

**CAUTION!!!**  
**UNDERGROUND UTILITIES**

EXISTING UTILITIES AND UNDERGROUND FACILITIES INDICATED ON THESE PLANS HAVE BEEN LOCATED FROM REFERENCE INFORMATION SUPPLIED BY VARIOUS OWNERS OF THE FACILITIES. THE ENGINEER DOES NOT ACCEPT THE RESPONSIBILITY FOR THE UTILITY LOCATIONS SHOWN. IT SHALL BE THE RESPONSIBILITY OF THE CONTRACTOR TO VERIFY BOTH HORIZONTALLY AND VERTICALLY THE LOCATION OF ALL EXISTING UTILITIES AND UNDERGROUND FACILITIES PRIOR TO CONSTRUCTION. TO TAKE NECESSARY PRECAUTIONS IN ORDER TO PROTECT ALL FACILITIES ENCOUNTERED, AND TO NOTIFY THE ENGINEER PROMPTLY OF ALL CONFLICTS OF THE WORK WITH EXISTING FACILITIES. THE CONTRACTOR SHALL PRESERVE AND PROTECT ALL EXISTING FACILITIES FROM DAMAGE DURING CONSTRUCTION. ANY DAMAGE BY THE CONTRACTOR TO EXISTING UTILITIES SHALL BE REPAIRED BY THE CONTRACTOR AT HIS EXPENSE.

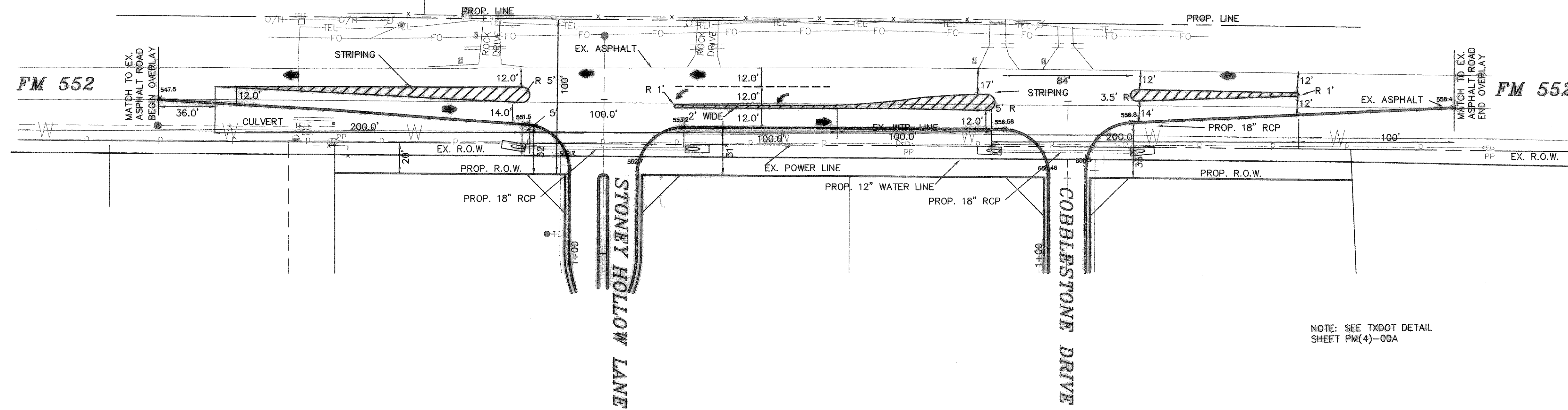
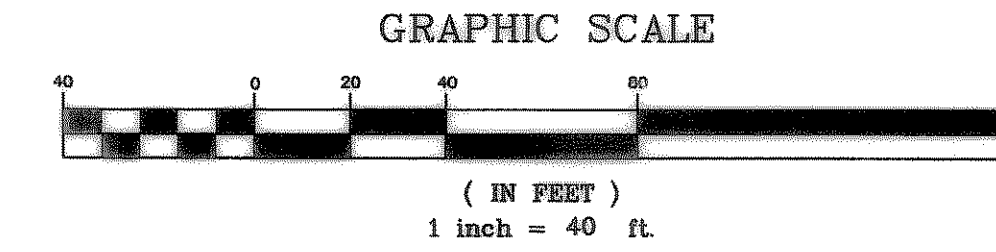

NOTE: SEE TXDOT DETAIL SHEET PM(4)-00A

PROPOSED F.M. 552 SECTION  
TYPICAL SECTION  
NOT TO SCALE

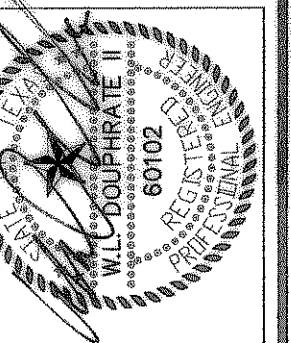
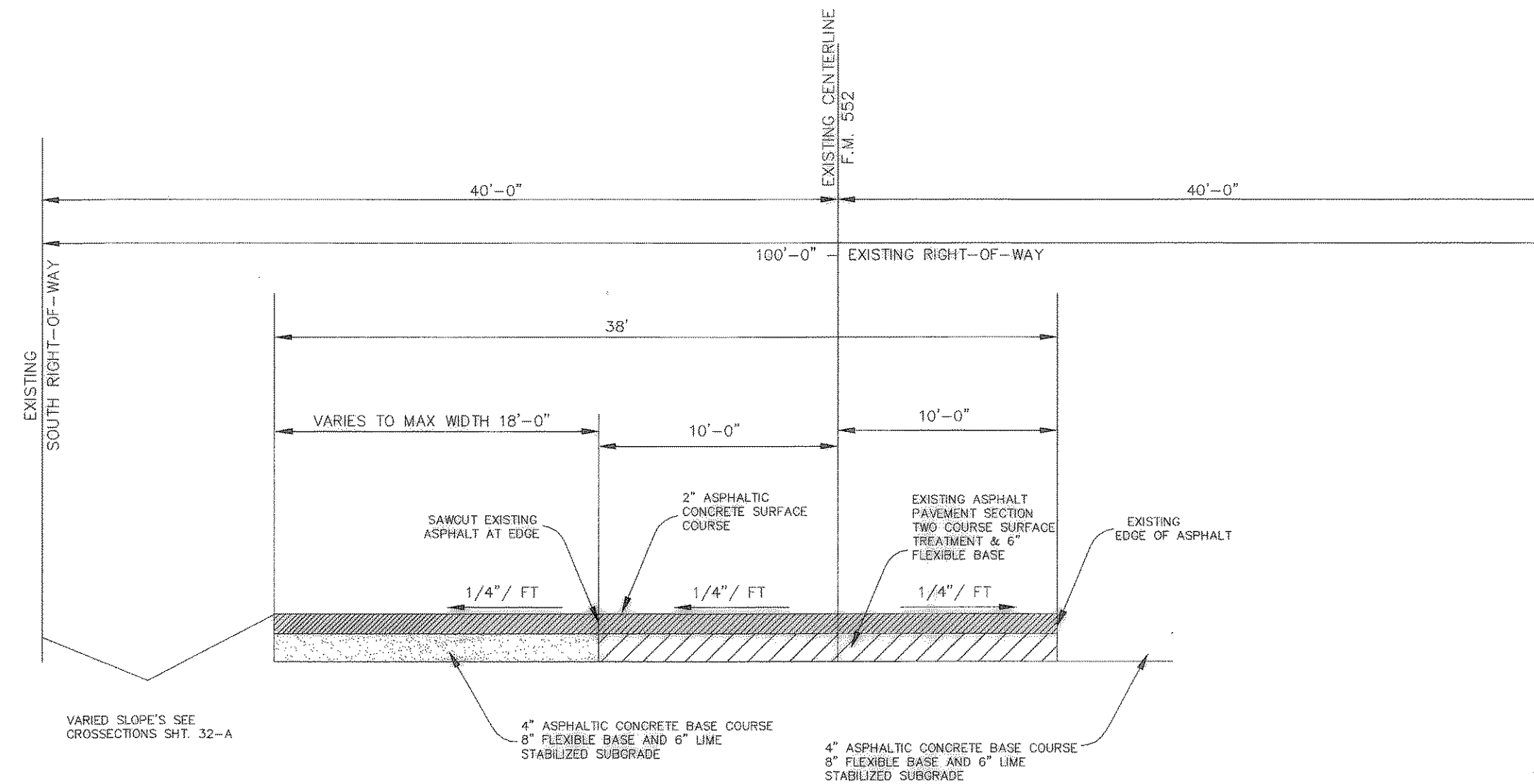

THE SEAL APPEARING ON THIS PLAN IS THE PROPERTY OF W.L. DOUPHRATE, P.E. NO. 80102 ON 1/1/02

**DOUPHRATE & ASSOCIATES, INC.**  
ENGINEERING - PROJECT MANAGEMENT - SURVEYING  
2235 RIDGE RD., # 200 ROCKWALL, TEXAS 75087  
PHONE: (972)771-9004 FAX: (972)771-9005

IMPROVEMENT AND STRIPING PLAN  
FARM TO MARKET 552  
STONEY HOLLOW ADDITION  
CITY OF ROCKWALL, COUNTY OF ROCKWALL, TEXAS

Revision:  
Striping changes per  
TxDot 8-5-02  
Striping changes per  
TxDot 4-17-03

REVISION
W.L.D. CHECKED
K.E.B. DRAWN
1/30/02 DATE
9907PV7 PROJECT

REVISED TO CONFORM TO CONSTRUCTION RECORDS.  
*[Signature]* DATE: 4/12/02