

SILT FENCE

|  |                                  |
|--|----------------------------------|
| North Central Texas Council of Governments | STANDARD SPECIFICATION REFERENCE |
|  |                                  |
| DATE: JAN. '98                             | STANDARD DRAWING NO.: 1020A      |

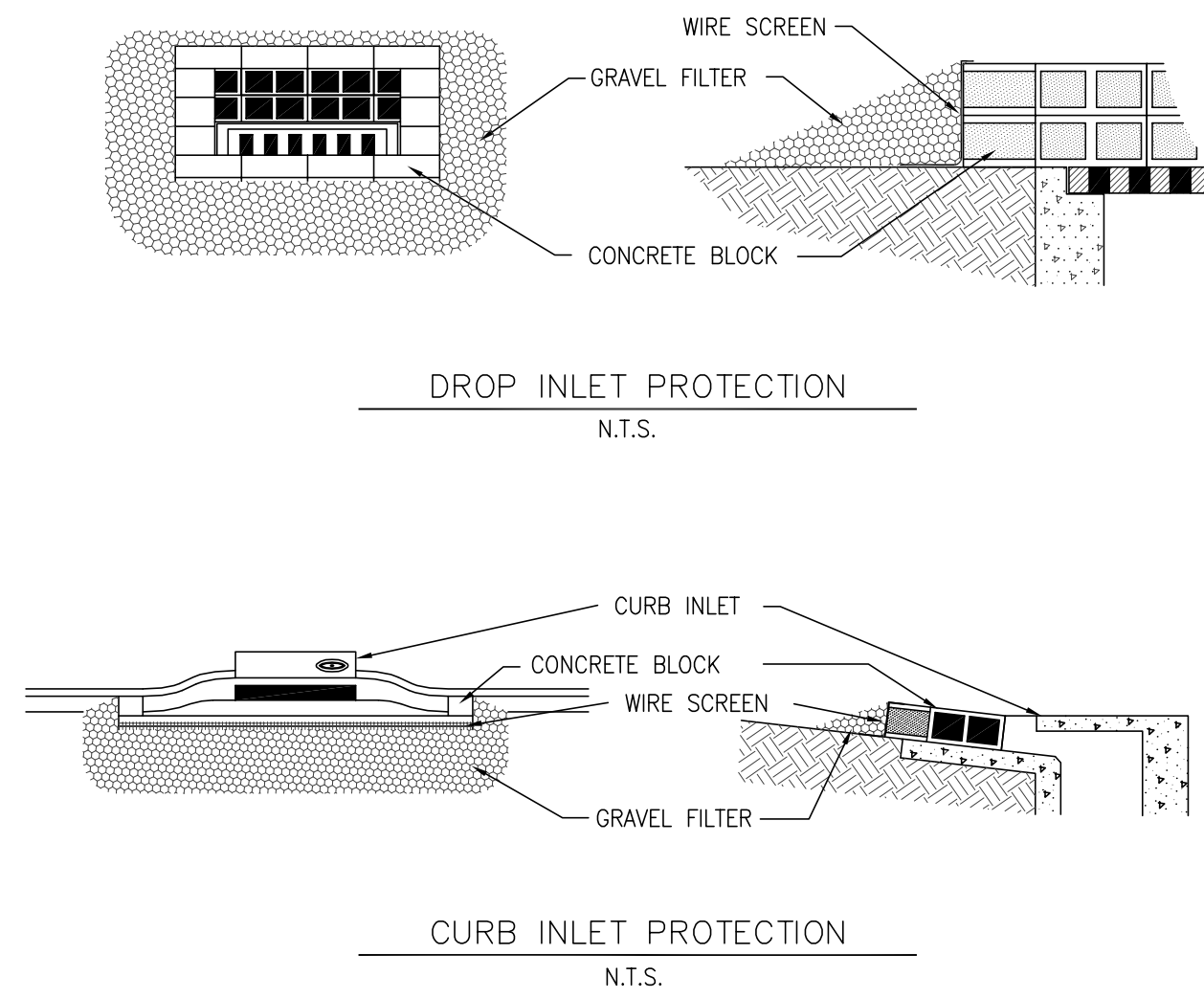

INLET PROTECTION  
BLOCK AND GRAVEL

|  |                                  |
|--|----------------------------------|
| North Central Texas Council of Governments | STANDARD SPECIFICATION REFERENCE |
|  |                                  |
| DATE: JAN. '98                             | STANDARD DRAWING NO.: 1130       |

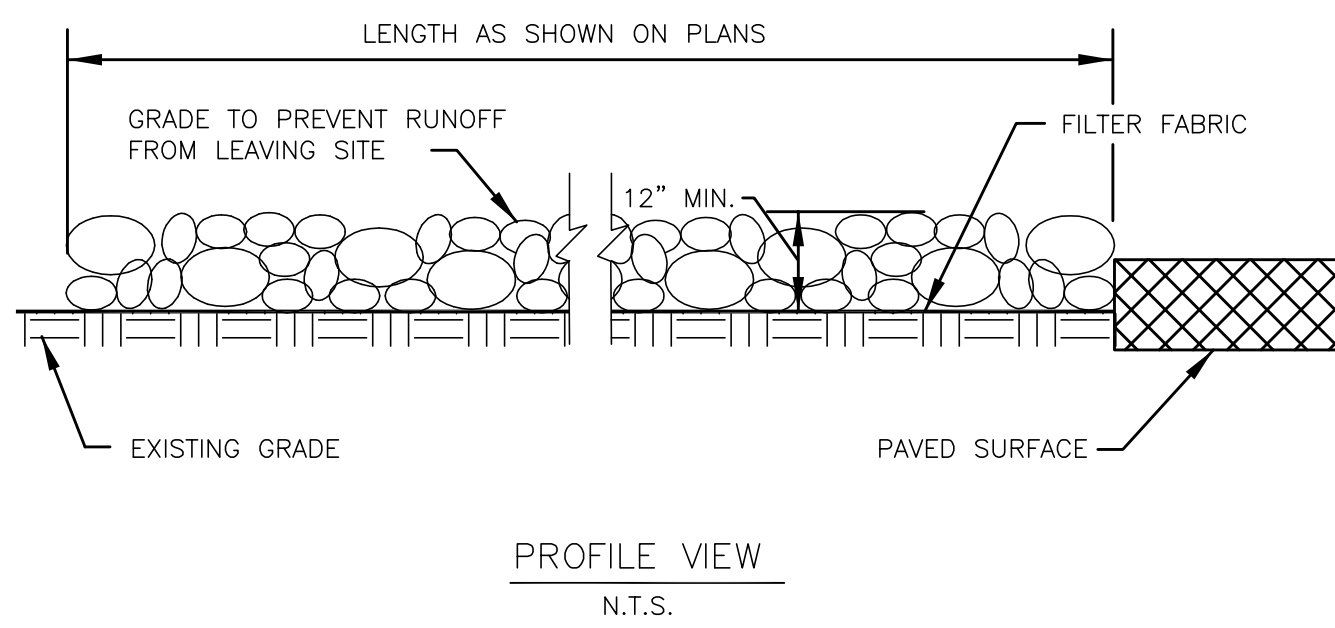

PROFILE VIEW  
N.T.S.

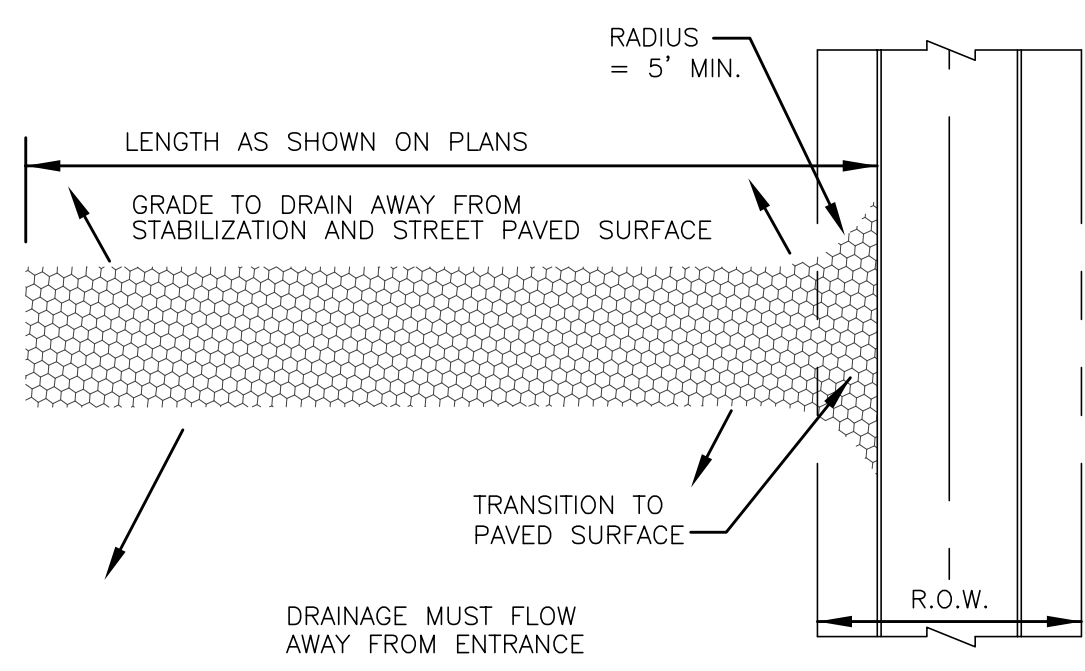

PLAN VIEW  
N.T.S.

STABILIZED CONSTRUCTION  
ENTRANCE

|  |                                  |
|--|----------------------------------|
| North Central Texas Council of Governments | STANDARD SPECIFICATION REFERENCE |
|  |                                  |
| DATE: JAN. '98                             | STANDARD DRAWING NO.: 1070A      |

NOTE:  
THE PROPOSED CONSTRUCTION ENTRANCE SHALL BE RELOCATED AS NECESSARY TO PREVENT SEDIMENT FROM LEAVING THE SITE AS THE EXISTING CONCRETE PAVEMENT IS REMOVED.

**BENCHMARK INFORMATION:**  
BM #1 - ELEV.: 518.83  
CITY OF ROCKWALL GPS CONTROL MONUMENT #R011.  
BM #2 - ELEV.: 490.08  
"C" CUT SET AT NORTHWEST CORNER OF CONCRETE PAD, APPROX. 19' SOUTH OF THE MOST EASTERLY CORNER OF THE SUBJECT PROPERTY AND THE SOUTHEAST CORNER OF LOT 2, PHASE TWO STONEBRIDGE CENTER.

| EROSION CONTROL LEGEND |                       |                 |                     |
|------------------------|-----------------------|-----------------|---------------------|
| T.C.                   | TOP OF CURB           | N.G.            | NATURAL GROUND      |
| G                      | GUTTER                | - - - XXX - - - | EXISTING CONTOURS   |
| T.P.                   | TOP OF PAVEMENT       | — XXX —         | PROPOSED CONTOURS   |
|                        | CONSTRUCTION ENTRANCE | — SF —          | PROPOSED SILT FENCE |
|                        | INLET PROTECTION      |                 |                     |

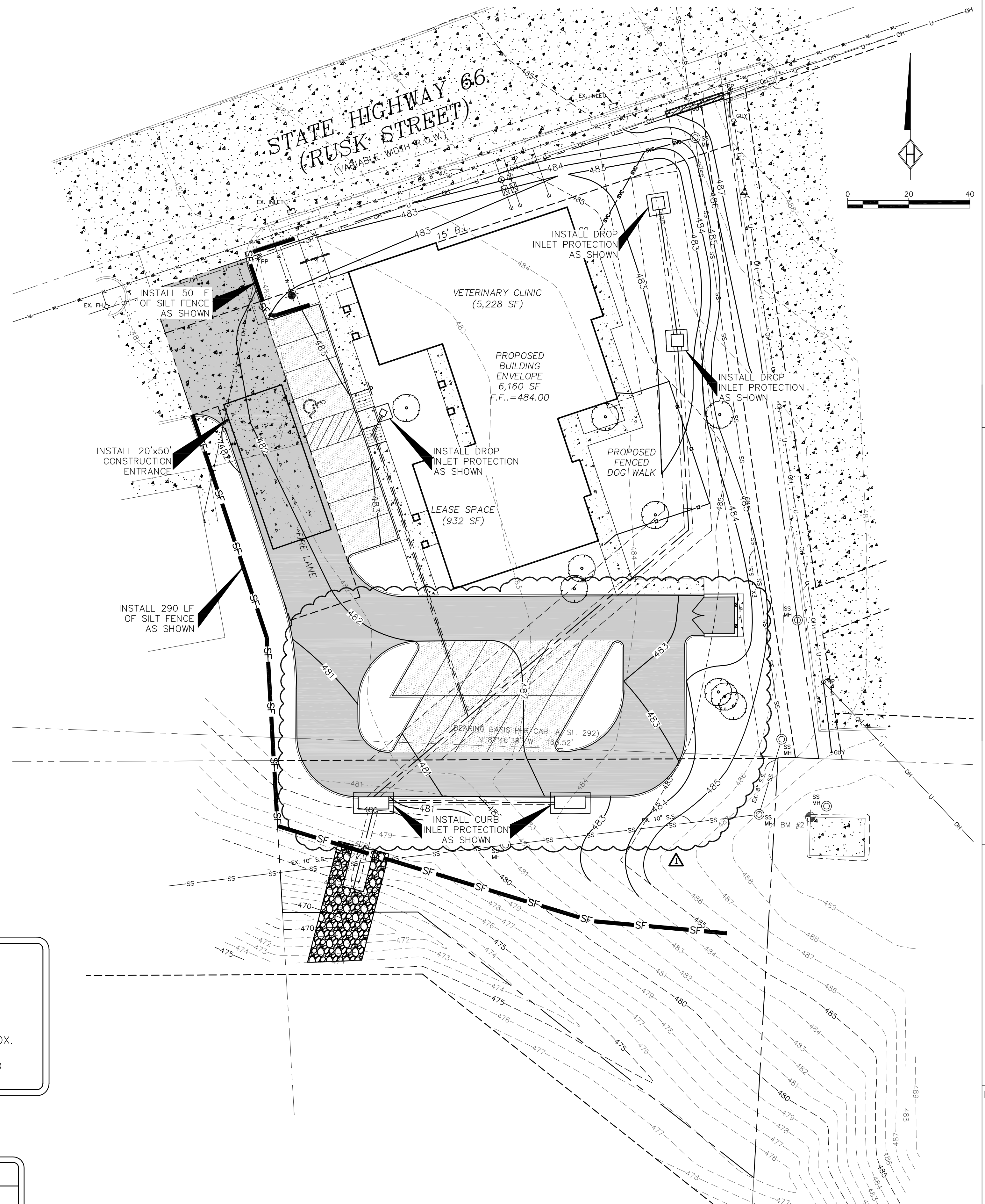

**RECORD DRAWING**  
To the best of our knowledge, Homeyer Engineering, Inc., hereby states that this plan is a Record Drawing. The information provided is based on surveying conducted at the site and information provided by the contractor.  
Steven R. Homeyer  
Steven R. Homeyer, P.E. #86942  
Date: 07-01-2008



THE SEAL APPEARING ON THIS DOCUMENT WAS AUTHORIZED BY STEVEN R. HOMEYER, P.E. #86942 ON JULY 1, 2008.

STONEBRIDGE VETERINARY  
1.085 ACRES  
ZONED - GR/SH 66 OVERLAY  
CITY OF ROCKWALL  
ROCKWALL COUNTY, TEXAS

EROSION CONTROL  
PLAN

REVISIONS:  
03-20-08  
REVISED PARKING & DUMPSTER LOCATION TO PROTECT EXISTING TREES.

DRAWN BY: BSZ

DATE: 10/15/07

HEI #: 07-168

SHEET NO:

G4

**HOMEYER**  
ENGINEERING, INC.  
CIVIL ENGINEERING, PLANNING  
SITE & LAND PLANNING  
P. O. BOX 294527 • LEWISVILLE, TEXAS • 75029  
972-990-0000 • FAX 972-990-0001  
WWW.HOMEYERENGINEERING.COM

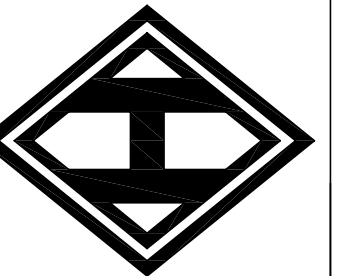

LARRY, JAN. 01, 2008 10:35:25 PM

C:\ADG\BANKING\STONEBRIDGE\_VETERINARY\EROSION\_CONTROL\EROSION\_CONTROL.dwg