

CIVIL SITE PLANS
for
STONEBRIDGE VETERINARY
Lot 1, Block A, Avery Addition
1.085 Acres
Zoned – GR/SH 66 OVERLAY
in the
B.F. Boydston Survey, Abstract No. 14
City of Rockwall
Rockwall County, Texas
July 2008

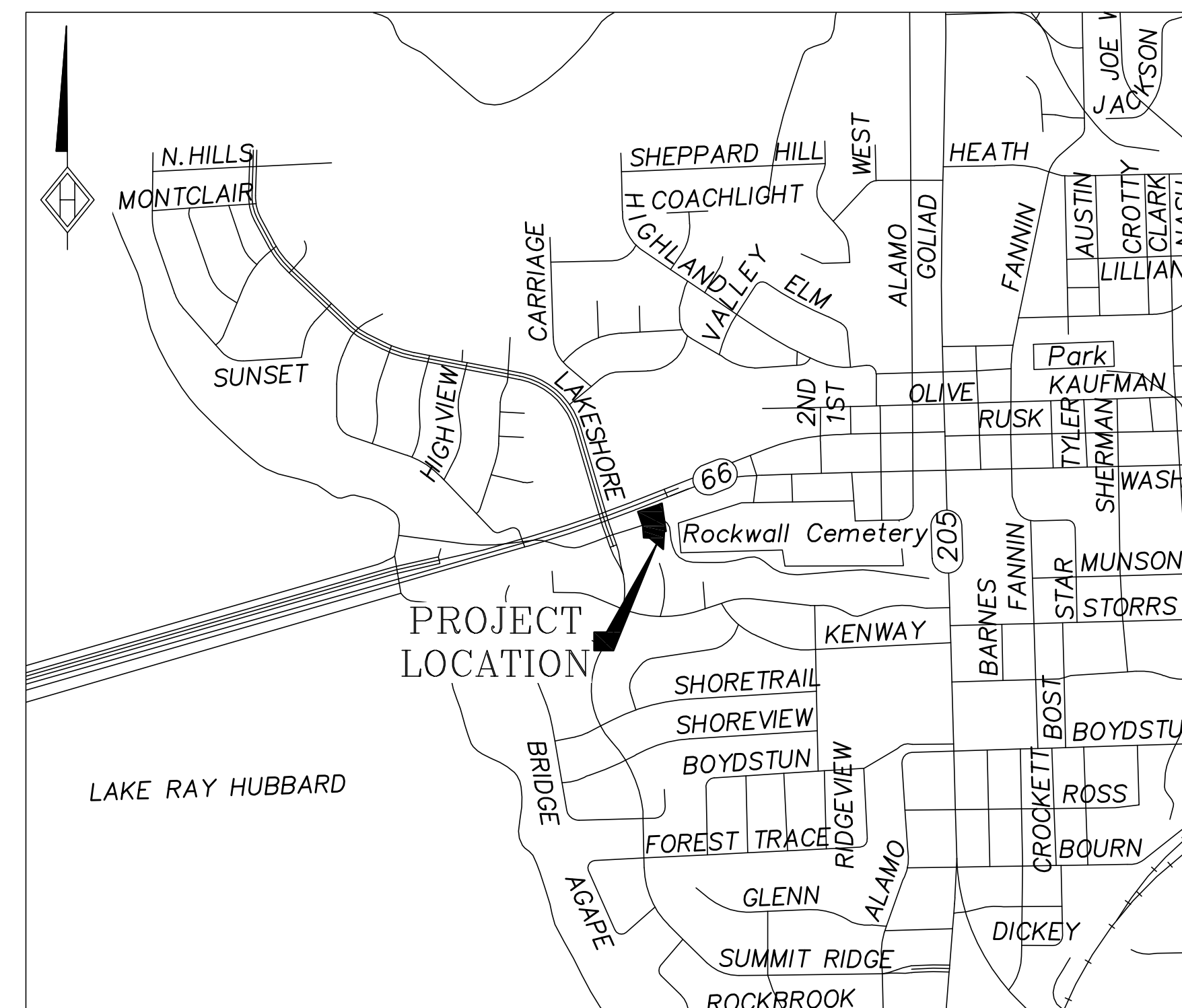

Vicinity Map 1"=1000'

SHEET INDEX

- Cover
- Final Plat
- C1 General Notes
- C2 Site Plan
- C3 Grading Plan
- C4 Erosion Control Plan
- C5 Drainage Area Map
- C6 Storm Drain Plan
- C7 Utility Plan
- C8 Landscape Plan
- C9 Irrigation Plan
- C10 Landscape & Irrigation Specifications
- C11 Traffic Control Plan
- C12 Details
- C13 City of Rockwall Standard Details
- C14 City of Rockwall Standard Details
- C15 ADA Ramp Details

RECORD DRAWING

To the best of our knowledge, Homeyer Engineering, Inc., hereby states that this plan is a Record Drawing. The information provided is based on surveying conducted at the site and information provided by the contractor.

Steven R. Homeyer
Steven R. Homeyer, P.E. #86942

Date: 07-01-2008



THE SEAL APPEARING ON THIS DOCUMENT WAS AUTHORIZED BY STEVEN R. HOMEYER, P.E. 86942 ON JULY 1, 2008

ENGINEER
HOMEYER ENGINEERING, INC
P.O. BOX 294527
LEWISVILLE, TEXAS 75029
CONTACT: STEVEN R. HOMEYER, PE
PHONE: 972-906-9985

DEVELOPER
DR. KURT AVERY, DVM
1365 SOUTHERN PINES DR.
ROCKWALL, TEXAS 75087
CONTACT: DR. KURT AVERY, DVM
PHONE: 515-520-0466

APPLICANT
TRI-STAR CONSTRUCTION, INC.
3601 YUCCA DRIVE, BUILDING 2
FLOWER MOUND, TEXAS 75028
CONTACT: KEVAN MEEHAN
PHONE: 972-221-5558

HOMEYER
ENGINEERING, INC.
CIVIL ENGINEERING & PLANNING
SITE & LAND PLANNING
P.O. BOX 294527 • LEWISVILLE, TEXAS 75029
972-906-9985 PHONE • 972-906-9987 FAX

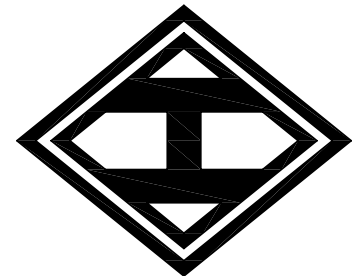

STONEBRIDGE VETERINARY
1.085 ACRES
ZONED - GR/SH 66 OVERLAY
CITY OF ROCKWALL
ROCKWALL COUNTY, TEXAS

COVER SHEET

DRAWN BY:
DATE: 10/15/07
HEI #: 07-168

STONEBRIDGE VETERINARY

CIVIL SITE PLANS