

AS BUILT PLANS

NOTE: THE INTENT OF THE OWNER AND ENGINEER WAS TO CONSTRUCT THE IMPROVEMENTS ACCORDING TO THESE PLANS AS APPROVED BY THE CITY OF ROCKWALL. THE GRADES WERE SET ON THE GROUND FOR CONSTRUCTION ACCORDING TO SAID PLANS. THE CITY OF ROCKWALL INSPECTED THE CONSTRUCTION. WE ARE NOT AWARE OF ANY CHANGES OR REVISIONS TO THESE PLANS DURING CONSTRUCTION, EXCEPT AS SHOWN.

JULY 10, 1981

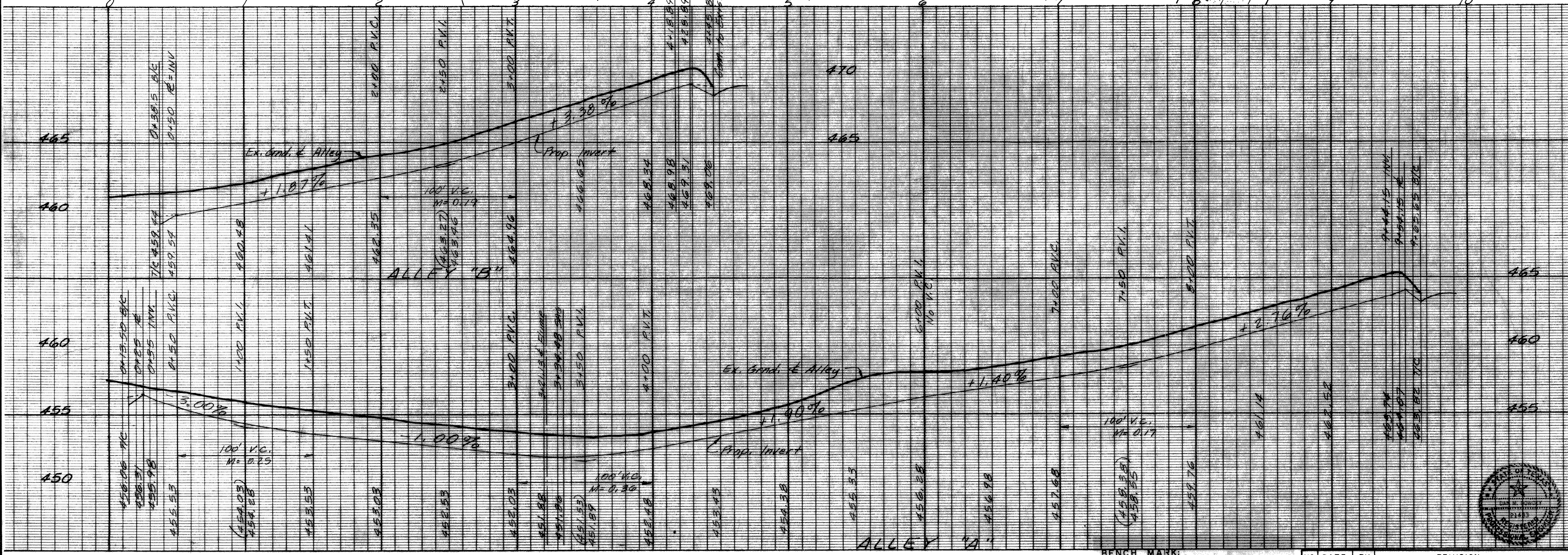

ALLEY'S BLOCK "A"
 PAVING PLANS
 STONEBRIDGE MEADOWS
 PHASE FIVE
 ROCKWALL, TEXAS

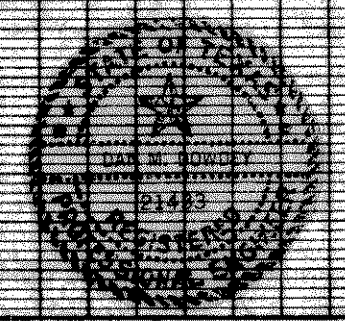

BENCH MARK:
 TOP OF SOUTH FLANGE BOLT
 OF FIRE HYDRANT ON EAST
 SIDE OF LAKE SHORE DRIVE,
 200' NORTH OF THE NORTH
 PROPERTY LINE OF STONE-
 BRIDGE MEADOWS I.
 ELEV. 454.36'

| NO. | DATE | BY | REVISION |
|-----|----------|----|--|
| 2 | 4-81 | RE | Revised Grade Alley "B" - 0+38.5 to 2+50 |
| 1 | 10-17-80 | RE | Added curb in Alley "A" |

| | | | | | | |
|--|--------|---------|---------|-----------|-------|-------|
| THREADGILL - DOWDEY and ASSOCIATES CONSULTING ENGINEERS DALLAS, TEXAS | | | | | | |
| DESIGN | DRAWN | CHECKED | DATE | SCALE | JOB | SHEET |
| J.G.B. R.E. | D.M.D. | 9-80 | 11/4/81 | 1/4" = 1' | 507-E | 6/10 |