

SCALE
1"=40' H
1"=5' V

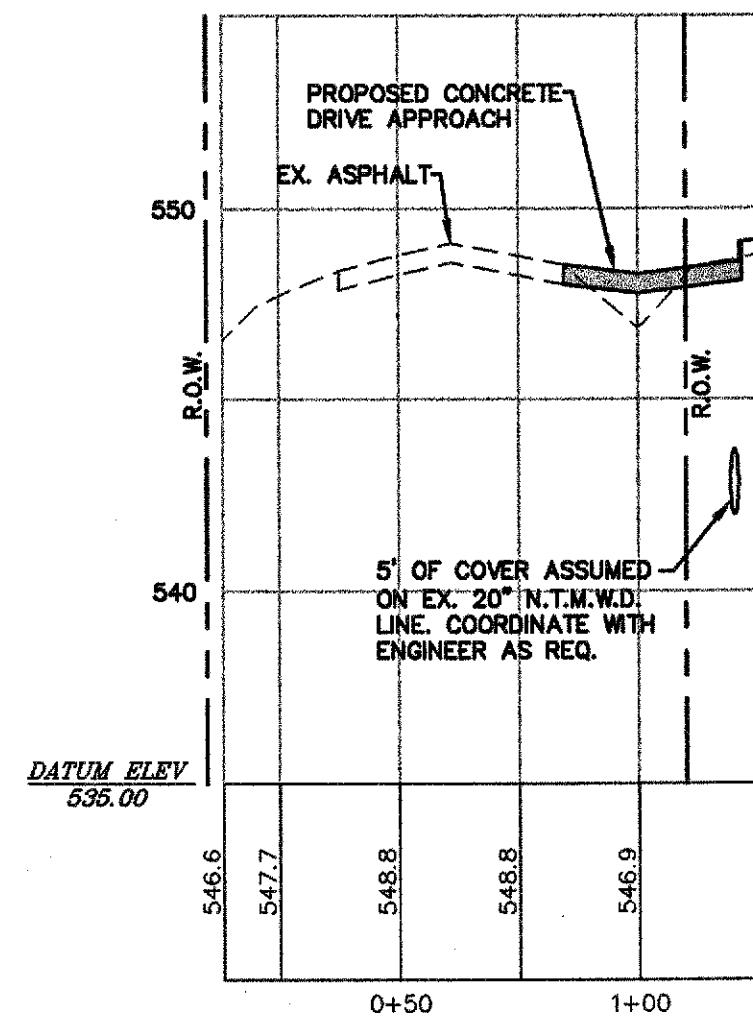

CROSS SECTION #1

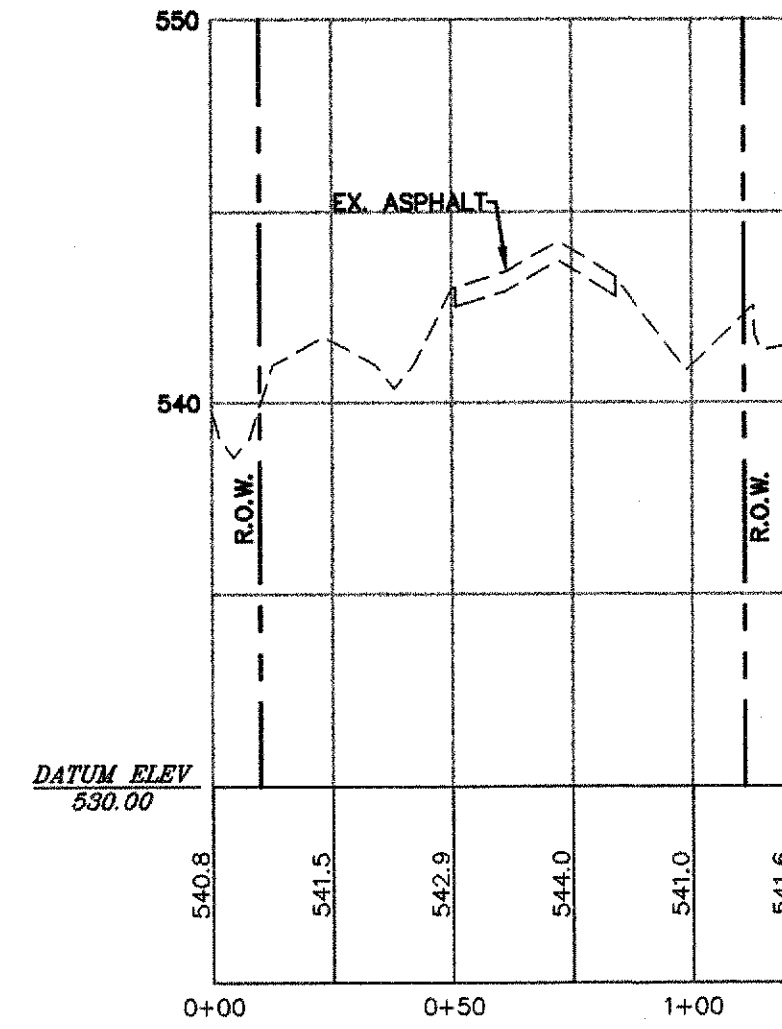

CROSS SECTION #2

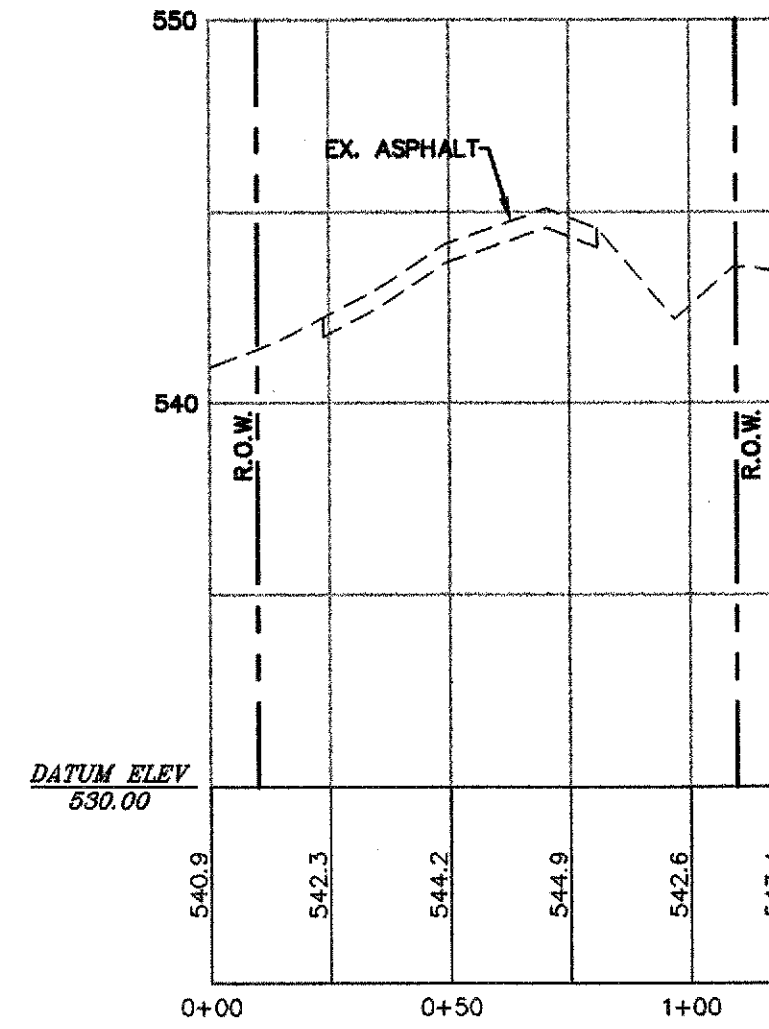

CROSS SECTION #3

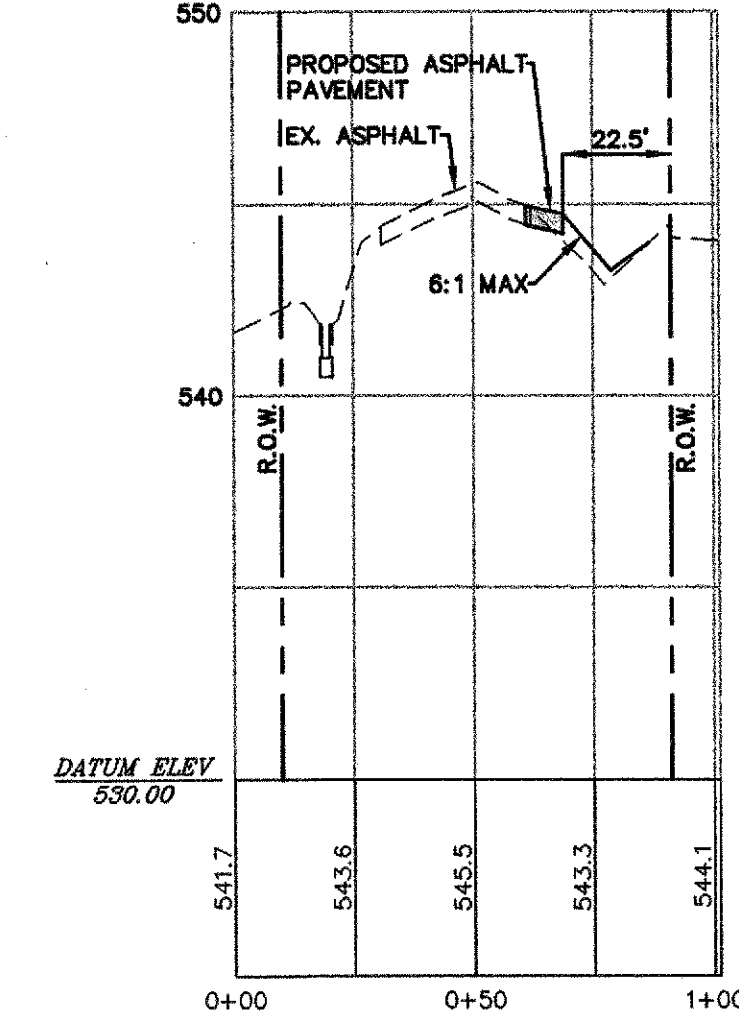

CROSS SECTION #4

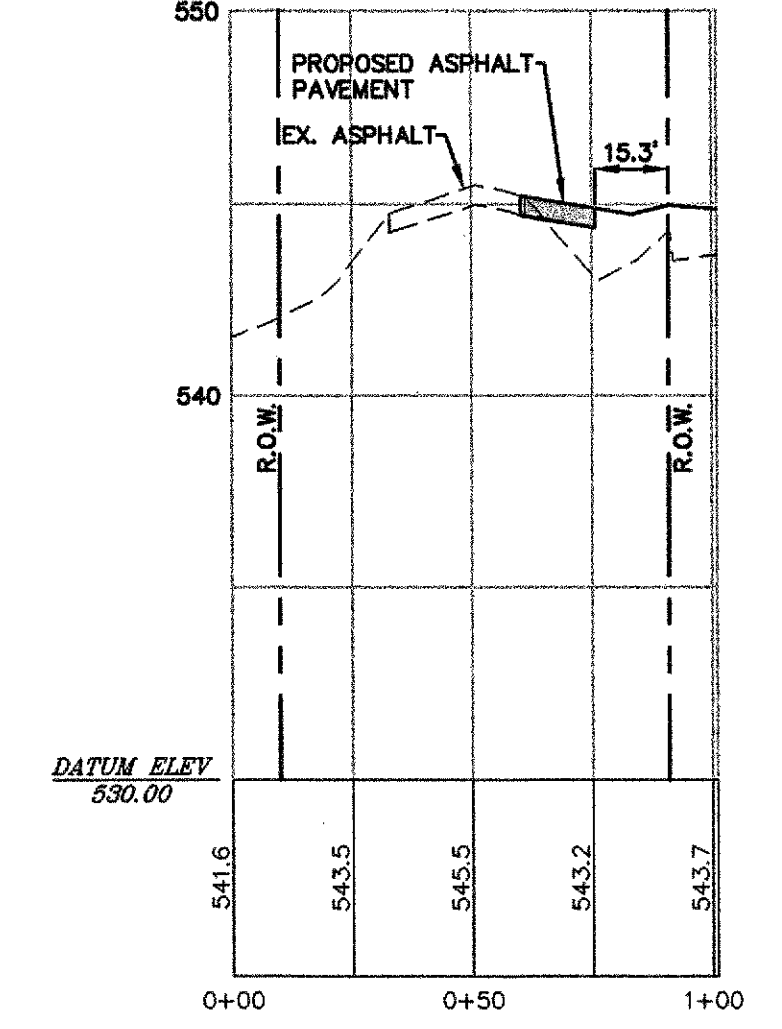

CROSS SECTION #5

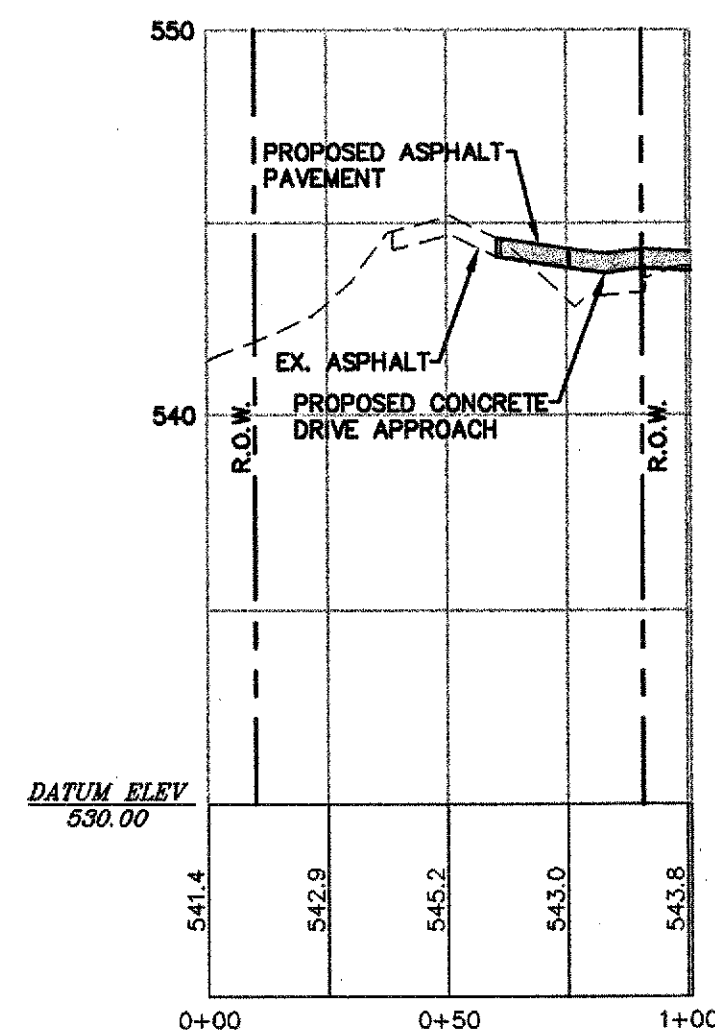

CROSS SECTION #6

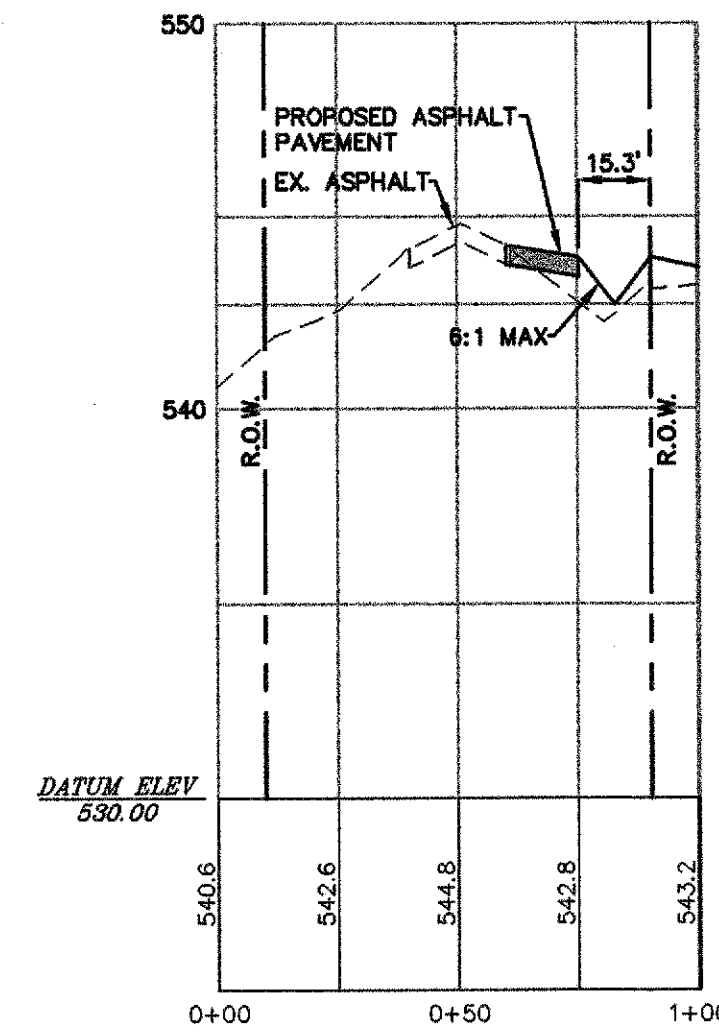

CROSS SECTION #7

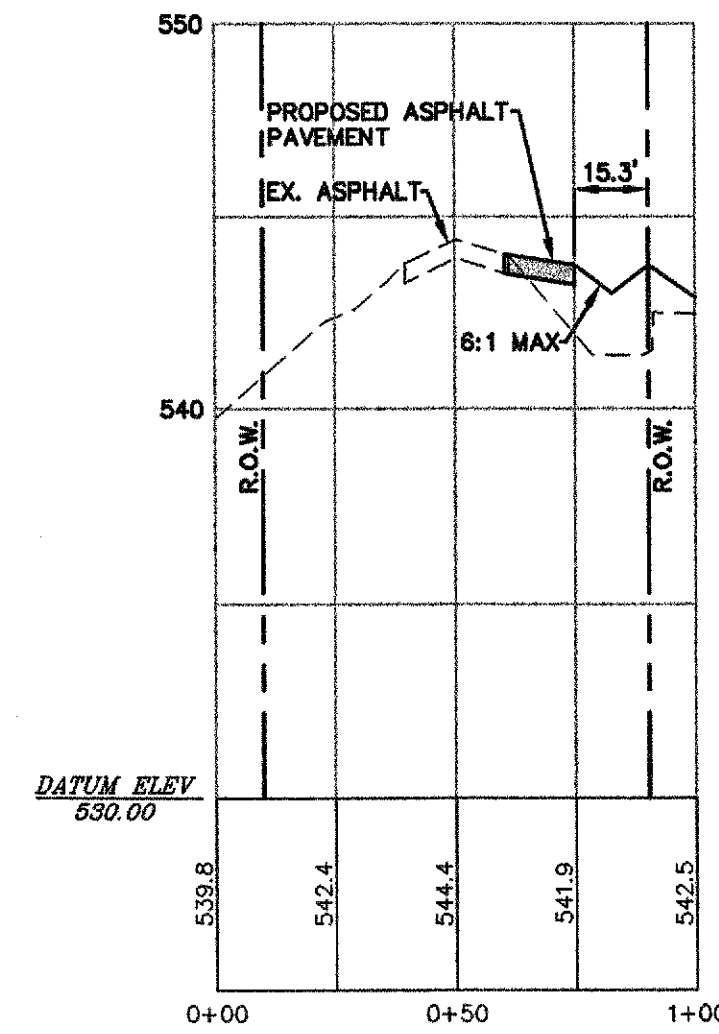

CROSS SECTION #8

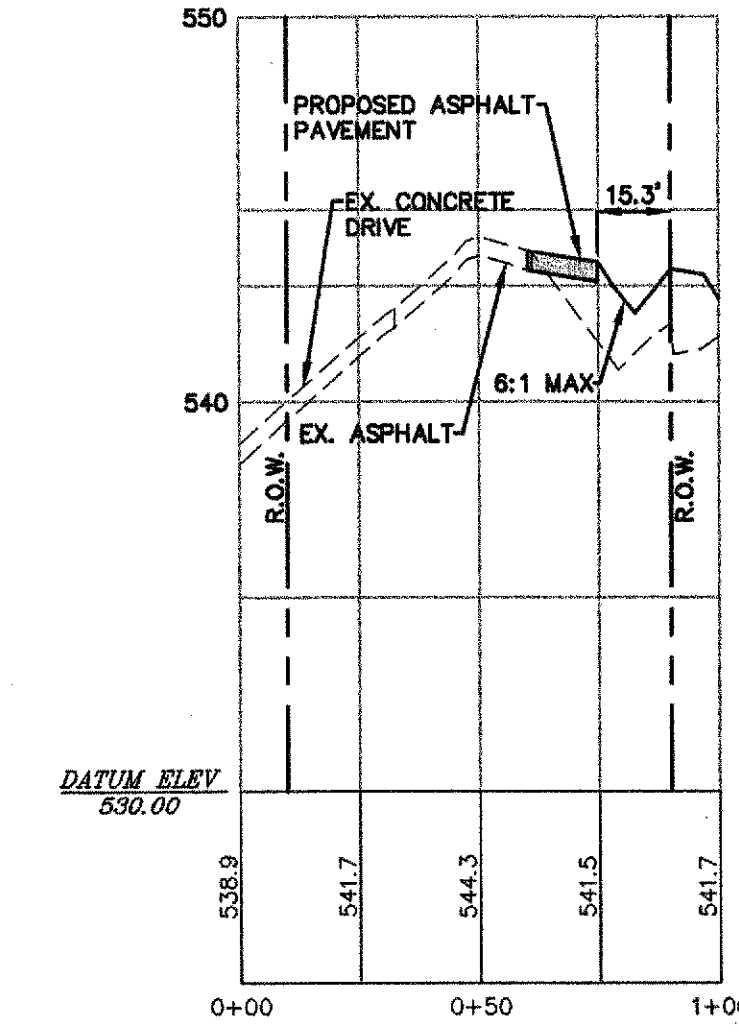

CROSS SECTION #9

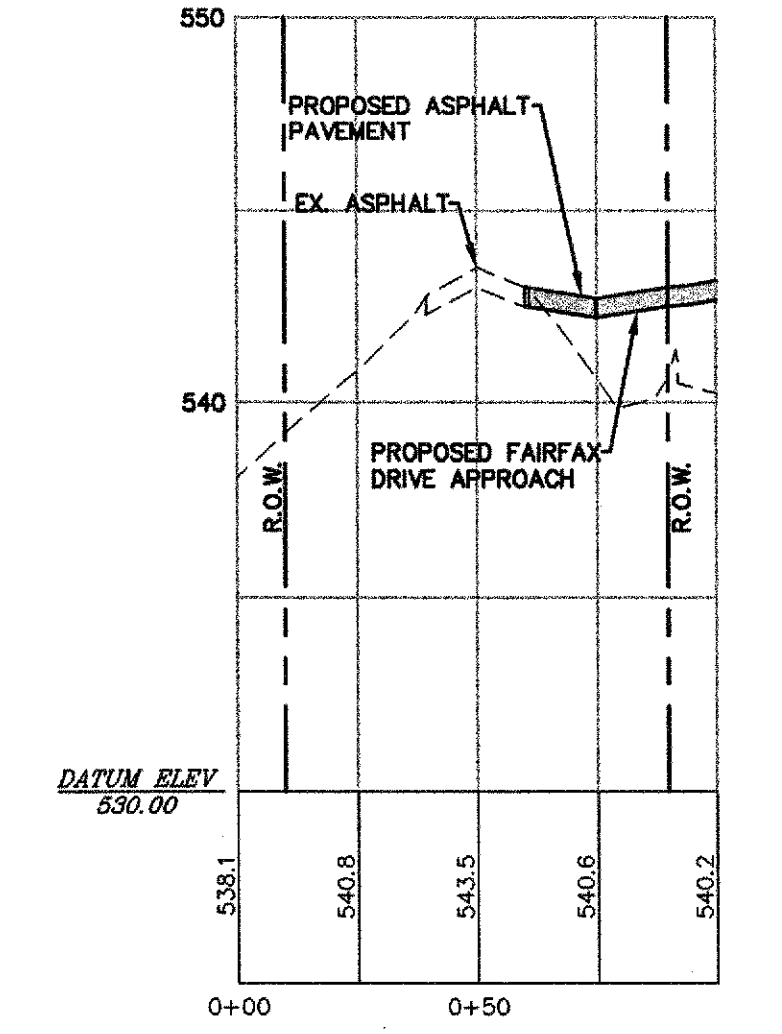

CROSS SECTION #10

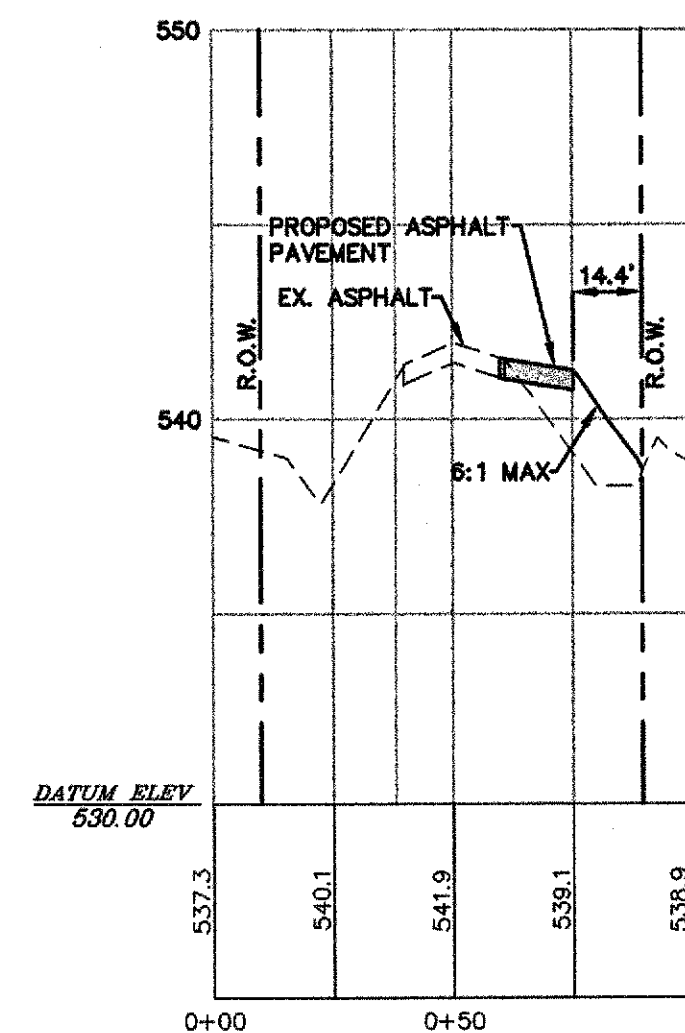

CROSS SECTION #11

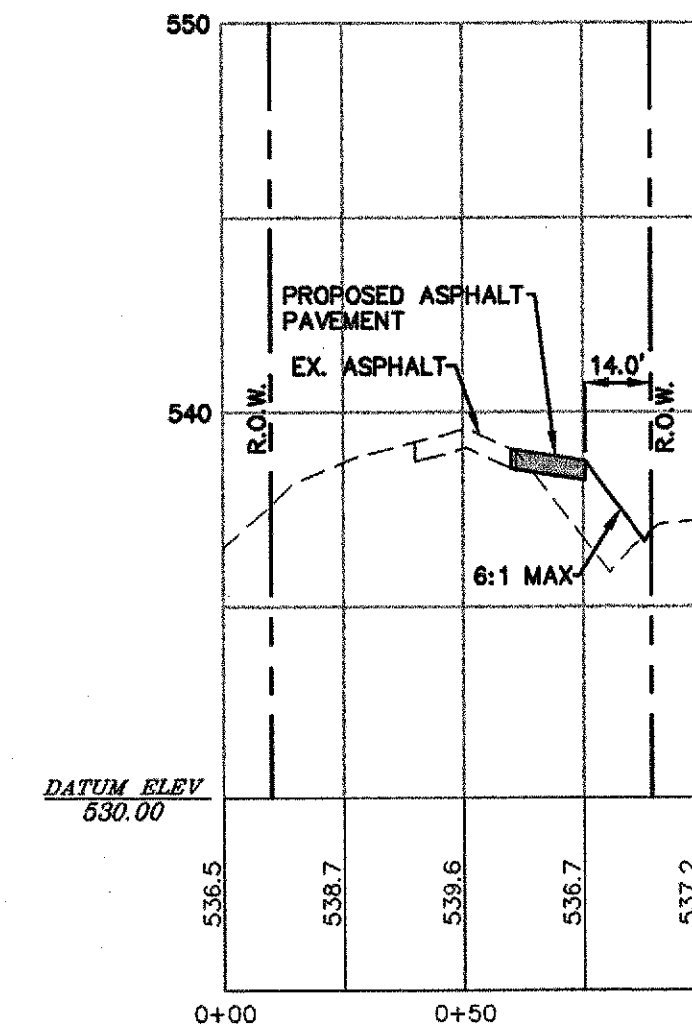

CROSS SECTION #12

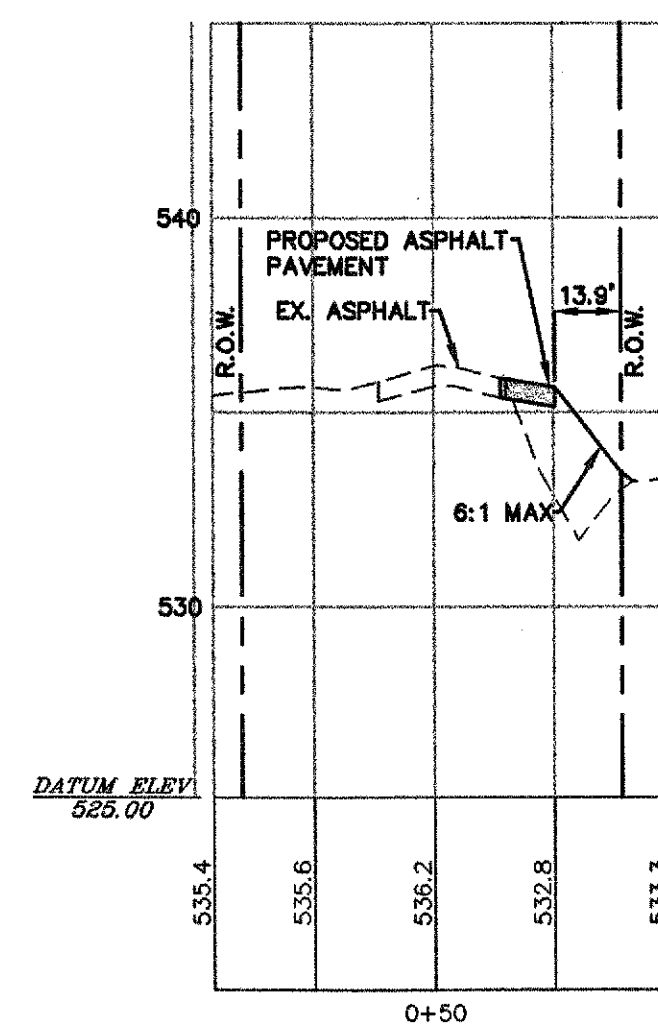

CROSS SECTION #13

RECORD DRAWINGS:
IT WAS THE INTENT THAT THE IMPROVEMENTS SHOWN BE CONSTRUCTED ACCORDING TO THESE PLANS AS APPROVED BY THE CITY. THE LINES AND GRADES WERE SET ON THE GROUND FOR CONSTRUCTION ACCORDING TO SAID PLANS. THE CITY INSPECTED THE CONSTRUCTION. THE ENGINEER DID NOT VERIFY LINES OR GRADES AFTER CONSTRUCTION. WE ARE NOT AWARE OF ANY CHANGES OR REVISIONS TO THESE PLANS DURING CONSTRUCTION OTHER THAN THOSE SHOWN.

RANDALL P. POGUE, P.E. DATE: APRIL 15, 2010
TX LIC. NO. 84780

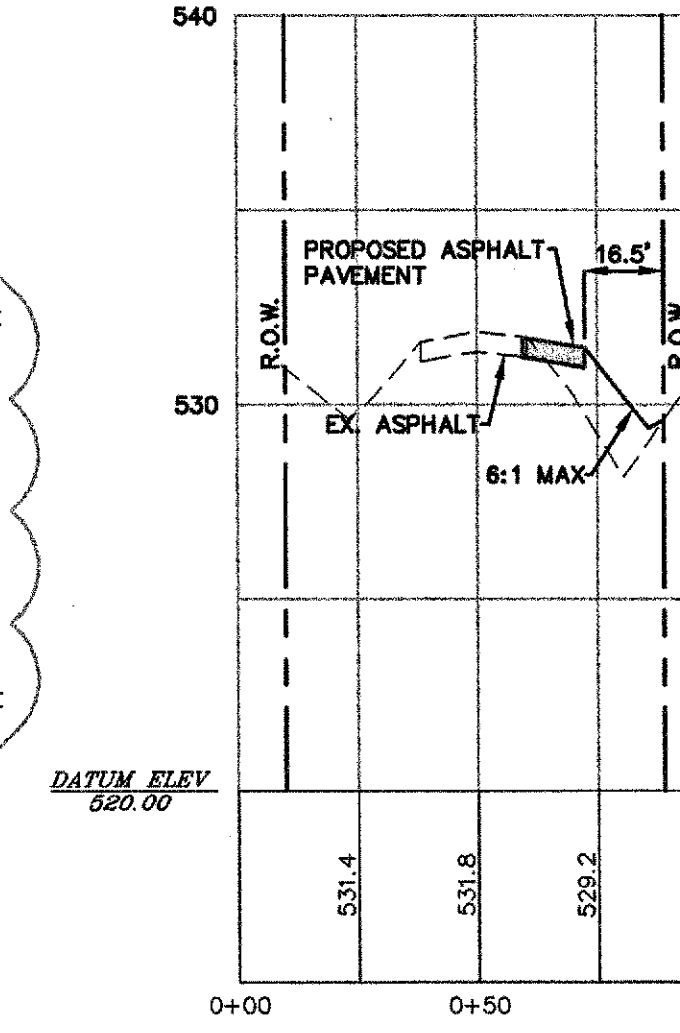

CROSS SECTION #14

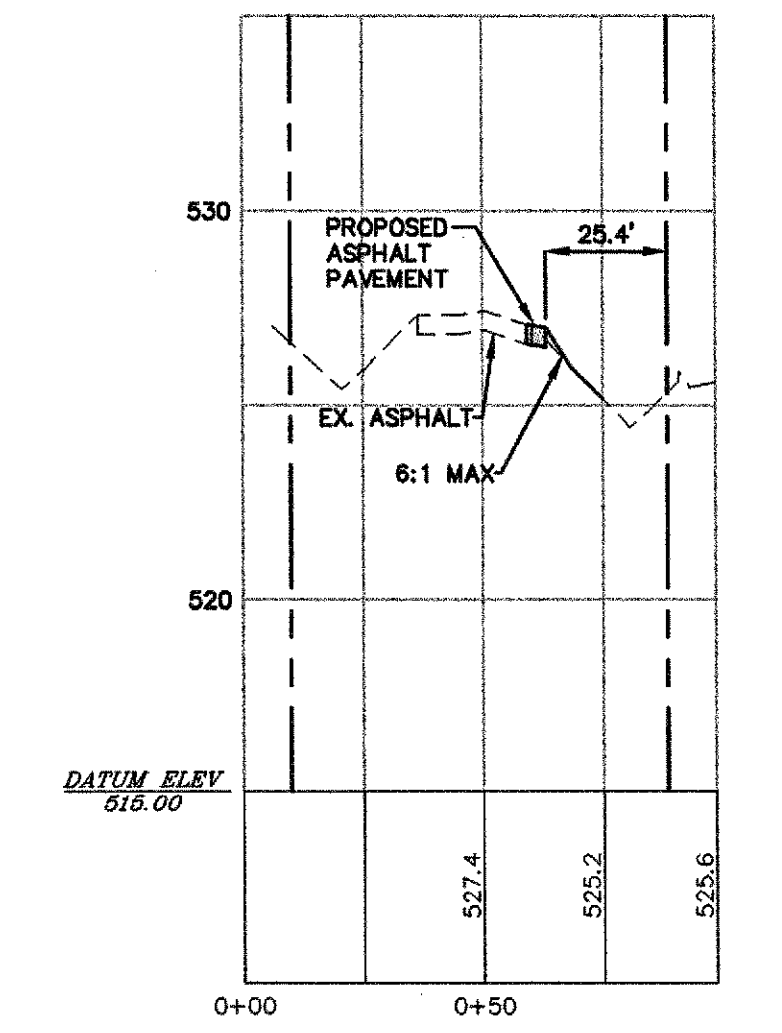

CROSS SECTION #15

NO.	DATE	REVISION / DESCRIPTION		
1	04-15-10	RECORD DRAWINGS		
2	02-24-10	ADDED RIGHT TURN LANE ON S.H. 205		
3	07-17-09	SANITARY SEWER & ADA ROUTE REVISIONS		
4	06-19-09	TXDOT COMMENTS		
DESIGN	DRAWN	DATE	SCALE	NOTES
BEC	WTW	05-21-09	AS SHOWN	-

OWNER
METROPLEX ACQUISITION FUND, LP
8214 WESTCHESTER, SUITE 850
DALLAS, TEXAS 75225
MR. GREY STOGNER
(214) 343-4477 PHONE
(214) 340-2029 FAX

DEVELOPER
CRESTVIEW REAL ESTATE, L.L.C.
8214 WESTCHESTER, SUITE 850
DALLAS, TEXAS 75225
MR. GREY STOGNER
(214) 343-4477 PHONE
(214) 340-2029 FAX

THE SEAL APPEARING ON THIS DOCUMENT WAS AUTHORIZED BY BRANDON E. COX, P.E. 101071 ON 05-21-09. ALTERATION OF A SEALED DOCUMENT WITHOUT PROPER NOTIFICATION TO THE RESPONSIBLE ENGINEER IS AN OFFENSE UNDER THE TEXAS ENGINEERING PRACTICE ACT.

Brandon E. Cox 05-21-09

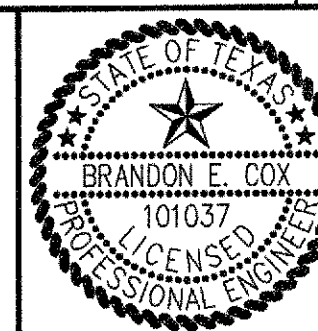

POGUE
ENGINEERING & DEVELOPMENT COMPANY, INC.
1512 BRAY CENTRAL DRIVE
SUITE 100
MCKINNEY, TEXAS 75069
(214) 544-8880 PHONE
(214) 544-8882 FAX
www.PogueEngineering.com

ROADWAY CROSS SECTIONS (2 of 2)
STONE CREEK RETAIL
BLOCK A, LOTS 1-6, STONE CREEK RETAIL ADDITION
W.T. DEWEESE SURVEY, ABSTRACT NO. 71
CITY OF ROCKWALL, TEXAS

SHEET NO.

C3.05

WILLIAMS 04/29/2010 - 3:59PM
 N:\V085\1300-1393\1393-08-087.DWG\1393-08-087-07A.DWG
 THE ENGINEERING DESIGN, RETAIL AND ENGINEERING DRAWINGS FOR THIS PROJECT AND/OR OVERALL PROJECT ARE THE LEGAL PROPERTY OF POGUE ENGINEERING & DEVELOPMENT COMPANY, INC. THEIR USE FOR REPRODUCTION, CONSTRUCTION, OR DISTRIBUTION IS PROHIBITED UNLESS AUTHORIZED IN WRITING BY POGUE ENGINEERING & DEVELOPMENT COMPANY, INC.
 © POGUE ENGINEERING & DEVELOPMENT COMPANY, INC. 2009. ALL RIGHTS RESERVED.

STONE CREEK RETAIL - ROCKWALL
TEXAS BOARD OF PROFESSIONAL ENGINEERS, CERTIFICATE OF REGISTRATION # 000491; TEXAS BOARD OF PROFESSIONAL LAND SURVEYING, CERTIFICATE OF REGISTRATION 100421-00