

- LEGEND**
- BOLLARD
 - ELECTRIC METER
 - POWER POLE
 - LIGHT STANDARD
 - WATER METER
 - WATER VALVE
 - IRRIGATION CONTROL VALVE
 - FIRE HYDRANT
 - FIRE DEPT CONNECTION
 - CLEAN OUT
 - MANHOLE
 - GAS METER
 - TRAFFIC SIGNAL CONTROL
 - TRAFFIC SIGNAL POLE
 - TRAFFIC SIGN
 - TELEPHONE BOX
 - TV BOX
 - FLAG POLE
 - LANDSCAPE AREA
 - PROPERTY LINE
 - O.H. POWER LINES
 - U/G TELEPHONE LINES
 - U/G WATER LINE
 - U/G GAS LINE
 - FENCE
 - EXISTING CONTOURS
 - EXISTING SPOT GRADES
 - CONTROLLING MONUMENT
 - 5/8-INCH IRON ROD WITH "POGUE ENG & DEV" CAP SET

RECORD DRAWINGS:
 IT WAS THE INTENT THAT THE IMPROVEMENTS SHOWN BE CONSTRUCTED ACCORDING TO THESE PLANS AS APPROVED BY THE CITY. THE LINES AND GRADES WERE SET ON THE GROUND FOR CONSTRUCTION ACCORDING TO SAID PLANS. THE CITY INSPECTED THE CONSTRUCTION. THE ENGINEER DID NOT VERIFY LINES OR GRADES AFTER CONSTRUCTION. WE ARE NOT AWARE OF ANY CHANGES OR REVISIONS TO THESE PLANS DURING CONSTRUCTION OTHER THAN THOSE SHOWN.

RANDALL P. POGUE, P.E. DATE: APRIL 15, 2010
 TX LIC. NO. 84780

ADA ROUTE
 NOTE: MAXIMUM SLOPE FOR ALL ADA PATHS 6% MAX. GROSS FALL IS 2% FOR THE FIRST FIVE FEET FROM THE DOOR A 2% SLOPE (MAX.) MUST BE MAINTAINED

FRANCHISE UTILITY NOTES:
 1. TXU ENERGY CONSTRUCTION SERVICES - (800) 711-9112
 2. ATMOS ENERGY (GAS) - 903-457-2092 - DINAH WOOD
 3. AT&T (PHONE) - 903-457-2092 - DWAYNE WELLS

BENCH MARK LIST:
 BENCHMARK #1
 SQUARE CUT SET AT SOUTHWEST CORNER OF WATER VAULT LOCATED AT THE SOUTHWEST CORNER OF THE INTERSECTION OF THE EAST RIGHT-OF-WAY LINE OF SH 205 AND THE SOUTH RIGHT-OF-WAY LINE OF FM 552. ELEVATION = 543.09
 BENCHMARK #2
 CITY OF ROCKWALL MONUMENT (R010) FOUND. ELEVATION = 524.788

CAUTION!!!
 UNDERGROUND UTILITIES ARE LOCATED IN THIS AREA. 48 HOURS PRIOR TO ANY CONSTRUCTION ACTIVITIES, CONTACT LINE LOCATES FOR FRANCHISE UTILITY INFO. CALL BEFORE YOU DIG!
 TEXAS EXCAVATION SAFETY SYSTEM (TESS) 1-800-344-8377
 TEXAS ONE CALL SYSTEMS 1-800-245-4545
 LONE STAR NOTIFICATION CENTER 1-800-669-8344 EXT. 5

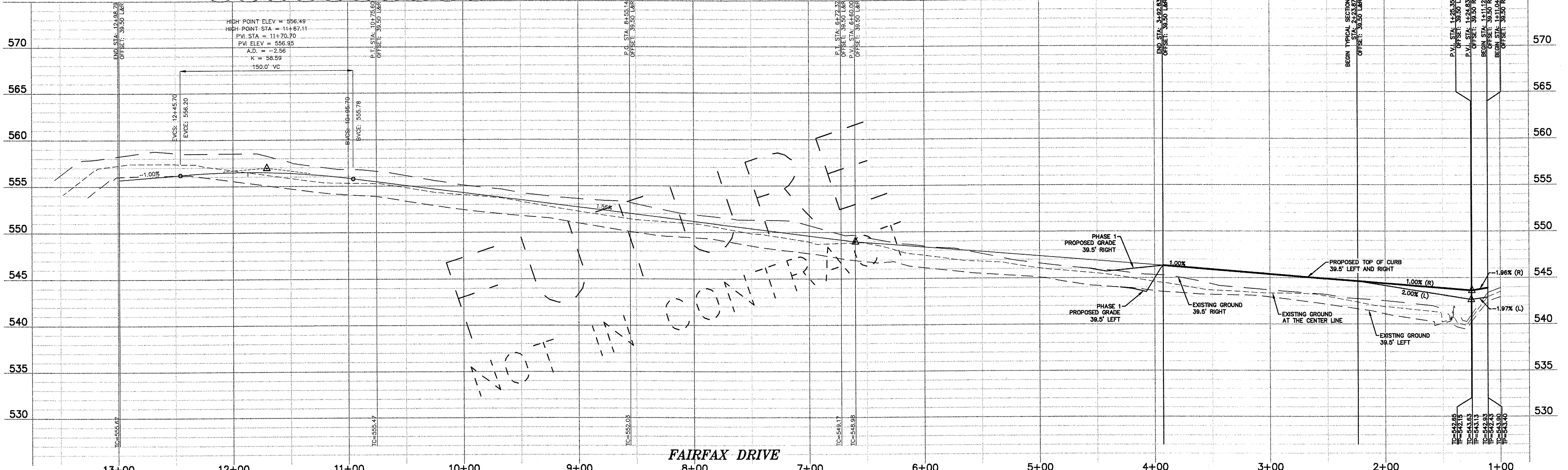

NO.	DATE	REVISION / DESCRIPTION
04-15-10		RECORD DRAWINGS
02-24-10		ADDED RIGHT TURN LANE ON S.H. 205
07-17-09		SANITARY SEWER & ADA ROUTE REVISIONS
06-19-09		TXDOT COMMENTS

OWNER
 METROPLEX ACQUISITION FUND, LP
 8214 WESTCHESTER, SUITE 850
 DALLAS, TEXAS 75225
 MR. GREY STOGNER
 (214) 343-4477 PHONE
 (214) 340-2029 FAX

DEVELOPER
 CRESTVIEW REAL ESTATE, L.L.C.
 8214 WESTCHESTER, SUITE 850
 DALLAS, TEXAS 75225
 MR. GREY STOGNER
 (214) 343-4477 PHONE
 (214) 340-2029 FAX

THE SEAL APPEARING ON THIS DOCUMENT WAS AUTHORIZED BY BRANDON E. COX, P.E. 10/01/09 ON 02-24-09 ALTERATION OF A SEALED DOCUMENT WITHOUT PROPER NOTIFICATION TO THE RESPONSIBLE ENGINEER IS AN OFFENSE UNDER THE TEXAS ENGINEERING PRACTICE ACT.

Brandon E. Cox 02-24-09

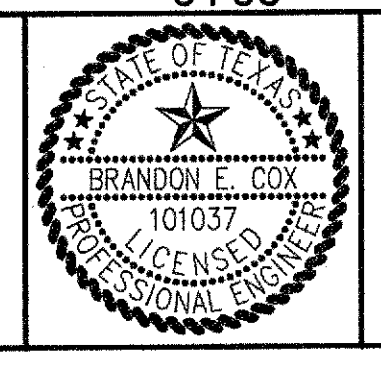

POGUE
 ENGINEERING & DEVELOPMENT COMPANY, INC.
 1512 BRAY CENTRAL DRIVE SUITE 100 MCKINNEY, TEXAS 75069
 (214) 544-8880 PHONE (214) 544-8882 FAX
 www.PogueEngineering.com

PAVING PLAN & PROFILE
 STONE CREEK RETAIL
 BLOCK A, LOTS 1-6, STONE CREEK RETAIL ADDITION
 W.T. DEWEESE SURVEY, ABSTRACT NO. 71
 CITY OF ROCKWALL, TEXAS

SHEET NO. C1.04

T:\Williams 04/29/2010 - 3:41PM N:\JONES\1393\1393-08-087\DWG\1393-08-087-07A.DWG © POGUE ENGINEERING & DEVELOPMENT COMPANY, INC. 2009. ALL RIGHTS RESERVED.

TEXAS BOARD OF PROFESSIONAL ENGINEERS, CERTIFICATE OF REGISTRATION #000491; TEXAS BOARD OF PROFESSIONAL LAND SURVEYING, CERTIFICATE OF REGISTRATION 100421-00