

DEVELOPMENT PLANS FOR STONE CREEK PHASE VIII CITY OF ROCKWALL, TEXAS

INDEX

1	TITLE
2	PLAT
3	EMERSON DRIVE
4	HARVARD DRIVE
5	NAKOMA DRIVE
6	MONTROSE DRIVE, MEMORIAL DRIVE
7	WANETA DRIVE
8	QUAIL RUN ROAD
9	QUAIL RUN ROAD CROSS SECTIONS
10	HAYS ROAD
11	HAYS ROAD
12	HAYS ROAD CROSS SECTIONS
12A	SIDEWALK RAMP DETAILS
13	WATER AND SANITARY SEWER PLAN
14	SANITARY SEWER PROFILES
15	SANITARY SEWER PROFILES
16	EXISTING CONDITIONS DRAINAGE AREA MAP
17	DRAINAGE AREA MAP
17A	INTERIM CONDITIONS DRAINAGE AREA MAP
18	DRAINAGE CALCULATIONS
19	STORM SEWER PLAN AND PROFILE LINES 'D-1' & 'D-2'
20	STORM SEWER PLAN AND PROFILE LINE 'D-3'
21	STORM SEWER PLAN AND PROFILE LINE 'D-4'
22	STORM SEWER PLAN AND PROFILE LINE 'D-7'
23	STORM SEWER PLAN AND PROFILE LINE 'D-5'
24	STORM SEWER PROFILES
25	GRADING PLAN
26	EROSION CONTROL PLAN
27	SIGN AND LIGHT PLAN
28	QUAIL RUN ROAD TRAFFIC SIGNAGE PLAN
29	HAYS ROAD TRAFFIC SIGNAGE PLAN
30	PHASE 1 DETOUR PLAN - HAYS ROAD CLOSURE
31	PHASE 2 DETOUR PLAN - QUAIL RUN CLOSURE
32	PHASE 3 DETOUR PLAN - QUAIL RUN CLOSURE

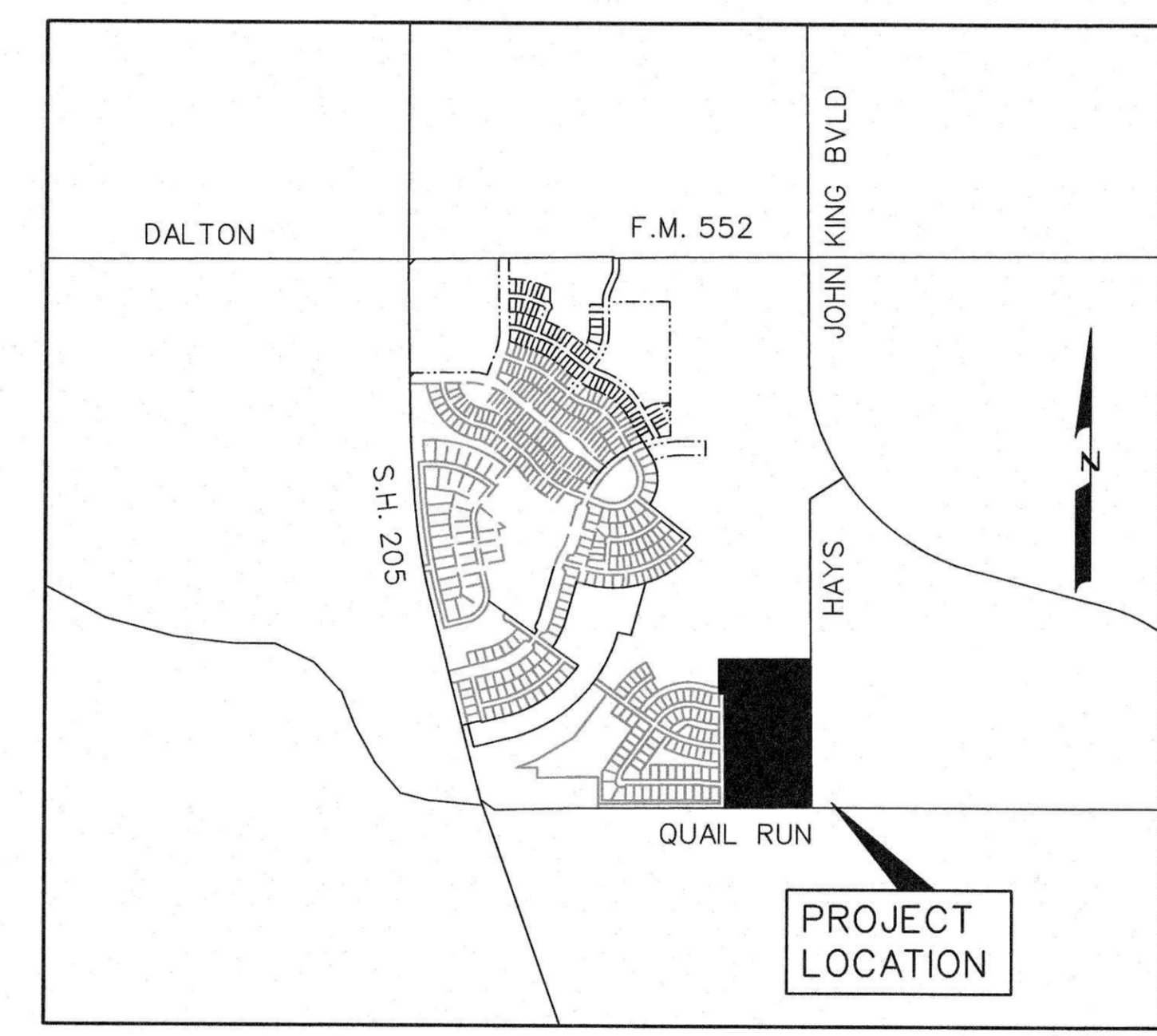

LOCATION MAP

PREPARED FOR
STONE CREEK PHASE 8, LTD.
8214 WESTCHESTER DRIVE, SUITE 710, DALLAS, TEXAS 75225

CORWIN ENGINEERING, INC. — CONSULTING ENGINEERS

200 W. BELMONT, SUITE E

TBPE FIRM #5951

ALLEN, TEXAS 75013

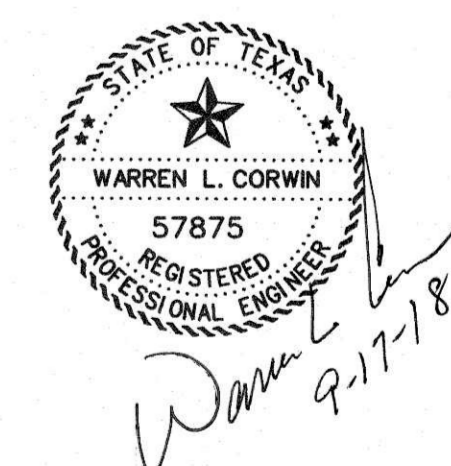

BENCHMARK:
CITY OF ROCKWALL SURVEY MONUMENT ON AN INLET
AT THE NORTHWEST CORNER OF FEATHERSTONE DR. AND
HARVARD DR.
ELEV. = 525.31

AS-BUILT SEPTEMBER 2018
INFORMATION PROVIDED
BY CONTRACTORS
(NOT FIELD VERIFIED)

NOTE:
CITY OF ROCKWALL STANDARDS
AND NCTCOG 3rd ADDITION STANDARDS
SHALL BE USED FOR REFERENCE.

NO.	REVISIONS	DATE