

△ = 89°27'46"
R = 80.00'
T = 79.25'
L = 124.91'

TOP TxDOT CONC. MARKER S. CUT BACK CORNER
OF THE INTER. OF ST. HWY. No. 276 & F.M. 549
ELEV. = 595.27

TOP TxDOT CONC. MARKER S. SIDE OF ST. HWY No. 276
1643' ± EAST OF THE INTER. OF ST. HWY No. 276
AND F.M. HIGHWAY No. 549
ELEV. = 604.75

LOW POINT ELEV = 594.66
LOW POINT STA = 26+42.86
PVI STA = 26+00
PVI ELEV = 594.40

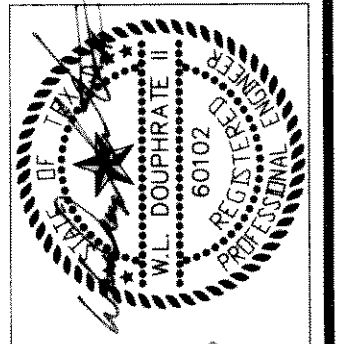
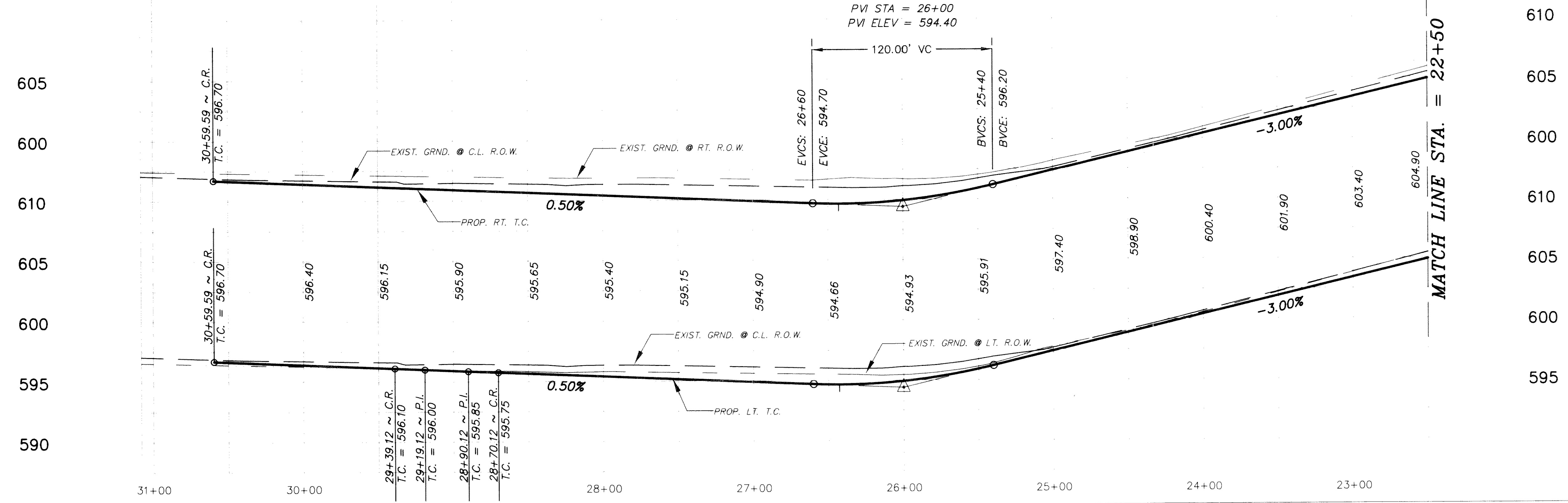

THE SEAL APPEARING ON THIS SHEET IS THE PROPERTY OF W.L. DOUPHRATE II, NO. 60102 ON 11/25/96

DOUPHRATE & ASSOCIATES
ENGINEERING - SURVEYING - CONSTRUCTION MANAGEMENT

P.O. BOX 1336
ROCKWALL, TEXAS 75087
PHONE: (972)771-8686

PAVING PLAN & PROFILE
DIAMOND WAY DRIVE & STERLING CT.
STERLING FARMS ADDITION
ROCKWALL COUNTY, TEXAS

REVISION	
CHECKED	W.L.D.
DRAWN	ACAD
DATE	11-25-96
PROJECT	96002PV3
OF	13