

SCALES:
 1" = 20' HOR
 1" = 4' VER

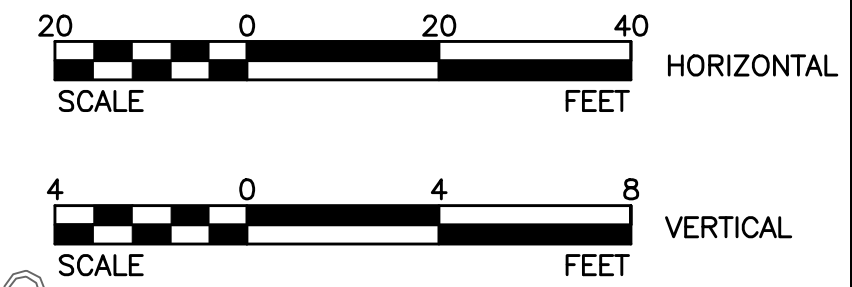

General Notes

- EXISTING UTILITY LOCATIONS AND/OR MATERIALS SHOWN ON THE PLANS ARE APPROXIMATE. THE CONTRACTOR IS HEREBY NOTIFIED THAT ALL EXISTING UTILITIES, WHETHER BURIED OR OVERHEAD, MAY OR MAY NOT BE SHOWN AND THAT THE CONTRACTOR IS RESPONSIBLE FOR LOCATING AND PROTECTING ALL UTILITIES WITHIN THE PROJECT AREA. THE CONTRACTOR SHALL ALSO BE RESPONSIBLE FOR REPAIRING AND/OR REPLACING ANY AND ALL UTILITIES DAMAGED BY THE CONTRACTOR'S OPERATIONS AND THE COST(S) FOR WHICH SHALL BE BORNE BY THE CONTRACTOR.
- THE CONTRACTOR IS HEREBY NOTIFIED THAT DANGEROUS UTILITIES MAY EXIST IN THE PROJECT AREA. THESE MAY INCLUDE BUT ARE NOT LIMITED TO: OVERHEAD OR UNDERGROUND ELECTRIC LINES, TELEPHONE LINES, FIBEROPTIC LINES, AND GAS LINES.
- THE CONTRACTOR SHALL NOTIFY THE CITY ENGINEERING DEPT. (936-569-2516) FOR INSPECTION PRIOR TO COVERING UNDERGROUND IMPROVEMENTS, BEFORE POURING BUILDING SLABS, OR MAKING ANY UTILITY TAPS OR CURB CUTS.
- THIS IS NOT A BOUNDARY SURVEY.
- THE CONTRACTOR IS RESPONSIBLE FOR PROVIDING EROSION CONTROL (SILT FENCING) ON ALL DOWNHILL SLOPE AREAS OF THIS SITE.
- ALL MANHOLES SHALL BE WATERTIGHT WITH WATERTIGHT COVER ASSEMBLIES.
- ALL PVC SEWER MAIN SHALL BE ASTM D-3034 SDR-26.
- SEE UTILITY PLAN SHEET(S) FOR DETAILS ON SANITARY SERVICE LINES.

No.	Revision/Issue	Date
6	REVISIONS PER HUD COMMENTS	04/05/10
4	ISSUED FOR PERMIT	02/10/10
3	ISSUED FOR FINAL REVIEW	01/28/10
2	REVISIONS PER CITY COMMENTS	08/12/08
1	FOR BIDDING	07/15/08
	PLAN REVIEW - CITY	07/01/08

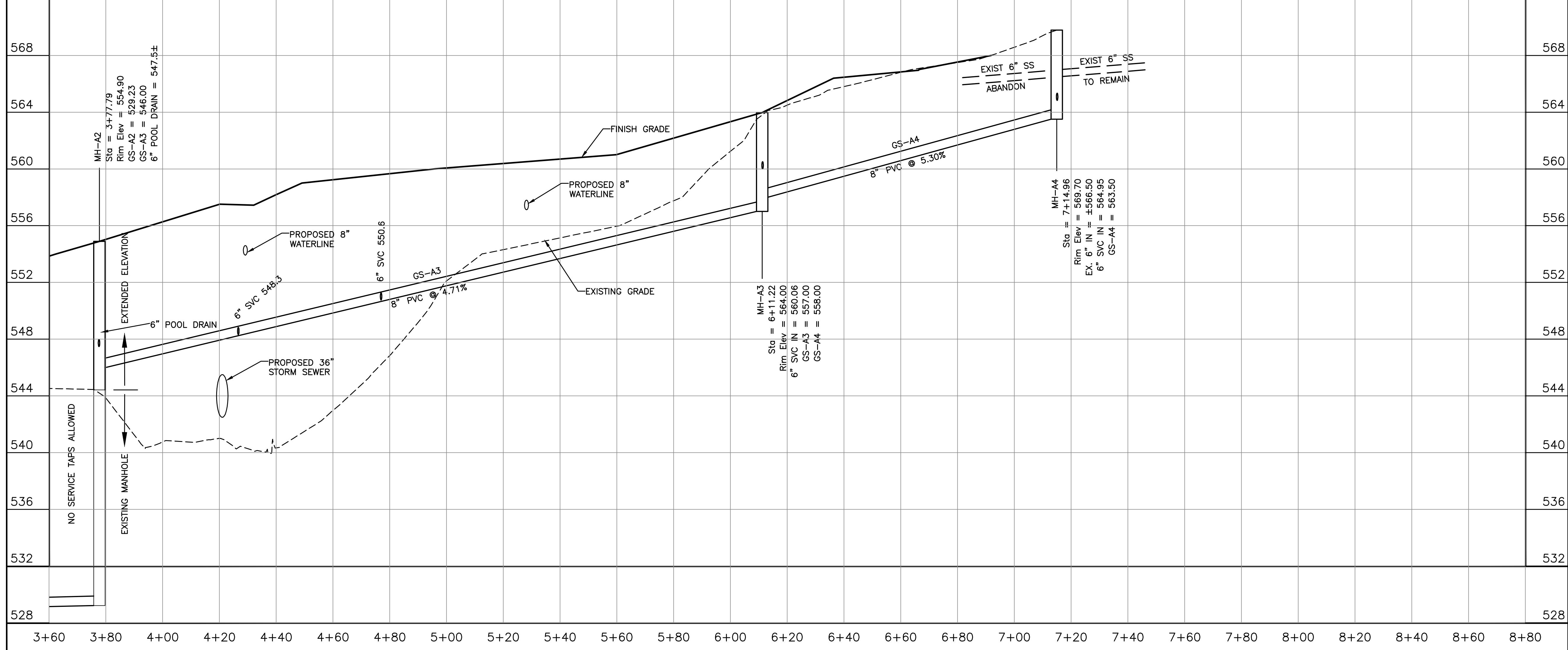

BarWin CONSULTANTS
 ENGINEERS SURVEYORS
 412 NORTH STREET
 NACOGDOCHES, TEXAS 75961
 (936) 569-0668 FAX (936) 569-9465
 TPE REGISTRATION F-1713

Engineer Seal:

 05/19/2011

Project Name:
SONOMA COURT APARTMENTS
SANITARY SEWER LINE A
STA 3+60 TO 7+14.96
ROCKWALL, TEXAS

Scale: AS SHOWN	Issue Date: 05/19/2011
Drawn By: CD HAYS	Checked By: CD HAYS
File: SS020201.dwg	Drawing No. CU-702

AS-BUILT
 To the best of our knowledge BARWIN CONSULTANTS, hereby states that this plan is As-Built. This information provided is based on site measurements, survey data and information provided by the contractor.