

NOTES:

1. THIS SITE PLAN IS PROVIDED TO ILLUSTRATE OVERALL SITE LAYOUT CONCEPTS. FOR ADDITIONAL DETAIL PLEASE REFER TO THE APPROPRIATE DETAIL SHEET(S) FOR THE DESIRED PHASE OF CONSTRUCTION (GRADING, DRAINAGE, UTILITIES, ETC.).
2. FOR THE CLARITY PURPOSES, PROPOSED SITE CONTOURS HAVE BEEN OMITTED FROM THIS DRAWING. PLEASE SEE THE GRADING PLAN SHEET(S) FOR THIS INFORMATION.
3. EASEMENTS SHOWN ON THIS DRAWING ARE FOR REFERENCE ONLY. PLEASE REFER TO THE SURVEY PLAT FOR THIS DEVELOPMENT.

REPLAT OF LOT 2R, BLOCK A
CANYON RIDGE-CANYON RANCH
B.J.T. LEWIS SURVEY A-225
CITY OF ROCKWALL, ROCKWALL COUNTY, TEXAS

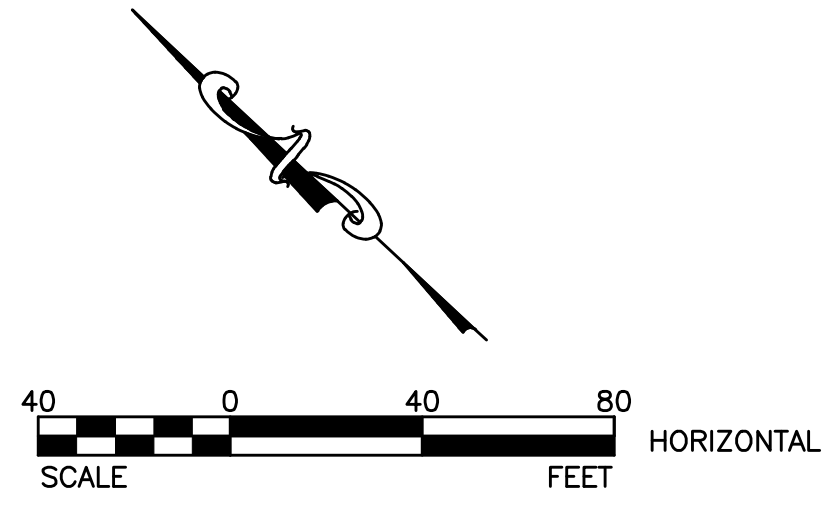

LEGEND

SYMBOL	EXISTING FEATURE	SYMBOL	EXISTING FEATURE
△	SURVEY TRAVERSE POINT	⊠	ELECTRIC TOWER
⊙	CONCRETE MONUMENT	⊠	GAS METER
⊕	TEMPORARY BENCH MARK	⊠	GAS VALVE
⊕	FOUND PROPERTY CORNER	—	GUY WIRE
⊕	MANHOLE SS	—	PROPOSED WATER LINE
⊕	MANHOLE SD	—	PROPOSED AERIAL TELEPHONE LINE
—	CLEAN OUT	—	PROPOSED UNDERGROUND ELECTRICAL LINE
—	FIRE HYDRANT	—	PROPOSED UNDERGROUND TELEPHONE LINE
—	WATER METER	—	PROPOSED UNDERGROUND FIBER OPTIC LINE
—	WATER VALVE	—	PROPOSED UNDERGROUND CABLE
—	IRRIGATION CONTROL VALVE	—	PROPOSED GAS LINE
—	TELEPHONE PED	—	PROPOSED AERIAL ELECTRIC LINE
—	MAIL BOX	—	PROPOSED AERIAL UTILITY LINE
—	SIGN	—	PROPOSED SANITARY SEWER LINE
—	FIRE HYDRANT	—	PROPOSED FORCE MAIN
—	POWER POLE	—	PROPOSED STORM DRAIN
—	LIGHT POLE	—	PROPOSED FENCE
—	METER POLE	—	PROPOSED RETAINING WALL
—	ELECTRIC METER	—	PROPOSED EASEMENT (AS NOTED)
—	ELECTRIC BOX/TRANSFORMER		

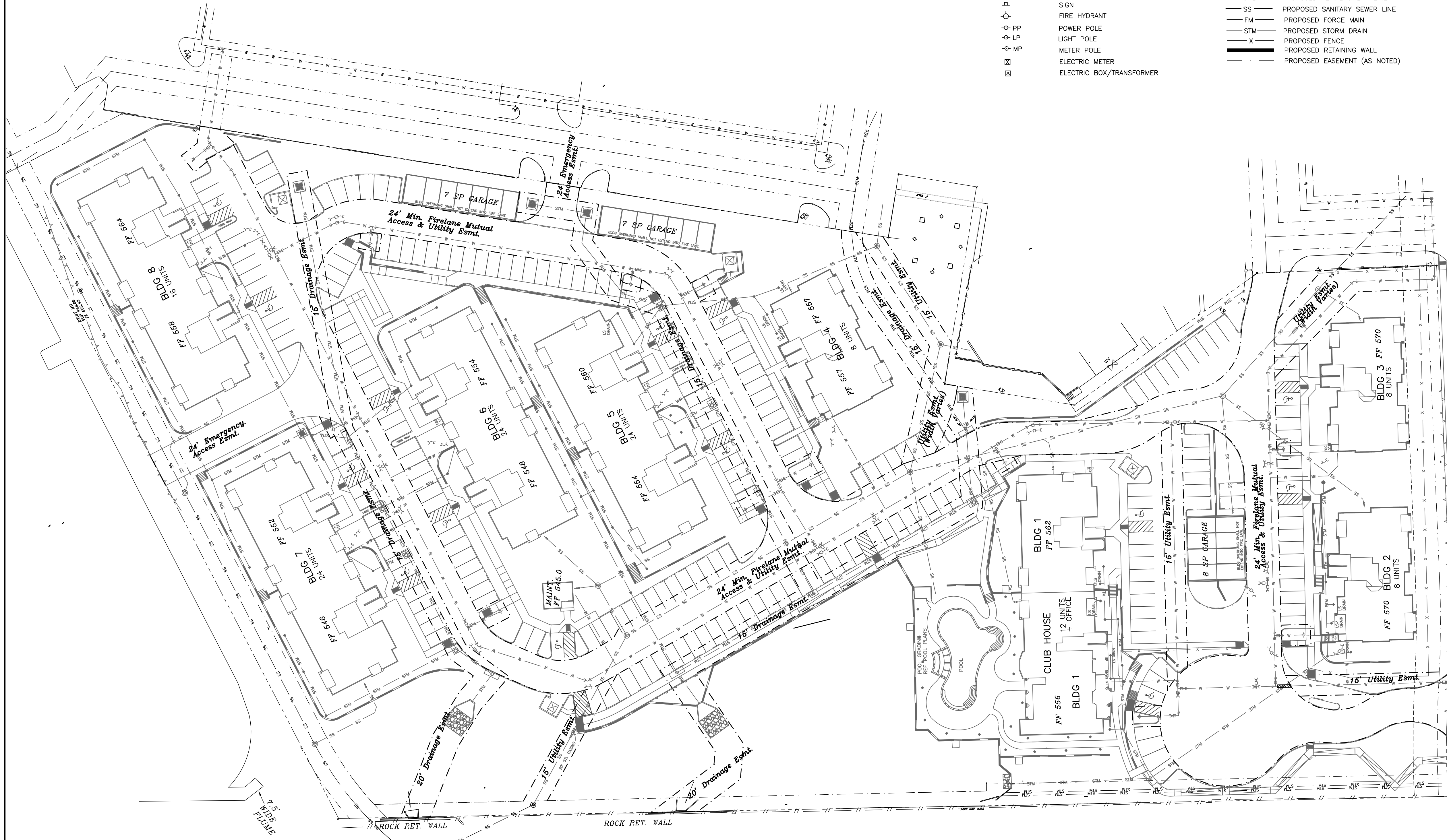

General Notes

1. EXISTING UTILITY LOCATIONS AND/OR MATERIALS SHOWN ON THE PLANS ARE APPROXIMATE. THE CONTRACTOR IS HEREBY NOTIFIED THAT ALL EXISTING UTILITIES, WHETHER BURIED OR OVERHEAD, MAY OR MAY NOT BE SHOWN AND THAT THE CONTRACTOR IS RESPONSIBLE FOR LOCATING AND PROTECTING ALL UTILITIES WITHIN THE PROJECT AREA. THE CONTRACTOR SHALL ALSO BE RESPONSIBLE FOR REPAIRING AND/OR REPLACING ANY AND ALL UTILITIES DAMAGED BY THE CONTRACTOR'S OPERATIONS AND THE COST(S) FOR WHICH SHALL BE BORNE BY THE CONTRACTOR.
2. THE CONTRACTOR IS HEREBY NOTIFIED THAT DANGEROUS UTILITIES MAY EXIST IN THE PROJECT AREA. THESE MAY INCLUDE BUT ARE NOT LIMITED TO: OVERHEAD OR UNDERGROUND ELECTRIC LINES, TELEPHONE LINES, FIBEROPTIC LINES, AND GAS LINES.
3. THE CONTRACTOR SHALL NOTIFY THE CITY ENGINEERING DEPT. (972-771-7746) FOR INSPECTION PRIOR TO COVERING UNDERGROUND IMPROVEMENTS, BEFORE POURING BUILDING SLABS, OR MAKING ANY UTILITY TAPS OR CURB CUTS.
4. THIS IS NOT A BOUNDARY SURVEY.
5. THE CONTRACTOR IS RESPONSIBLE FOR PROVIDING EROSION CONTROL (SILT FENCING) ON ALL DOWNHILL SLOPE AREAS OF THIS SITE.

No.	Revision/Issue	Date
6	REVISIONS PER HUD COMMENTS	04/05/10
5	ISSUED FOR PERMIT	02/10/10
4	ISSUED FOR FINAL REVIEW	01/28/10
3	REVISIONS PER CITY COMMENTS	09/19/08
2	REVISIONS PER CITY COMMENTS	08/12/08
1	FOR BIDDING	07/15/08
	PLAN REVIEW - CITY	07/01/08

BarWin
CONSULTANTS
ENGINEERS SURVEYORS

412 NORTH STREET
NACOGDOCHES, TEXAS 75961
(936) 569-0668 FAX (936) 569-9465
TOLPE REGISTRATION F-1713

Engineer Seal:



05/19/2011

Project Name:
SONOMA COURT APARTMENTS
SITE PLAN
ROCKWALL, TEXAS

Scale: AS SHOWN	Issue Date: 05/19/2011
Drawn By: ALB	Checked By: SRB
File: 3950_200.dwg	Drawing No. CS-102

AS-BUILT

To the best of our knowledge BARWIN CONSULTANTS, hereby states that this plan is As-Built. This information provided is based on site measurements, survey data and information provided by the contractor.