

SCALE IN FEET
1" = 40'

LEGEND:
AS-BUILT TOPO
ELEVATION SPOT x 854
TOE x 463.948

NOTE: EFFECTIVE ZONE A FLOODPLAIN PER FIRM NO. 43897C0040L, EFFECTIVE 09-29-2008.

100 YEAR FLOOD ELEVATION PER THE STUDY BY DAVID MCLENDON, P.E. THE STUDY INCORPORATES DETENTION FOR THE DEVELOPABLE PORTION OF THIS PROPERTY AT FULLY DEVELOPED CONDITIONS.

- NOTES:
- 1.) ALL FILL TO BE COMPACTED TO 95% STANDARD DENSITY WITH A SHEEP'S FOOT ROLLER.
 - 2.) ANY AREA DISTURBED IN POST-PROJECT 100-YEAR FLOODPLAIN TO HAVE EITHER SOD OR ANCHORED SEEDED CURLEX. (AS SHOWN ON EROSION CONTROL PLAN)
 - 3.) 75-80% OF ALL DISTURBED AREA TO HAVE A MINIMUM 1" STAND OF GRASS ESTABLISHED PRIOR TO CITY ACCEPTANCE.

TOPOGRAPHIC SURVEY PERFORMED BY H.D. FETTY LAND SURVEYORS, LLC, DATED SEPTEMBER 9, 2013 (#20130299)

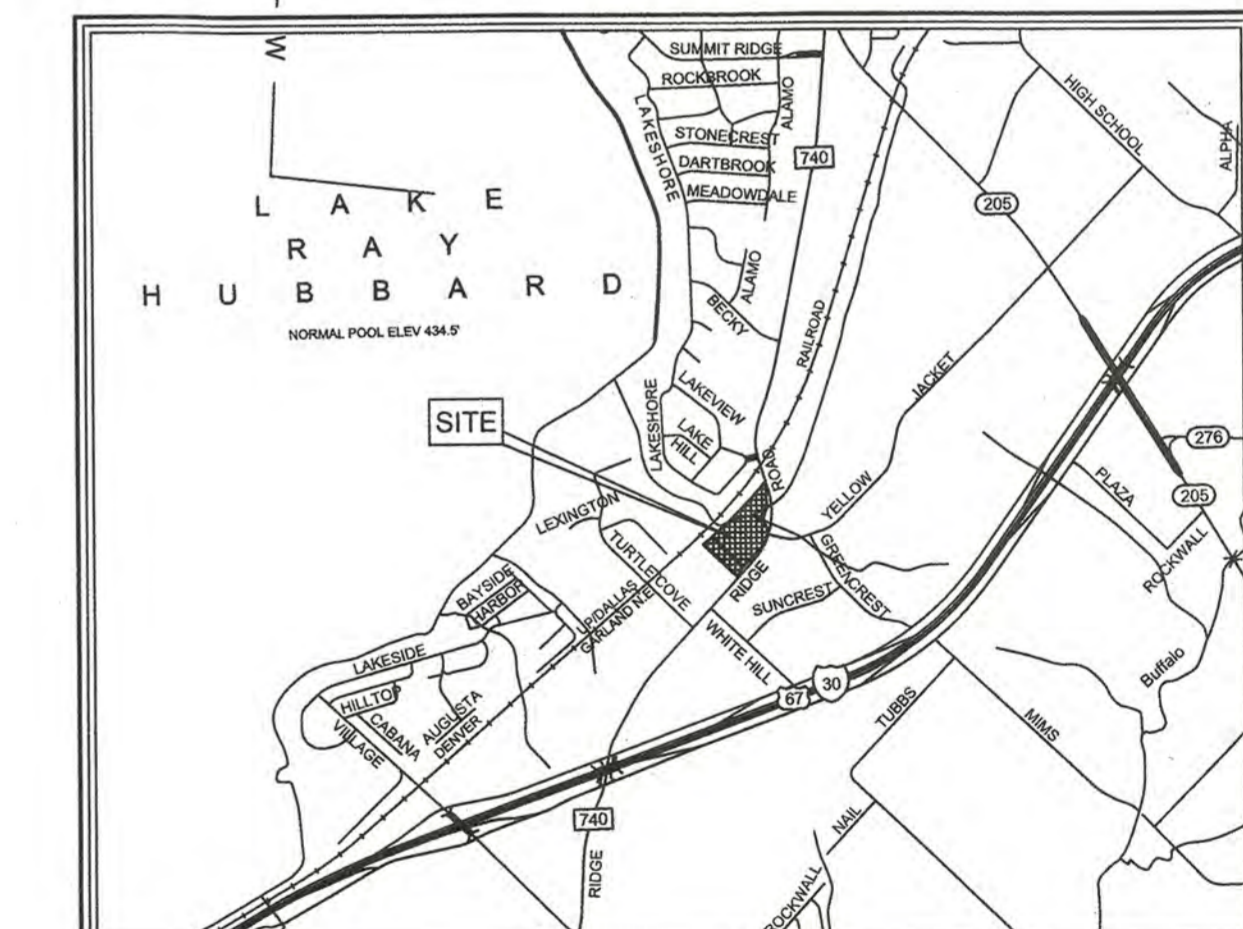

RECORD DRAWINGS

To the best of our knowledge Engineering Concepts & Design, L.P., hereby states that this plan is As-Built. This information provided is based on surveying at the site and information provided by the contractor.

Todd Winters 11-22-17
TODD WINTERS DATE

OWNER:
SKY INVESTMENT PROPERTY
MIKE SWERCINSKY
106 E. RUSK, STE. 200
ROCKWALL, TX 75087

BENCHMARKS: CITY OF ROCKWALL, TEXAS - CONTROL MONUMENTATION

MON. R005-1 N: 7023593.75795; E: 2594175.58258; ELEVATION: 578.6314.
RESET CONCRETE MONUMENT W/BRASS CAP LOCATED IN MEDIAN OF SUMMIT RIDGE DRIVE INTERSECTING F.M. HWY. No. 740.

MON. R007 N: 7013837.484; E: 2595453.327; ELEVATION: 566.223.
BEING LOCATED ON THE EAST SIDE OF INTERSECTION I-30 SOUTH SERVICE ROAD & MIMS ROAD.

ENGINEERINGCONCEPTS
& DESIGN, L.P.

ENGINEERING / PROJECT MANAGEMENT /
CONSTRUCTION SERVICES - FIRM REG. #F-001145
201 WINDCO CIR, STE 200, WYLLIE, TX 75098
972-941-8400 FAX: 972-941-8401 WWW.ECDLP.COM

| | |
|-----------------------------------------------|------------------------|
| REVISIONS: 2016-03-23 REVISED TO BALANCE SITE | DATE: OCTOBER 14, 2016 |
| 2017-03-07 REVISED TO BALANCE NORTH SIDE | DATE: |
| 2017-05-25 AS-BUILT GRADING PLAN | |
| DRAWN: TONY | DATE: OCTOBER 14, 2016 |
| CHECKED: TW | DATE: |
| PROJECT NO.: 3775 | |
| DWG FILE NAME: | |

THIS DOCUMENT IS RELEASED FOR THE PURPOSE OF CONSTRUCTION.



FLOODPLAIN GRADING PLAN
RIDGE ROAD AND YELLOW JACKET
7.045 ACRES, E P G CHISUM SURVEY, A-0064
CITY OF ROCKWALL, ROCKWALL COUNTY, TEXAS

SHEET
1