

Shoreline Plaza\_07\_Prop\_Drain\_Area\_Map.sht  
 PLOTTED BY: David  
 2/22/2008 10:45:01 AM

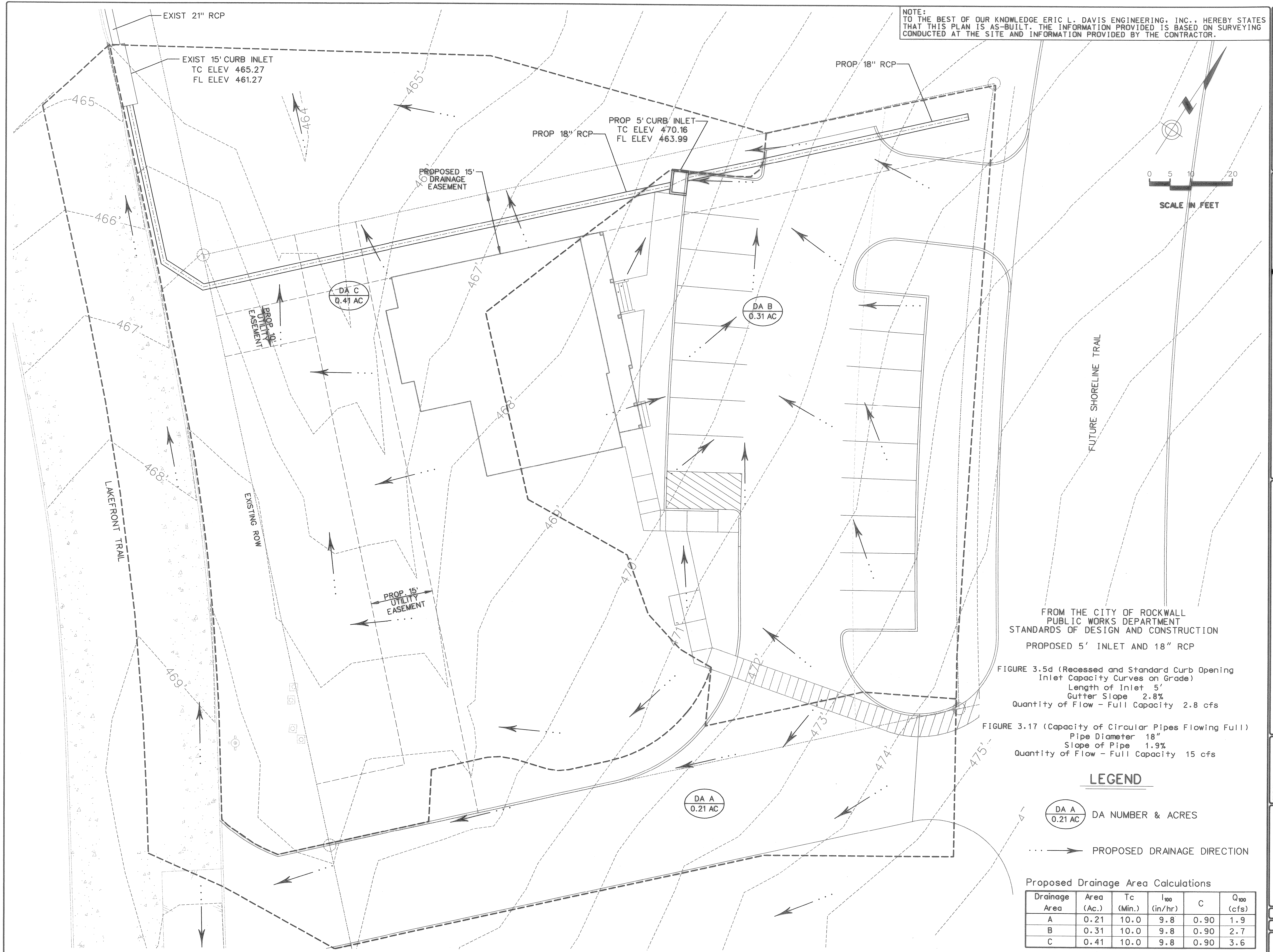

NOTE:  
 TO THE BEST OF OUR KNOWLEDGE ERIC L. DAVIS ENGINEERING, INC., HEREBY STATES  
 THAT THIS PLAN IS AS-BUILT. THE INFORMATION PROVIDED IS BASED ON SURVEYING  
 CONDUCTED AT THE SITE AND INFORMATION PROVIDED BY THE CONTRACTOR.

DATE	REV	REVISION

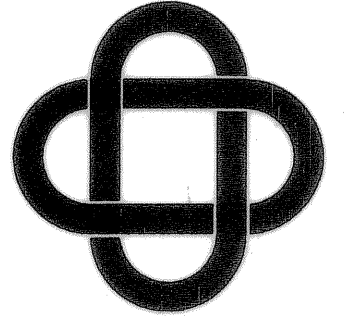

ERIC L. DAVIS  
 ENGINEERING, INC.  
 425 Pinson Road Ste. G  
 Forney, Texas 75126  
 972/564-0592 Fax 972/564-6523  
 E-Mail ericdavis@engineering.com

**PROPOSED DRAINAGE  
 AREA MAP**  
 SHORELINE PLAZA  
 CITY OF ROCKWALL, ROCKWALL CO, TEXAS

FROM THE CITY OF ROCKWALL  
 PUBLIC WORKS DEPARTMENT  
 STANDARDS OF DESIGN AND CONSTRUCTION  
 PROPOSED 5' INLET AND 18" RCP

FIGURE 3.5d (Recessed and Standard Curb Opening  
 Inlet Capacity Curves on Grade)  
 Length of Inlet 5'  
 Gutter Slope 2.8%  
 Quantity of Flow - Full Capacity 2.8 cfs

FIGURE 3.17 (Capacity of Circular Pipes Flowing Full)  
 Pipe Diameter 18"  
 Slope of Pipe 1.9%  
 Quantity of Flow - Full Capacity 15 cfs

**LEGEND**

- DA NUMBER & ACRES
- PROPOSED DRAINAGE DIRECTION

Proposed Drainage Area Calculations

Drainage Area	Area (Ac.)	Tc (Min.)	I <sub>100</sub> (in/hr)	C	Q <sub>100</sub> (cfs)
A	0.21	10.0	9.8	0.90	1.9
B	0.31	10.0	9.8	0.90	2.7
C	0.41	10.0	9.8	0.90	3.6

DEVELOPER:	
JOB NO.:	
DRAWN BY:	
CHECKED BY:	
DATE:	

**AS-BUILT**

SCALE: 1"=10'  
 SHEET 7 OF 14  
 SHEET 7