

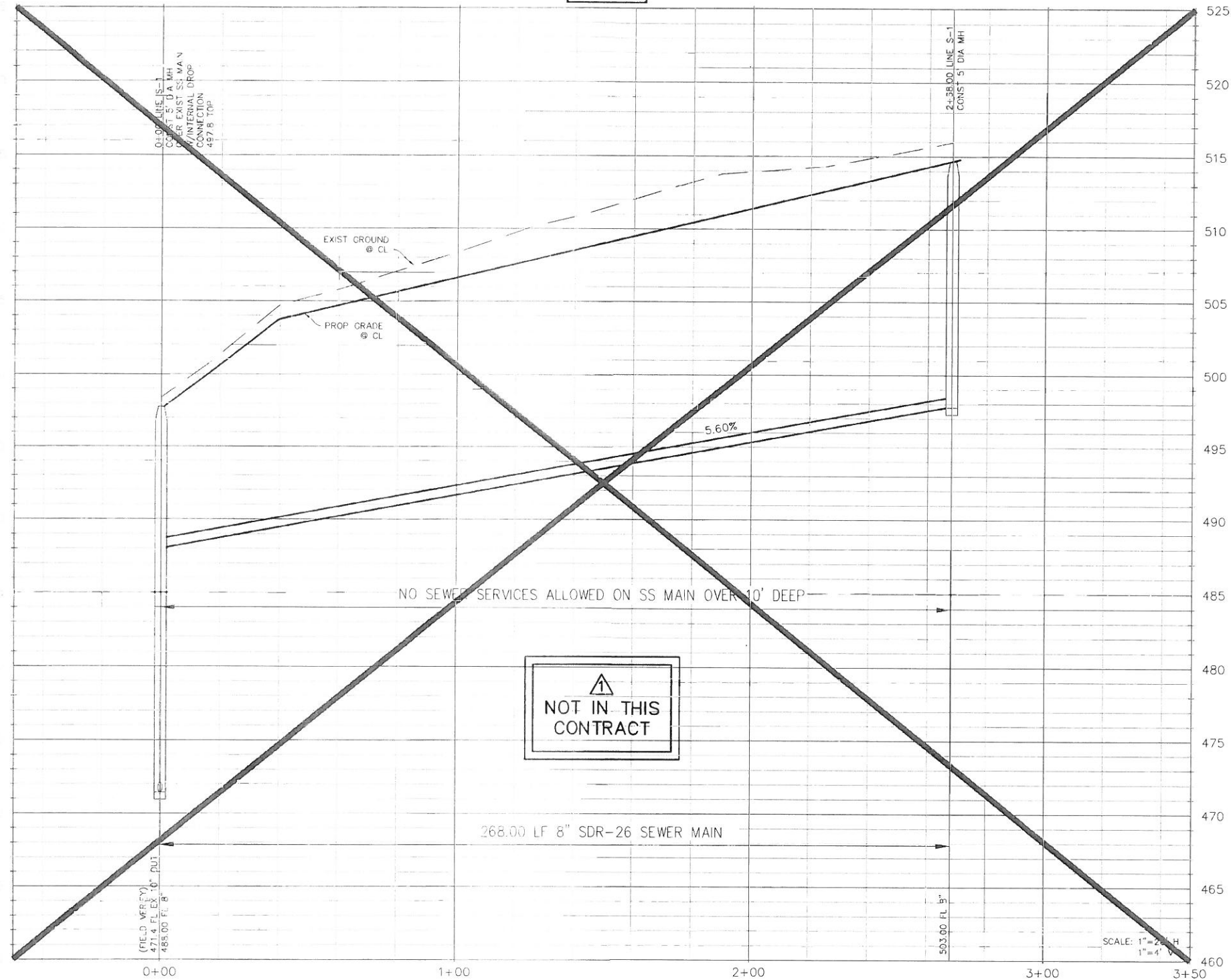

**LINE S-1**



- NOTES:
1. ALL CONSTRUCTION SHALL CONFORM TO STANDARD SPECIFICATIONS FOR PUBLIC WORKS CONSTRUCTION NORTH CENTRAL TEXAS, FOURTH EDITION AND CITY OF ROCKWALL STANDARDS OF DESIGN AND CONSTRUCTION.
  2. ALL RESPONSIBILITY FOR ADEQUACY OF DESIGN REMAINS WITH THE DESIGN ENGINEER. THE CITY OF ROCKWALL, IN REVIEWING AND RELEASING PLANS FOR CONSTRUCTION, ASSUMES NO RESPONSIBILITY FOR ADEQUACY OR ACCURACY OF DESIGN.

  
**NOT IN THIS CONTRACT**

NO SEWER SERVICES ALLOWED ON SS MAIN OVER 10' DEEP

268.00 LF 8" SDR-26 SEWER MAIN

SCALE: 1" = 20' H  
1" = 4' V

 04/14/19 DELETED SEWER MAIN ON CARMEL CIRCLE.

REVISION  
APR 28 2019

PROFESSIONAL ENGINEER/DESIGNER  
*Archie Hager* 5-16-19



April 14, 2019

**RECORD DRAWING**  
TO THE BEST OF OUR KNOWLEDGE, USA PROFESSIONAL SERVICES GROUP, INC. HEREBY STATES THAT THIS RECORD DRAWING IS BASED ON VISUAL SITE OBSERVATIONS, SURVEY INFORMATION, AND INFORMATION PROVIDED BY THE CONTRACTOR.  
*Greg S. Smiley*  
DATE: JUNE 16, 2020

- BENCHMARKS:**
- #1 "□" CUT ON EXISTING "Y" INLET ±74' FROM THE NORTHWEST CORNER OF PROPERTY. ELEV. 493.46
  - #2 "□" CUT ON BACK OF CURB ±12' IN FRONT OF EXISTING SANITARY SEWER MANHOLE ±66' FROM THE NORTHEAST CORNER OR PROPERTY LINE. ELEV. 497.98

13  
15

<b>SANITARY SEWER PROFILE</b>	
SHIFMAN OFFICE BUILDING	
CITY OF ROCKWALL	
ROCKWALL COUNTY, TEXAS	
USA PROFESSIONAL SERVICES GROUP, INC. 1525 VICEROY DRIVE, DALLAS, TX 75225 214-634-3300 PHONE, 214-634-3336 FAX REGISTERED ENGINEERING FIRM T-1845 REGISTERED SURVEYING FIRM 101074-00	USA JOB NUMBER <b>2018006.00</b>