

2 - GRATE INLET CAPACITIES	
DEPTH (FT.)	INLET CAPACITY (CFS)
0.2	2.38
0.3	3.25
0.4	3.80
0.5	4.22
0.6	4.63

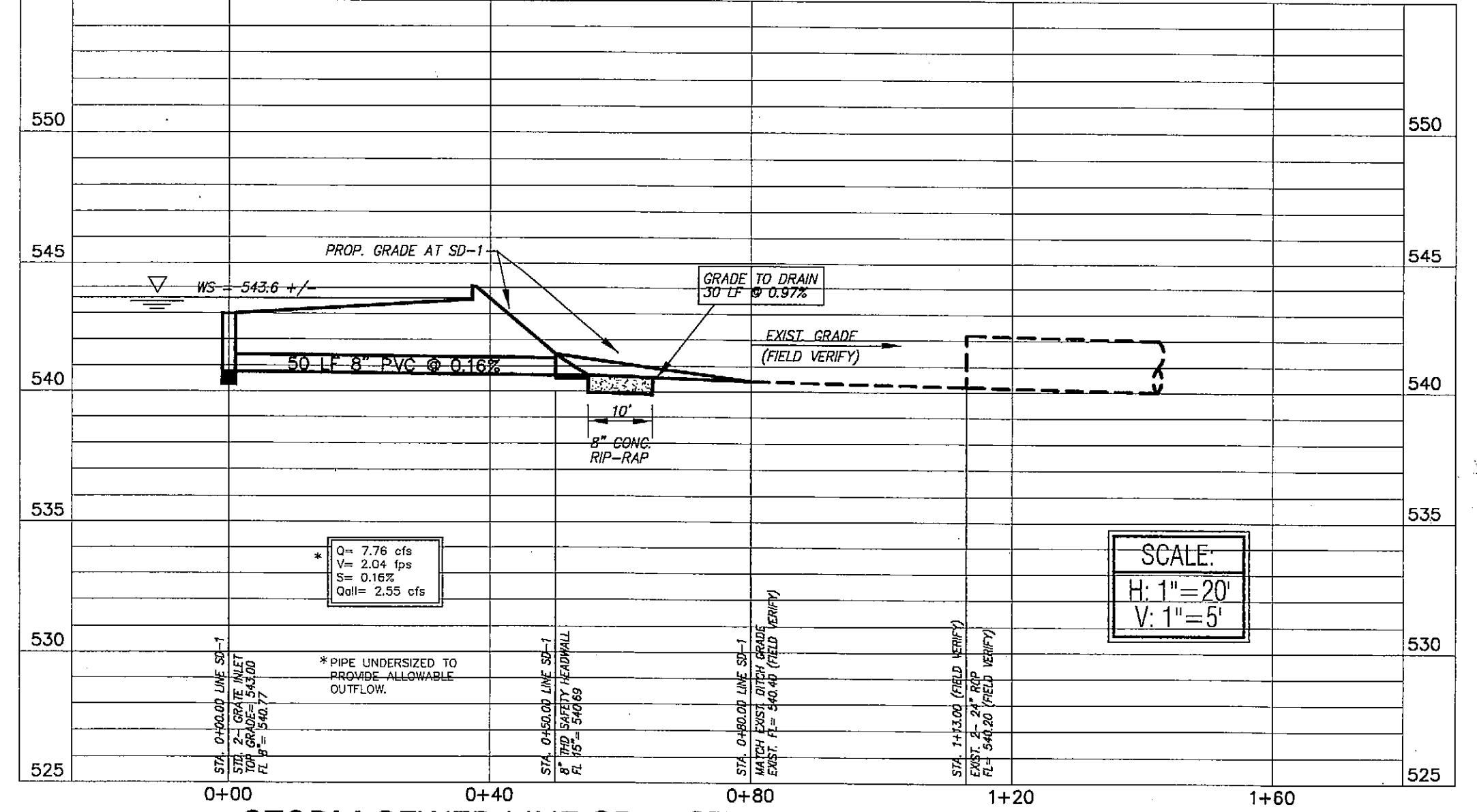

STORM SEWER LINE SD-1 STA. 0+00.00 TO STA. 1+13.00

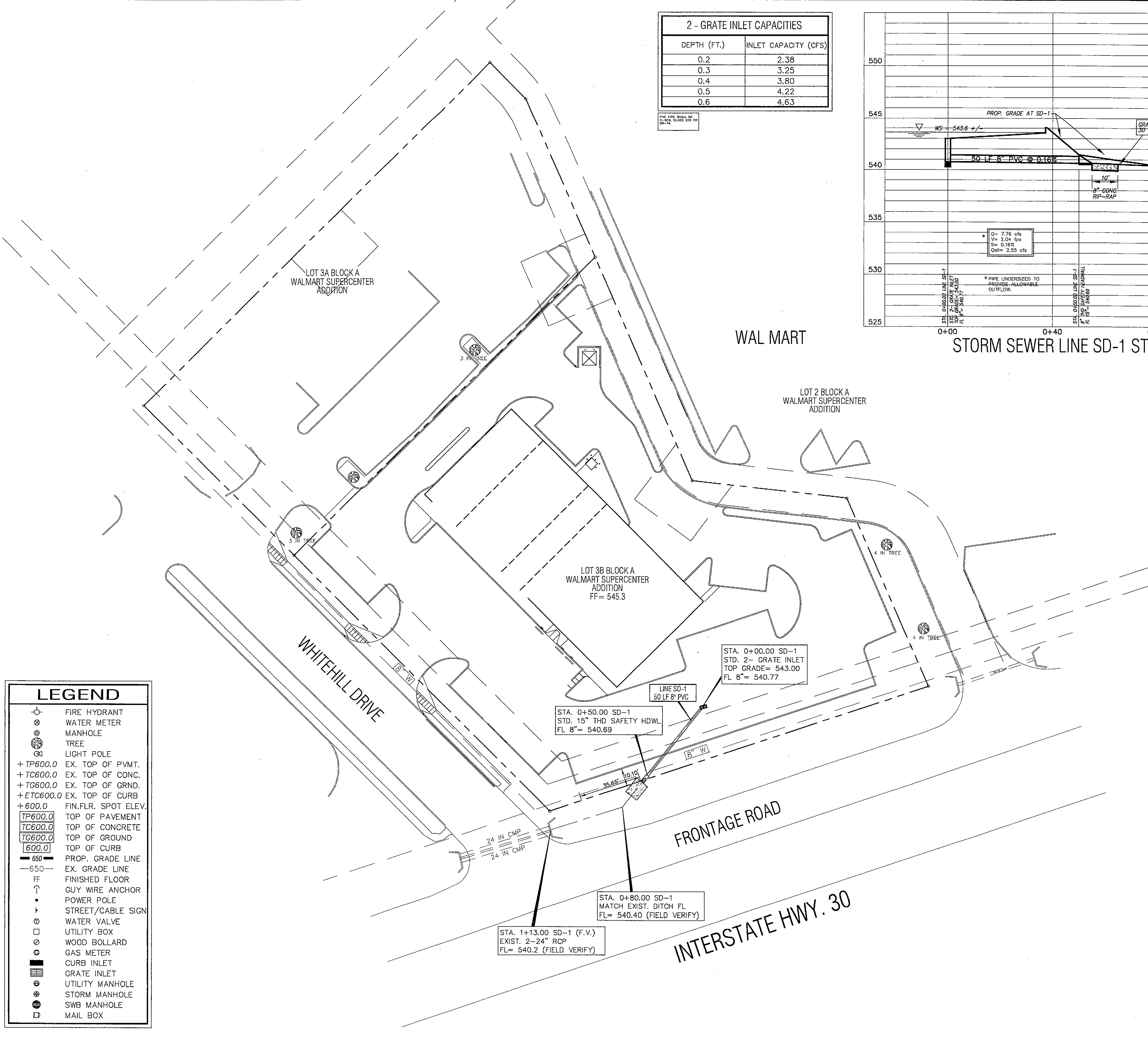

LEGEND	
	FIRE HYDRANT
	WATER METER
	MANHOLE
	TREE
	LIGHT POLE
+TP600.0	EX. TOP OF PVMT.
+TC600.0	EX. TOP OF CONC.
+TG600.0	EX. TOP OF GRND.
+ETC600.0	EX. TOP OF CURB
+600.0	FIN. FLR. SPOT ELEV.
TP600.0	TOP OF PAVEMENT
TC600.0	TOP OF CONCRETE
TG600.0	TOP OF GROUND
600.0	TOP OF CURB
650	PROP. GRADE LINE
-650	EX. GRADE LINE
FF	FINISHED FLOOR
↑	GUY WIRE ANCHOR
•	POWER POLE
+	STREET/CABLE SIGN
⊕	WATER VALVE
□	UTILITY BOX
⊙	WOOD BOLLARD
⊙	GAS METER
■	CURB INLET
■	GRATE INLET
⊙	UTILITY MANHOLE
⊙	STORM MANHOLE
⊙	SWB MANHOLE
⊙	MAIL BOX

dietz engineering

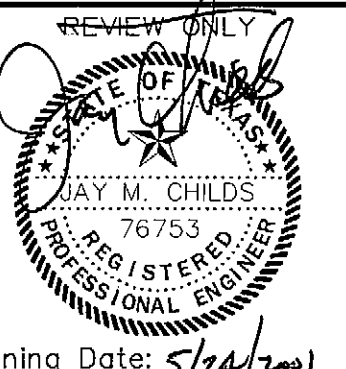

Signing Date: 5/24/2001  
**dietz engineering**  
 811 e. plano parkway  
 suite 109  
 plano, texas 75074  
 voice: 972 633-8867  
 fax: 972 633-1327  
 Drawn By: LL  
 Checked By: JMC  
 Revisions:

**SITE RETAIL**  
 STORM SEWER PLAN  
 PLAN VIEW  
 for the  
 City of Rockwall, Texas



NORTH

24"x36" Scale: 1" = 30'  
 11"x17" Scale: 1" = 60'  
 Vertical Scale: NA  
 Project Num: E-SPC-001  
 Issue Date: 24 MAY 2001  
 Sheet Title:  
**STORM SEWER**  
 Sheet No.:

**AS-BUILT**

**BENCHMARK:**  
 SQUARE CUT ON NORTH CORNER OF INLET ON EAST SIDE OF TACO BUENO.  
 ELEVATION = 541.75

**C1.07**