

**HAROLD L. EVANS**  
CONSULTING ENGINEER  
P.O. BOX 570355  
2331 CUS THOMASSON ROAD, SUITE 102  
DALLAS, TEXAS 75370, (214) 328-8133

SCALE	DATE	JOB No.
1" = 30'	3/12/03	02060

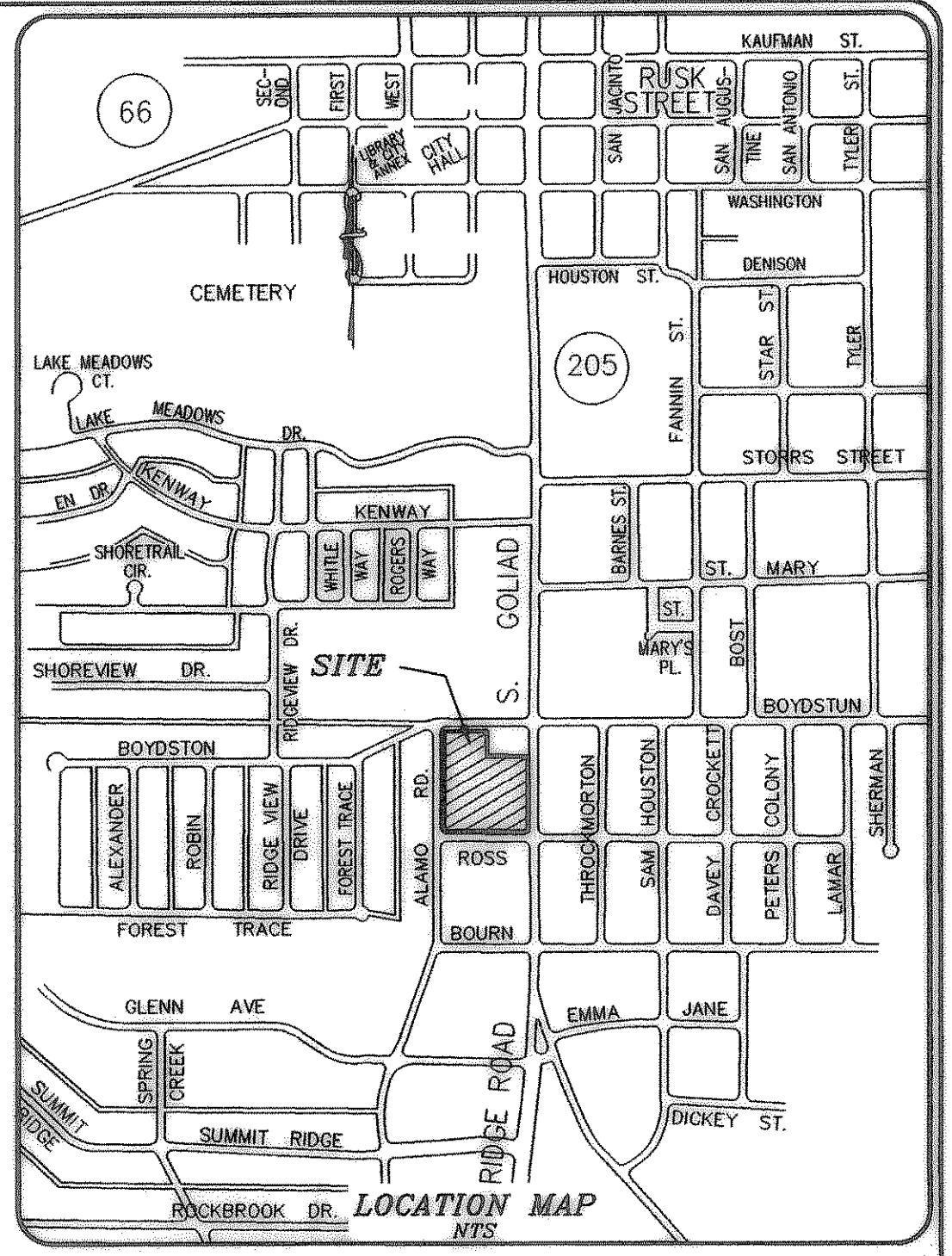

Note:  
Bearings based on the South line of Goliad Place  
Lot 1R, Block 1 recorded in Cabinet C, Slide 261  
Plat Records, Rockwall County, Texas

**LEGEND**

5' M.E. ——— DENOTES 5' MAINTENANCE EASEMENT

"0" ——— DENOTES ZERO LOT LINE

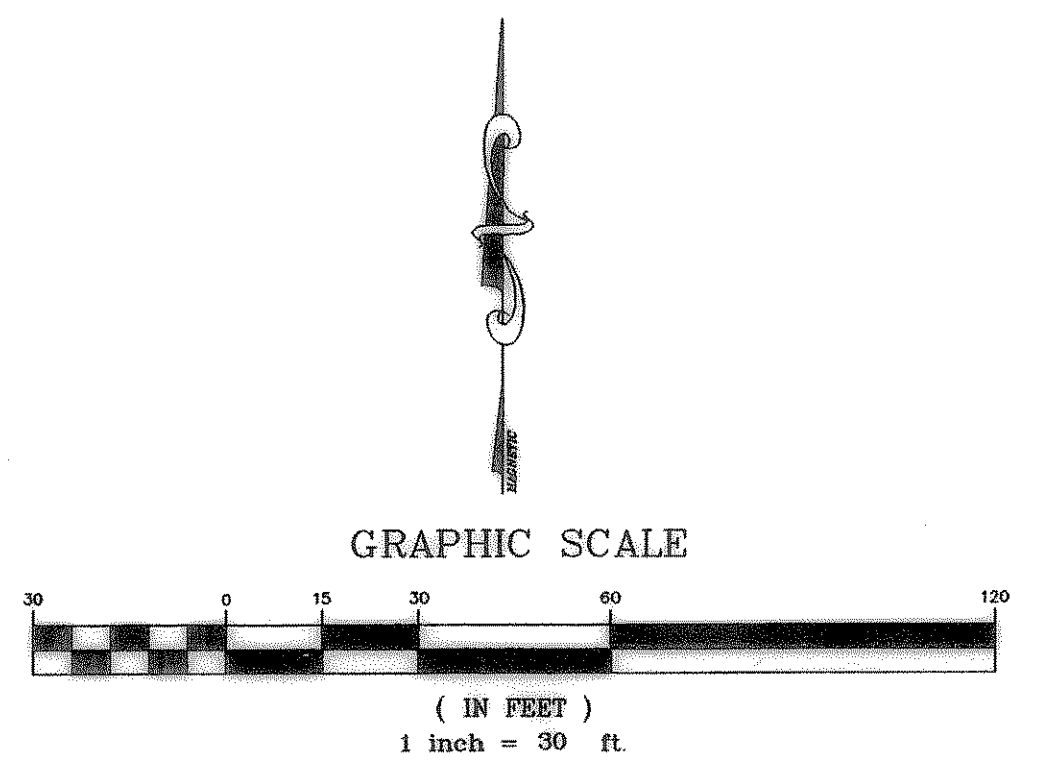

**SANGER BROTHERS ADDITION**  
RE-PLAT OF LOTS 2-8, BLOCK M  
CITY OF ROCKWALL, ROCKWALL COUNTY, TEXAS

DEWAYNE CAIN 972-771-8641  
P.O. BOX 1119 ROCKWALL, TEXAS 75087