

PRIVATE STORM SEWER ST-3

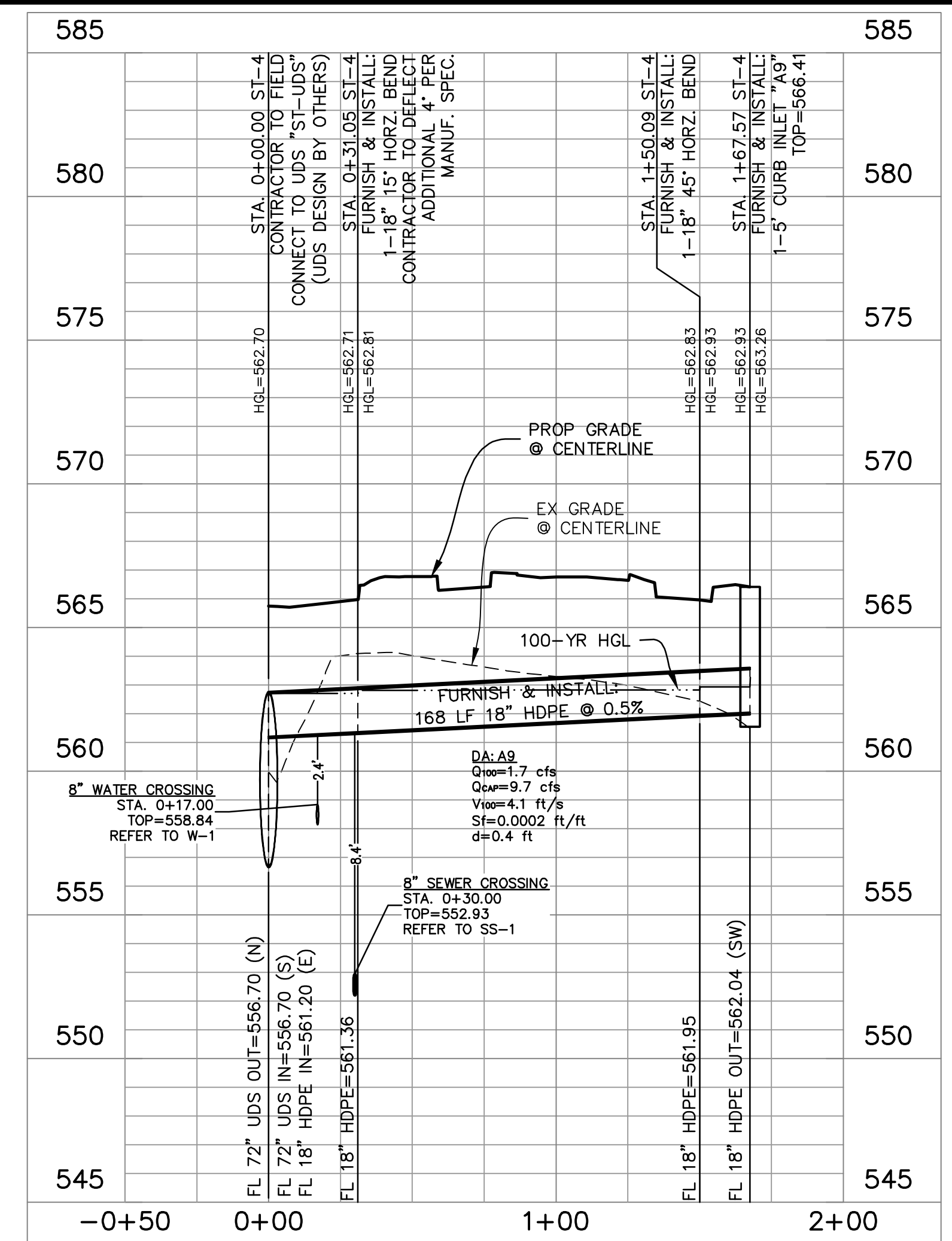

PRIVATE STORM SEWER ST-4

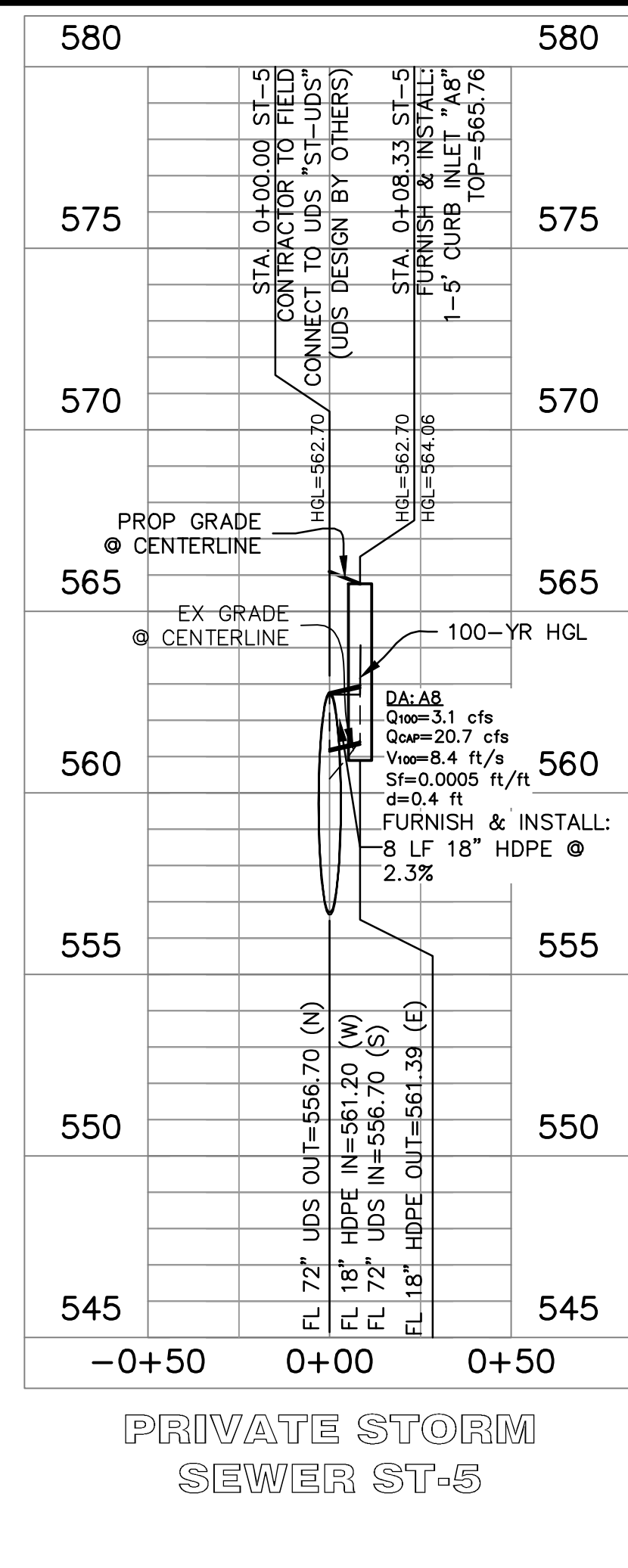

PRIVATE STORM SEWER ST-5

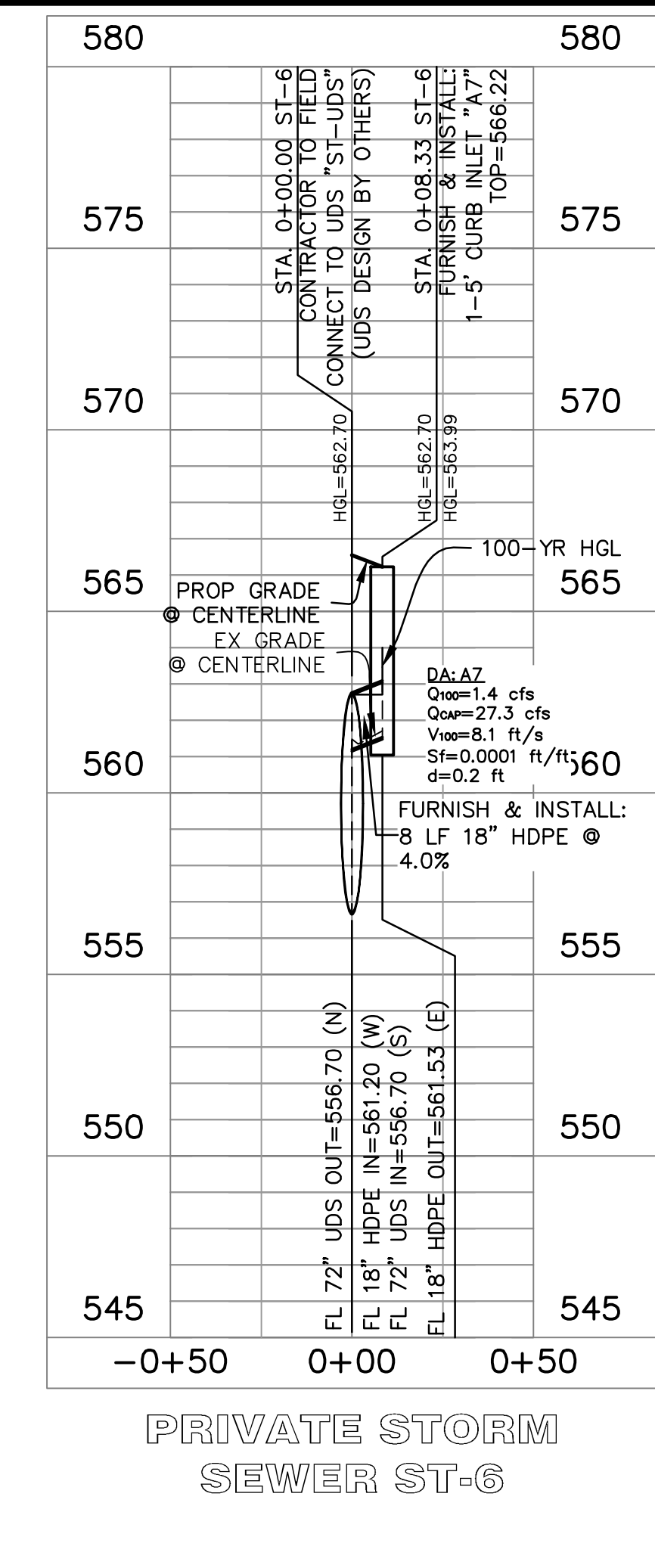

PRIVATE STORM SEWER ST-6

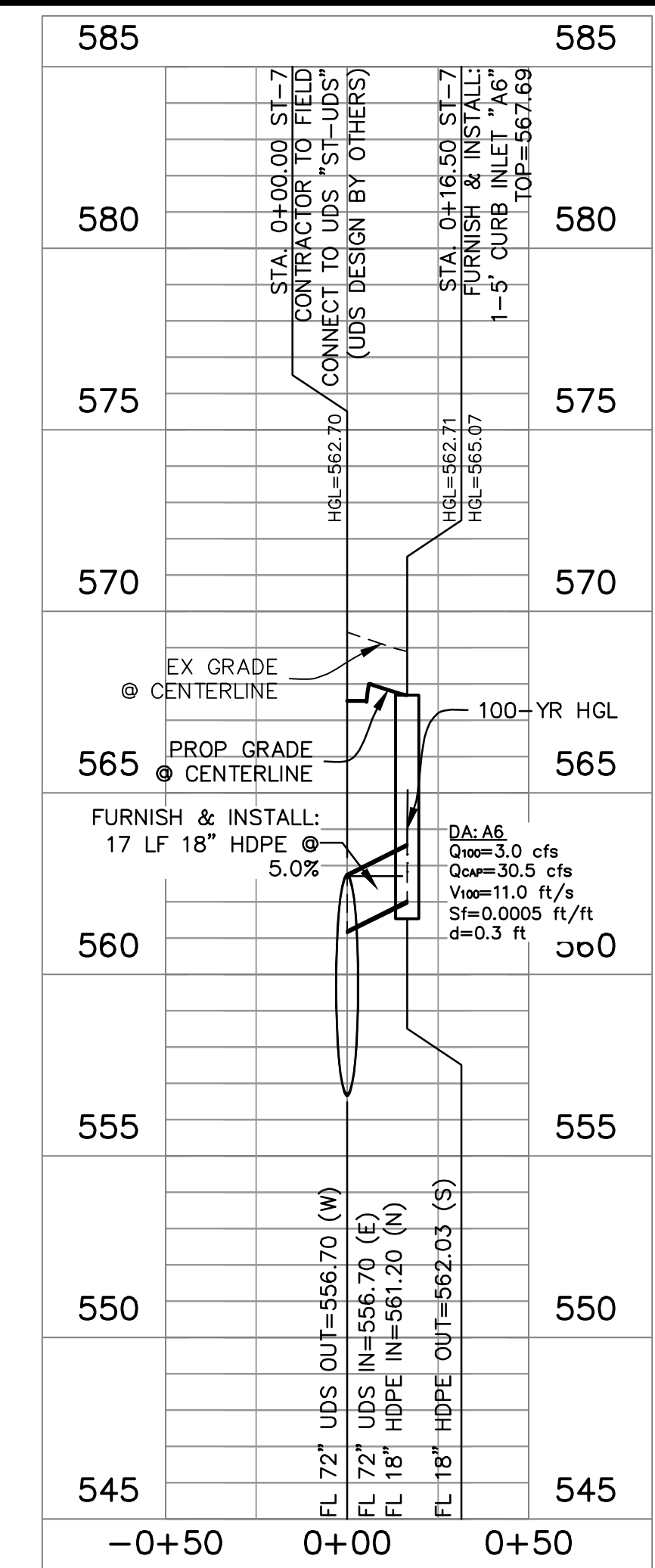

PRIVATE STORM SEWER ST-7

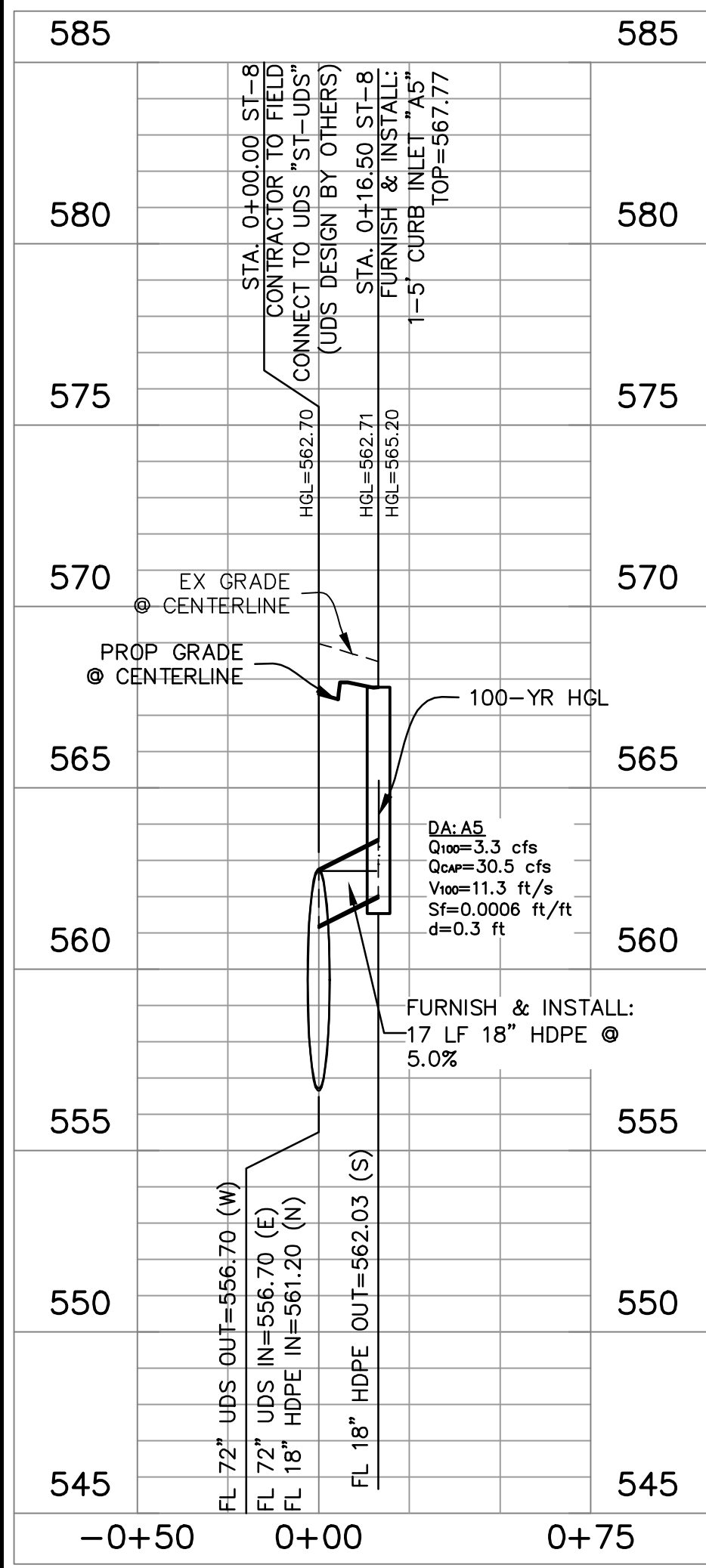

PRIVATE STORM SEWER ST-8

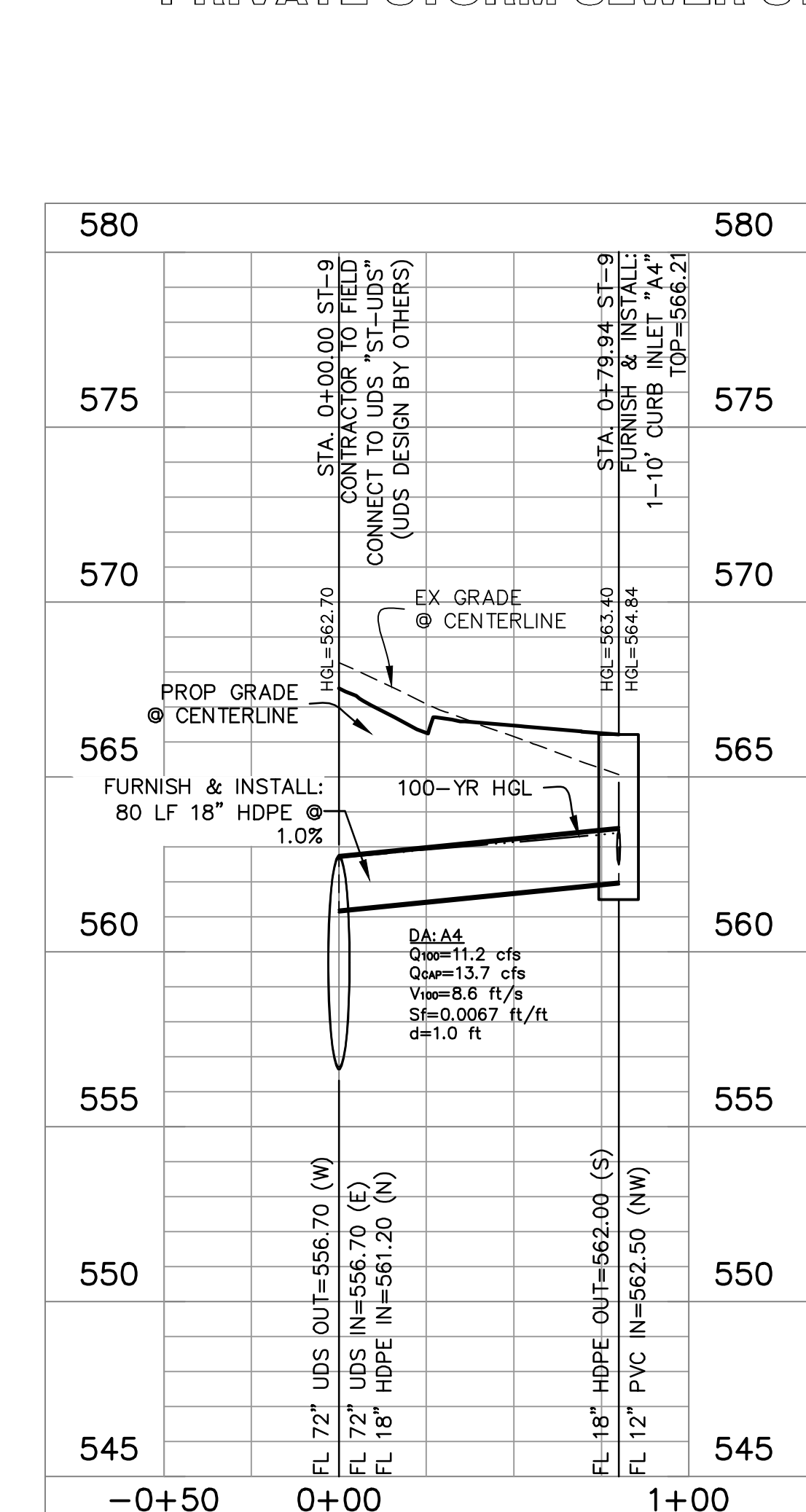

PRIVATE STORM SEWER ST-9

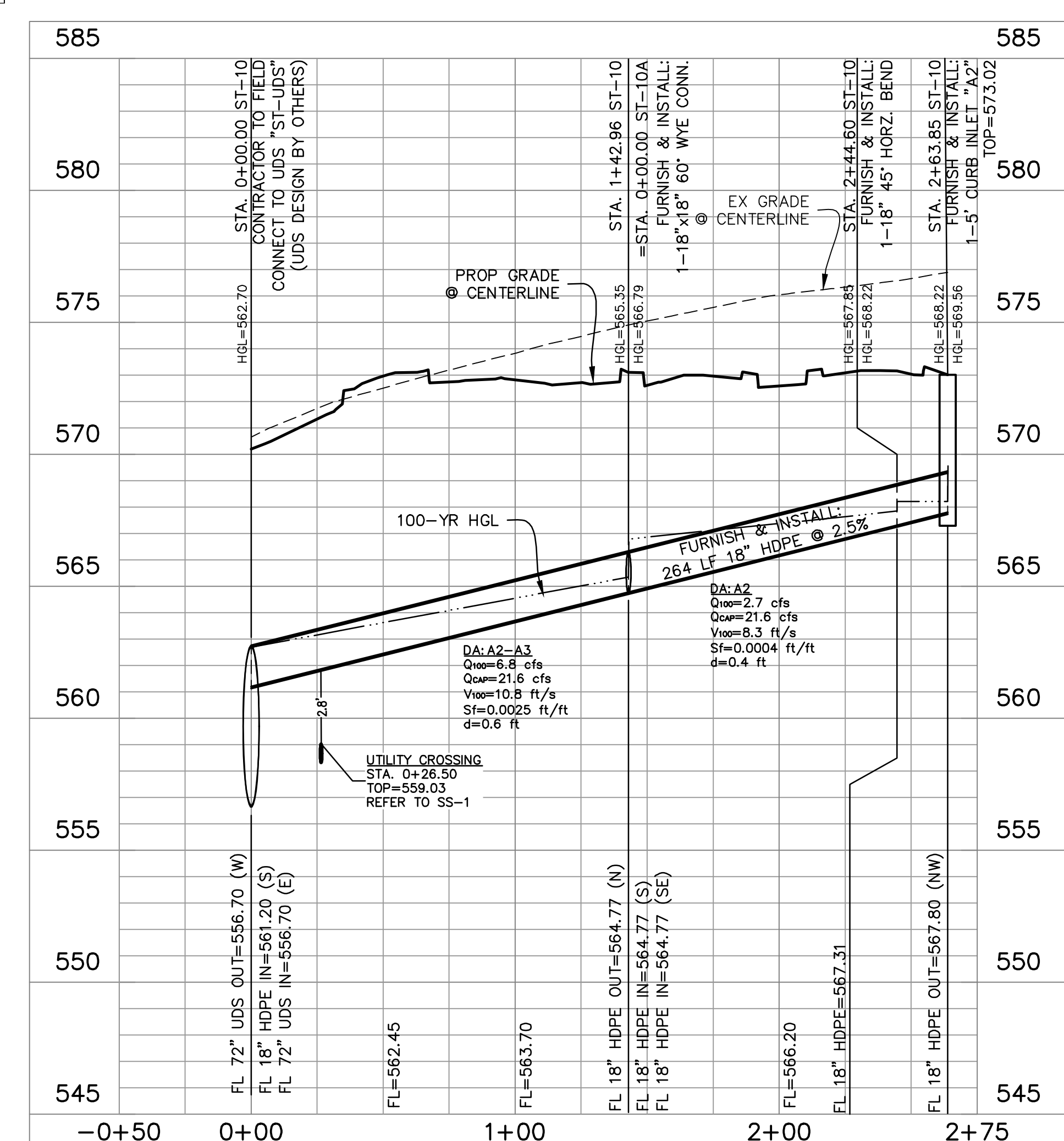

PRIVATE STORM SEWER ST-10

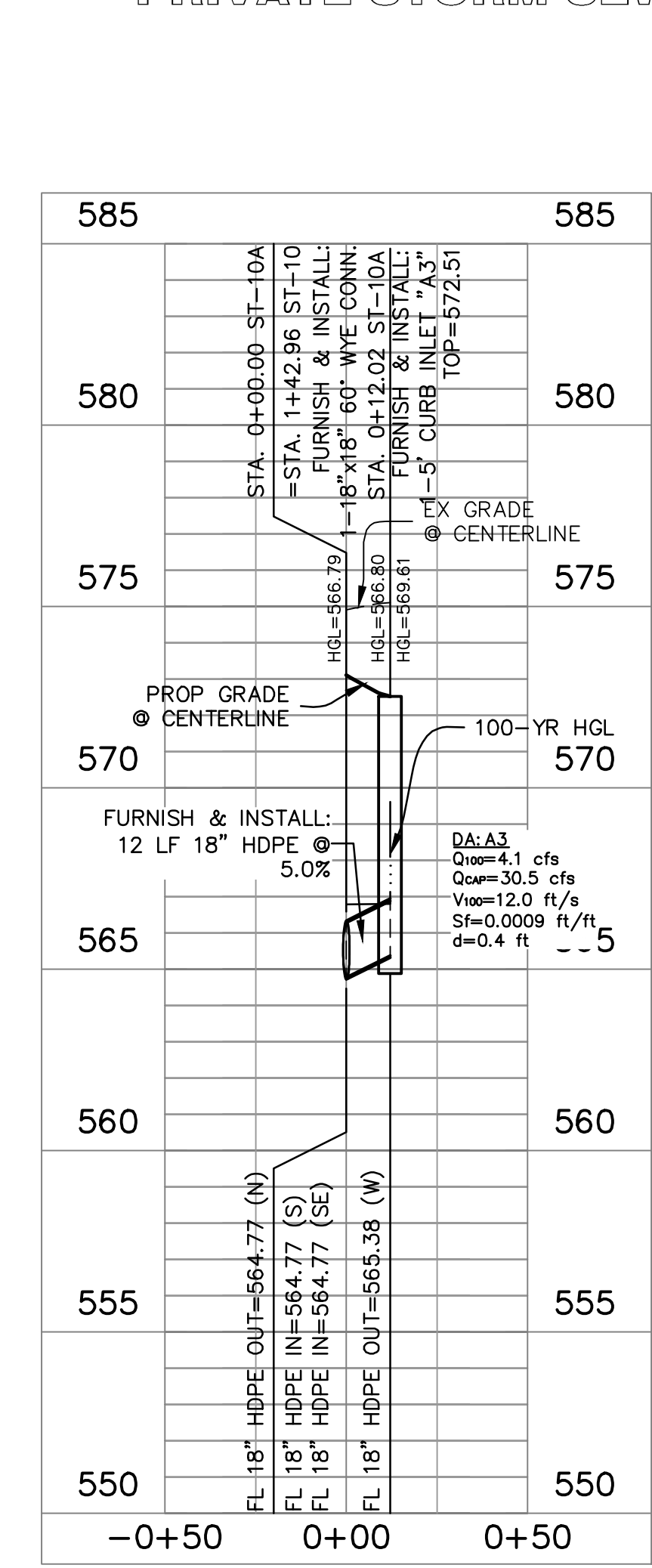

PRIVATE STORM SEWER ST-10A

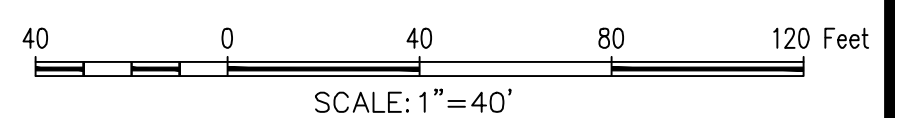

BM: CITY OF ROCKWALL CONTROL MONUMENT "N1495". CALLED ELEV= 566.71. MEASURED ELEV. = 566.83

- GENERAL NOTES
1. ALL T.C.E.Q. SEPARATION REQUIREMENTS MUST BE MET.
 2. THE CONTRACTOR SHALL FIELD VERIFY LOCATIONS AND DEPTHS OF EXISTING UTILITIES PRIOR TO START OF CONSTRUCTION.
 3. ALL WATER MAINS SHALL HAVE A MINIMUM COVER OF 48 INCHES PER CITY STANDARDS.
 4. ALL PUBLIC SEWER TO HAVE GREEN EMS DISKS INSTALLED AT EVERY SERVICE CONNECTION. CLEANOUT, MANHOLE AND CHANGE IN DIRECTION.
 5. ALL MANHOLES TO BE RAVEN LINED OR CITY APPROVED EQUAL.
 6. MANHOLES AND MAIN LINES MUST MEET ALL N.C.T.C.O.G. AND CITY REQUIREMENTS.



SWBC ROCKWALL PHASE II
Lot 1, Block A
SWBC ROCKWALL ADDITION, PHASE II
 21275 Acres
 in the
 J.M. ALLEN SURVEY ABSTRACT NO. NO. 2
 CITY OF ROCKWALL,
 ROCKWALL COUNTY, TEXAS

STORM SEWER PROFILES

AS-BUILT RECORD DRAWING

THE INFORMATION ON THESE PLANS HAS BEEN REVIEWED TO REFLECT CHANGES TO PUBLIC IMPROVEMENTS MADE DURING CONSTRUCTION. UNLESS OTHERWISE NOTED, THE CONSTRUCTION OF THE PUBLIC IMPROVEMENTS IS IN GENERAL CONFORMANCE WITH THESE PLANS, BASED UPON INFORMATION PROVIDED BY THE CONTRACTOR AND FIELD VERIFICATIONS. THE RESPONSIBILITY FOR ACCURACY AND COMPLETENESS BELONGS TO THE CONTRACTOR.

Matthew G. St. Marie
 THE JOHN R. MCADAMS COMPANY, INC.
 Date: 09/25/2023

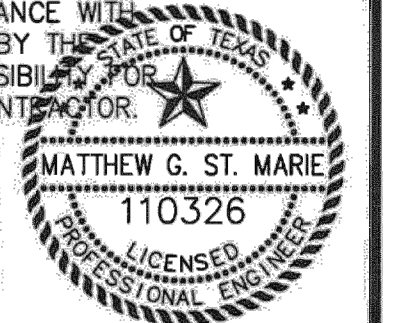

MCADAMS
 TBPE 19762

Drawn By:	CMK
Date:	12/30/2020
Scale:	H1=40' V 1"=4'
Revisions:	
	02/11/2021
	05/07/2021
	07/12/2021
	09/25/2023 - AS-BUILT

WBC20000

OWNER/DEVELOPER
SWBC ROCKWALL LP
 6949 SHERRY LANE, SUITE 760
 DALLAS, TEXAS 75226
 Ph. (214) 987-0700
 Contact: Spencer Byington

C4.05

File: W:\Projects\WBC20000\As-Built\Drawings\WBC20000-Sub-10-Storm.dwg
 Plot: 9/28/2023 11:30 AM by Matthew G. St. Marie, Sheet: 9/25/2023 11:02 AM, by Spencer