

PUBLIC SANITARY SEWER SS-1

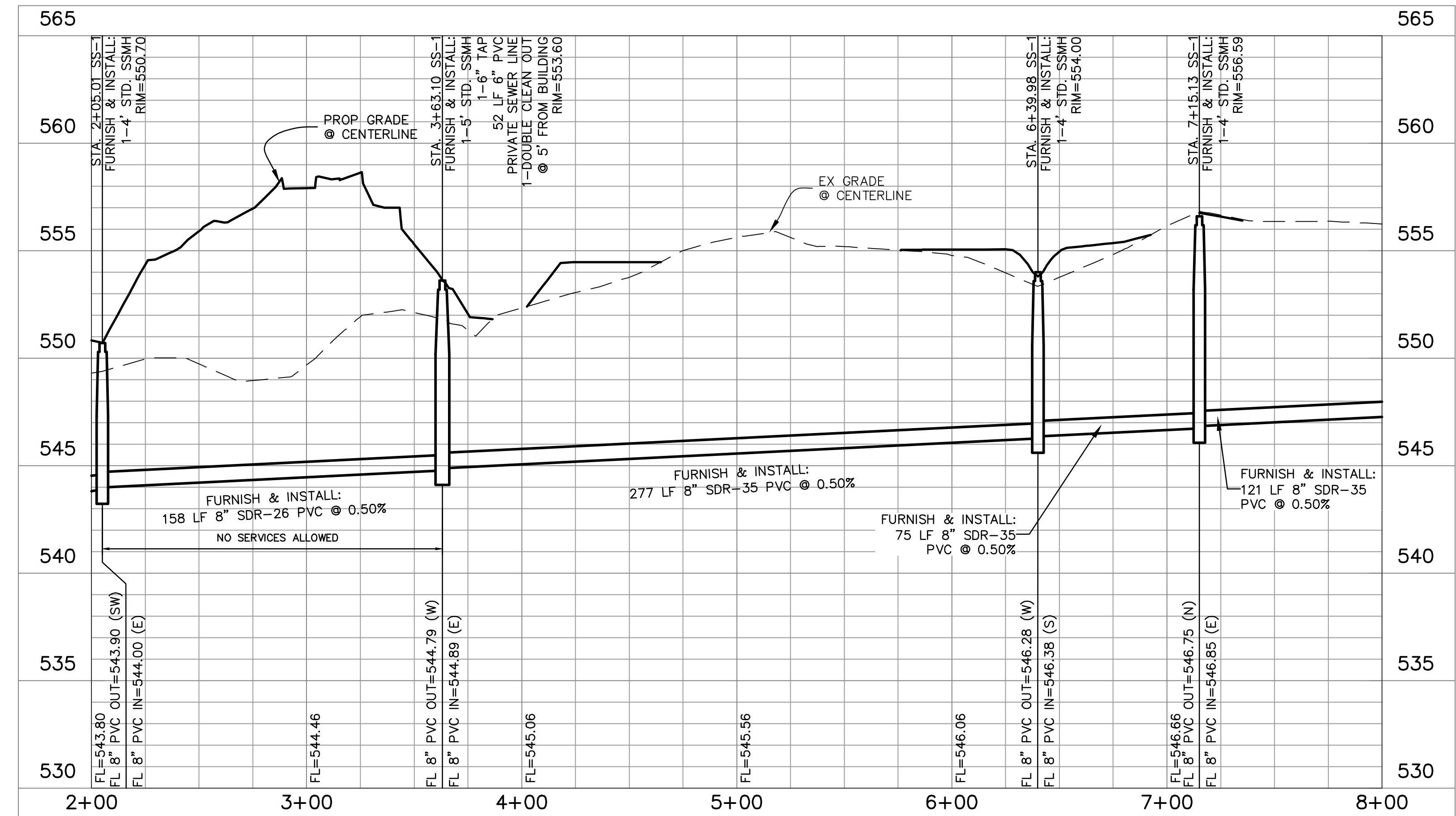

PUBLIC SANITARY SEWER SS-1

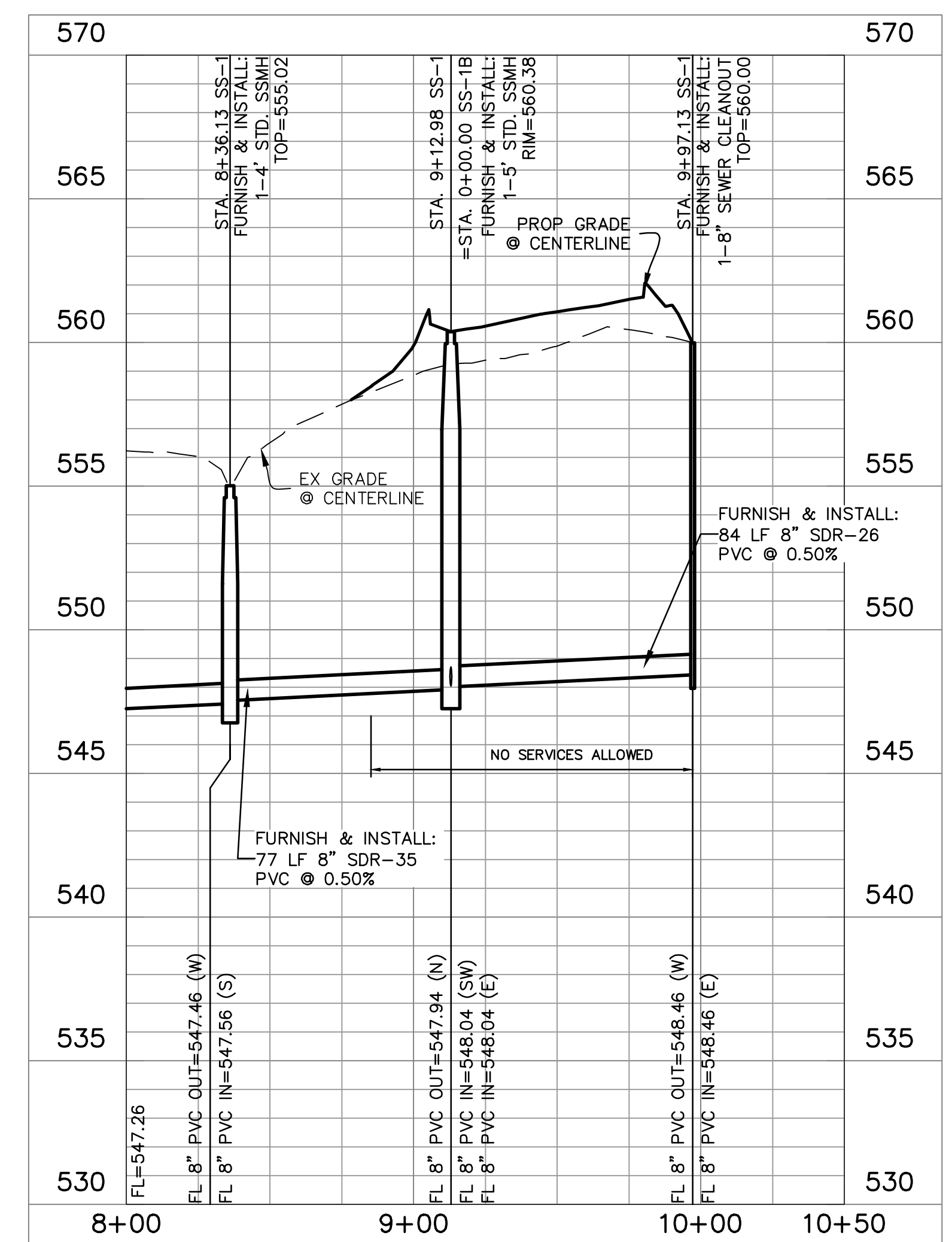

PUBLIC SANITARY SEWER SS-1

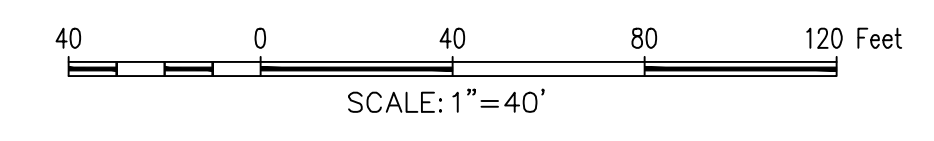

TBM: "X" CUT ON CURB INLET ALONG NORTHSIDE OF DISCOVERY BLVD. APPROXIMATELY 570 FEET FROM EAST PROPERTY LINE. ELEV.= 564.92  
 BM: CITY OF ROCKWALL CONTROL MONUMENT "N1495", CALLED ELEV.= 566.71. MEASURED ELEV. = 566.83

- GENERAL NOTES
1. ALL T.C.E.Q SEPARATION REQUIREMENTS MUST BE MET.
  2. THE CONTRACTOR SHALL FIELD VERIFY LOCATIONS AND DEPTHS OF EXISTING UTILITIES PRIOR TO START OF CONSTRUCTION.
  3. ALL WATER MAINS SHALL HAVE A MINIMUM COVER OF 48 INCHES PER CITY STANDARDS.
  4. ALL PUBLIC SEWER TO HAVE GREEN EMS DISKS INSTALLED AT EVERY SERVICE CONNECTION. CLEANOUT, MANHOLE AND CHANGE IN DIRECTION.
  5. ALL MANHOLES TO BE RAVEN LINED OR CITY APPROVED EQUAL.
  6. MANHOLES AND MAIN LINES MUST MEET ALL NCTCOG AND CITY REQUIREMENTS.

The John R. McAdams Company, Inc.  
 111 Hillside Drive  
 Lewisville, Texas 75057  
 972.436.9712  
 201 County View Drive  
 Rockwall, Texas 75087  
 940.248.1817  
 TBPE: 19762 TBPLS: 10194440  
 www.mcadamsco.com

**SWBC ROCKWALL**  
 Lot 1, Block A  
 SWBC ROCKWALL ADDITION, PHASE I  
 21280 Acres  
 in the  
 J.M. ALLEN SURVEY, ABSTRACT NO. 2  
 CITY OF ROCKWALL,  
 ROCKWALL COUNTY, TEXAS

**SANITARY SEWER PROFILE**

**AS-BUILT RECORD DRAWING**

THE INFORMATION ON THESE PLANS HAS BEEN REVISED TO REFLECT CHANGES TO PUBLIC IMPROVEMENTS MADE DURING CONSTRUCTION. UNLESS OTHERWISE NOTED, THE CONSTRUCTION OF THE PUBLIC IMPROVEMENTS IS IN GENERAL CONFORMANCE WITH THESE PLANS, BASED UPON INFORMATION PROVIDED BY THE CONTRACTOR AND FIELD VERIFICATIONS. THE RESPONSIBILITY FOR ACCURACY AND COMPLETENESS BELONGS TO THE CONTRACTOR.

*Matthew G. St. Marie*  
 THE JOHN R. MCADAMS COMPANY, INC.  
 Date: 03/04/2021



MCADAMS  
 TBPE: 19762

Drawn By:	ASC
Date:	12/19/2017
Scale:	H 1"=40'; V 1"=4'
Revisions:	
	03/23/2018 AS-BUILT
	05/16/2018 03/04/2021
	07/16/2018
	08/13/2018
	10/12/2018
	11/07/2018
	12/14/2018
	12/26/2018

17193

OWNER/DEVELOPER  
**SWBC BUILDERS**  
 5949 SHERRY LANE #760  
 DALLAS, TX 75226  
 Ph. (214) 987-8317  
 Contact: SPENCER BYINGTON

C29

File: 2:107017101\Drawings\As-Built\As-Built\_Sewer\17193\_SSP002.dwg  
 Plotted: 3/3/2021 8:47 AM by S. Wynn, MWH&E, Somet 3/3/2021 8:57 AM by mmore