

Date: 2/20/2021 10:50 AM; User: MGS; Plot: SWBC Rockwall Addition, Phase 1; Scale: 1/8" = 1'-0"; Plot Size: 11.00 x 17.00; Plot Date: 2/20/2021 10:50 AM; by: mgs

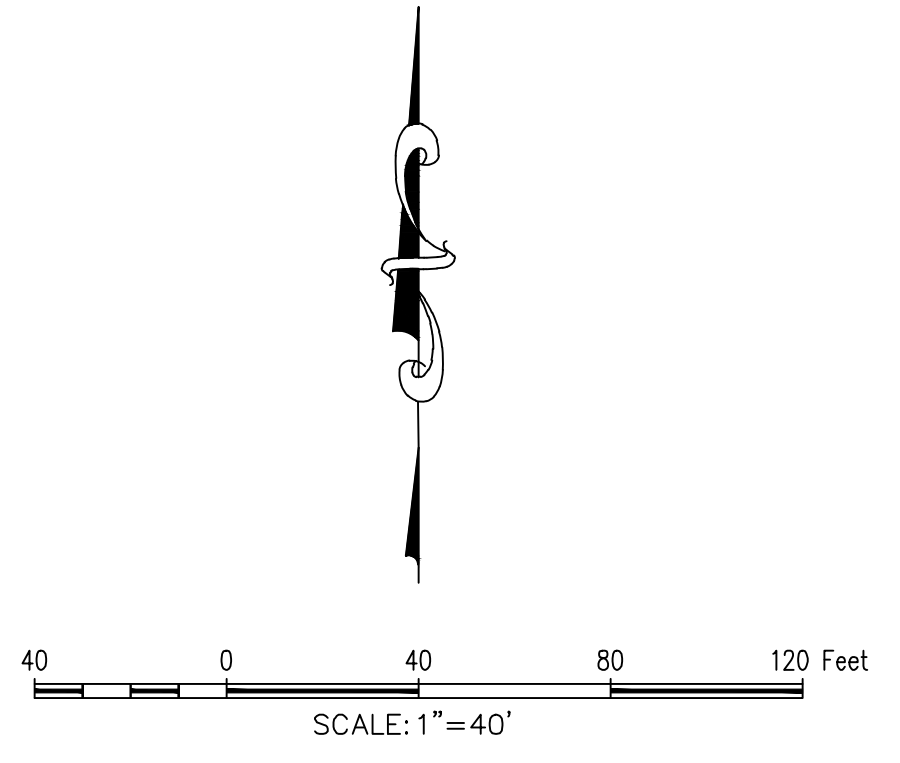
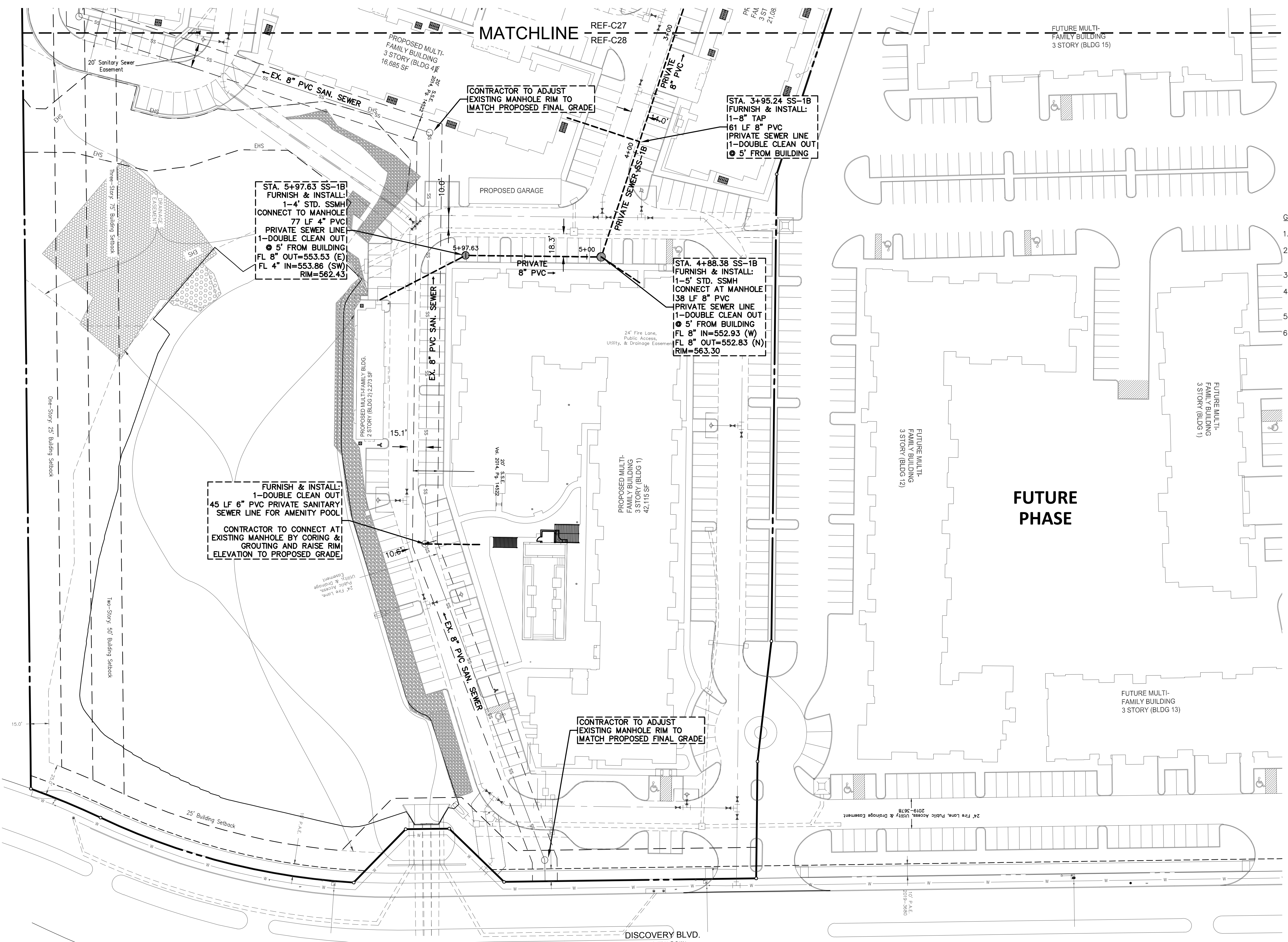

TBM: "X" CUT ON CURB INLET ALONG NORTHSIDE OF DISCOVERY BLVD. APPROXIMATELY 570 FEET FROM EAST PROPERTY LINE. ELEV.= 564.92
 BM: CITY OF ROCKWALL CONTROL MONUMENT "N1495". CALLED ELEV.= 566.71. MEASURED ELEV. = 566.83

- GENERAL NOTES**
1. ALL T.C.E.Q SEPARATION REQUIREMENTS MUST BE MET.
 2. THE CONTRACTOR SHALL FIELD VERIFY LOCATIONS AND DEPTHS OF EXISTING UTILITIES PRIOR TO START OF CONSTRUCTION.
 3. ALL WATER MAINS SHALL HAVE A MINIMUM COVER OF 48 INCHES PER CITY STANDARDS.
 4. ALL PUBLIC SEWER TO HAVE GREEN EMS DISKS INSTALLED AT EVERY SERVICE CONNECTION, CLEANOUT, MANHOLE AND CHANGE IN DIRECTION.
 5. ALL MANHOLES TO BE RAVEN LINED OR CITY APPROVED EQUAL.
 6. MANHOLES AND MAIN LINES MUST MEET ALL NCTCOG AND CITY REQUIREMENTS.

AS-BUILT RECORD DRAWING

THE INFORMATION ON THESE PLANS HAS BEEN REVISED TO REFLECT CHANGES TO PUBLIC IMPROVEMENTS MADE DURING CONSTRUCTION. UNLESS OTHERWISE NOTED, THE CONSTRUCTION OF THE PUBLIC IMPROVEMENTS IS IN GENERAL CONFORMANCE WITH THESE PLANS, BASED UPON INFORMATION PROVIDED BY THE CONTRACTOR AND FIELD VERIFICATIONS. THE RESPONSIBILITY FOR ACCURACY AND COMPLETENESS BELONGS TO THE CONTRACTOR.

Matthew G. St. Marie
 THE JOHN R. MCADAMS COMPANY, INC.
 Date: 03/04/2021

MCADAMS
 The John R. McAdams Company, Inc.
 111 Hillside Drive
 Lewisville, Texas 75057
 972.436.9712
 201 Country View Drive
 Rockwall, Texas 75087
 940.248.1817
 TBPE: 19762 TBPLS: 10194440
 www.mcadamsco.com

SWBC ROCKWALL
 Lot 1, Block A
SWBC ROCKWALL ADDITION, PHASE 1
 21280 Acres
 in the
 J.M. ALLEN SURVEY, ABSTRACT NO. 2
 CITY OF ROCKWALL,
 ROCKWALL COUNTY, TEXAS

SANITARY SEWER PLAN

STATE OF TEXAS
 MATTHEW G. ST. MARIE
 110326
 LICENSED PROFESSIONAL ENGINEER

MCADAMS
 TBPE: 19762

Drawn By:	ASC
Date:	12/19/2017
Scale:	1" = 40'
Revisions:	
	03/23/2018 AS-BUILT
	05/16/2018 03/04/2021
	07/16/2018
	08/13/2018
	10/12/2018
	11/07/2018
	12/14/2018
	12/26/2018

17193

C28

OWNER/DEVELOPER
SWBC BUILDERS
 5949 SHERRY LANE #760
 DALLAS, TX 75226
 Ph. (214) 987-8317
 Contact: SPENCER BYINGTON