



**SWBC ROCKWALL**  
 Lot 1, Block A  
**SWBC ROCKWALL ADDITION, PHASE I**  
 21280 Acres  
 J.M. ALLEN SURVEY, ABSTRACT NO. 2  
 CITY OF ROCKWALL,  
 ROCKWALL COUNTY, TEXAS

**SANITARY SEWER PLAN**

**AS-BUILT RECORD DRAWING**

THE INFORMATION ON THESE PLANS HAS BEEN REVIEWED TO REFLECT CHANGES TO PUBLIC IMPROVEMENTS MADE DURING CONSTRUCTION. UNLESS OTHERWISE NOTED, THE CONSTRUCTION OF THE PUBLIC IMPROVEMENTS IS IN GENERAL CONFORMANCE WITH THESE PLANS, BASED UPON INFORMATION PROVIDED BY THE CONTRACTOR AND FIELD VERIFICATIONS. THE RESPONSIBILITY FOR ACCURACY AND COMPLETENESS BELONGS TO THE CONTRACTOR.

*Matthew G. St. Marie*  
 THE JOHN R. MCADAMS COMPANY, INC.

Date: 03/04/2021

MCADAMS  
 TBPE: 19762

Drawn By:	ASC
Date:	12/19/2017
Scale:	1" = 40'
Revisions:	
03/23/2018	AS-BUILT S.
05/16/2018	03/04/2021
07/16/2018	
08/13/2018	
10/12/2018	
11/07/2018	
12/14/2018	
12/26/2018	

**17193**

OWNER/DEVELOPER  
**SWBC BUILDERS**  
 5949 SHERRY LANE #760  
 DALLAS, TX 75226  
 Ph. (214) 987-8317  
 Contact: SPENCER BYINGTON

**C27**

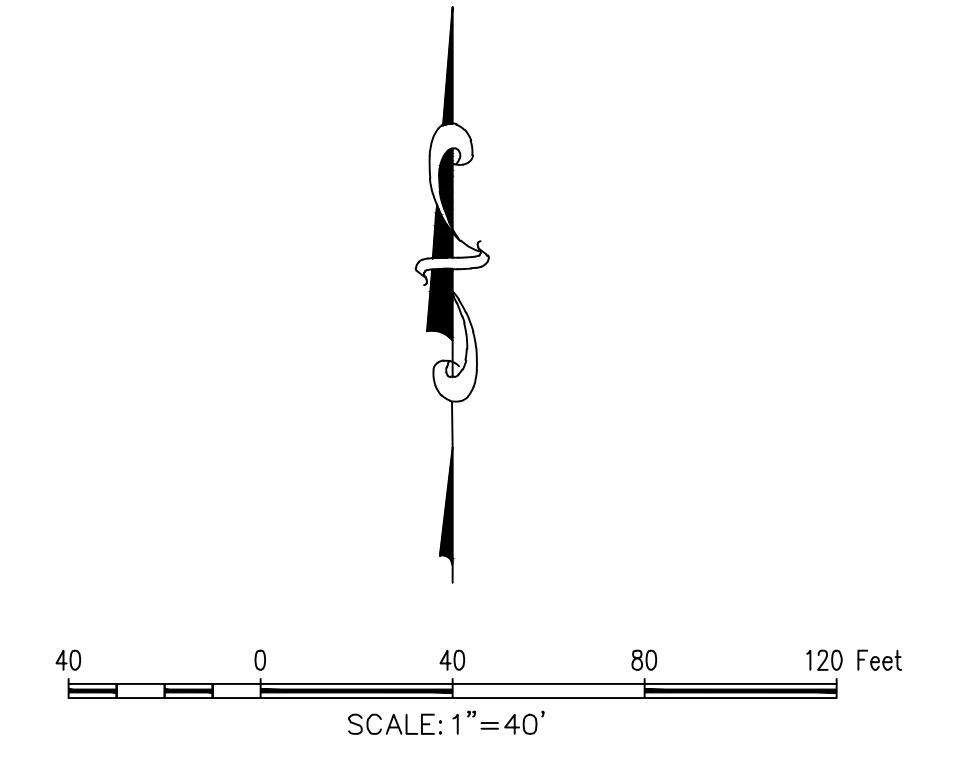

TBM: "X" CUT ON CURB INLET ALONG NORTHSIDE OF DISCOVERY BLVD. APPROXIMATELY 570 FEET FROM EAST PROPERTY LINE. ELEV.= 564.92  
 BM: CITY OF ROCKWALL CONTROL MONUMENT "N1495". CALLED ELEV.= 566.71.  
 MEASURED ELEV. = 566.83

- GENERAL NOTES
1. ALL T.C.E.Q SEPARATION REQUIREMENTS MUST BE MET.
  2. THE CONTRACTOR SHALL FIELD VERIFY LOCATIONS AND DEPTHS OF EXISTING UTILITIES PRIOR TO START OF CONSTRUCTION.
  3. ALL WATER MAINS SHALL HAVE A MINIMUM COVER OF 48 INCHES PER CITY STANDARDS.
  4. ALL PUBLIC SEWER TO HAVE GREEN EMS DISKS INSTALLED AT EVERY SERVICE CONNECTION, CLEANOUT, MANHOLE AND CHANGE IN DIRECTION.
  5. ALL MANHOLES TO BE RAVEN LINED OR CITY APPROVED EQUAL.
  6. MANHOLES AND MAIN LINES MUST MEET ALL NCTCOG AND CITY REQUIREMENTS.

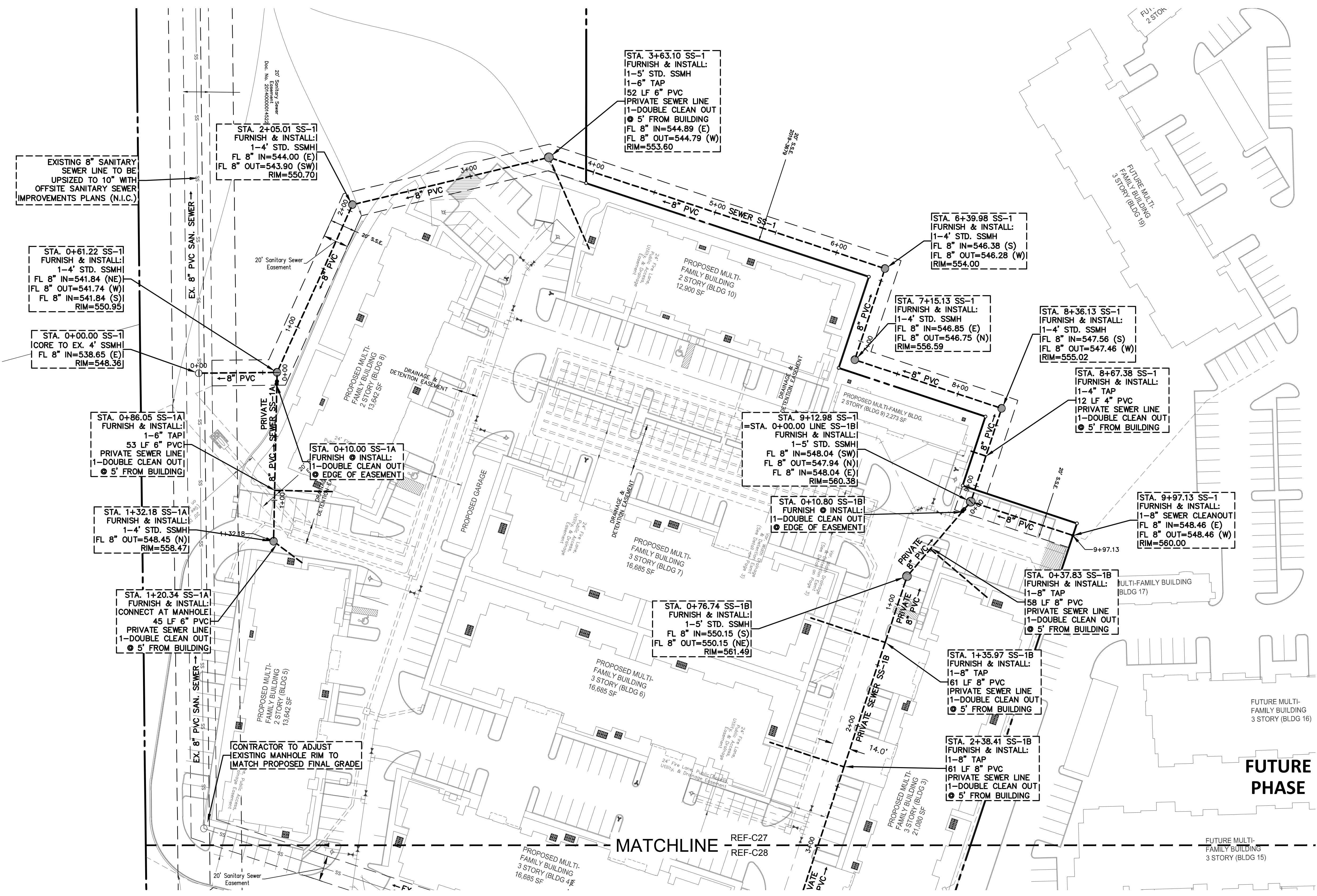

File: 2:2017\17193\SWBC\AS-BUILT\AS-BUILT\_Sewer\17193\_SSB\_S1.dwg  
 Plotted: 3/3/2021 9:46 AM by: S. Marie, Matthew, Somet 3/3/2021 9:02 AM, by: mmore