

# SOUTHERN PACIFIC RAIL ROAD (100' R.O.W.)

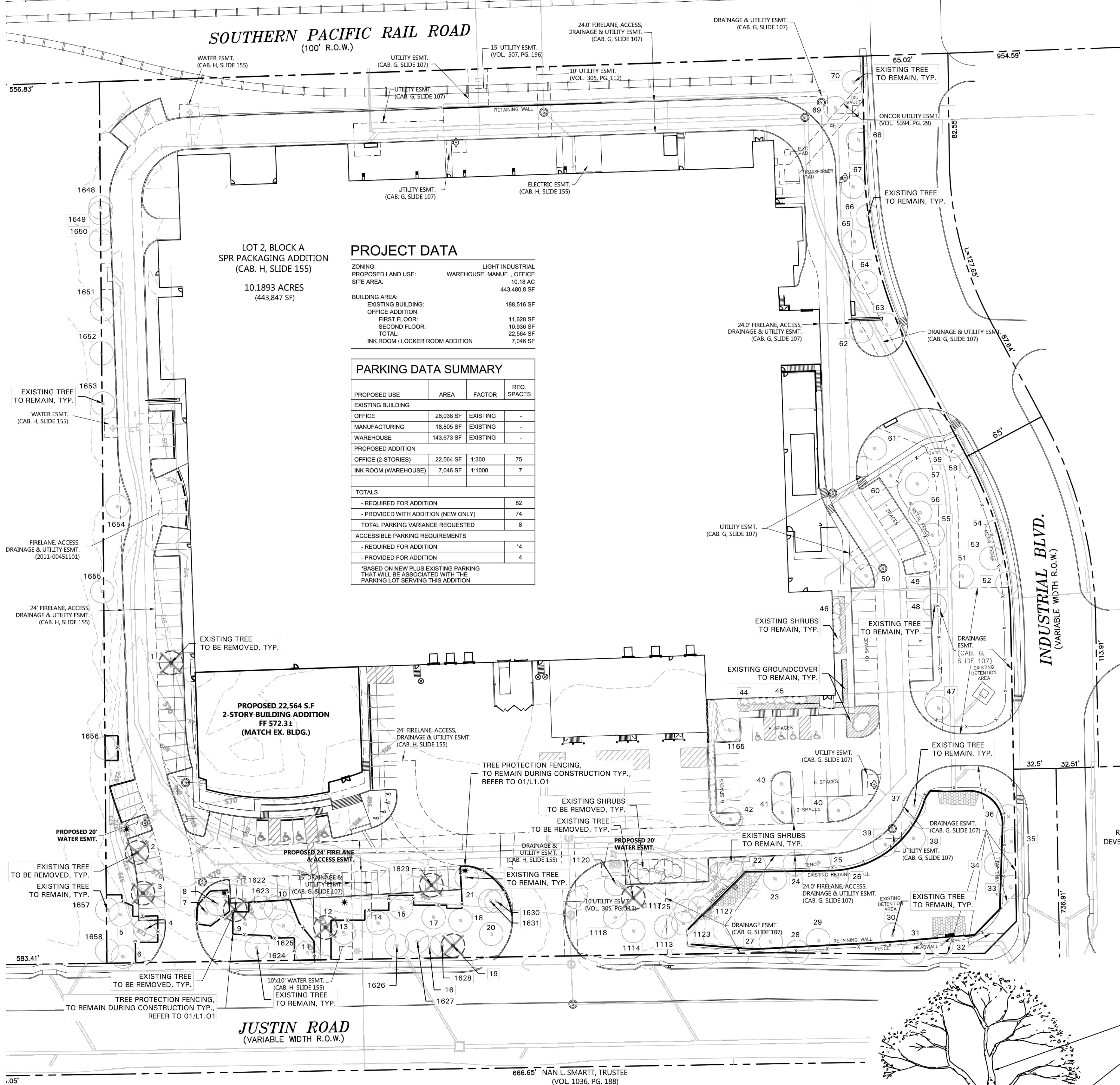

### PROJECT DATA

ZONING:	LIGHT INDUSTRIAL
PROPOSED LAND USE:	WAREHOUSE, MANUF., OFFICE
SITE AREA:	10.18 AC
BUILDING AREA:	443,480.8 SF
EXISTING BUILDING:	188,516 SF
OFFICE ADDITION:	11,628 SF
FIRST FLOOR:	10,936 SF
SECOND FLOOR:	22,564 SF
TOTAL:	22,564 SF
INK ROOM / LOCKER ROOM ADDITION:	7,046 SF

### PARKING DATA SUMMARY

PROPOSED USE	AREA	FACTOR	REQ. SPACES
<b>EXISTING BUILDING</b>			
OFFICE	26,036 SF	EXISTING	-
MANUFACTURING	18,805 SF	EXISTING	-
WAREHOUSE	143,673 SF	EXISTING	-
<b>PROPOSED ADDITION</b>			
OFFICE (2-STORIES)	22,564 SF	1:300	75
INK ROOM (WAREHOUSE)	7,046 SF	1:1000	7
<b>TOTALS</b>			<b>82</b>
- REQUIRED FOR ADDITION			82
- PROVIDED WITH ADDITION (NEW ONLY)			74
<b>TOTAL PARKING VARIANCE REQUESTED</b>			<b>8</b>
<b>ACCESSIBLE PARKING REQUIREMENTS</b>			
- REQUIRED FOR ADDITION			*4
- PROVIDED FOR ADDITION			4

\*BASED ON NEW PLUS EXISTING PARKING THAT WILL BE ASSOCIATED WITH THE PARKING LOT SERVING THIS ADDITION

### TREE SURVEY FIELD DATA

No.	Di. (inches)	Species (common name)	Status	Remarks
1	5	CEDAR ELM	TO BE REMOVED	PROTECTED
2	3	LACEBARK ELM	TO BE REMOVED	NOT PROTECTED
3	7	LACEBARK ELM	TO BE REMOVED	PROTECTED
4	5.5	LACEBARK ELM	TO REMAIN	
5	3.5	LACEBARK ELM	TO REMAIN	
6	6	LACEBARK ELM	TO REMAIN	
7	4	CEDAR	TO REMAIN	
8	4	CEDAR	TO REMAIN	
9	6	LACEBARK ELM	TO REMAIN	
10	6	CEDAR	TO REMAIN	
11	7	CEDAR ELM	TO REMAIN	
12	4	CEDAR	TO BE REMOVED	NOT PROTECTED
13	6	CEDAR ELM	TO REMAIN	
14	6	CEDAR ELM	TO REMAIN	
15	5.5	CEDAR ELM	TO REMAIN	
16	5	CEDAR	TO REMAIN	
17	7	CEDAR ELM	TO REMAIN	
18	5.5	BALD CYPRESS	TO REMAIN	
19	6	BALD CYPRESS	TO BE REMOVED	DEAD
20	5	BALD CYPRESS	TO REMAIN	
21	5	CEDAR ELM	TO REMAIN	
22	8	BALD CYPRESS	TO REMAIN	
23	5	BALD CYPRESS	TO REMAIN	
24	8	BALD CYPRESS	TO REMAIN	
25	6	BALD CYPRESS	TO REMAIN	
26	3	BALD CYPRESS	TO REMAIN	
27	3	BALD CYPRESS	TO REMAIN	
28	5	BALD CYPRESS	TO REMAIN	
29	5	BALD CYPRESS	TO REMAIN	
30	6	BALD CYPRESS	TO REMAIN	
31	6	BALD CYPRESS	TO REMAIN	
32	4	BALD CYPRESS	TO REMAIN	
33	9	BALD CYPRESS	TO REMAIN	
34	8	BALD CYPRESS	TO REMAIN	
35	7	BALD CYPRESS	TO REMAIN	
36	5	BALD CYPRESS	TO REMAIN	
37	6	BALD CYPRESS	TO REMAIN	
38	3	BALD CYPRESS	TO REMAIN	
39	4	BALD CYPRESS	TO REMAIN	
40	12	LACEBARK ELM	TO REMAIN	
41	12	LACEBARK ELM	TO REMAIN	
42	11	LACEBARK ELM	TO REMAIN	
43	11	LACEBARK ELM	TO REMAIN	
44	10	CREPE MYRTLE	TO REMAIN	
45	11	CREPE MYRTLE	TO REMAIN	
46	6	CREPE MYRTLE	TO REMAIN	
47	6	BALD CYPRESS	TO REMAIN	
48	8	BALD CYPRESS	TO REMAIN	
49	7	BALD CYPRESS	TO REMAIN	
50	4	LACEBARK ELM	TO REMAIN	
51	6	BALD CYPRESS	TO REMAIN	
52	6	BALD CYPRESS	TO REMAIN	
53	3	BALD CYPRESS	TO REMAIN	
54	5	BALD CYPRESS	TO REMAIN	
55	5	BALD CYPRESS	TO REMAIN	
56	5	BALD CYPRESS	TO REMAIN	
57	3	BALD CYPRESS	TO REMAIN	
58	6	BALD CYPRESS	TO REMAIN	
59	7	BALD CYPRESS	TO REMAIN	
60	8	BALD CYPRESS	TO REMAIN	
61	7	BALD CYPRESS	TO REMAIN	
62	4	LIVE OAK	TO REMAIN	
63	4	LIVE OAK	TO REMAIN	
64	5	LIVE OAK	TO REMAIN	
65	9	BALD CYPRESS	TO REMAIN	
66	10	BALD CYPRESS	TO REMAIN	
67	10	BALD CYPRESS	TO REMAIN	
68	11	LIVE OAK	TO REMAIN	
69	5	LIVE OAK	TO REMAIN	
70	10	LIVE OAK	TO REMAIN	
1113	6	CYPRESS	TO REMAIN	
1114	6	CYPRESS	TO REMAIN	
1117	10	CEDAR	TO BE REMOVED	DEAD
1118	6	CYPRESS	TO REMAIN	
1120	12	CEDAR	TO REMAIN	
1123	8	CEDAR	TO REMAIN	
1125	8	CEDAR	TO REMAIN	
1127	8	CEDAR	TO REMAIN	
1165	8	LACEBARK ELM	TO REMAIN	
1622	6	CEDAR	TO BE REMOVED	NOT PROTECTED
1623	6	CEDAR	TO REMAIN	
1624	6	CEDAR ELM	TO REMAIN	
1625	6	CEDAR ELM	TO REMAIN	
1626	27	HACKBERRY	TO REMAIN	
1627	6	CEDAR	TO REMAIN	
1628	6	CEDAR	TO REMAIN	
1629	10	HACKBERRY	TO BE REMOVED	NOT PROTECTED
1630	12	HACKBERRY	TO REMAIN	
1631	12	HACKBERRY	TO REMAIN	
1648	8	HACKBERRY	TO REMAIN	
1649	10	HACKBERRY	TO REMAIN	
1650	8	HACKBERRY	TO REMAIN	
1651	18	HACKBERRY	TO REMAIN	
1652	15	HACKBERRY	TO REMAIN	
1653	9	HACKBERRY	TO REMAIN	
1654	30	BOIS D'ARC	TO REMAIN	
1655	12	HACKBERRY	TO REMAIN	
1656	8	HACKBERRY	TO REMAIN	
1657	8	HACKBERRY	TO REMAIN	
1658	27	MULBERRY	TO REMAIN	

Total Caliper Inches on Site	762
Total Caliper Inches Removed	51
Total Mitigation Inches Required	12
Total Mitigation Inches Provided (Refer to Landscape Plan)	12

### TREE PRESERVATION NOTES

- EXISTING TREES TO REMAIN SHALL BE PROTECTED DURING CONSTRUCTION FROM TREE STRUCTURE DAMAGE AND COMPACTION OF SOIL UNDER AND AROUND DRIP LINE (CANOPY) OF TREE.
- IF ANY ROOT STRUCTURE IS DAMAGED DURING ADJACENT EXCAVATION CONSTRUCTION, NOTIFY OWNER'S AUTHORIZED REPRESENTATIVE IMMEDIATELY. IT IS RECOMMENDED THAT A LICENSED ARBORIST BE SECURED FOR THE TREATMENT OF ANY POSSIBLE TREE WOUNDS.
- NO DISTURBANCE OF THE SOIL GREATER THAN 4" SHALL BE LOCATED CLOSER TO THE TREE TRUNK THAN 1/2 THE DISTANCE OF THE DRIP LINE TO THE TREE TRUNK. A MINIMUM OF 75% OF THE DRIP LINE AND ROOT ZONE SHALL BE PRESERVED AT NATURAL GRADE.
- ANY FINE GRADING DONE WITHIN THE CRITICAL ROOT ZONES OF THE PROTECTED TREES MUST BE DONE WITH LIGHT MACHINERY SUCH AS A BOBCAT OR LIGHT TRACTOR. NO EARTH MOVING EQUIPMENT WITH TRACKS IS ALLOWED WITHIN THE CRITICAL ROOT ZONE OF THE TREES.
- NO MATERIALS INTENDED FOR USE IN CONSTRUCTION OR WASTE MATERIALS ACCUMULATED DUE TO EXCAVATION OR DEMOLITION SHALL BE PLACED WITHIN THE LIMITS OF THE DRIP LINE OF ANY TREE.
- NO EQUIPMENT MAY BE CLEANED OR TOXIC SOLUTIONS, OR OTHER LIQUID CHEMICALS, SHALL BE DEPOSITED WITHIN THE LIMITS OF THE DRIP LINE OF A TREE, INCLUDING BUT NOT LIMITED TO: PAINT, OIL, SOLVENTS, ASPHALT, CONCRETE, MORTAR, PRIMERS, ETC.
- NO SIGNS, WIRES OR OTHER ATTACHMENTS, OTHER THAN THOSE OF A PROTECTIVE NATURE, SHALL BE ATTACHED TO ANY TREE.
- NO VEHICULAR / CONSTRUCTION EQUIPMENT TRAFFIC OR PARKING IS ALLOWED WITHIN THE LIMITS OF THE DRIP LINE OF TREES.
- BORING OF UTILITIES MAY BE PERMITTED UNDER PROTECTED TREES IN CERTAIN CIRCUMSTANCES. THE MINIMUM LENGTH OF THE BORE SHALL BE THE WIDTH OF THE TREE'S CANOPY AND SHALL BE A MINIMUM DEPTH OF FORTY-EIGHT (48") INCHES.
- IRRIGATION TRENCHING WHICH MUST BE DONE WITHIN THE CRITICAL ROOT ZONE OF A TREE SHALL BE DUG BY HAND AND ENTER THE AREA IN A RADIAL MANNER.
- ALL TREES TO BE REMOVED FROM THE SITE SHALL BE FLAGGED BY THE CONTRACTOR WITH BRIGHT RED VINYL TAPE (3" WIDTH) WRAPPED AROUND THE MAIN TRUNK AT A HEIGHT OF FOUR (4") FEET ABOVE GRADE. FLAGGING SHALL BE APPROVED BY OWNER'S AUTHORIZED REPRESENTATIVE PRIOR TO ANY TREE REMOVAL. CONTRACTOR SHALL CONTACT OWNER'S AUTHORIZED REPRESENTATIVE WITH 72 HOURS NOTICE TO SCHEDULE ON-SITE MEETING.
- ALL TREES TO REMAIN, AS NOTED ON DRAWINGS, SHALL HAVE PROTECTIVE FENCING LOCATED AT THE TREE'S DRIP LINE. THE PROTECTIVE FENCING MAY BE COMPRISED OF SNOW FENCING, ORANGE VINYL CONSTRUCTION FENCING, CHAIN LINK FENCE OR OTHER SIMILAR FENCING WITH A FOUR (4') FOOT OPTIMUM HEIGHT. THE PROTECTIVE FENCING SHALL BE LOCATED AS INDICATED ON THE TREE PROTECTION DETAIL.
- WHEN A LOW HANGING LIMB IS BROKEN DURING THE COURSE OF CONSTRUCTION, THE CONTRACTOR SHALL NOTIFY THE OWNER'S AUTHORIZED REPRESENTATIVE IMMEDIATELY. UNDER NO CIRCUMSTANCE SHALL THE CONTRACTOR PRUNE ANY PORTION OF THE DAMAGED TREE WITHOUT THE PRIOR APPROVAL BY THE OWNER'S AUTHORIZED REPRESENTATIVE.

### EXISTING TREE LEGEND

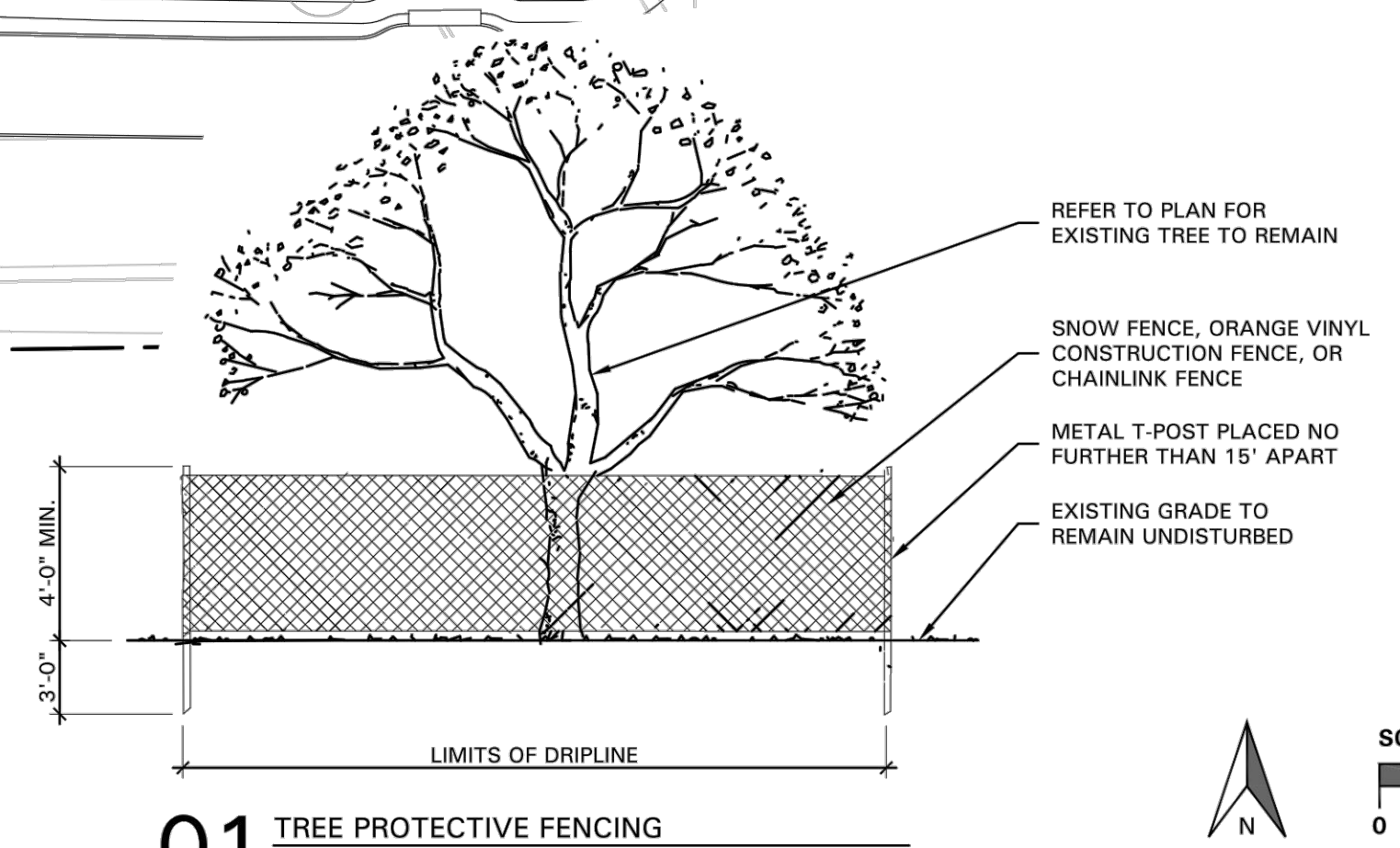
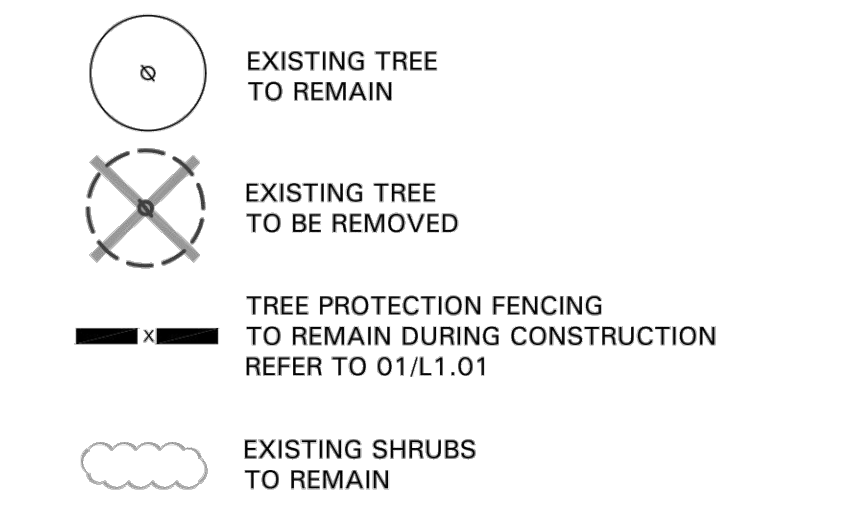

01 TREE PROTECTIVE FENCING  
NOT TO SCALE

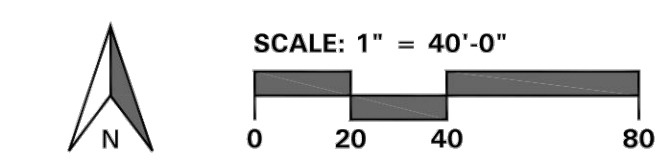

**BELLE FIRMA**

OWNER: ALVAPLAST US, INC. / SPR PACKAGING  
CONTACT: CAROLINA MOLINA  
1480 JUSTIN ROAD  
ROCKWALL, TX 75087  
469-402-1232

ARCHITECT: PROSS DESIGN GROUP, INC.  
CONTACT: BOBBY PROSS  
5310 HARVEST HILL RD., SUITE 180  
DALLAS, TX 75230  
972-759-1400

CASE NO: SP2019-030

### TREE PRESERVATION PLAN

- 4245 North Central Expy
- Suite 501
- Dallas, Texas 75205
- 214.865.7192 office

drawn: NAY  
checked: KAH  
date: 08/14/19

DESCRIPTION

#	DATE	DESCRIPTION

REGISTERED LANDSCAPE ARCHITECT  
STATE OF TEXAS  
2246  
09/27/19

pross design group, incorporated  
5310 Harvest Hill Road, Suite 180, Dallas, Texas 75230-1400

**SPR PACKAGING**  
OFFICE ADDITION  
1480 JUSTIN RD., ROCKWALL, TEXAS

job no 1854  
sheet  
**L1.01**