

DEVELOPMENT PLANS
FOR
ROLLING MEADOWS ESTATES
ROCKWALL COUNTY, TEXAS

GENERAL NOTES

1. All street and alleys intersections and connections shall be built by the developer.
2. Excavation from streets to be deposited in low areas to allow proper drainage, except existing creek.
3. All existing ditches, except as noted on drainage plans, are to be filled to conform to surrounding terrain.
4. It will be the responsibility of the developer and/ or the contractor to protect and maintain to proper line and grade all public utilities, manholes, cleanouts, valve boxes, fire hydrants, etc. during the construction of this project, prior to and after placing permanent pavement.
5. All materials and workmanship shall conform to the County Standards and Specifications.

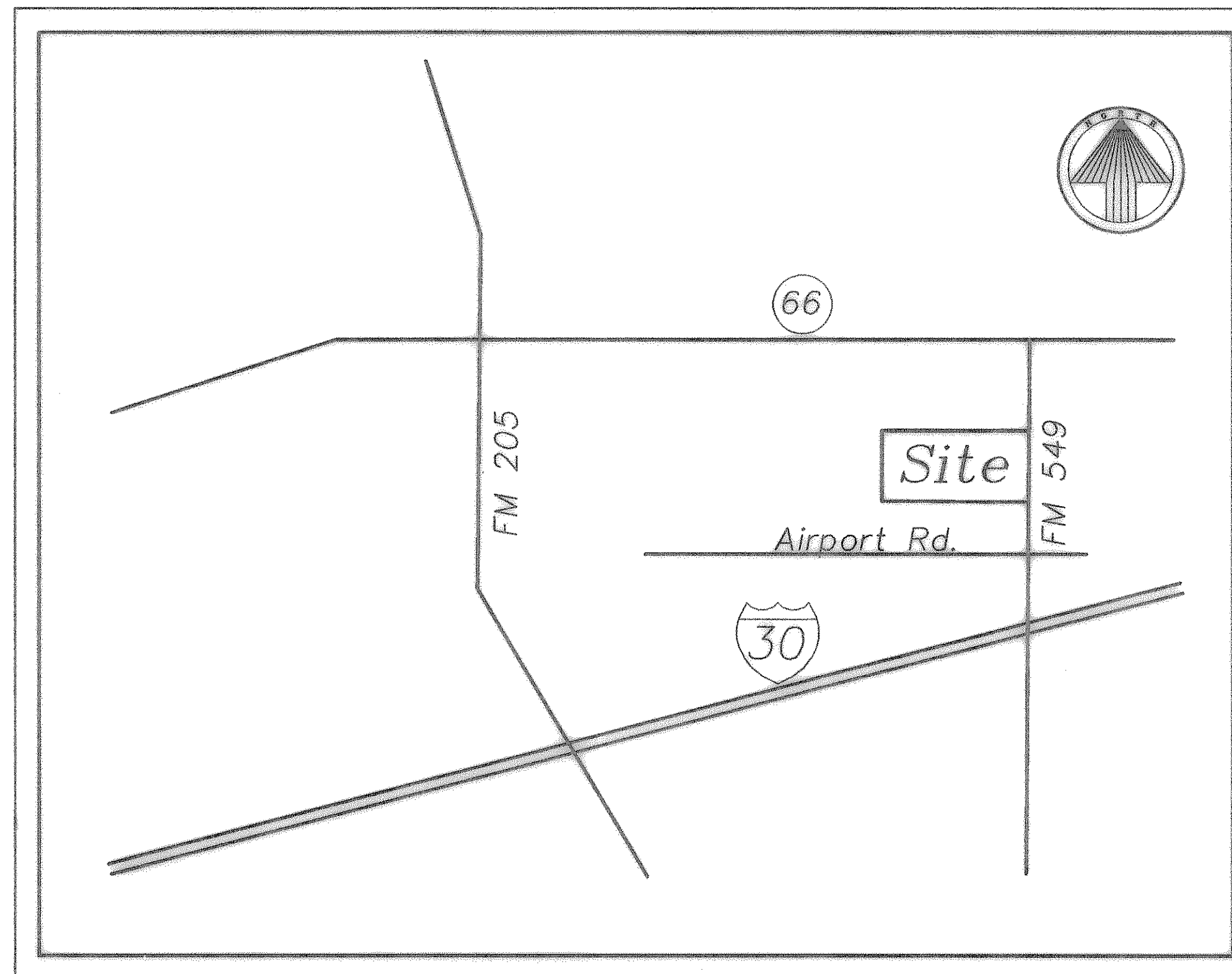

LOCATION MAP
NOT TO SCALE

INDEX

Sheet No.	Description
1-2	Final Plat
3-5	Paving Plans
6	Drainage Area Map
7	Utility Plan
8	Pollution Prevention Plan

PREPARED FOR
ROLLING MEADOWS ESTATES J.V.

12900 Preston Road ~ Suite 1218 ~ Dallas, Texas 75230

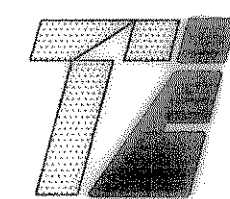

TIPTON ENGINEERING, INC.

6330 Belt Line Road ~ Suite C ~ Garland, Texas 75043 (214) 226-2967