

RUNOFF COEFFICIENT CALCULATION FOR A-1		
LAND USE	AREA (SQ.FT.)	C
ROOF	33148.41	0.90
PAVEMENT	89122.93	0.90
GRAVEL	5784.35	0.40
OPEN	793934.01	0.35
TOTAL	921989.70	0.42

STORMWATER RUNOFF CALCULATION FOR PRE-DEVELOPED CONDITIONS						
DRAINAGE AREA	AREA (AC.)	WEIGHTED C VALUE BASED ON LAND USE	Tc (MIN.)	FREQUENCY (YR.)	I100 (IN./HR.)	Q100 (CFS)
A-1	21.17	0.42	10	100	9.80	87.14
A-2	0.21	0.35	10	100	9.80	0.72

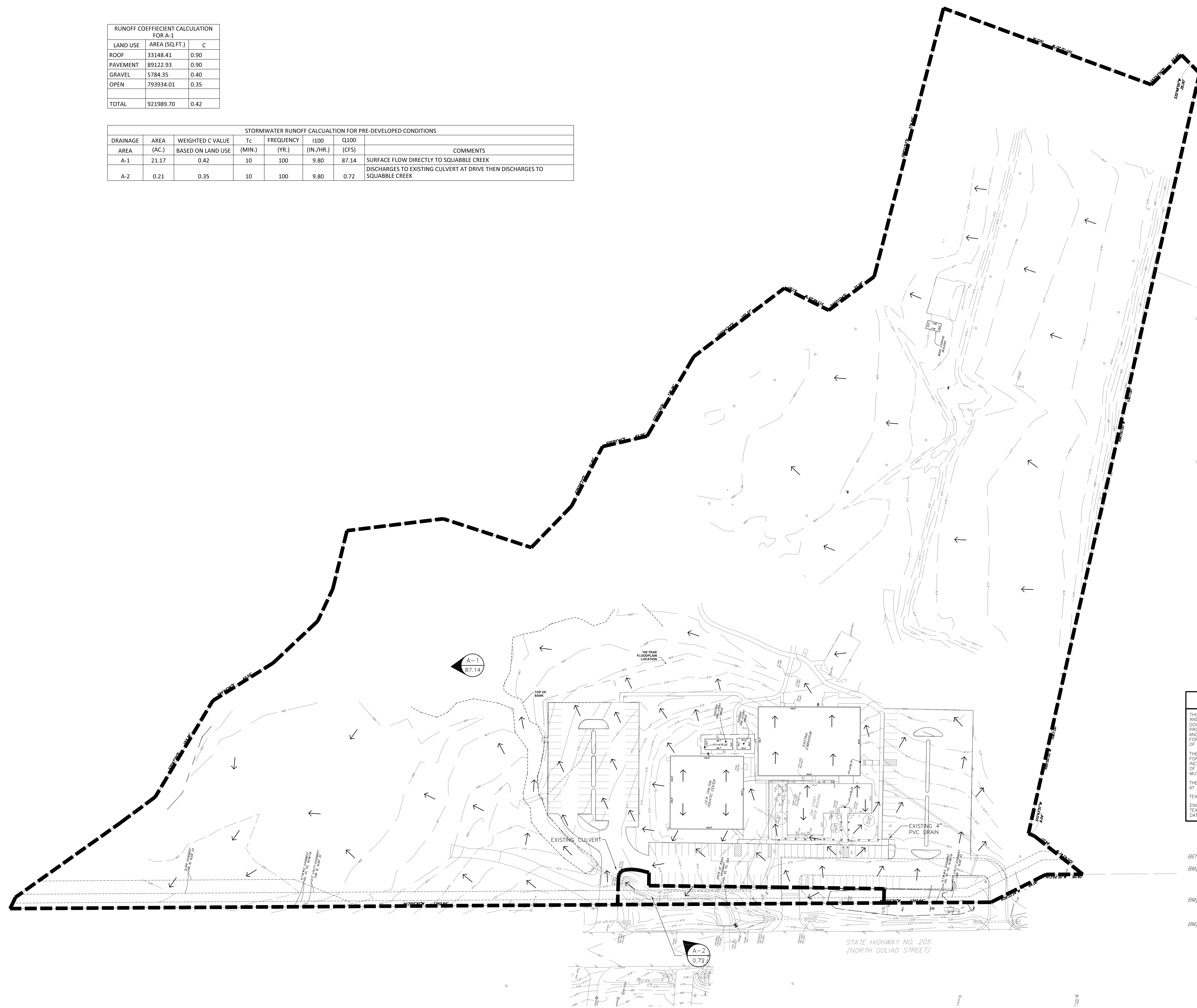

Legend

- 424--- EXISTING CONTOUR AND ELEVATION
- DIRECTION OF FLOW INDICATED BY ARROW
- A-1 → DRAINAGE AREA NO.
- 2.54 → FLOW (CFS)₁₀₀
- DRAINAGE AREA BOUNDARY
- DRAINAGE FLOW ARROWS

Drainage Notes

1. THE HORIZONTAL AND VERTICAL LOCATION OF EXISTING SUBSURFACE UTILITIES HAVE BEEN DETERMINED FROM DATA RECORDED BY OTHERS AND THE BEST AVAILABLE RECORDS. FIELD DATE IS LIMITED TO WHICH IS VISIBLE AND CAN BE MEASURED. THIS DOES NOT PRECLUDE THE EXISTENCE OF OTHER UNDERGROUND ITEMS. THE COMPLETENESS AND/OR ACCURACY OF THESE RECORDS CANNOT BE GUARANTEED, EXCEPT INsofar AS THEY CAN BE VERIFIED BY THE FIELD MEASUREMENT. IT SHALL BE THE RESPONSIBILITY OF THE CONTRACTOR TO UNCOVER AND VERIFY THE ACTUAL DEPTH AND CONDITION OF ALL AFFECTED UNDERGROUND UTILITIES WITHIN THE AREA OF CONSTRUCTION PRIOR TO BEGINNING THE ACTUAL WORK.

RECORD DOCUMENTS

THIS ELECTRONIC DRAWING IS RELEASED AS A RECORD DOCUMENT ONLY AND IS NOT TO BE USED FOR ANY OTHER PURPOSE. THESE RECORD DOCUMENTS HAVE BEEN PREPARED BASED IN PART ON INFORMATION PROVIDED BY OTHERS. THE CONSULTANT HAS NOT VERIFIED THE ACCURACY AND/OR COMPLETENESS OF THIS INFORMATION AND SHALL NOT BE RESPONSIBLE FOR ANY ERRORS OR OMISSIONS THAT MAY BE INCORPORATED AS A RESULT OF ERRONEOUS INFORMATION PROVIDED BY OTHERS.

THE USER OF THIS DRAWING FILE AGREES TO ASSUME ALL RESPONSIBILITY FOR ALL MODIFICATIONS TO OR USE OF THIS DRAWING FILE THAT ARE INCONSISTENT WITH THE REQUIREMENTS OF THE RULES AND THE REGULATIONS OF THE TEXAS BOARD OF PROFESSIONAL ENGINEERS. THIS DRAWING MUST NOT BE ALTERED WITHOUT THE ENGINEER'S KNOWLEDGE AND/OR APPROVAL.

THE ORIGINAL SIGNED, ENGINEER SEALED AND DATED DRAWINGS MAY BE REVIEWED AT THE OFFICES OF JASTER-QUINTANILLA DALLAS, LLP UPON REQUEST.

TEXAS REGISTERED ENGINEERING FIRM: F-1294
 ENGINEER: THOMAS C. PICKERING
 TEXAS REGISTRATION OR LICENSE NUMBER: 87183
 DATE: 08-18-15

BENCHMARKS:

- BM#1 SQUARE CUT AT THE SOUTH END OF THE HEADWALL ALONG EAST LINE OF HIGHWAY 205 IN FRONT OF THE J.E.R. CHILTON AQUATIC CENTER (YMCA), 400' ± NORTH OF CARUTH LANE. ELEVATION = 475.64
- BM#2 60D NAIL IN THE NORTH SIDE OF A FIELD LIGHT POLE AT THE WEST END OF THE MOST SOUTHEAST PLAYING FIELD. ELEVATION = 479.14
- BM#3 STAINLESS STEEL ROD INSIDE ACCESS COVER AT THE INTERSECTION OF STATE HIGHWAY 66 (WILLIAMS STREET), 70.5 FEET SOUTHWEST OF THE SOUTHWEST CORNER OF A HOUSE AT 604 NASH STREET, 70.2 FEET NORTHWEST OF THE CENTERLINE OF THE HIGHWAY, 19.7 FEET EAST OF THE CENTERLINE OF THE STREET, NORTH OF UTILITY POLE NUMBER 2321 482 0087, AND 1.0 FOOT WEST OF THE WEST EDGE OF A SIDEWALK. ELEVATION = 550.99

No.	Description	Date
1	RECORD DOC.	8/18/2015