

RECORD DOCUMENTS

THIS ELECTRONIC DRAWING IS RELEASED AS A RECORD DOCUMENT ONLY AND IS NOT TO BE USED FOR ANY OTHER PURPOSE. THESE RECORD DOCUMENTS HAVE BEEN PREPARED BASED ON INFORMATION PROVIDED BY OTHERS. THE CONSULTANT HAS NOT VERIFIED THE ACCURACY AND/OR COMPLETENESS OF THIS INFORMATION AND SHALL NOT BE RESPONSIBLE FOR ANY ERRORS OR OMISSIONS THAT MAY BE INCORPORATED AS A RESULT OF ERRONEOUS INFORMATION PROVIDED BY OTHERS.

THE USER OF THIS DRAWING FILE AGREES TO ASSUME ALL RESPONSIBILITY FOR ALL MODIFICATIONS TO OR USE OF THIS DRAWING FILE THAT ARE INCONSISTENT WITH THE REQUIREMENTS OF THE RULES AND THE REGULATIONS OF THE TEXAS BOARD OF PROFESSIONAL ENGINEERS. THIS DRAWING MUST NOT BE ALTERED WITHOUT THE ENGINEER'S KNOWLEDGE AND/OR APPROVAL.

THE ORIGINAL SIGNED, ENGINEER SEALED AND DATED DRAWINGS MAY BE REVIEWED AT THE OFFICES OF JASTER-QUINTANILLA DALLAS, LLP UPON REQUEST.

TEXAS REGISTERED ENGINEERING FIRM: F-1294
 ENGINEER: THOMAS C. PICKERING
 TEXAS REGISTRATION OR LICENSE NUMBER: 87183
 DATE: 08-18-15

Legend

- PROPOSED CONCRETE SIDEWALK (SEE 13/C8.0)
- PROPOSED 8" CONCRETE PAVEMENT (SEE 01/C8.0)
- PROPOSED BRICK PAVERS (REFER TO ARCH.)
- PROPOSED FIRE LANE STRIPING

Paving Plan Notes

1. EXISTING TOPOGRAPHIC SURVEY AND LOCATION OF PHYSICAL FEATURES WERE OBTAINED FROM A TOPOGRAPHIC SURVEY PERFORMED BY RLG DATED 2/25/2013.
2. ALL PARKING STRIPING SHALL BE 4" WIDE UNLESS OTHERWISE NOTED.
3. UNLESS OTHERWISE NOTED, REFER TO GEOTECHNICAL REPORT FOR SUBGRADE COMPACTION AND MOISTURE CONTENT REQUIREMENTS.
4. INSTALLATION AND PLACEMENT OF IRRIGATION SLEEVES AND UTILITY CONDUITS SHALL BE IN ACCORDANCE TO THE ARCHITECT'S LANDSCAPE PLANS AND/OR MEP PLANS.
5. SIDEWALKS SHALL HAVE A SLOPE NO GREATER THAN 5% AND A CROSS SLOPE NOT GREATER THAN 2%, UNLESS OTHERWISE NOTED.
6. SAWED JOINTS SHALL BE SPACED AT INTERVALS OF 12 FEET MAXIMUM AND AT ALL RADIUS RETURNS. SAWED JOINTS SHALL BE PERPENDICULAR TO ALL CURVES. JOINTS SHALL BE SAWED WITHIN 12 HOURS AFTER CONCRETE IS POURED.
7. SAWED JOINTS SHALL MATCH THE EXISTING PAVEMENT JOINT PATTERN WHERE NEW PAVEMENT IS CONSTRUCTED ADJACENT TO EXISTING CONCRETE PAVEMENT.
8. ALL MANHOLES, INLETS, LIGHT BASES, AND OTHER STRUCTURES SHALL BE ISOLATED FROM THE NEW PAVEMENT WITH PREFORMED ASPHALTIC EXPANSION MATERIAL.
9. ADJUST EXISTING TOP OF MANHOLE RIMS AND EXISTING WATERLINE VALVE BOXES TO FINISHED GRADE ELEVATIONS.
10. FOR PAVING PATTERNS, FINISHES AND MATERIALS REFER TO ARCHITECTURAL DRAWINGS.
11. NEW IRRIGATION SLEEVES SHOWN HEREON ARE FOR REFERENCE ONLY AND SHOULD BE CONSIDERED APPROXIMATE. REFER TO LANDSCAPE DRAWINGS FOR EXACT LOCATIONS.
12. CONTRACTOR TO REPLACE EXISTING FIRE LANE STRIPING AS NEEDED.

Keynotes

- 1 CONCRETE CURB AND GUTTER (REFER TO 03/C8.0)
- 2 BARRIER FREE RAMP (REFER TO 02/C8.2)
- 3 FENCING, REFER TO ARCH.
- 4 PARKING STRIPING, TYP. (REFER TO 12/C8.0)
- 5 FIRE LANE STRIPING, TYP. (REFER TO 08/C8.1)
- 6 STRUCTURED SLAB
- 7 RAMP WITH HANDRAILS, REFER TO ARCH./STRUCT.
- 8 SIDEWALK FLUME (REFER TO 10/C8.0)
- 9 CONCRETE FLUME (REFER TO 03/C8.2)
- 10 RETAINING WALL (REFER TO 06/C8.1)
- 11 CURB DRAIN (REFER TO 09/C8.1)
- 12 WHEEL STOP, TYP. (REFER TO 02/C8.1)
- 13 BOLLARD, TYP. (REFER TO 07/C8.1)
- 14 HANDICAP PARKING SIGNAGE, TYP. (REFER TO 11/C8.0)
- 15 PARALLEL CURB RAMP (REFER TO 04/C8.2)

BENCHMARKS:

- BM#1** SQUARE CUT AT THE SOUTH END OF THE HEADWALL ALONG EAST LINE OF HIGHWAY 205 IN FRONT OF THE J.E.R. CHILTON AQUATIC CENTER (YMCA), 400' ± NORTH OF CARUTH LANE. ELEVATION = 475.64
- BM#2** 60D NAIL IN THE NORTH SIDE OF A FIELD LIGHT POLE AT THE WEST END OF THE MOST SOUTHEAST PLAYING FIELD. ELEVATION = 479.14
- BM#3** STAINLESS STEEL ROD INSIDE ACCESS COVER AT THE INTERSECTION OF STATE HIGHWAY 66 (WILLIAMS STREET), 70.5 FEET SOUTHWEST OF THE SOUTHWEST CORNER OF A HOUSE AT 504 NASH STREET, 70.2 FEET NORTHWEST OF THE CENTERLINE OF THE HIGHWAY, 19.7 FEET EAST OF THE CENTERLINE OF THE STREET, NORTH OF UTILITY POLE NUMBER 2321 462 0067, AND 1.0 FOOT WEST OF THE WEST EDGE OF A SIDEWALK. ELEVATION = 550.99

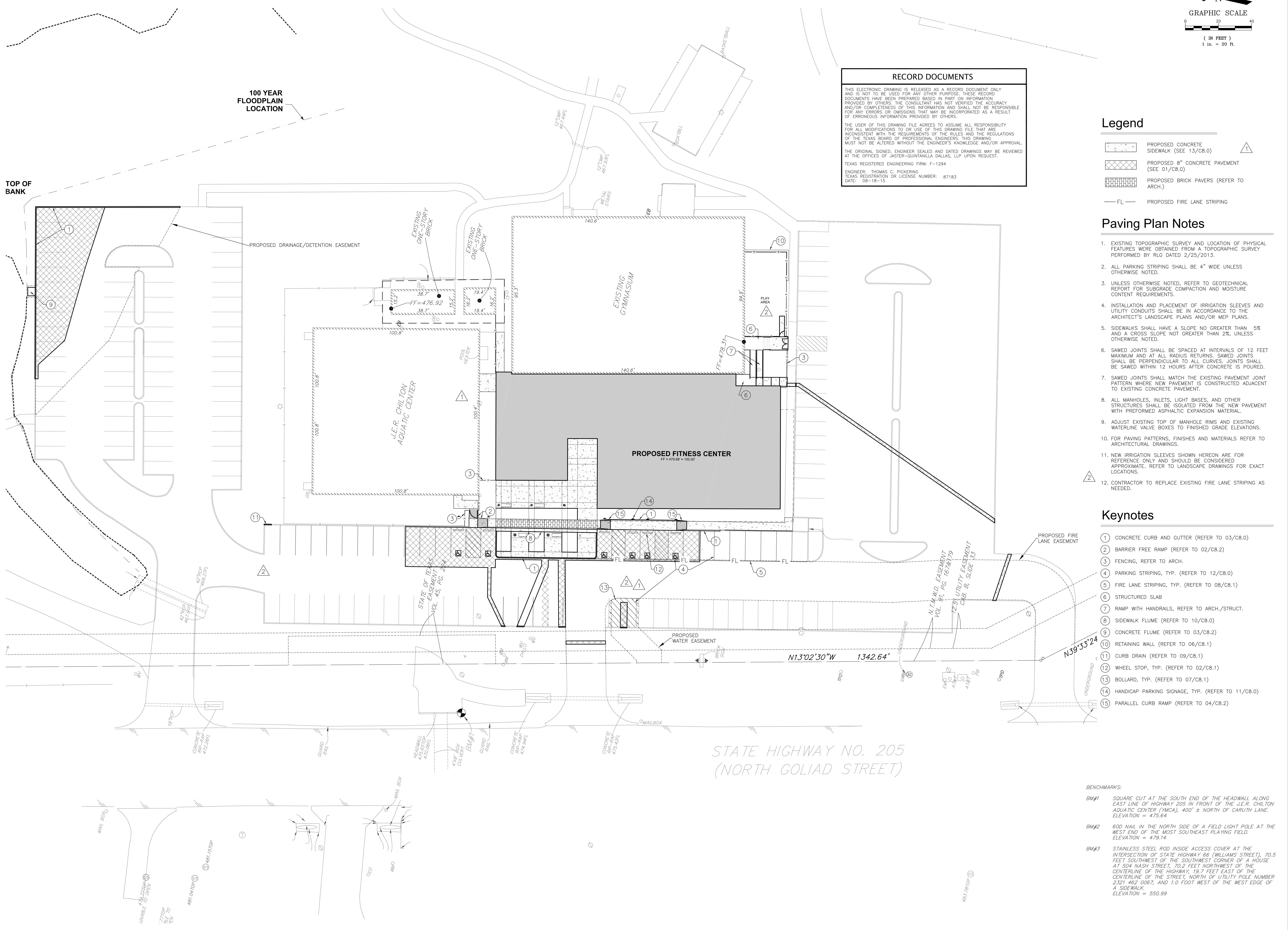

STATE HIGHWAY NO. 205
(NORTH GOLIAD STREET)

BROWN REYNOLDS WATFORD ARCHITECTS
 1200 W. WYOMING STREET
 SUITE 220
 DALLAS, TEXAS 75204
 214.528.8704
 WWW.BRWARCH.COM

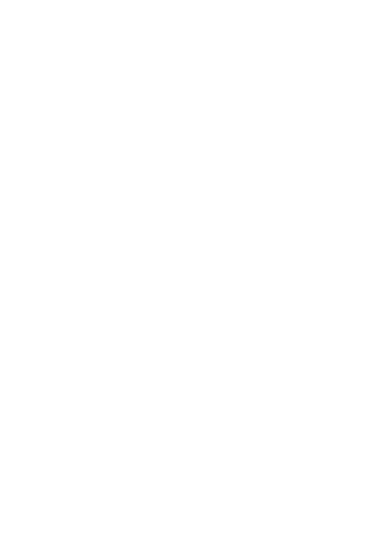

JASTER-QUINTANILLA DALLAS, LLP
 2300 GARDNER STREET
 SUITE 1000
 DALLAS, TEXAS 75201
 214.528.8704

BROWN REYNOLDS WATFORD ARCHITECTS, INC.
 DATE: NOVEMBER 26, 2013
 DRAWN BY: JB
 CHECKED BY: JDD
 BRW PROJECT NUMBER: 21306100

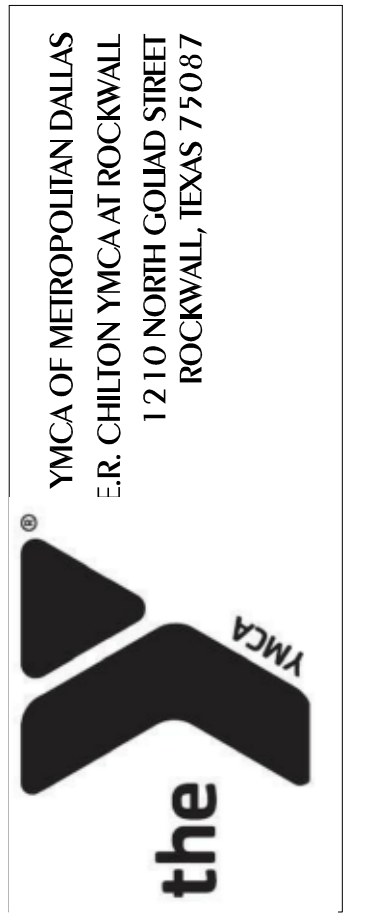

No.	Description	Date
1	ADDENDUM 1	12/9/2013
2	AS1/2	3/11/2014
3	RECORD DOC.	8/18/2015

C3.0

PAVING PLAN