

THE SEAL APPEARING ON THIS DOCUMENT WAS AUTHORIZED BY W.L. DOUPHRATE II TEXAS P.E. NO. 60102 ON 5/10/04

DOUPHRATE & ASSOCIATES, INC.
 ENGINEERING - PROJECT MANAGEMENT - SURVEYING
 2235 RIDGE RD., # 200 ROCKWALL, TEXAS 75087
 PHONE: (972)771-9004 FAX: (972)771-9005

STORM SEWER PROFILE (LINE - E)
 ROCKWALL CROSSING
 26.09 AC.
 CITY OF ROCKWALL, ROCKWALL COUNTY, TEXAS

REVISION	
CHECKED	W.L.D.
DRAWN	Y.B.
DATE	10/15/04
PROJECT	0242

LINE : "E"

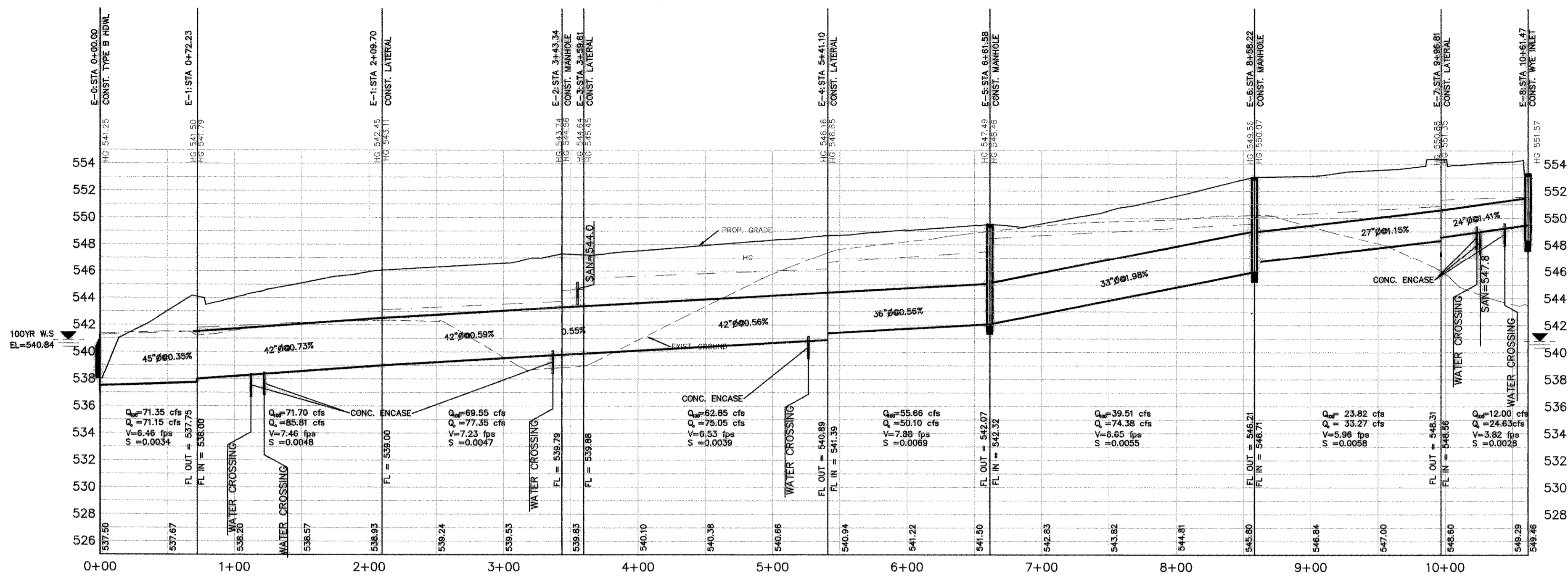

BR: "E-6"

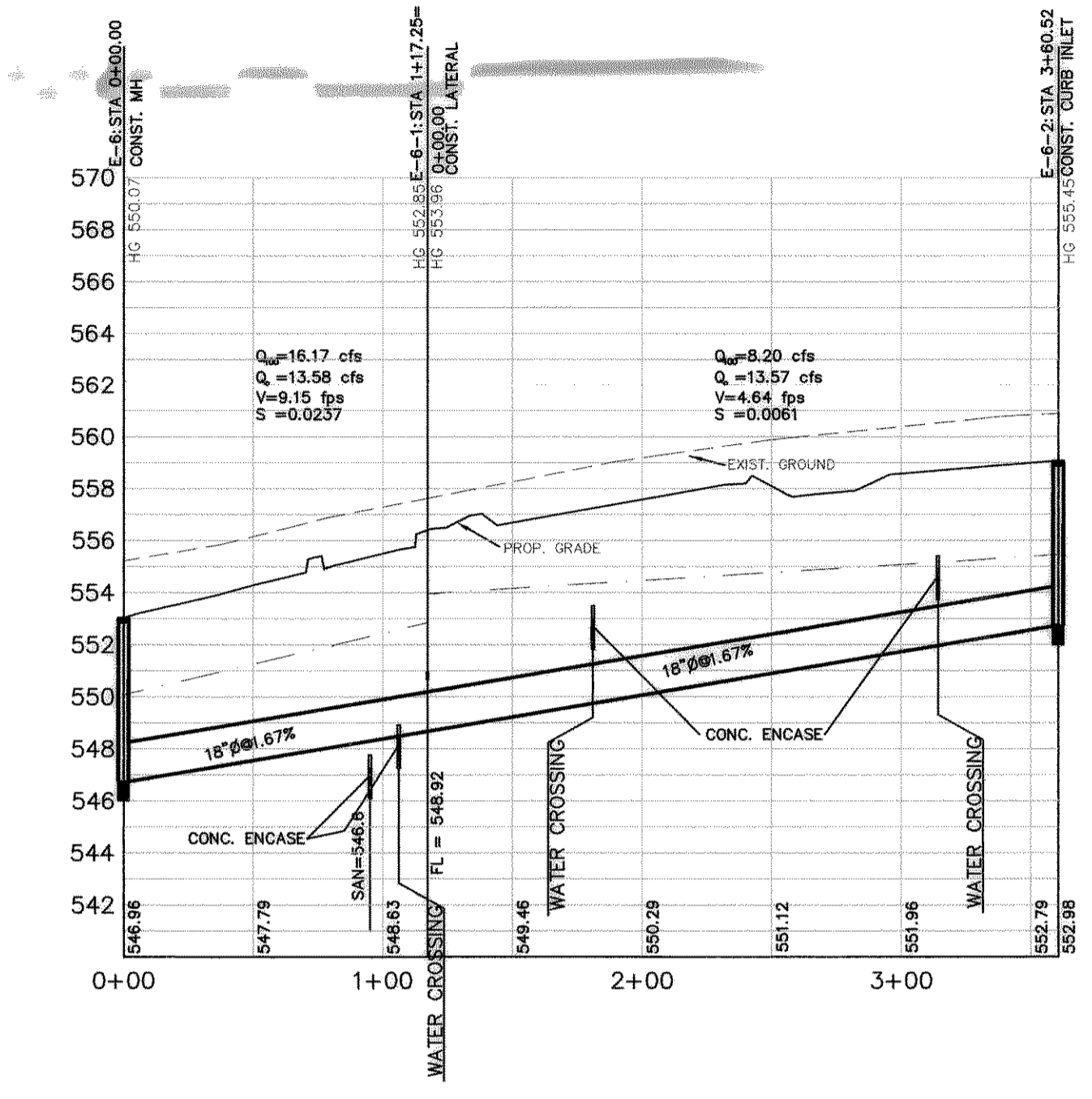

BR: "E-6-1"

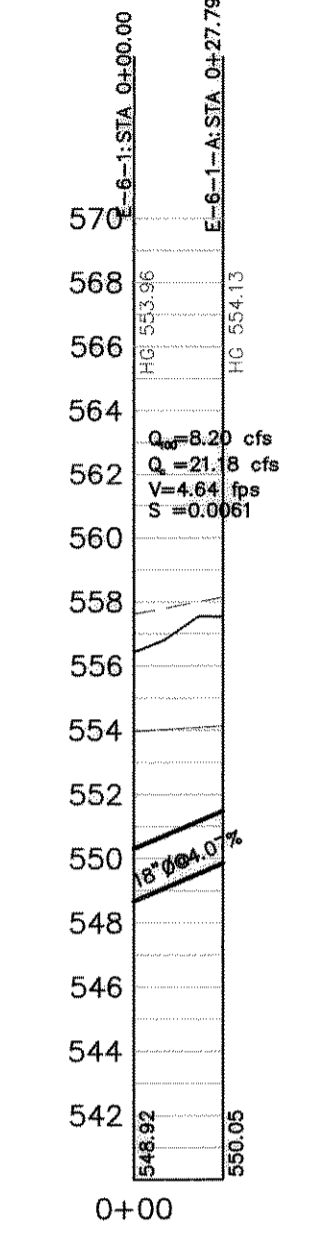

BR: "E-1"

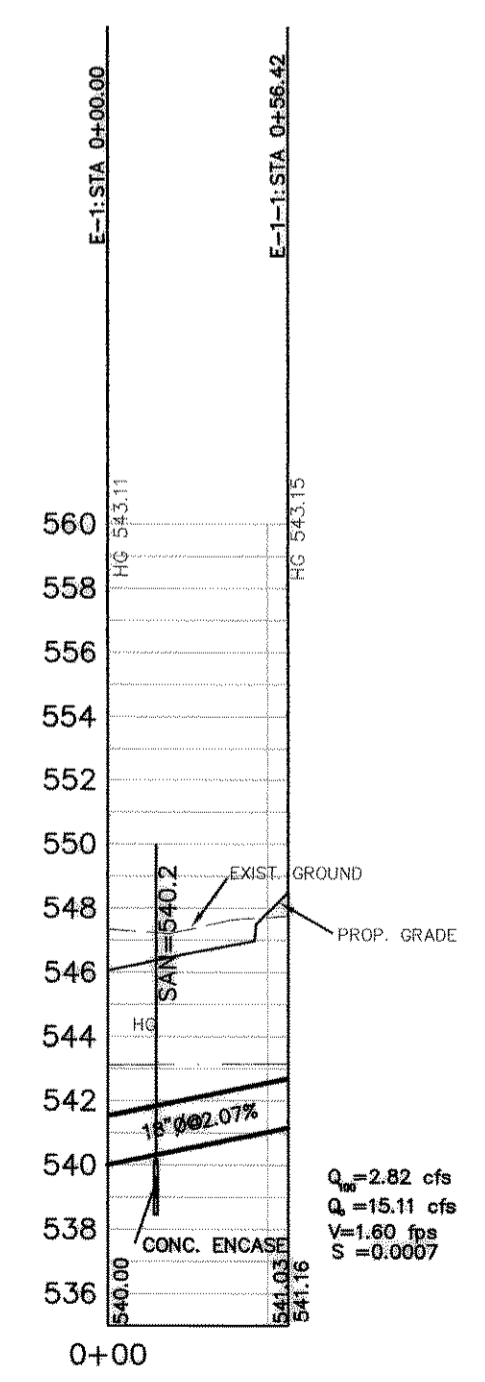

BR: "E-3"

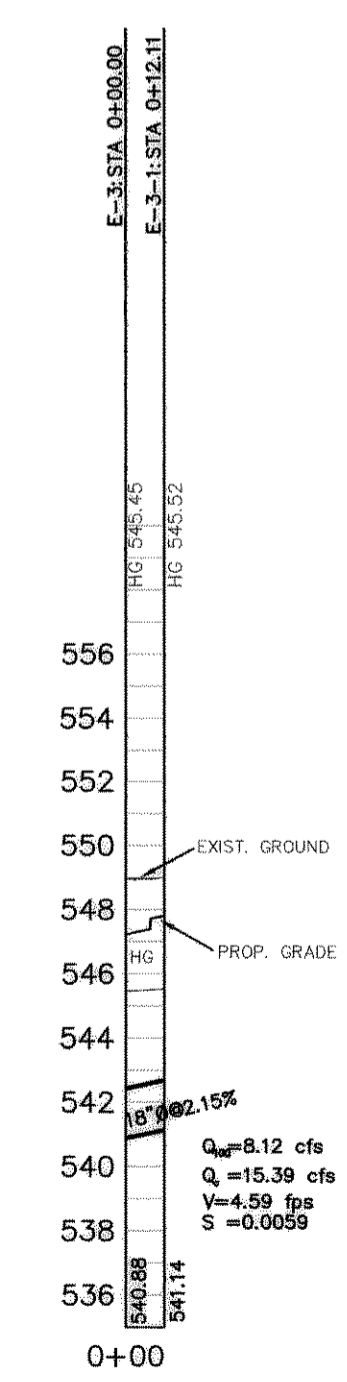

BR: "E-4"

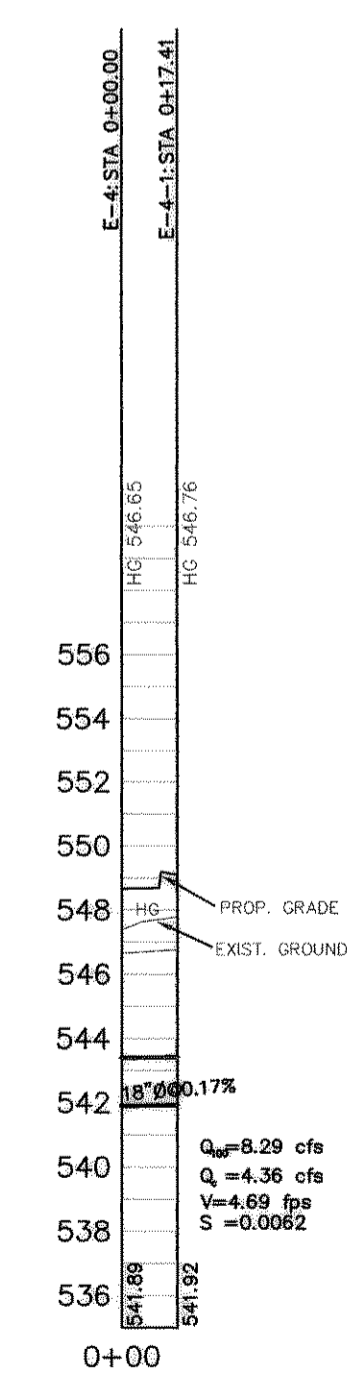

BR: "E-5"

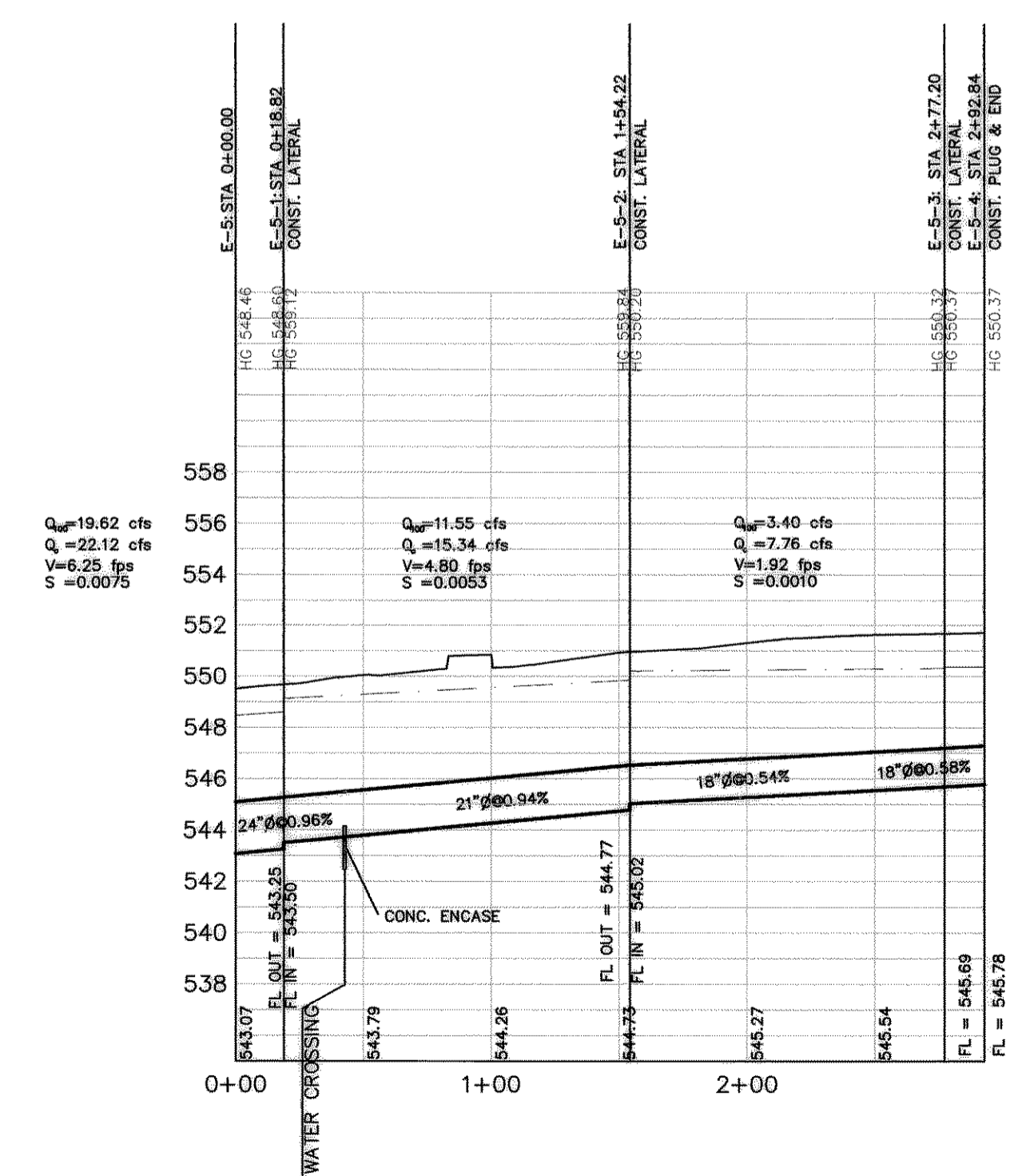

BR: "E-5-1"

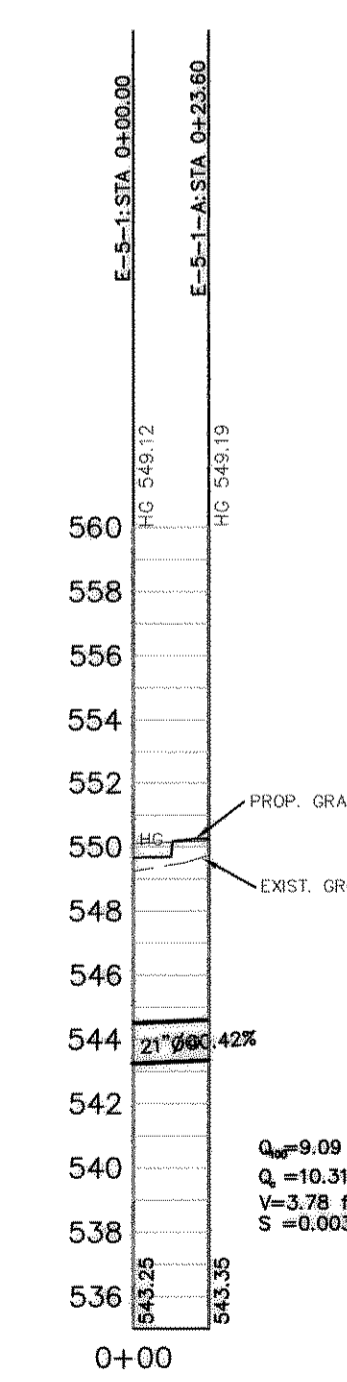

BR: "E-5-2"

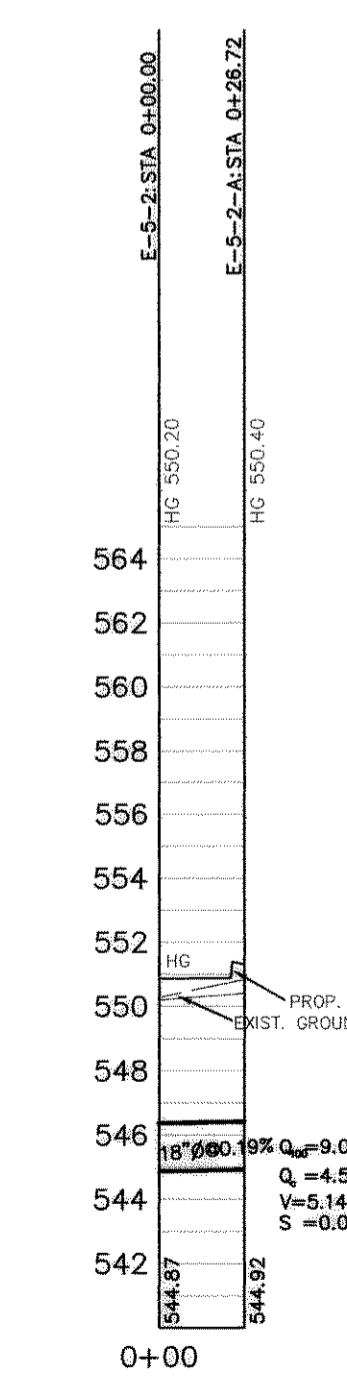

BR: "E-5-3"

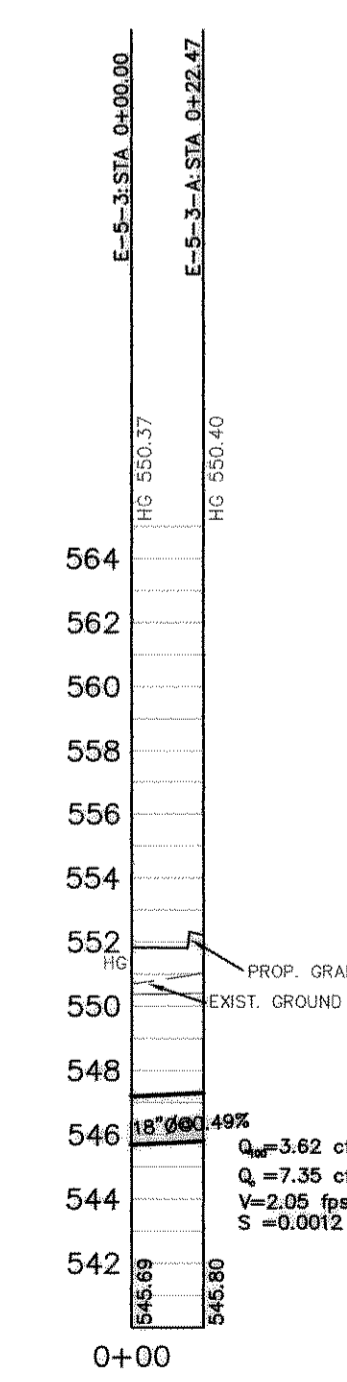

BR: "E-7"

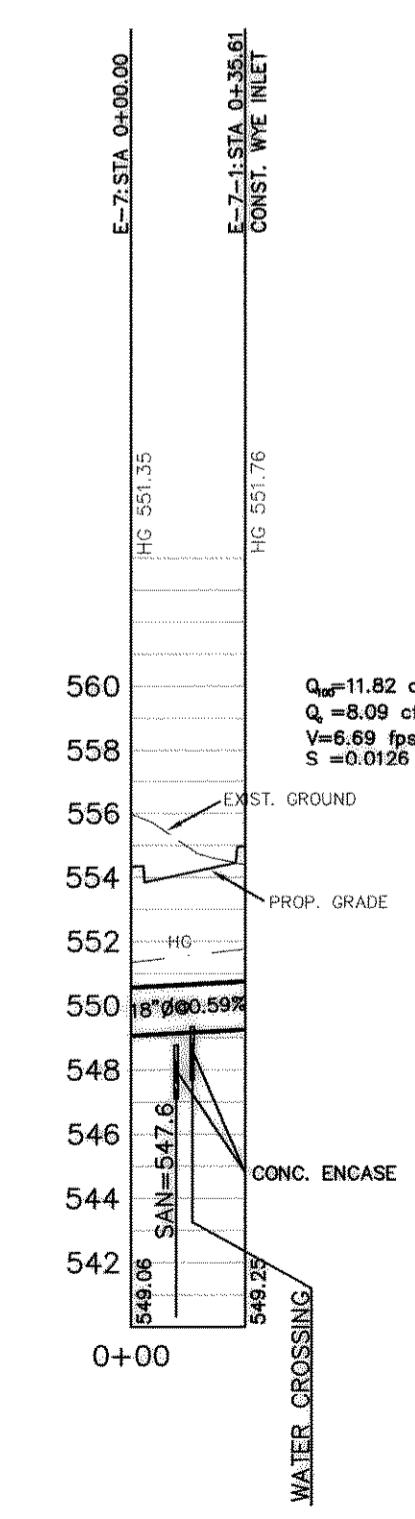

GENERAL NOTES

- ALL STORM WATER PIPES MUST BE RCP UNLESS NOTED OTHERWISE.

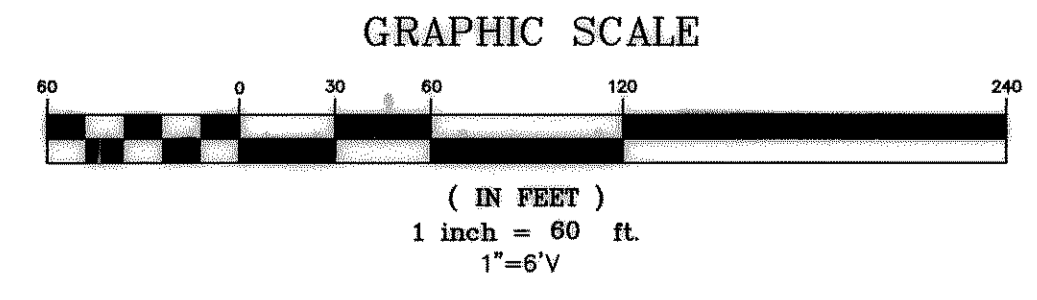

REVISED TO CONFORM TO CONSTRUCTION RECORDS.
 DATE: 5/14/04