

This drawing is an instrument of service and the property of e group landscape architecture. It is to be used only for the project and site for which it was prepared and no part of it shall be reproduced or published in any form without the written consent of e group landscape architecture.

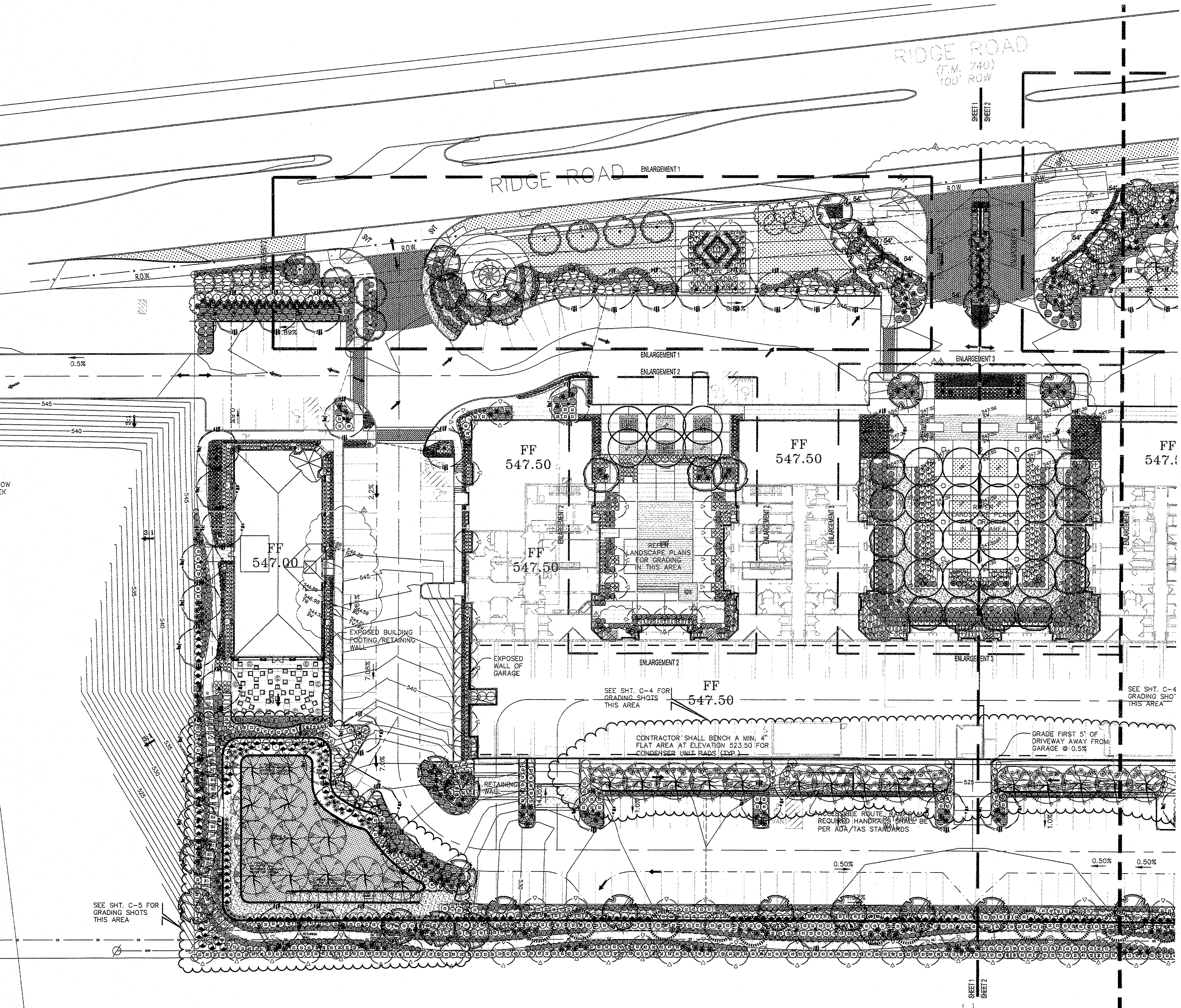

PLANT LEGEND

ACCENT TREES	BOTANICAL / COMMON NAME	SIZE	QTY
Yucca parviflora	CHINESE ELM	48" BOX STANDARD	32
Quercus virginiana	LIVE OAK	48" BOX STANDARD	77
Magnolia grandiflora	Little Gem	38" BOX STANDARD	16
Leguminosae indica	Wisteria	38" BOX STANDARD	7
Juniper chinensis		48" BOX MULTI-TRUNK	16
Acacia saligna	WILLOW MYRTLE	64/48" BOX MULTI-TRUNK	1/40
Prosopis glandulosa	TEXAS HONEY MESQUITE	54" BOX MULTI-TRUNK	56
Pyrus calleryana	BALD CYPRESS	54" BOX STANDARD	12
Brachyglottis	BALD CYPRESS	54" BOX STANDARD	16

SHRUBS	SIZE	QTY
Yucca parviflora	5 GAL	12
Fraxinus pennsylvanica	6" O.C. MIN	2/8
Fraxinus pennsylvanica	9" O.C. MIN	2/4
Juniper chinensis	1 GAL	224
Blue Yucca	4" O.C.	188
Hamamelis virginiana	5 GAL	8
Fraxinus pennsylvanica	tree form	8
Leguminosae indica	Dwarf White	176
Quercus virginiana	5 GAL	106
Indian Hawthorne	3" O.C.	308
Pyrus calleryana	5 GAL	130
Nandina domestica	2" O.C.	130
Dwarf Nandina	2" O.C.	130

GROUND COVERS	SIZE	QTY
Trichostema aedonum	1 GAL	2038
ASATICO LASHINE	3" O.C.	434
Juniper chinensis	5 GAL	127
TAM JUNIPER	4" O.C.	127
Abelia grandiflora	1 GAL	162
GLOSSY ABELIA	4" O.C.	162
Hemerocallis sp.	1 GAL	47
DAILY	2" O.C.	47
Eucalyptus japonica	1 GAL	87
VARIEGATED EVERGREEN EUONYMUS	3" O.C.	87
Zephyranthes x Prati Sunset	1 GAL	87
RAIN LILY	1 GAL	87

ACCENTS	SIZE	QTY
Yucca parviflora	5 GAL	347
SOFT LEAF YUCCA	5" O.C.	78
Pennisetum setaceum	5 GAL	61
PURPLE FOUNTAIN GRASS	5 GAL	61
Muhlenbergia lutea	5 GAL	144
OW	4" O.C.	144
Muhlenbergia capensis	5 GAL	240
REGAL MIST	5 GAL	240
Hesperis matronalis	1 GAL	x
RED YUCCA	3" O.C.	x
Annularis	4" Container	x

POTS	CITY PER POT + SIZE	TOTAL QTY.
POT 'A' - CALIFORNIA CR-CAL-9822T	14	14
Pennisetum setaceum	14	14
PURPLE FOUNTAIN GRASS	(6) 6 GAL	140
Annularis	(10) 4" CONTAINER	140
POT 'B' - CALIFORNIA CR-CAL-8038P	14	14
Magnolia grandiflora	(8) 38" BOX STANDARD	14
MAGNOLIA	(2) 1 GAL	168
Hemerocallis sp.	(2) 1 GAL	322
DAILY	(23) 4" CONTAINER	322
POT 'C' - CASCADE CR-CE3636 WITH SAUCER	9	9
Leguminosae indica	(8) 15 GAL	9
PINK GRAPE MYRTLE	(8) 15 GAL	45
Eucalyptus japonica	(6) 1 GAL	45
VARIEGATED EVERGREEN EUONYMUS	(6) 1 GAL	45
Annularis	(6) 1 GAL	45
WHITE FLOWER PER SEASONALLY AVAILABLE SELECTIONS		

MATERIALS	QTY
SURFACE SELECT BOLDERS 3/4" X 3/4"	25
500 Gg 10 TEXTURF 10 HYBRID BERMLUDA	23,970 SF
BARK MULCH IN ALL PLANTING AREAS UNLESS OTHERWISE NOTED ON PLAN	87,285.61 SF

NOTES

- PREPARE GRADES TO ROTOCUT OR DEEP TO BLEND 8" OF A MIXTURE OF ORGANIC MATTER TO ALL PLANTING AREAS.

KEY MAP LOCATION

8/27/04 CITY COMMENTS
 4/20/07 VE ITEM
 0/07 OWNER COMMENTS

DESIGN REVIEW
 DESIGN DEVELOPMENT
 CONSTRUCTION DOCUMENTS
 SUBMITTING PACKAGE
 CONSTRUCTION ISSUE

MAY 10, 2004

LM, TM, MM, JL, RV
 MS, ZK
 20042

PERMIT SUBMITTAL

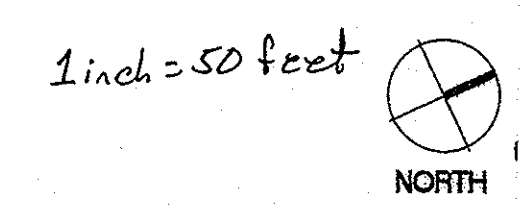

RECORD DRAWING
 THIS RECORD DRAWING HEREIN REFLECTS TO THE BEST OF THE DESIGN ENGINEER'S KNOWLEDGE, THE APPROXIMATE LOCATION OF THE CONSTRUCTED WORK, USING INFORMATION AS PROVIDED BY THE CONTRACTORS AND SURVEYED GRADES.

e group
 landscape architecture
 environmental design inc.

817 North Central Avenue
 Phoenix, Arizona 85004
 602-462-9000
 Fax: 602-462-9001
 www.egroupinc.com

ROCKWALL COMMONS
 ROCKWALL, TEXAS

TF. STONE COMPANY
 18600 Dallas Pkwy #400
 Dallas, Texas 75248
 (972) 5012691

HUMPHREYS & PARTNERS
 ARCHITECTS, L.P.

1385 ALPHEUS DR. DALLAS, TEXAS 75246
 (972) 751-1600 • (972) 751-1600 FAX
 DALLAS • LOS ANGELES
 CHARLOTTE • LOS ANGELES