

STORM WATER FLUME DETAIL
NTS

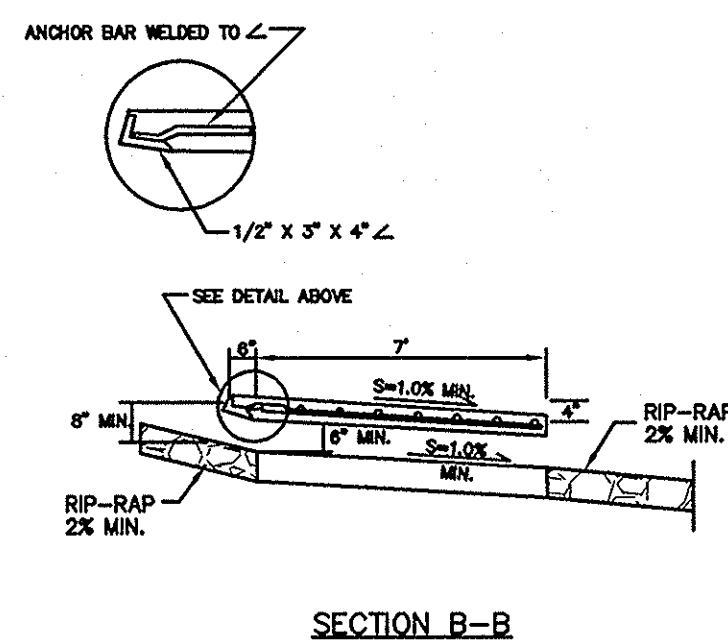

SECTION B-B

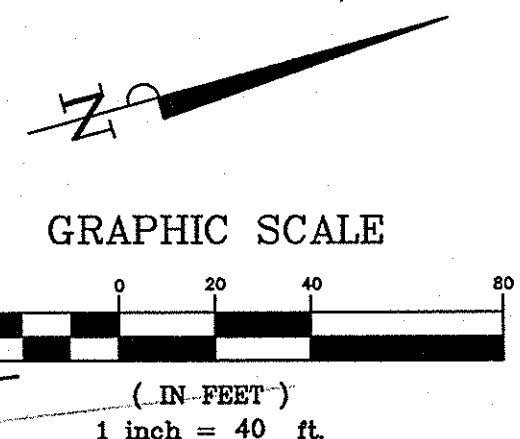

1. EXPANSION JOINT FILLER SHALL BE 1/2" BITUMINOUS TYPE PERFORMED EXPANSION JOINT FILLER, ASTM D-1701

PLAN VIEW

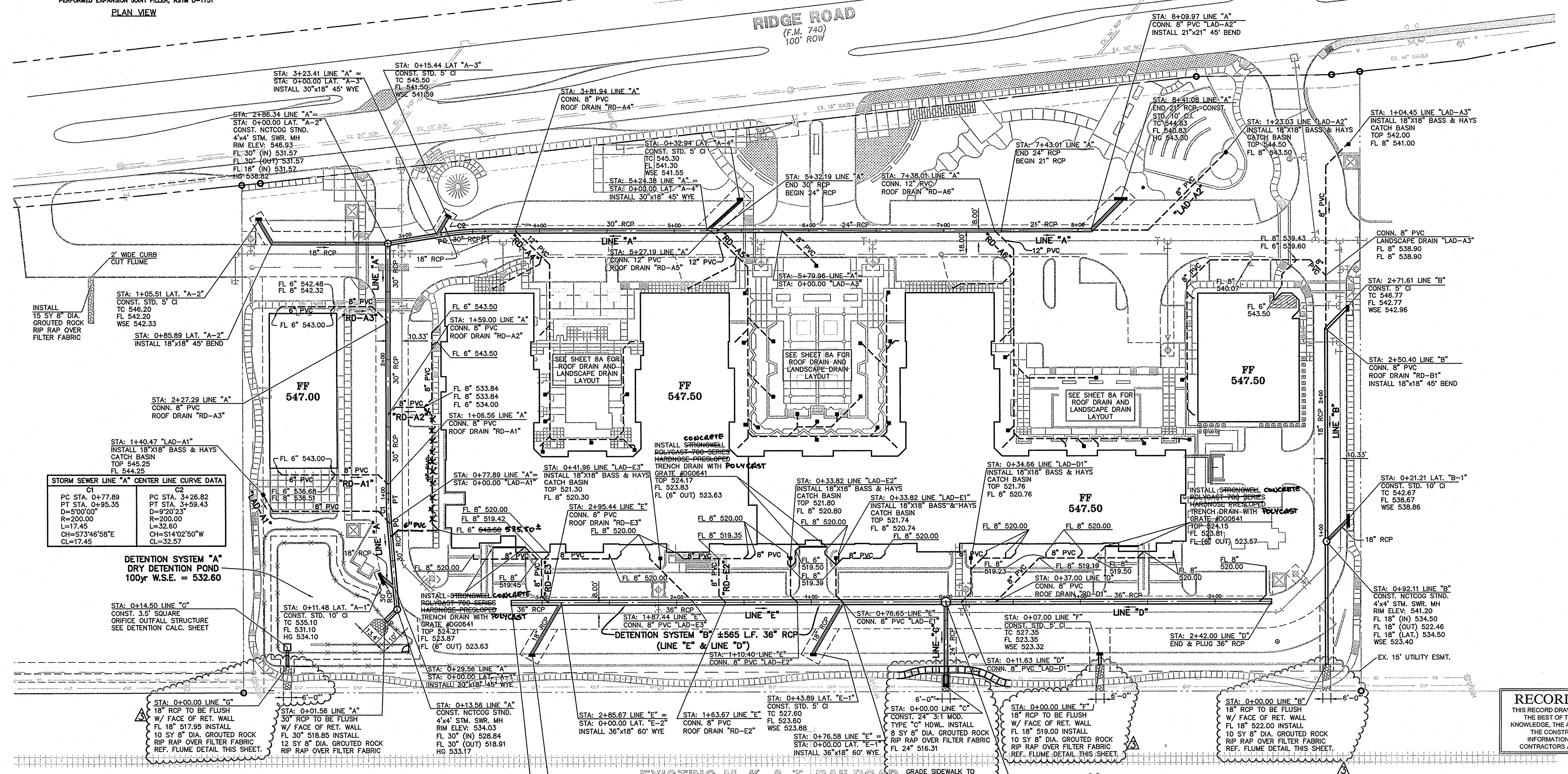

STORM SEWER LINE "A" CENTER LINE CURVE DATA	
C1	C2
PC STA. 0+77.89	PC STA. 3+26.82
PT STA. 0+95.35	PT STA. 3+59.43
D=500'00"	D=920'23"
R=200.00	R=200.00
L=17.45	L=32.60
CH=573°46'58"E	CH=514°02'50"W
CL=17.45	CL=32.57

DETECTION SYSTEM "A"
DRY DETENTION POND
100yr W.S.E. = 532.60

RECORD DRAWING
THIS RECORD DRAWING HEREIN REFLECTS TO THE BEST OF THE DESIGN ENGINEER'S KNOWLEDGE, THE APPROXIMATE LOCATION OF THE CONSTRUCTED WORK, USING INFORMATION AS PROVIDED BY THE CONTRACTORS AND SURVEYED GRADES.

NOTES

- SEE MEP AND ARCH PLANS FOR ROOF DRAIN AND DOWNSPOUT CONNECTIONS INTO BUILDING.
- STORM SEWER LINES STUD 5 FEET FROM BUILDING FOR SERVICE CONNECTIONS UNLESS OTHERWISE SHOWN.
- CONTRACTOR TO ADJUST MANHOLE RIM ELEVATIONS TO FINISHED GRADE.

BENCHMARKS:

ROCKWALL MONUMENT R500-1: CONC. MONUMENT IN CENTER MEDIAN OF SUMMIT RIDGE DRIVE, WEST OF RIDGE RD.	ELEV: 578.63
"I" SET IN MEDIAN NOSE RIDGE ROAD ±193 FEET SOUTH OF SW PROPERTY CORNER.	ELEV: 546.15
"I" SET ON INLET WEST CURB LINE RIDGE ROAD, ±165 SOUTH OF NW PROPERTY CORNER	ELEV: 553.07

THE CONTRACTOR SHALL FIELD VERIFY THE HORIZONTAL AND VERTICAL LOCATIONS OF ALL EXISTING UTILITIES PRIOR TO START OF CONSTRUCTION AND SHALL NOTIFY THE CONSTRUCTION MANAGER AND ENGINEER OF ANY CONFLICTS DISCOVERED. CONTRACTOR IS RESPONSIBLE FOR PROTECTING EXISTING UTILITIES (SHOWN OR NOT SHOWN) WITHIN SCOPE OF CONSTRUCTION. IF ANY EXISTING UTILITIES ARE DAMAGED, THE CONTRACTOR SHALL REPLACE THEM AT HIS OWN EXPENSE, CALL 1-800-DIG-TESS AT LEAST 72 HOURS PRIOR TO COMMENCING CONSTRUCTION IN VICINITY.

SEE SHEET C-1 FOR CONSTRUCTION NOTES

AS SHOWN	App.
Designed by: J.G.W.	P.D.K.
Drawn by: J.G.W./B.B.P.	Revisions
Checked by: P.D.K.	Date
Date: 01/23/07	No.
Project No. 067051007	01/23/07

Kimley-Horn and Associates, Inc.
Tel. No. (972) 355-3860
Fax No. (972) 355-3779
Suite 320
8300 West Branchwood
Frisco, Texas 75035

STATE OF TEXAS
PIETER D. KESSELS
87775
LICENSED PROFESSIONAL ENGINEER
01-23-2007

**ROCKWALL COMMONS
MIXED USE TRACT
CITY OF ROCKWALL, TEXAS**

**STORM SEWER
PLAN**