

**OFF-SITE SANITARY SEWER LINE "A"**

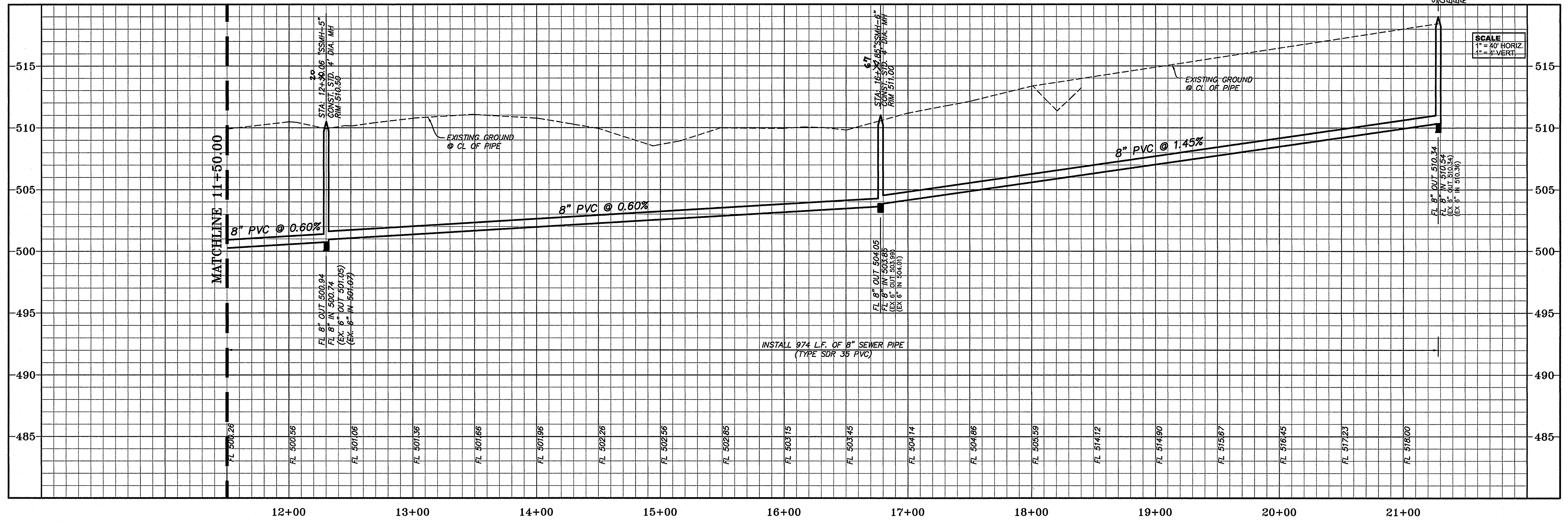

**NOTE**  
 PROPOSED SANITARY SEWER LINE TO BE CONSTRUCTED 4.0' FROM EXISTING SANITARY SEWER LINE NOT 6.0'. PLEASE NOTE THAT DRAWING DOES NOT REFLECT THIS CHANGE. CONTRACTOR SHALL BE RESPONSIBLE FOR THE ADJUSTMENT OF SANITARY SEWER MANHOLES AND SANITARY SEWER LINE BEARINGS, DISTANCES, ETC. IN THE FIELD TO REFLECT THIS 2' CHANGE. CONTRACTOR SHALL CONTACT CIVIL ENGINEER PRIOR TO CONSTRUCTION.

**NOTE**  
 THE CONTRACTOR SHALL FIELD VERIFY THE HORIZONTAL AND VERTICAL LOCATIONS OF ALL EXISTING UTILITIES PRIOR TO START OF CONSTRUCTION AND SHALL NOTIFY THE CONSTRUCTION MANAGER AND ENGINEER OF ANY CONFLICTS DISCOVERED. CONTRACTOR IS RESPONSIBLE FOR PROTECTING EXISTING UTILITIES (SHOWN OR NOT SHOWN) WITHIN SCOPE OF CONSTRUCTION. IF ANY EXISTING UTILITIES ARE DAMAGED, THE CONTRACTOR SHALL REPLACE THEM AT HIS OWN EXPENSE. CALL 1-800-DIG-TESS AT LEAST 72 HOURS PRIOR TO COMMENCING CONSTRUCTION IN VICINITY.

BEGINNING @ STA: 2+38.84 TO STA: 21+28.07  
 PROPOSED 8" SANITARY SEWER TO PARALLEL  
 EXISTING 6" SANITARY SEWER. EXISTING SANITARY  
 SEWER MH FLOWS INDICATED IN PROFILE WITH "(EX)"

- NOTE:**
- CONTRACTOR TO ADJUST MH RIM ELEVATIONS TO APPROX. 1' ABOVE EXIST. GRADE
  - DETECTABLE METALLIC TAPE SHALL BE INSTALLED OVER THE ENTIRE LENGTH OF THE OFF-SITE SANITARY SEWER.

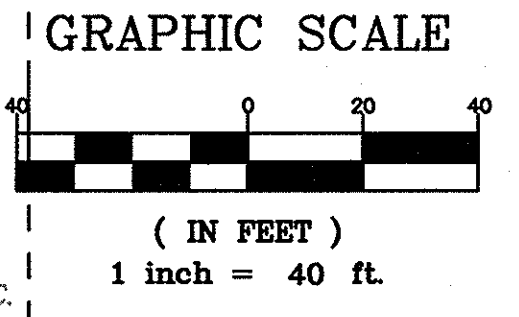

**BENCHMARKS:**  
 ROCKWALL MONUMENT R500-1:  
 CONC. MONUMENT IN CENTER  
 MEDIAN OF SUMMIT RIDGE DRIVE,  
 WEST OF RIDGE RD.  
 ELEV: 578.63  
 "T" SET IN MEDIAN NOSE RIDGE  
 ROAD ±193 FEET SOUTH OF SW  
 PROPERTY CORNER.  
 ELEV: 546.15  
 "T" SET ON INLET WEST CURB  
 LINE RIDGE ROAD, ±155 SOUTH  
 OF NW PROPERTY CORNER  
 ELEV: 553.07

**RECORD DRAWING**  
 THIS RECORD DRAWING HEREIN REFLECTS TO THE BEST OF THE DESIGN ENGINEER'S KNOWLEDGE, THE APPROXIMATE LOCATION OF THE CONSTRUCTED WORK, USING INFORMATION AS PROVIDED BY THE CONTRACTORS AND SURVEYED GRADES.

No.	Date	Revisions	App.
1/A	10/13/04	RELOCATE OFF-SITE SAN. SWR.	P.D.K.

**Kimley-Horn and Associates, Inc.**  
 Tel. No. (972) 335-3550  
 Fax No. (972) 335-3779

9.40 AC.  
 HFS MANAGEMENT, INC.  
 VOL. 1194 PG. 256  
 D.R.R.C.T.

5900 Wade Boulevard, Suite 320  
 Frisco, Texas 75035

STATE OF TEXAS  
 PIETER D. KESSELS  
 87775  
 LICENSED PROFESSIONAL ENGINEER  
 10-13-2004

**ROCKWALL COMMONS  
 MIXED USE TRACT  
 CITY OF ROCKWALL, TEXAS**

**OFF-SITE  
 SANITARY SEWER  
 PLAN & PROFILE**

Scale: AS SHOWN  
 Designed by: P.D.K.  
 Drawn by: C.D.R.  
 Checked by: P.D.K.  
 Date: 05/25/04  
 Project No. 067051007