

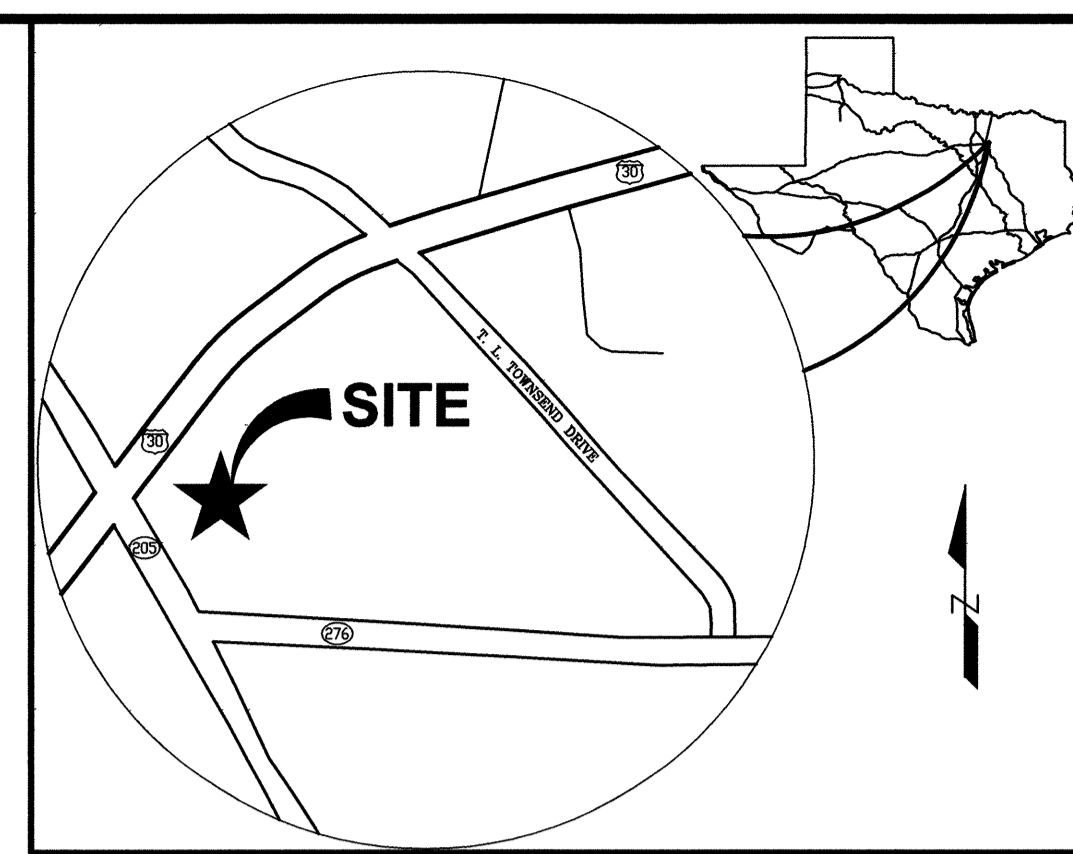

5728 LBJ Freeway
Suite 330
Dallas, Texas 75240
Phone: 972.490.1515
Fax: 972.490.1517

Certificate of
Authorization No. F4830
© 2008

Engineers
Surveyors
Architects
Planners
Landscape Architects
Environmental Scientists
Construction
Management
Design / Build



VICINITY MAP
N.T.S.

LOT 1, BLOCK 1
TOYOTA OF ROCKWALL
CABINET G, SLIDE 153-155,
P.R.R.C.T.

INTERSTATE HIGHWAY 30
(VARIABLE WIDTH R.O.W.)

NOTE:
ROADWAY ALIGNMENT AND ELEVATIONS
OF S.H. 205 AND I.H. 30 ARE BASED ON
TXDOT CONSTRUCTION PLANS (0451-01)
DATED MAY 17, 2006; CURRENTLY UNDER
CONSTRUCTION. CONTRACTOR TO
VERIFY ALL TIE-IN CONDITIONS AND
REPORT ANY DISCREPANCIES.

LOT 2
2.519 AC.
(109,710 S.F.)

LOT 3
2.951 AC.
(128,543 S.F.)

LOT 4
1.293 AC.
(56,313 S.F.)

LOT 5
1.228 AC.
(53,491 S.F.)

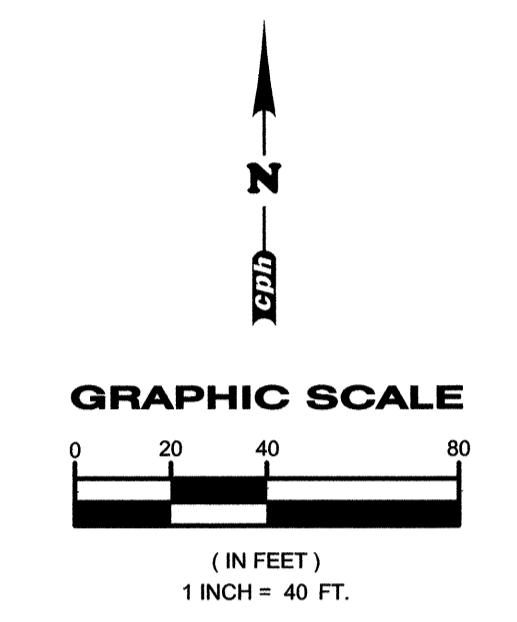

SITE PLAN LEGEND

[Symbol]	STANDARD DUTY CONCRETE
[Symbol]	PROPERTY RIGHT-OF-WAY
[Symbol]	PROP. EDGE OF PAVEMENT
[Symbol]	EASEMENT LIMITS
[Symbol]	PROP. WATER METER
[Symbol]	PROP. FIRE HYDRANT
[Symbol]	PROP. SANITARY SEWER M.H.
[Symbol]	PROP. WYE INLET

Date	By	Revision
05/04/09	WAS	PER AS-BUILTS
07/09/09	WAS	PER CLIENT REQUEST
11/08/08	WAS	NO CHANGES TO THIS SHEET
09/23/08	WAS	PER CO#1 AND RF#3
08/04/08	WAS	NO CHANGES TO THIS SHEET
06/26/08	WAS	NO CHANGES TO THIS SHEET
06/03/08	WAS	NO CHANGES TO THIS SHEET
05/19/08	WAS	NO CHANGES TO THIS SHEET
03/07/08	WAS	NO CHANGES TO THIS SHEET
12/05/07	WAS	PER CITY COMMENTS 11/26/07
10/31/07	WAS	PER CITY COMMENTS 10/22/07

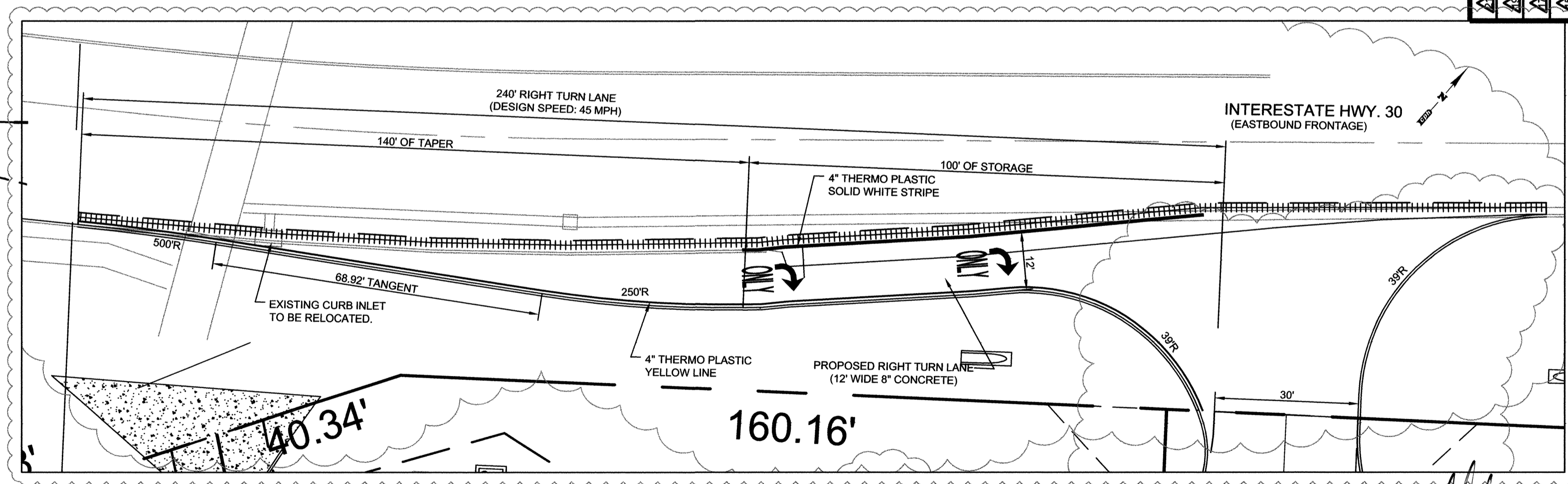

* FOR CONSTRUCTING WITHIN
TXDOT R.O.W., SEE TXDOT PAVING
AND STRIPING DETAIL SHEETS

RECORD DRAWING
TO THE BEST OF OUR KNOWLEDGE OPH
ENGINEERS, INC., HEREBY STATES THAT
THIS PLAN IS A REPRESENTATION OF THE
AS-BUILT CONDITIONS OF THE SUBJECT
PROJECT. THE INFORMATION PRESENTED IS
BASED ON INFORMATION PROVIDED BY THE
CONTRACTOR ALONG WITH DATA PROVIDED
BY THE PROJECT LAND SURVEYOR.

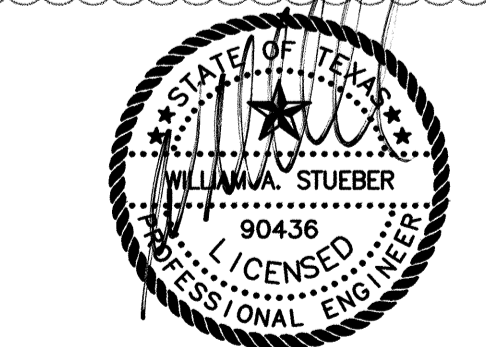

THE SEAL APPEARING ON THIS DOCUMENT WAS
AUTHORIZED BY WILLIAM A. STUEBER, P.E. 90436
ON 05/04/2009. ALTERATION OF A SEALED
DOCUMENT TO THE RESPONSIBLE ENGINEER IS
AN OFFENSE UNDER THE TEXAS ENGINEERING
PRACTICE ACT.

NOTICE
THE SIZE OF THIS PLAN MAY HAVE BEEN SLIGHTLY
ALTERED BY REPRODUCTION PROCESSES. THIS MUST
BE CONSIDERED WHEN SCALING ANY REPRODUCED
PLAN FOR THE PURPOSE OF COLLECTING DATA.

- SITE NOTES:**
- ALL WORK AND MATERIALS SHALL COMPLY WITH ALL CITY OF ROCKWALL REGULATIONS AND CODES AND O.S.H.A. STANDARDS.
 - ALL DISTURBED AREAS ARE TO RECEIVE FOUR INCHES OF TOPSOIL, SEED, MULCH AND WATER UNTIL A HEALTHY STAND OF GRASS IS ESTABLISHED.
 - EXISTING STRUCTURES WITHIN CONSTRUCTION LIMITS ARE TO BE ABANDONED, REMOVED OR RELOCATED AS NECESSARY. ALL COST SHALL BE INCLUDED IN BASE BID.
 - CONTRACTOR SHALL BE RESPONSIBLE FOR ALL RELOCATIONS, INCLUDING BUT NOT LIMITED TO, ALL UTILITIES, STORM DRAINAGE, SIGNS, TRAFFIC SIGNALS & POLES, ETC. AS REQUIRED. ALL WORK SHALL BE IN ACCORDANCE WITH GOVERNING AUTHORITIES SPECIFICATIONS AND SHALL BE APPROVED BY SUCH. ALL COST SHALL BE INCLUDED IN BASE BID.
 - TOPOGRAPHY, UTILITY AND ROAD INFORMATION TAKEN FROM A SURVEY BY ROCKWALL SURVEY COMPANY.
 - SITE BOUNDARY INFORMATION TAKEN FROM A SURVEY BY AJ DUMFORD SURVEY COMPANY.
 - HEAVY DUTY CONCRETE SHALL BE USED ON ALL FIRELANES AND BUMPSTER PADS. MINIMUM 3600PSI (6 SACK MACHINE PLACED, 6-1/2 SACK HAND PLACED)
 - FIRE LANES TO BE MARKED IN ACCORDANCE WITH THE CITY OF ROCKWALL SPECIFICATIONS. SEE SHEET C-21 FOR FIRE LANE MARKING DETAILS.

Date	By	Revision
10/19/2007	WAS	1" = 40'
11/15/07	WAS	PER CITY COMMENTS 11/05/07
10/19/07	WAS	PER CLIENT'S NEW SITE LAYOUT

SITE DIMENSION PLAN
ROCKWALL CENTRE CORNERS
INTERSTATE HIGHWAY 30 AND S.H. 205
CITY OF ROCKWALL, ROCKWALL COUNTY, TEXAS

Sheet No.
C-8