

SCALE: 1" = 100'

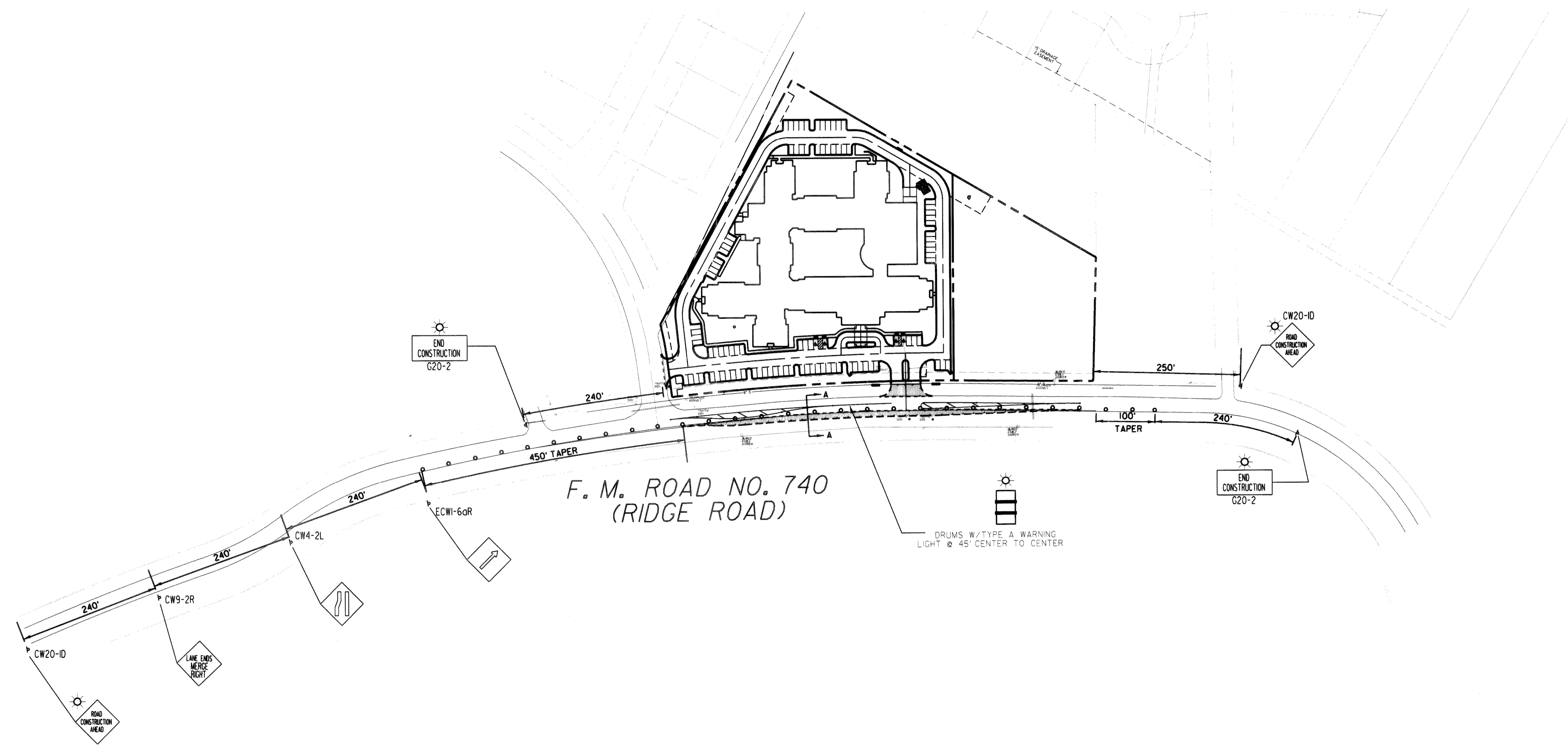

F. M. ROAD NO. 740
(RIDGE ROAD)

NOTES

1. THE CONTRACTOR SHALL PLACE ALL SIGNS AND OTHER TRAFFIC CONTROL DEVICES IN ACCORDANCE WITH THE TEXAS MANUAL ON UNIFORM TRAFFIC CONTROL DEVICES AND THE BARRICADE AND CONSTRUCTION STANDARDS BC(1)-94 THROUGH BC(9)-94 OF THE TEXAS DEPARTMENT OF TRANSPORTATION.
2. LOCATIONS OF SIGNS AND TRAFFIC CONTROL DEVICES AS SHOWN ARE APPROXIMATE AND MAY BE ADJUSTED AS DIRECTED BY THE CITY ENGINEER OR HIS REPRESENTATIVE TO FIT THE CONDITIONS OF THE WORK.
3. THE ENGINEER MAY DIRECT THE CONTRACTOR TO PLACE ADDITIONAL SIGNS AND TRAFFIC CONTROL DEVICES AS NECESSARY TO FIT THE CONDITIONS OF THE WORK. NO ADDITIONAL PAYMENT SHALL BE MADE FOR THESE CHANGES.
4. THE CONTRACTOR SHALL CLEAN AND MAINTAIN ALL SIGNS AND WARNING DEVICES THROUGHOUT CONSTRUCTION AND SHALL REPLACE ANY THAT BECOME DAMAGED OR UNSERVICEABLE AT NO ADDITIONAL COST.

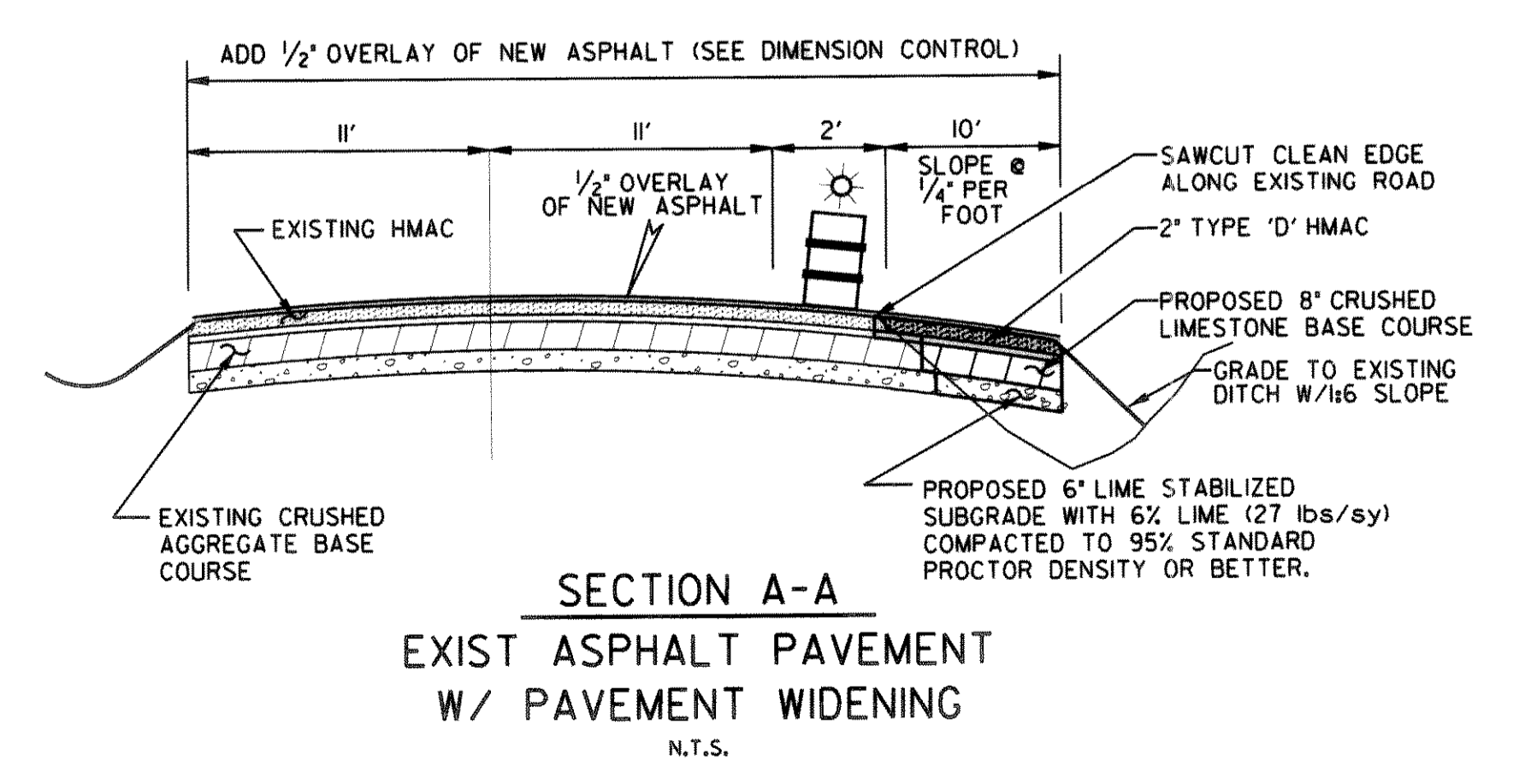

SECTION A-A
EXIST ASPHALT PAVEMENT
W/ PAVEMENT WIDENING
N.T.S.

RECORD DRAWINGS
These drawings have been modified to reflect construction records provided to the Engineer.

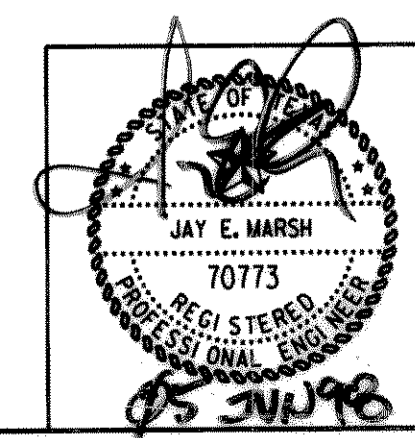

DATE	REVISION	MADE	CKD.	APPD.
Carter & Burgess Carter & Burgess, Inc. 7950 Elmbrook Drive Dallas, Texas 75247-4961 (214) 638-0145 Metro 263-2019 Fax (214) 638-0447				
TRAFFIC CONTROL PLAN				
ROCKWALL ASSISTED LIVING ADDITION				
CONSTRUCTION PLANS				
CITY OF ROCKWALL, ROCKWALL COUNTY, TX				
DESIGN	DRAWN	CHECKED	SCALE	DATE
STEPHEN	BAUM	MARSH	1" = 100'	JUNE 98
FILE	NO.			
01-3110	C6			