

DETAIL "D"
1"=20'

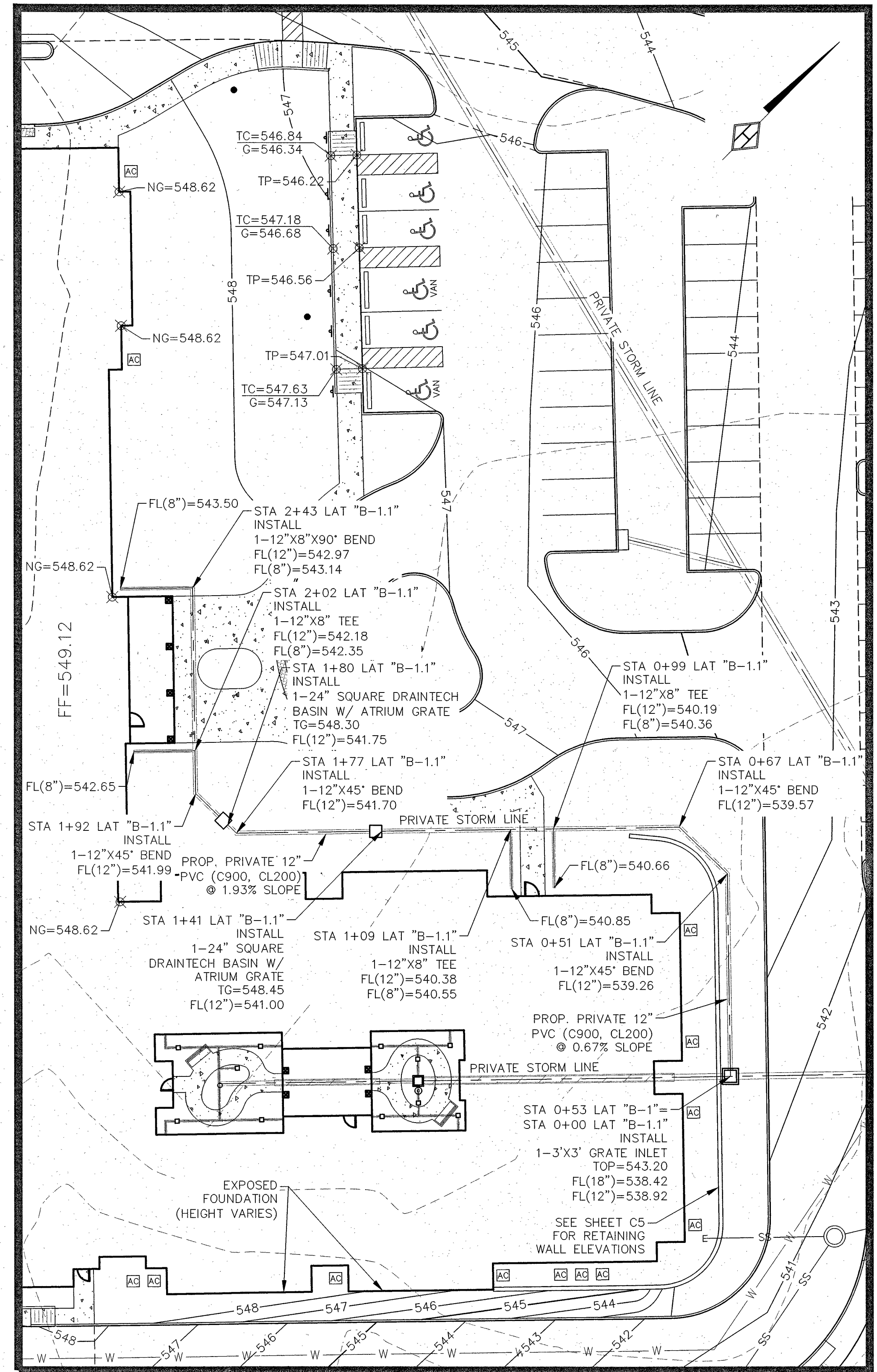

DETAIL "E"
1"=20'

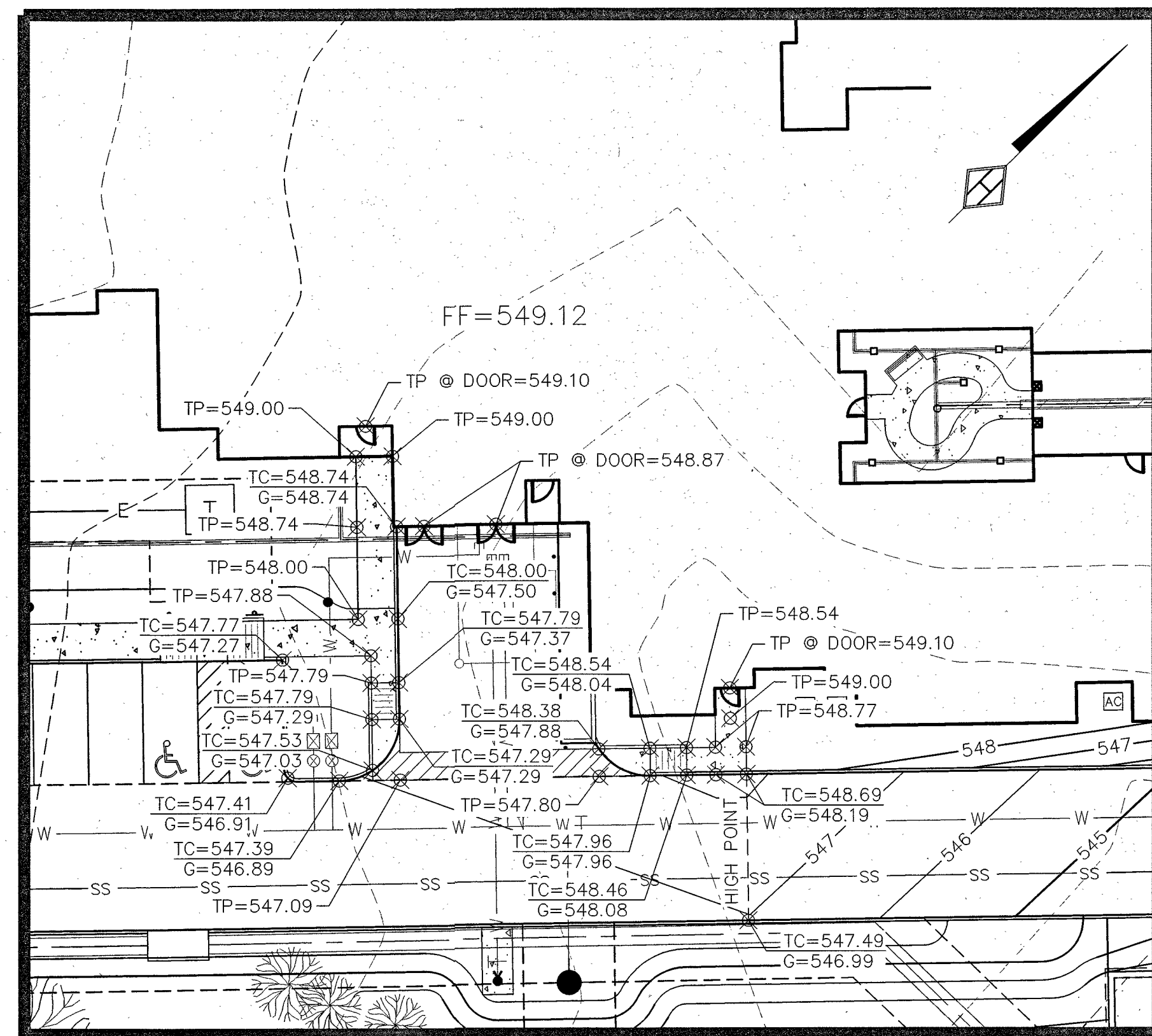

DETAIL "F"
1"=20'

NOTES:

1. CITY OF ROCKWALL CONSTRUCTION STANDARDS & NCTCOG 3RD EDITION APPLY WHETHER INDICATED ON THESE PLANS OR NOT.
2. ALL RESPONSIBILITY FOR ADEQUACY OF DESIGN REMAINS WITH THE DESIGN ENGINEER. THE CITY OF ROCKWALL, IN REVIEWING AND RELEASING PLANS FOR CONSTRUCTION, ASSUMES NO RESPONSIBILITY FOR ADEQUACY OR ACCURACY OF DESIGN.

BENCHMARK INFORMATION

TBM #1 - 1/2" CAPPED IRON ROD LOCATED WITHIN THE MEDIAN NOSE ON THE NORTH SIDE OF RALPH HALL PARKWAY AT FLAGSTONE CREEK BLVD. APPROXIMATELY 50 FEET NORTH OF THE MOST NORTHERLY CORNER OF THE SUBJECT PROPERTY.
ELEVATION = 546.28
ELEVATIONS SHOWN ARE BASED ON THE CITY OF ROCKWALL GIS NETWORK MONUMENT NUMBER R016.
ELEVATION = 558.72

RECORD DRAWING

TO THE BEST OF OUR KNOWLEDGE, HOMEYER ENGINEERING, INC., HEREBY STATES THAT THIS PLAN IS A RECORD DRAWING. THE INFORMATION PROVIDED IS BASED ON ON-SITE SURVEYING, SITE OBSERVATIONS AND INFORMATION PROVIDED BY THE CONTRACTOR.

STEVEN R. HOMEYER, P.E. #86942
DATE: 12-2-13

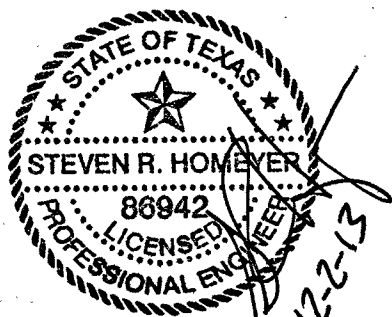

HOMEYER ENGINEERING, INC.
TBM FIRM REGISTRATION NO. F-8440
P.O. BOX 294527, LEWISVILLE, TEXAS 75029
972-906-9985, MOBILE # 972-906-9987 FAX
WWW.HEI.US.COM

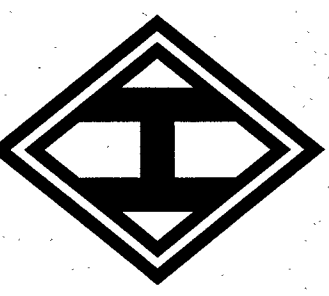

ROCK RIDGE ASSISTED LIVING AND MEMORY CARE
AND MEMORY CARE
LOT 1R, BLOCK A,
FLAGSTONE CORNERS
CITY OF ROCKWALL
ROCKWALL COUNTY, TEXAS

GRADING PLAN AREA DETAILS

REVISIONS:

- 07/05/13 REVISED GRADING IN LOADING AREA FOR PROPOSED ACCESSIBLE ROUTE (ADDED DETAIL F)
- REMOVED SIDEWALK ON NORTHEAST CORNER OF BLDG AND REVISED GRADING
- 12/02/13 REVISED GRADING FOR LEAD SIDEWALK CONNECTION TO PUBLIC SIDEWALK PER CONTRACTOR (DETAIL "D")

DRAWN: SRH
DATE: 11/27/12
HEI #: 12-112
SHEET NO: C5.1