

# CONSTRUCTION PLANS FOR RIDGEVIEW CHURCH CLASSROOM ADDITION

**NOTES:**

1. All utilities may not be shown on the plans. Location of existing utilities depicted on the plans are approximate. It shall be the contractor's responsibility to verify all utility locations prior to construction. Utilities damaged by the contractor during construction shall be repaired at the contractor's expense.
2. Call 1-800-344-8377 (Dig-Tess) or other utility locating services 48 hours prior to construction activity. Di Scullo-Terry, Stanton Inc. & Associates is not responsible for knowing all existing utilities or depicting exact locations on all drawings.
3. Di Scullo-Terry, Stanton & Associates, Inc. is not responsible for jobsite safety and construction means and methods. Those are the sole responsibility of the construction contractors.

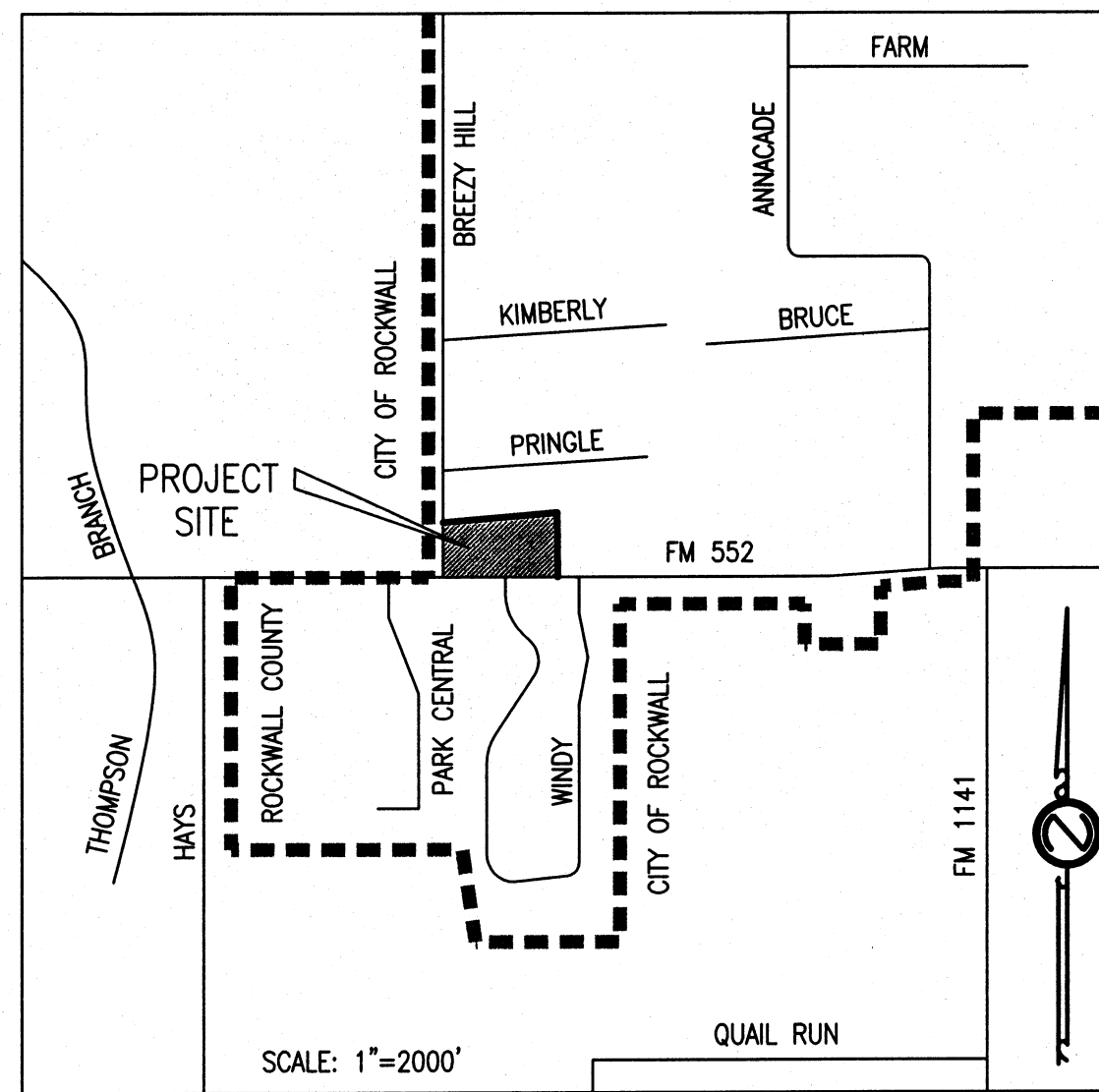

VICINITY MAP

**LOT 22R**  
**SKYVIEW COUNTRY ESTATES No. 3**

**1362 EAST F.M. 552**  
**ROCKWALL COUNTY, TEXAS**

SHEET INDEX		
NO.	DESCRIPTION	LAST UPDATE
1	COVER SHEET	8-2-12
1A	FINAL PLAT	7-18-12
2	TOPOGRAPHIC SURVEY	7-31-12
3	DEMOLITION PLAN	7-31-12
4	DIMENSION CONTROL PLAN	7-31-12
4A	TXDOT-DIMENSION CONTROL PLAN	7-31-12
5	WATER & SANITARY SEWER PLAN	8-7-12
5A	TXDOT-SANITARY SEWER SVC P&P	7-31-12
6	PAVING PLAN	7-31-12
6A	TXDOT-DRIVEWAY PLAN & CROSS SECTION	8-2-12
7	DRAINAGE AREA MAP & CALCULATIONS	7-31-12
8	GRADING PLAN	8-2-12
9	CHANNEL PLAN & PROFILE	7-31-12
10	EROSION CONTROL PLAN	7-31-12
* 10A-C	TXDOT DETAIL-TEMPORARY EROSION, SEDIMENT & WATER POLLUTION CONTROL MEASURES [EC(1)-93]	7-31-12
11	EROSION CONTROL DETAILS (iSWM)	7-31-12
12	EROSION CONTROL DETAILS (iSWM)	7-31-12
13	PAVING DETAILS	7-31-12
14	WATER AND SANITARY SEWER DETAILS	7-31-12
15	WATER AND SANITARY SEWER DETAILS	7-31-12
16	CULVERT PLAN AND PROFILE	7-31-12
* 17	TXDOT DETAIL-SAFETY END TREATMENT (SETP-PD)	7-31-12
* 18	TXDOT DETAIL-TRAFFIC CONTROL PLAN ONE LANE TWO-WAY TRAFFIC CONTROL [TCP (1-2)-12]	7-31-12

**GENERAL NOTES**

1. THE CONTRACTORS SHALL COORDINATE CONSTRUCTION OF THIS PROJECT WITH THE CITY OF ROCKWALL. NOTIFICATION SHALL BE MADE AT LEAST 48 HOURS PRIOR TO BEGINNING CONSTRUCTION SO THAT AN INSPECTOR MAY BE ASSIGNED TO THIS PROJECT.
2. ALL DIMENSIONS ARE TO THE BACK OF CURB, FACE OF BUILDING, OR EDGE OF SIDEWALK UNLESS OTHERWISE STATED ON THE PLAN.
3. THE CONTRACTOR SHALL PROVIDE CONSTRUCTION STAKING.
4. THE CONTRACTOR SHALL NOT ENTER OR STORE EQUIPMENT ON ADJACENT PROPERTIES.
5. ALL PUBLIC CONSTRUCTION MATERIALS SHALL BE IN ACCORDANCE WITH THE CURRENT CITY OF ROCKWALL STANDARD SPECIFICATIONS AND DETAILS OR TXDOT DETAILS IF IN TXDOT RIGHT OF WAY.
6. ALL NON-PUBLIC CONSTRUCTION SHALL BE IN ACCORDANCE WITH THE NORTH CENTRAL TEXAS COUNCIL OF GOVERNMENT STANDARD SPECIFICATIONS.
7. RETESTING SHALL BE PERFORMED AT THE CONTRACTORS EXPENSE, AND ANY DEFICIENCIES SHALL BE CORRECTED AT THE CONTRACTORS EXPENSE.
8. REFER TO LANDSCAPE DRAWINGS FOR HARDSCAPE, PLANTING FINE GRADING AND SOILS PREPARATION.
9. REFER TO GEOTECHNICAL REPORT FOR INFORMATION REGARDING GRADING, BEARING VALUES,
10. VERIFY THAT ALL CLEARANCES AND GRADES ON SITE COMPLY WITH REQUIREMENTS FOR HANDICAP ACCESS AS SHOWN ON ALL ARCHITECTURAL AND CIVIL PLANS PRIOR TO CONSTRUCTION.
11. ALL UNDERGROUND UTILITIES MAY NOT BE SHOWN ON THE PLANS. LOCATIONS OF EXISTING UTILITIES DEPICTED ON THE PLANS ARE APPROXIMATE. THE CONTRACTOR SHALL DETERMINE THE EXACT LOCATION OF ALL EXISTING UTILITIES BEFORE COMMENCING WORK AND AGREES TO BE FULLY RESPONSIBLE FOR ANY AND ALL DAMAGES WHICH MIGHT BE OCCASIONED BY THE CONTRACTORS FAILURE TO EXACTLY LOCATE AND PRESERVE ANY AND ALL UNDERGROUND UTILITIES.

**RECORD DOCUMENT**

This Record Document (As Built) has been prepared based on information provided by others. The Engineer has not verified the accuracy and/or completeness of this information and shall not be responsible for any errors or omissions which may be incorporated herein as a result.

**OWNER**

RIDGEVIEW BAPTIST CHURCH  
1362 EAST F.M. 552  
ROCKWALL COUNTY, TEXAS  
PHONE: 972-771-2661

**BENCH MARK:**

BM No. 1 (Set): North rim of sanitary sewer manhole located on north side of FM Road 552, approximately 220 feet west of drive entrance to Ridgeview Church and approximately 95 feet north of west intersection of Windy Lane.

ELEVATION: 533.11

**CONSULTING ENGINEER**



DI SCIULLO-TERRY, STANTON & ASSOCIATES, INC.  
401-A WEST ABRAM STREET  
ARLINGTON, TEXAS 76010  
PHONE: 817-275-3361 FAX: 817-275-3361  
CONTACT EMAIL: jstanton@dferry.com  
FIRM No. 615

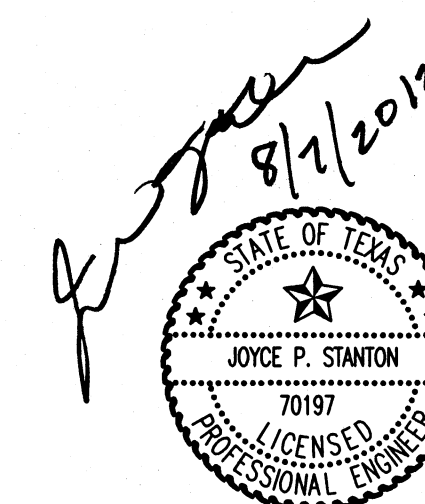

ALL CONSTRUCTION WITHIN THE STATE RIGHT OF WAY WILL REQUIRE COMPLIANCE TO TXDOT STANDARD SPECIFICATIONS, STANDARD PLANS AND TEXAS MANUAL ON UNIFORM TRAFFIC CONTROL DEVICES.

SPECIFICATIONS ADOPTED BY THE TEXAS DEPARTMENT OF TRANSPORTATION, JUNE 1, 2004 AND SPECIFICATION ITEMS LISTED AS FOLLOWS SHALL GOVERN ON THIS PROJECT FOR ALL WORK WITHIN THE STATE RIGHT OF WAY.

\* THE STANDARD SHEETS, SPECIFICALLY IDENTIFIED IN THIS INDEX OF SHEETS, HAVE BEEN SELECTED BY ME OR UNDER MY RESPONSIBLE SUPERVISION AS BEING APPLICABLE TO THIS PROJECT.

BY SEALING AND SIGNING THESE PERMIT PLANS AS A PROFESSIONAL CIVIL ENGINEER LICENSED TO PRACTICE IN THE STATE OF TEXAS, I CERTIFY THAT THE PROPOSED DRIVEWAY OR PUBLIC STREET CONNECTION(S) TO THE STATE ROADWAY MEETS OR EXCEEDS THE MINIMUM STOPPING SIGHT DISTANCE REQUIRED FOR A DESIGN SPEED OF 45 MILES PER HOUR, BASED ON THE MOST RECENT TXDOT DESIGN MANUAL REQUIREMENTS.