

MEDICAL OFFICES DEVELOPMENT

1.46 ACRES PORTION OF
LOT 2, BLOCK "A" ROCKWALL ASSISTED LIVING ADDITION
CITY OF ROCKWALL, ROCKWALL COUNTY, TX

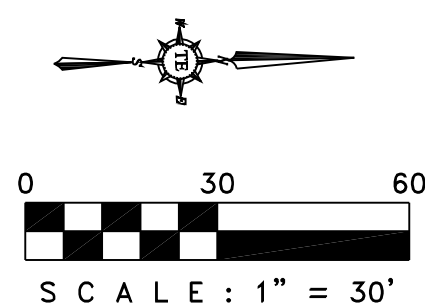

GENERAL NOTES - STORM DRAINAGE IMPROVEMENTS

1. ALL PUBLIC STORM SEWER AND CULVERT PIPE AND FITTINGS SHALL BE ASTM C76, CLASS III REINFORCED CONCRETE PIPE (RCP), INSTALLED WITH COMPRESSIVE TYPE JOINTS.
2. ALL PRIVATE STORM SEWER SHALL BE "N-12 HIGH PERFORMANCE PIPE" MANUFACTURED BY ADVANCE DRAINAGE SYSTEM (ADS).
3. AFTER COMPLETION OF ALL STORM SEWER INSTALLATION, THE CONTRACTOR SHALL PERFORM A TELEVISION INSPECTION AND PROVIDE A VIDEOTAPE TO THE PUBLIC WORKS DEPARTMENT.
4. STORM SEWER PIPES LARGER THAN 36" MUST BE WIPED WITH NON-SHRINK GROUT AFTER INSPECTION AND APPROVAL.

NOTE

1. VERIFY ROOF DRAIN/DOWN SPOUT LOCATION WITH ARCHITECTURAL PLANS.
2. ALL ROOF DRAINS TO CONNECT STORM SEWER SYSTEM.
3. POSITIVE DRAINAGE SHALL BE ALLOWED AROUND THE BUILDING FOUNDATION TO PREVENT WATER GOING TO BUILDING.

BENCHMARKS

TOP OF THE STORM DRAIN MAN HOLE LOCATED AT SOUTH EAST PROPERTY CORNER.
ELEVATION: 557.70'

NOTE

1. DETENTION SYSTEM TO BE IN AND FULLY FUNCTIONING PRIOR TO ANY PAVING BEING INSTALLED INCLUDING SLAB.
2. ALL PRIVATE SYSTEM MAINTAINED BY PROPERTY OWNER.

DRAINAGE LEGEND

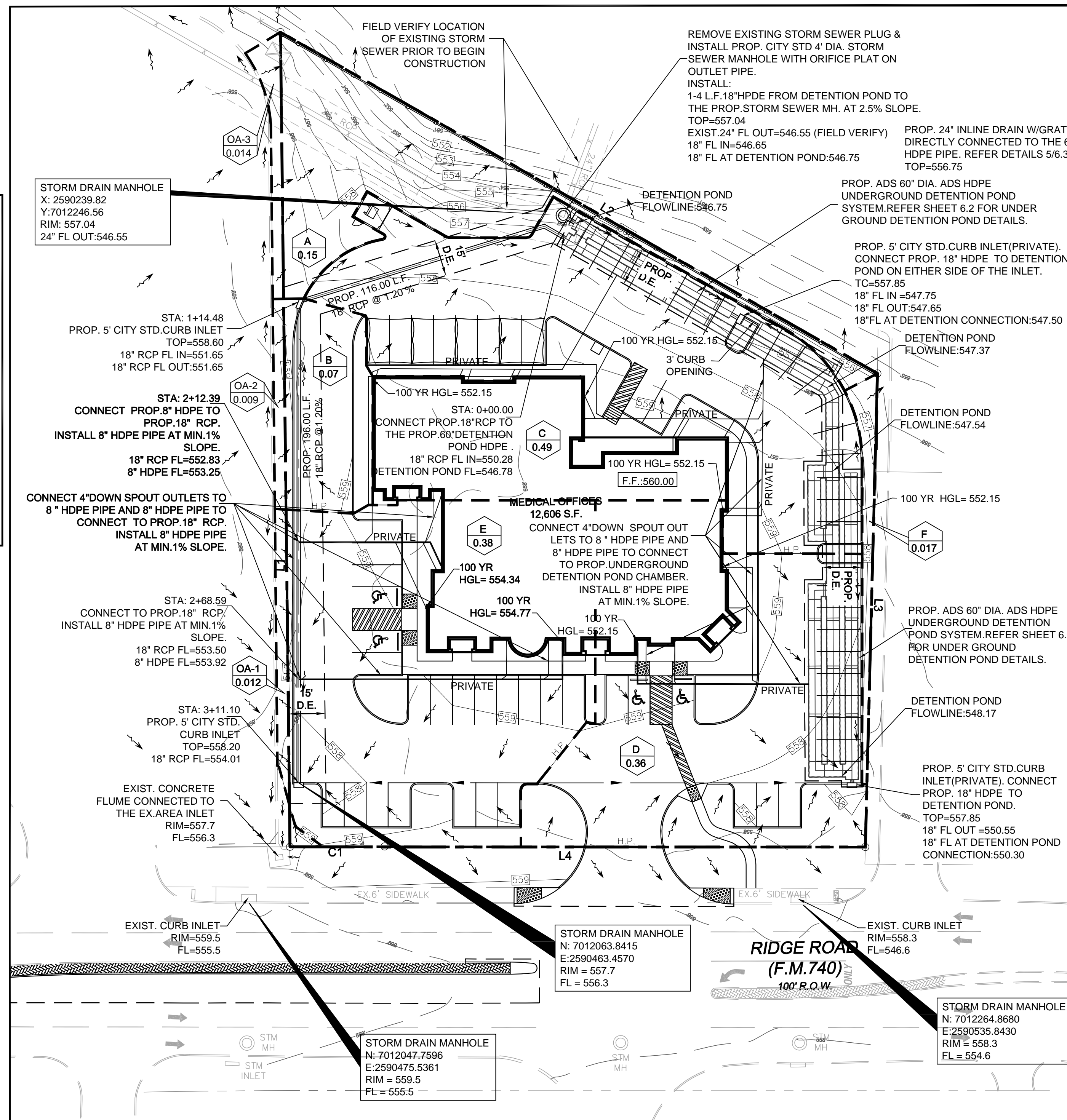
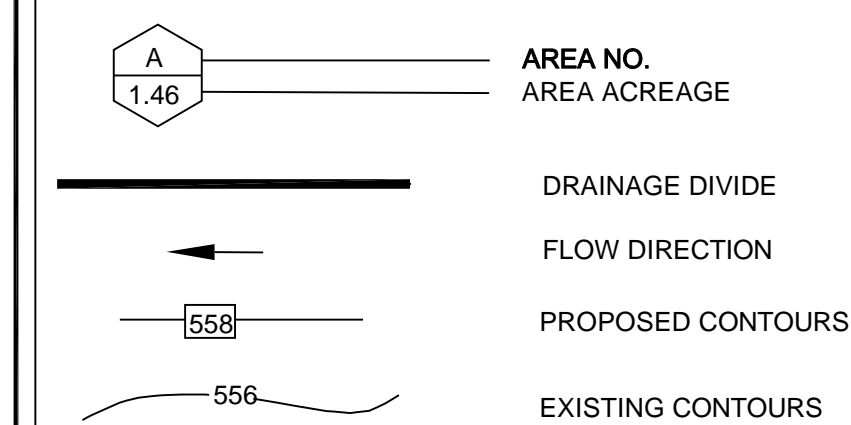

PRE-DEVELOPED DRAINAGE CALCULATIONS (100yr FLOW)

Drainage Area	C	Tc (min)	A (acres)	I-100 (in/hr)	Q-100yr (cfs)
ENTIRE SITE	0.35	20	1.46	8.30	4.24
OFFSITE	0.35	20	0.035	8.30	0.10

DEVELOPED DRAINAGE CALCULATIONS (100yr FLOW)

Drainage Area	C	Tc (min)	A (acres)	I-100 (in/hr)	Q-100yr (cfs)	Remark
A	0.90	10	0.15	9.80	1.32	BY PASS RUNOFF
B	0.90	10	0.07	9.80	0.62	DRAIN TO DETENTION POND
C	0.90	10	0.49	9.80	4.32	DRAIN TO DETENTION POND
D	0.90	10	0.36	9.80	3.18	DRAIN TO DETENTION POND
E	0.90	10	0.38	9.80	3.35	DRAIN TO DETENTION POND
F	0.90	10	0.017	9.80	0.18	BY PASS RUNOFF
OA-1	0.90	10	0.012	9.80	0.11	DRAIN TO DETENTION POND
OA-2	0.90	10	0.009	9.80	0.08	DRAIN TO DETENTION POND
OA-3	0.90	10	0.014	9.80	0.12	BY PASS RUNOFF

DEVELOPED DRAINAGE CALCULATIONS (50yr FLOW)

Drainage Area	C	Tc (min)	A (acres)	I-50 (in/hr)	Q-50yr (cfs)	Remark
A	0.90	10	0.15	9.00	1.22	BY PASS RUNOFF
B	0.90	10	0.07	9.00	0.57	DRAIN TO DETENTION POND
C	0.90	10	0.49	9.00	3.97	DRAIN TO DETENTION POND
D	0.90	10	0.36	9.00	2.92	DRAIN TO DETENTION POND
E	0.90	10	0.38	9.00	3.08	DRAIN TO DETENTION POND
F	0.90	10	0.017	9.00	0.14	BY PASS RUNOFF
OA-1	0.90	10	0.012	9.00	0.10	DRAIN TO DETENTION POND
OA-2	0.90	10	0.009	9.00	0.07	DRAIN TO DETENTION POND
OA-3	0.90	10	0.014	9.00	0.11	BY PASS RUNOFF

DEVELOPED DRAINAGE CALCULATIONS (25yr FLOW)

Drainage Area	C	Tc (min)	A (acres)	I-25 (in/hr)	Q-25yr (cfs)	Remark
A	0.90	10	0.15	8.30	1.13	BY PASS RUNOFF
B	0.90	10	0.07	8.30	0.52	DRAIN TO DETENTION POND
C	0.90	10	0.49	8.30	3.66	DRAIN TO DETENTION POND
D	0.90	10	0.36	8.30	2.69	DRAIN TO DETENTION POND
E	0.90	10	0.38	8.30	2.84	DRAIN TO DETENTION POND
F	0.90	10	0.017	8.30	0.13	BY PASS RUNOFF
OA-1	0.90	10	0.012	8.30	0.09	DRAIN TO DETENTION POND
OA-2	0.90	10	0.009	8.30	0.067	DRAIN TO DETENTION POND
OA-3	0.90	10	0.014	8.30	0.11	BY PASS RUNOFF

DEVELOPED DRAINAGE CALCULATIONS (5yr FLOW)

Drainage Area	C	Tc (min)	A (acres)	I-5 (in/hr)	Q-5yr (cfs)	Remark
A	0.90	10	0.15	6.30	0.85	BY PASS RUNOFF
B	0.90	10	0.07	6.30	0.40	DRAIN TO DETENTION POND
C	0.90	10	0.49	6.30	2.78	DRAIN TO DETENTION POND
D	0.90	10	0.36	6.30	2.04	DRAIN TO DETENTION POND
E	0.90	10	0.38	6.30	2.16	DRAIN TO DETENTION POND
F	0.90	10	0.017	6.30	0.10	BY PASS RUNOFF
OA-1	0.90	10	0.012	6.30	0.07	DRAIN TO DETENTION POND
OA-2	0.90	10	0.009	6.30	0.05	DRAIN TO DETENTION POND
OA-3	0.90	10	0.014	6.30	0.08	BY PASS RUNOFF

"ALL RESPONSIBILITY FOR ADEQUACY OF DESIGN REMAINS WITH THE DESIGN ENGINEER. THE CITY OF ROCKWALL, IN REVIEWING AND RELEASING PLANS FOR CONSTRUCTION, ASSUMES NO RESPONSIBILITY FOR ADEQUACY OR ACCURACY OF DESIGN."

ASBUILT DRAWINGS:
TO THE BEST OF OUR KNOWLEDGE TRIANGLE ENGINEERING LLC, HEREBY STATES THAT THIS PLAN IS ASBUILT. THE INFORMATION PROVIDED IS BASED ON SURVEYING AT THE SITE AND INFORMATION PROVIDED BY THE CONTRACTOR.

KARTAVYA S. PATEL P.E. NO. 97534

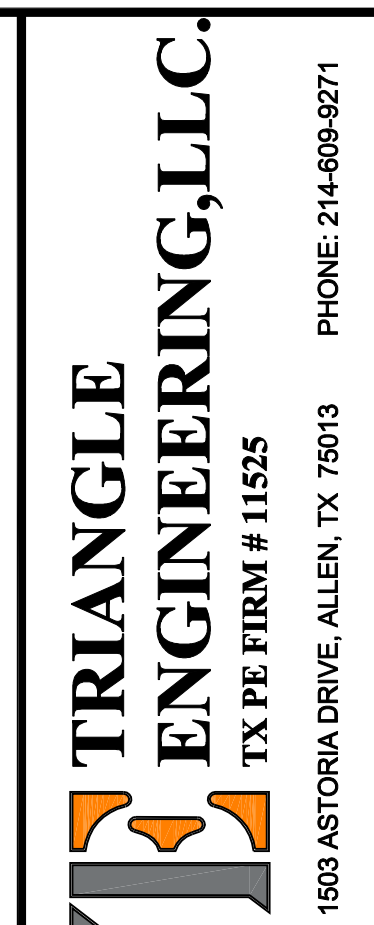

BY	DATE	DESCRIPTION
KP	06/25/2015	FINAL ASBUILT SUBMITTAL

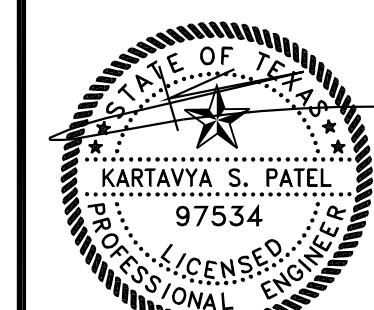

06/25/2015

MEDICAL OFFICE
3018 RIDGE ROAD
ROCKWALL, TEXAS

DRAINAGE PLAN	
PROJECT No:	13-035
DATE:	06/25/2015
DRAWN BY:	KP
CHECKED BY:	KP

SHEET #

REVISION #

6