

MEDICAL OFFICES DEVELOPMENT

1.46 ACRES PORTION OF
LOT 2, BLOCK "A" ROCKWALL ASSISTED LIVING ADDITION
CITY OF ROCKWALL, ROCKWALL COUNTY, TX

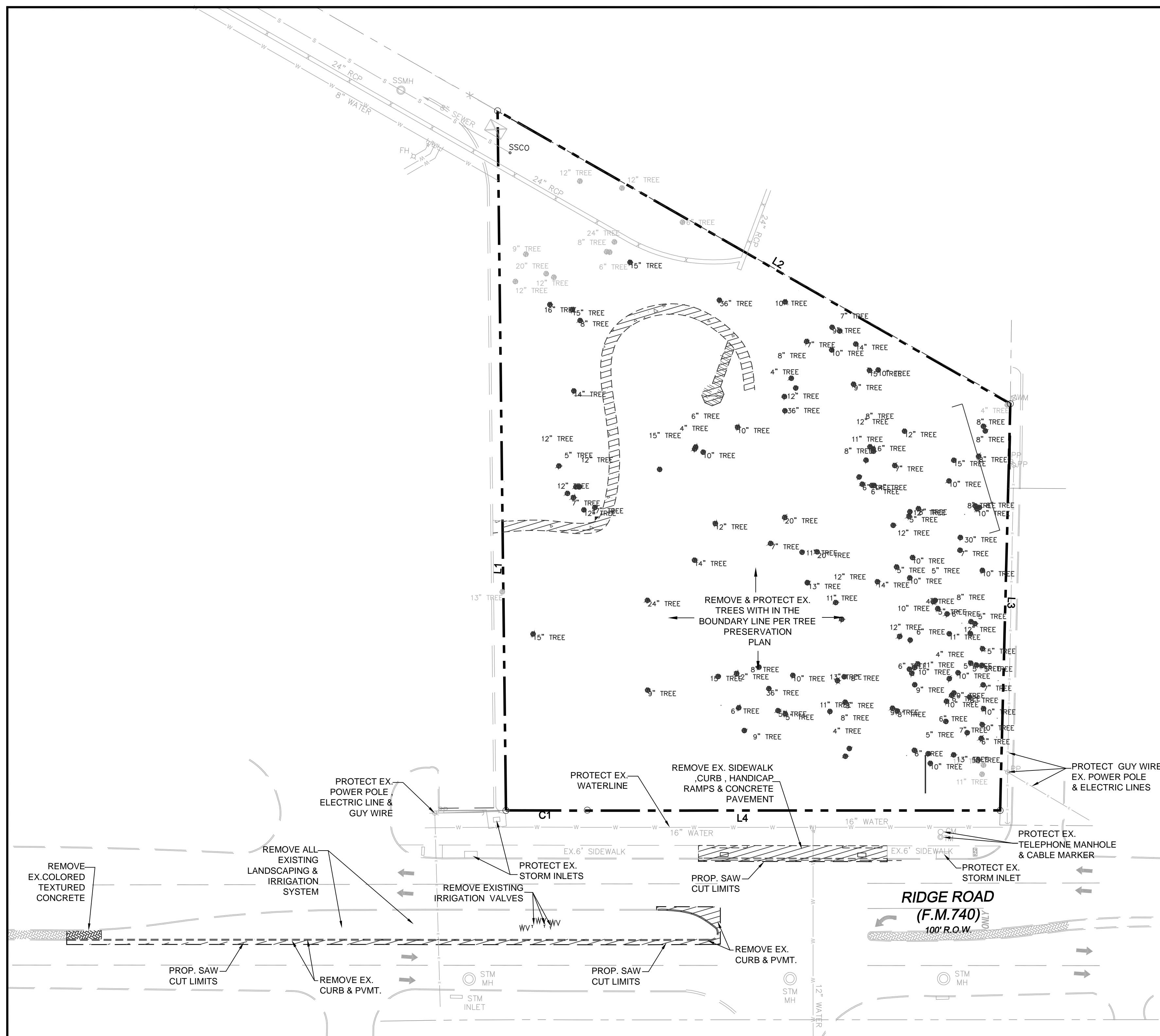
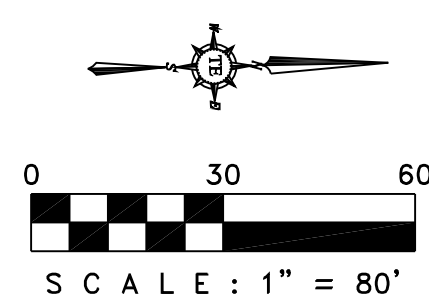

NOTE:

- FM 740 PAVING, CURB, SIDEWALK RAMPS & MEDIAN SHALL NOT BE DEMOLISHED UNTIL CONSTRUCTION ON THE PROPOSED DRIVEWAY AND TURN LANE IS TO BEGIN.

DEMOLITION GENERAL NOTES

- CONSTRUCTION SHALL PROCEED IN THE FOLLOWING MANNER:
1. INITIAL SITE STRIPPING, DEMOLITION AND HAUL DEBRIS OFFSITE.
 2. INSTALL STABILIZED CONSTRUCTION ENTRANCES.
 3. PREPARE TEMPORARY PARKING AND STORAGE AREA.
 4. CONSTRUCT THE SILT FENCES ON THE SITE.
 5. BEGIN GRADING THE SITE.
 6. INSTALL/CONSTRUCT MAJOR DRAINAGE SYSTEM.
 7. INSTALL UTILITIES, UNDER DRAINS, CURBS, AND GUTTERS.
 8. START CONSTRUCTION OF BUILDING PADS AND STRUCTURES.
 9. TEMPORARILY SEED DENUDEED AREAS.
 10. PREPARE SITE FOR PAVING.
 11. PAVE SITE.
 12. COMPLETE GRADING AND INSTALL PERMANENT SEEDING AND PLANTING.
 15. REMOVE ALL TEMPORARY EROSION AND SEDIMENT CONTROL DEVICES (ONLY IF SITE IS STABILIZED). THIS SITE IS STABILIZED WHEN ALL SOIL-DISTURBING ACTIVITIES ARE COMPLETED AND UNIFORM PERENNIAL VEGETATIVE COVER WITH A DENSITY OF 70% OF THE COVER FOR UNPAVED AREAS AND AREAS NOT COVERED BY PERMANENT STRUCTURES HAVE BEEN EMPLOYED.

NOTE: EROSION CONTROL BMP'S SHALL BE IN PLACE PRIOR TO COMMENCEMENT OF ANY CONSTRUCTION ACTIVITIES INCLUDING DEMOLITION.

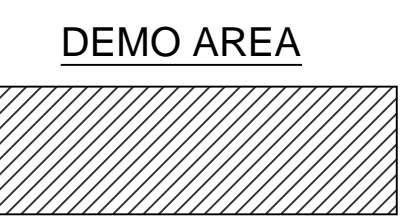

ASBUILT DRAWINGS:
TO THE BEST OF OUR KNOWLEDGE TRIANGLE ENGINEERING LLC., HEREBY STATES THAT THIS PLAN IS ASBUILT. THE INFORMATION PROVIDED IS BASED ON SURVEYING AT THE SITE AND INFORMATION PROVIDED BY THE CONTRACTOR.

KARTAVYA S. PATEL P.E. NO. 97534

TRIANGLE ENGINEERING, LLC.
TX PE FIRM # 11525
1509 ASTORIA DRIVE, ALLEN, TX 75013
PHONE: 214-609-9271

No.	DATE	DESCRIPTION
1	05/25/2015	FINAL ASBUILT SUBMITTAL

06/25/2015

MEDICAL OFFICE
3018 RIDGE ROAD
ROCKWALL, TEXAS

PROJECT No:	DATE:	DRAWN BY:	CHECKED BY:
13-035	06/25/2015	KP	KP

SHEET #	REVISION #
DM	