

VICINITY MAP
N.T.S.

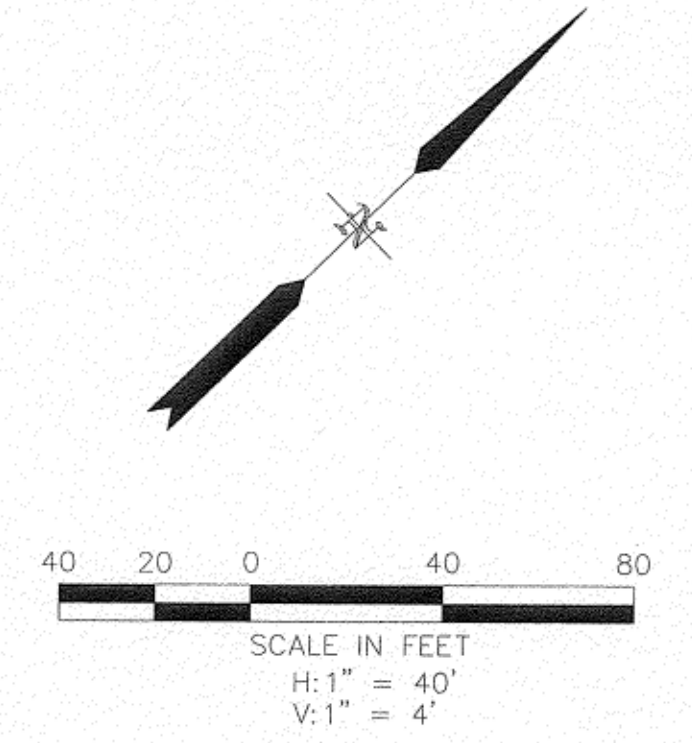

WTR LN W-1

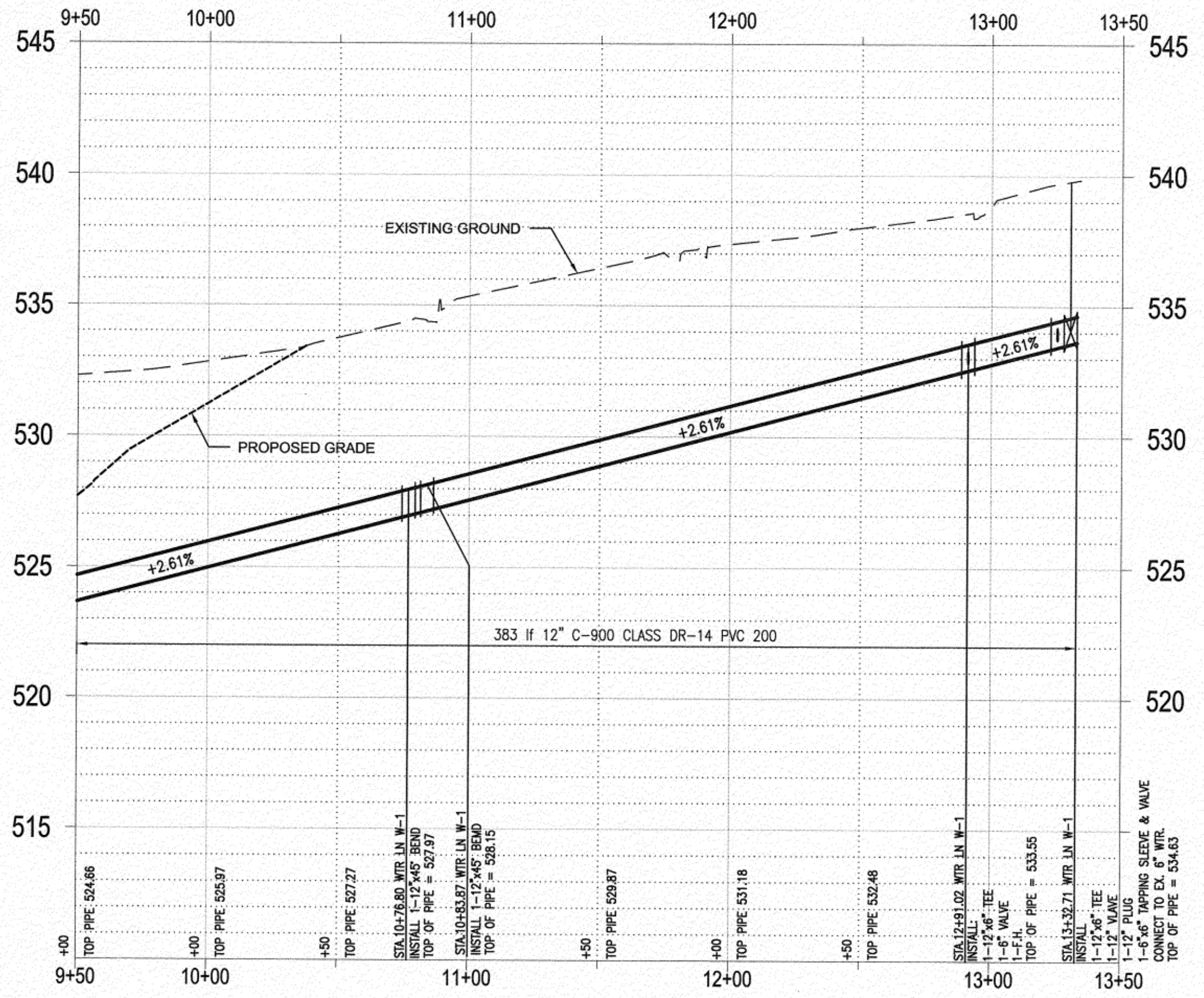

LEGEND	
1/2" I.R.S. W/CAP	1/2" IRON ROD SET WITH YELLOW CAP STAMPED "RPLS 3963"
I.R.F.	IRON ROD FOUND
GW	GUY WIRE
PP	POWER POLE
LP	LIGHT POLE
EM	ELECTRIC METER
ICV	IRRIGATION CONTROL VALVE
B	BOLLARD
WM	WATER METER
SSMH	SANITARY SEWER MANHOLE
TPED	TELEPHONE PEDESTAL
XFR	ELECTRIC TRANSFORMER
MB	MAILBOX
WV	WATER VALVE
EBX	ELECTRIC BOX
FOM	FIBER OPTIC CABLE MARKER
A/C	AIR CONDITIONER UNIT
ES	ELECTRIC SWITCH
HW	HEADWALL
TS	TRAFFIC SIGN
WF	WATER FAUCET
FH	FIRE HYDRANT
FOV	FIBER OPTIC VAULT
CMP	CORRUGATED METAL PIPE
PVC	POLYVINYL CHLORIDE PIPE
RCP	REINFORCED CONCRETE PIPE
P.R.R.C.T.	PLAT RECORDS ROCKWALL COUNTY TEXAS
D.R.R.C.T.	DEEDS RECORDS ROCKWALL COUNTY TEXAS
—	EDGE OF ASPHALT
—x—	WIRE FENCE
—E—	OVERHEAD ELECTRIC LINE

RECORD DRAWINGS

To the best of our knowledge Engineering Concepts & Design, L.P., hereby states that this plan is As-Built. This information provided is based on surveying at the site and information provided by the contractor.

Todd Winters 7.14.14
TODD WINTERS DATE

BENCHMARK:
"X" CUT IN CURB 23'± SOUTH OF EAST DRIVE APPROACH OF EXISTING RAYBURN COUNTRY ELECTRIC BUILDING.

ENGINEERINGCONCEPTS & DESIGN, L.P.

ENGINEERING / PROJECT MANAGEMENT / CONSTRUCTION SERVICES - FIRM REG. #F-001145
201 WINDCO CIR, STE 200, WYLIE, TX 75098
972-941-8400 FAX: 972-941-8401 WWW.ECDLP.COM

REVISIONS:	
Δ	4-24-14 REVISED W-1 ALIGNMENT
DRAWN:	JIM DATE: APRIL, 2014
CHECKED:	TW DATE:
PROJECT NO.:	3551
DWG FILE NAME:	

THIS DOCUMENT IS RELEASED FOR THE PURPOSE OF CONSTRUCTION.



PLAN & PROFILE
(OFFSITE WATER LINE W-1)

RAYBURN COUNTRY ADDITION
(LOT 2)

CITY OF ROCKWALL,
ROCKWALL COUNTY, TEXAS

SHEET
4
OF
14