

1
17 DUMPSTER ENCLOSURE PLAN
N.T.S.

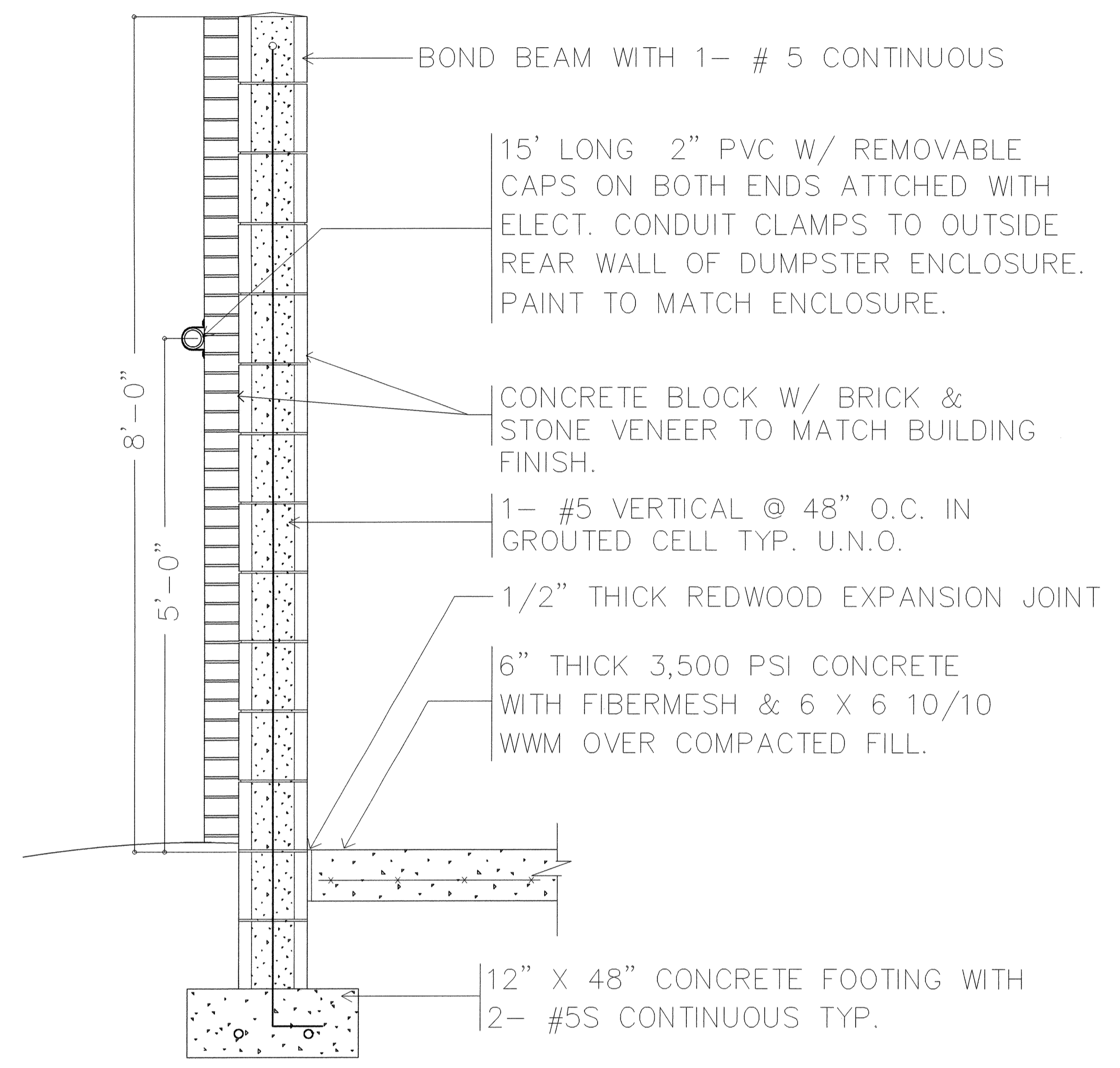

2
17 DUMPSTER WALL SECTION A-A
N.T.S.

ALL RESPONSIBILITY FOR ADEQUACY OF DESIGN REMAINS WITH THE DESIGN ENGINEER. THE CITY OF ROCKWALL, IN REVIEWING AND RELEASING PLANS FOR CONSTRUCTION, ASSUMES NO RESPONSIBILITY FOR ADEQUACY OR ACCURACY OF DESIGN.

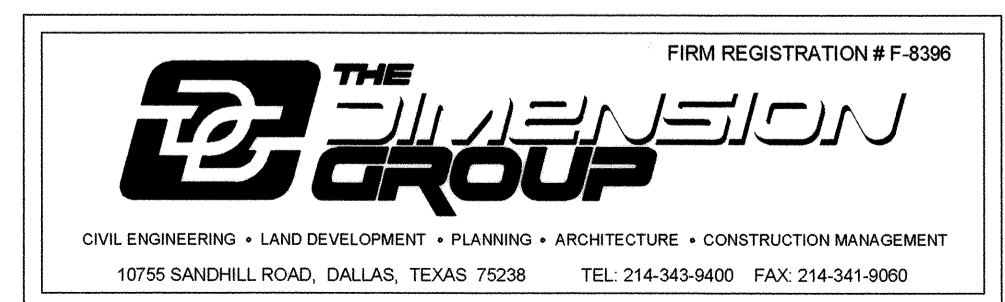

AS-BUILT

DATE	4/18/17
BY	KP
REVISIONS	
NO.	1
AS-BUILT	
THESE PLANS ARE SUBJECT TO FEDERAL COPYRIGHT LAWS. ANY USE OF SAME WITHOUT THE EXPRESSED WRITTEN PERMISSION OF RACETRAC PETROLEUM, INC. IS PROHIBITED. © 200 RACETRAC PETROLEUM, INC.	
Racetrac RACETRAC PETROLEUM, INC. 300 TECHNOLOGY COURT SMYRNA, GEORGIA 30082 (770) 431-7600	
DUMPSTER ENCLOSURE	
RACETRAC SERVICE STATION	
SITE	S.H. 205 & S.H. 276 ROCKWALL, TEXAS
SCALE	AS SHOWN
DATE	5/18/10
DRAWN BY	CS
DWG NO.	17
17	
SHEET NO.	REV.