

# STATE HIGHWAY 276

(120' RIGHT-OF-WAY)

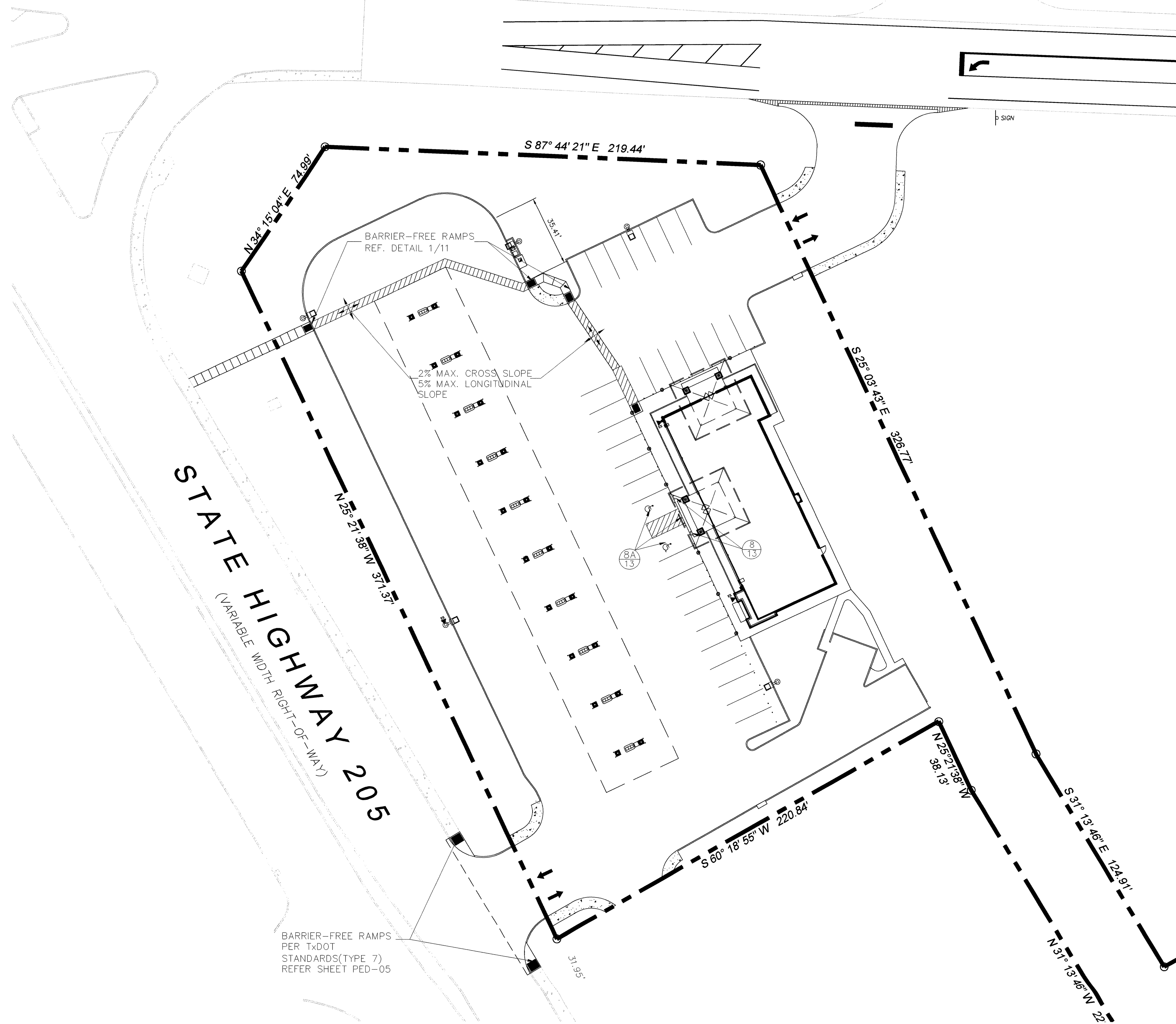

### CONSTRUCTION NOTES:

1. MAXIMUM SLOPE OF CURB RAMP SHALL BE 1:12 (8.33%) - 5% RECOMMENDED.
2. MAXIMUM SLOPE OF THE CURB RAMP'S "FLARED SIDES" SHALL BE (8.33% MAX).
3. SLOPE AND CROSS-SLOPE OF A SIDEWALK LEADING INTO A CURB RAMP'S SYSTEM SHALL BE A MAXIMUM OF 1:50 (2%).
4. MAXIMUM SLOPE OF A HANDICAPPED ACCESSIBLE ROUTE ALONG A SIDEWALK LEADING INTO A CURB RAMP, BEFORE IT MUST BE CONSIDERED A RAMP IS 1:20 (5%).
5. ALL SLOPED SURFACES AT CURB RAMP SYSTEMS MUST HAVE A "SIGNIFICANT COLOR CONTRAST" FOR THE SEEING IMPAIRED. THEREFORE ALL SUCH SLOPES MUST HAVE "INTEGRAL COLOR IN CONCRETE" OR "STAINED" CONCRETE COMPARED TO THE ADJACENT "FLAT" SIDEWALK/PAVING SURFACE.
6. MAXIMUM SLOPE AND CROSS-SLOPE OF HANDICAPPED ACCESSIBLE PARKING SPACE & ADJACENT ACCESS AISLE IS 1:50 (2%) IN ANY DIRECTION.

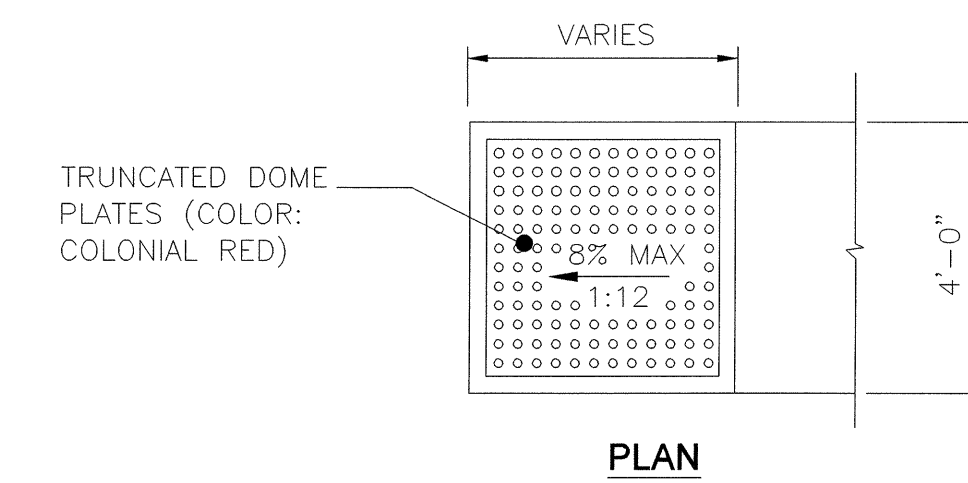
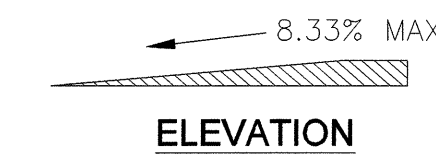

1 STANDARD ADA RAMP  
11 NTS

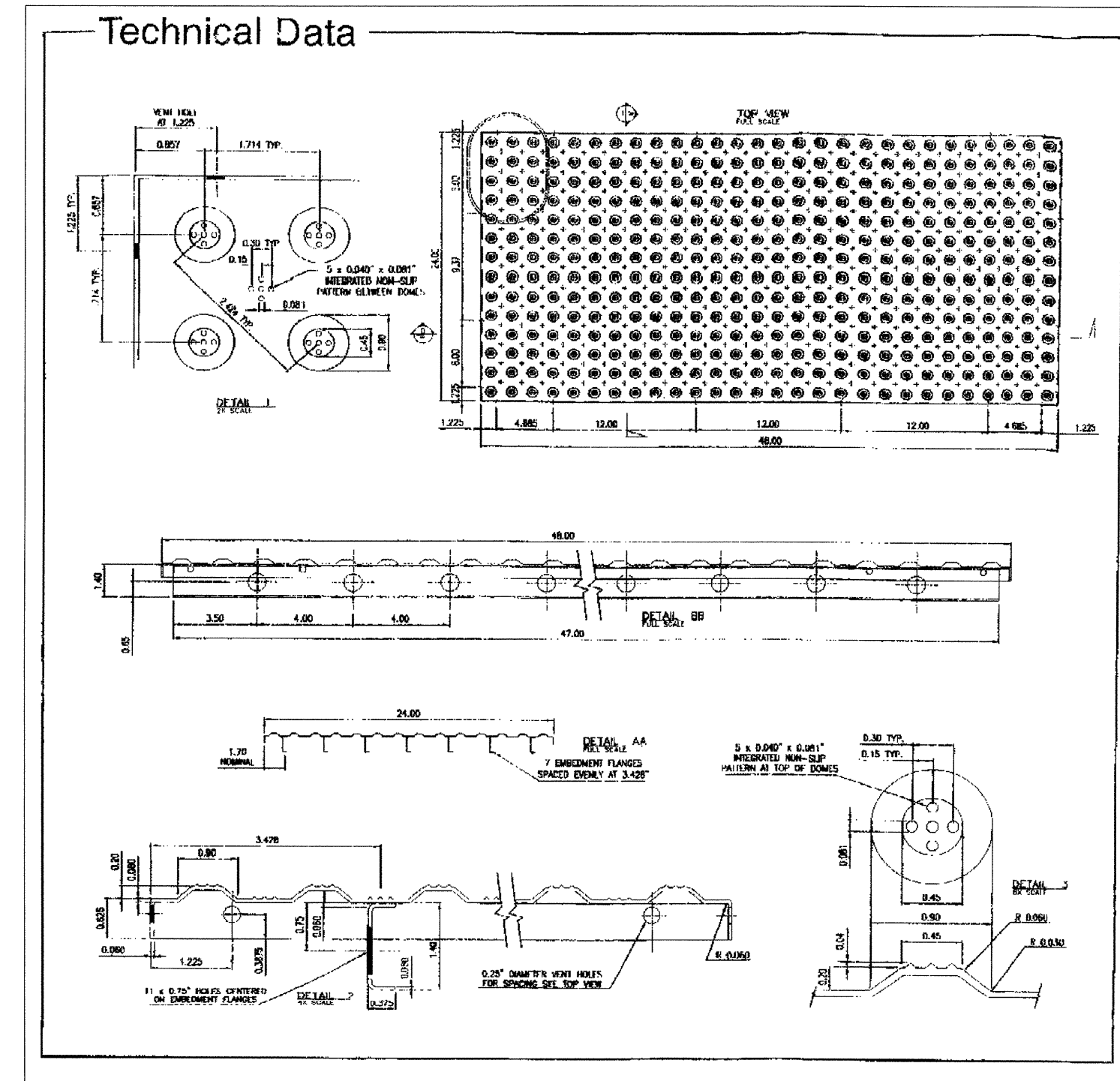

METAL PLATE DETAIL  
NTS

AS-BUILT

NO.	DATE	BY	REVISIONS
1	4/18/11	MP	AS-BUILT

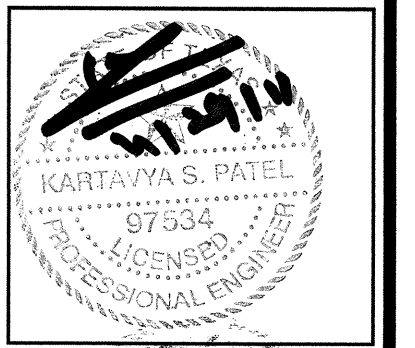

**Racetrac**  
THESE PLANS ARE SUBJECT TO FEDERAL COPYRIGHT LAWS. ANY USE OF SAME WITHOUT THE EXPRESSED WRITTEN PERMISSION OF RACETRAC PETROLEUM, INC. IS PROHIBITED. © 2000 RACETRAC PETROLEUM, INC.

**Racetrac**  
RACETRAC PETROLEUM, INC.  
300 TECHNOLOGY COURT  
SMYRNA, GEORGIA 30082  
(770) 431-7600

ADA PLAN	DATE	DWG. NO.
RACETRAC SERVICE STATION	5/18/10	11
S.H. 205 & S.H. 276	SCALE	
ROCKWALL, TEXAS	1"=30'	
	DRAWN BY	CS

SHEET NO.	REV.
11	-



ALL RESPONSIBILITY FOR ADEQUACY OF DESIGN REMAINS WITH THE DESIGN ENGINEER. THE CITY OF ROCKWALL, IN REVIEWING AND RELEASING PLANS FOR CONSTRUCTION, ASSUMES NO RESPONSIBILITY FOR ADEQUACY OR ACCURACY OF DESIGN.

