

18" DIA. CULVERT PROFILE 'A'
(PUBLIC)

SCALE:
HOR. 1"=30'
VERT. 1"=6'

NOTE: REFER SHEET 7.1 FOR THE CULVERT CALCULATION.

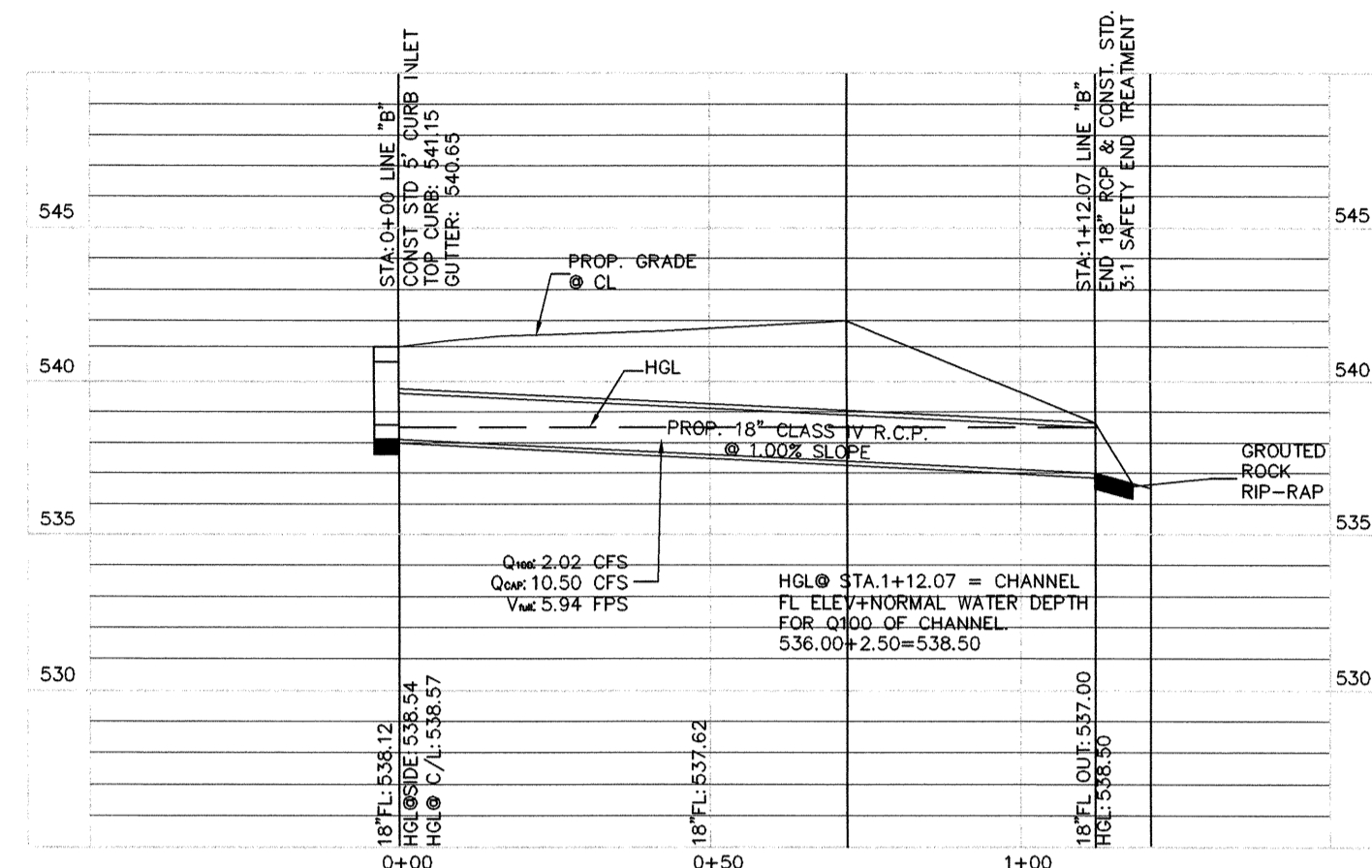

18" STORM SEWER PROFILE 'B'
(PRIVATE)

SCALE:
HOR. 1"=30'
VERT. 1"=6'

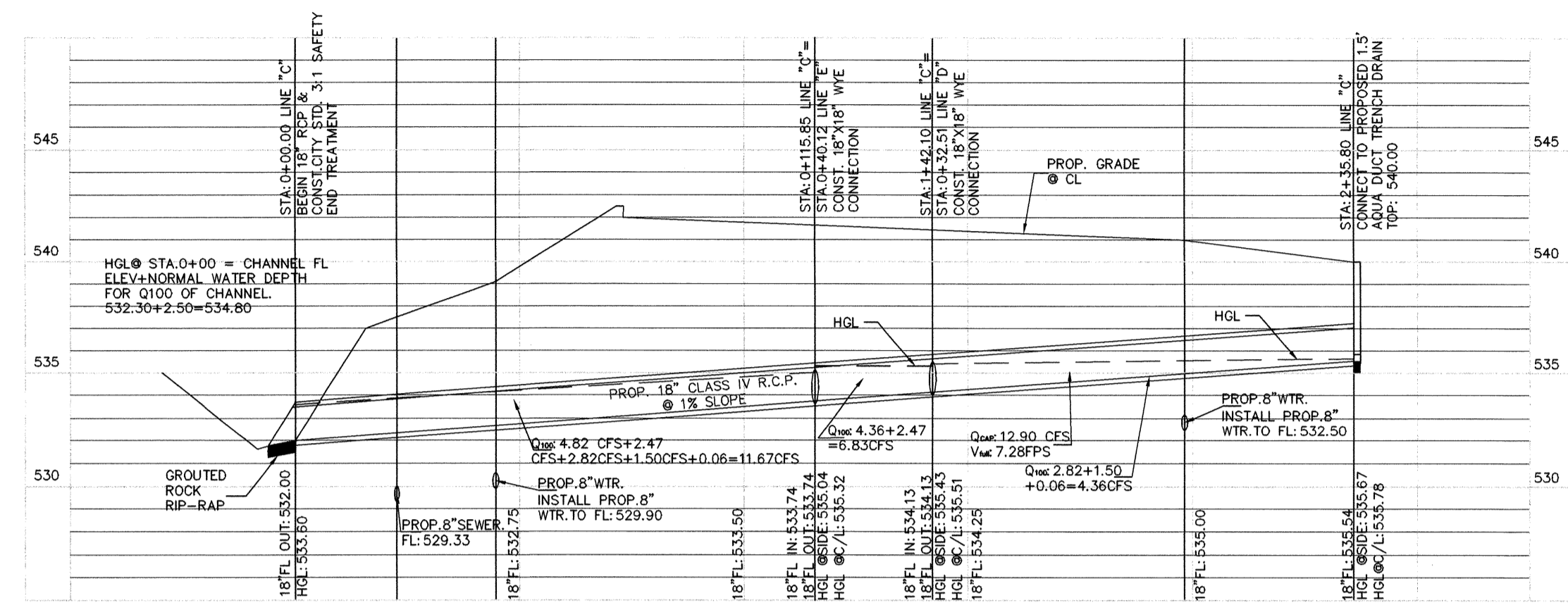

24" STORM SEWER PROFILE 'C'
(PRIVATE)

SCALE:
HOR. 1"=30'
VERT. 1"=6'

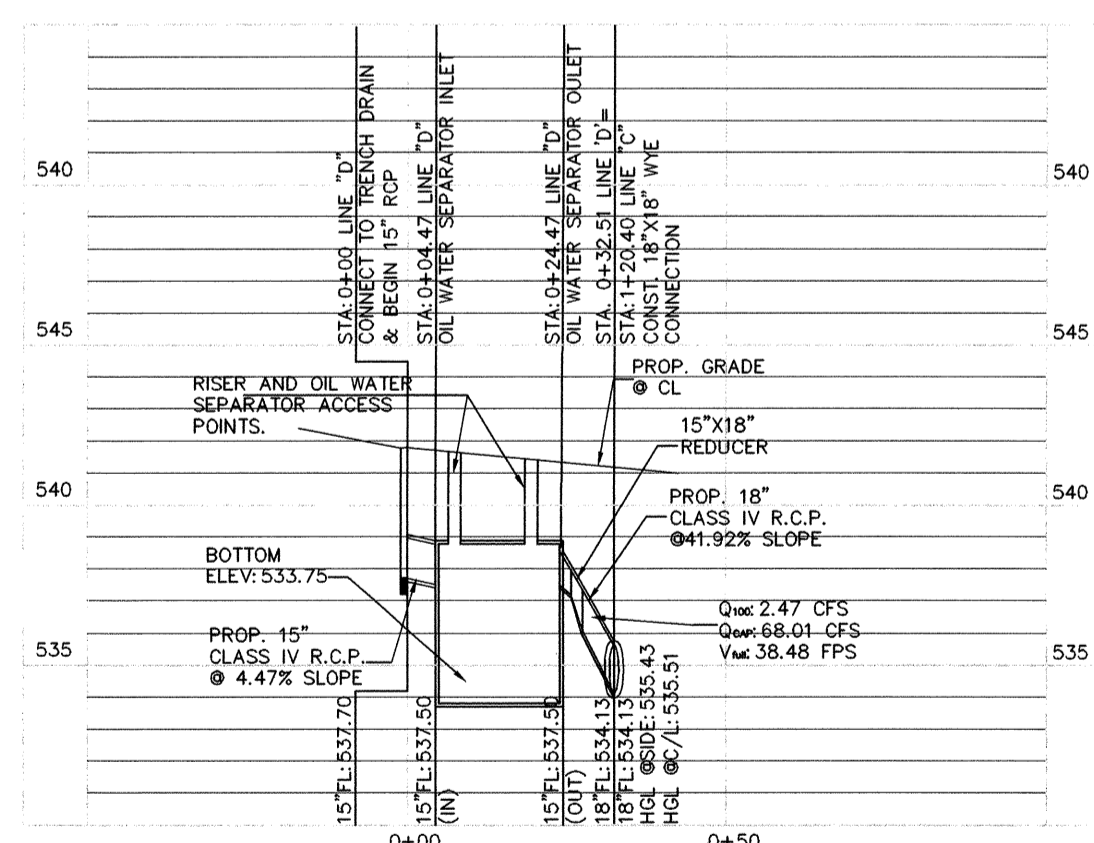

18" STORM SEWER PROFILE 'D'
(PRIVATE)

SCALE:
HOR. 1"=30'
VERT. 1"=6'

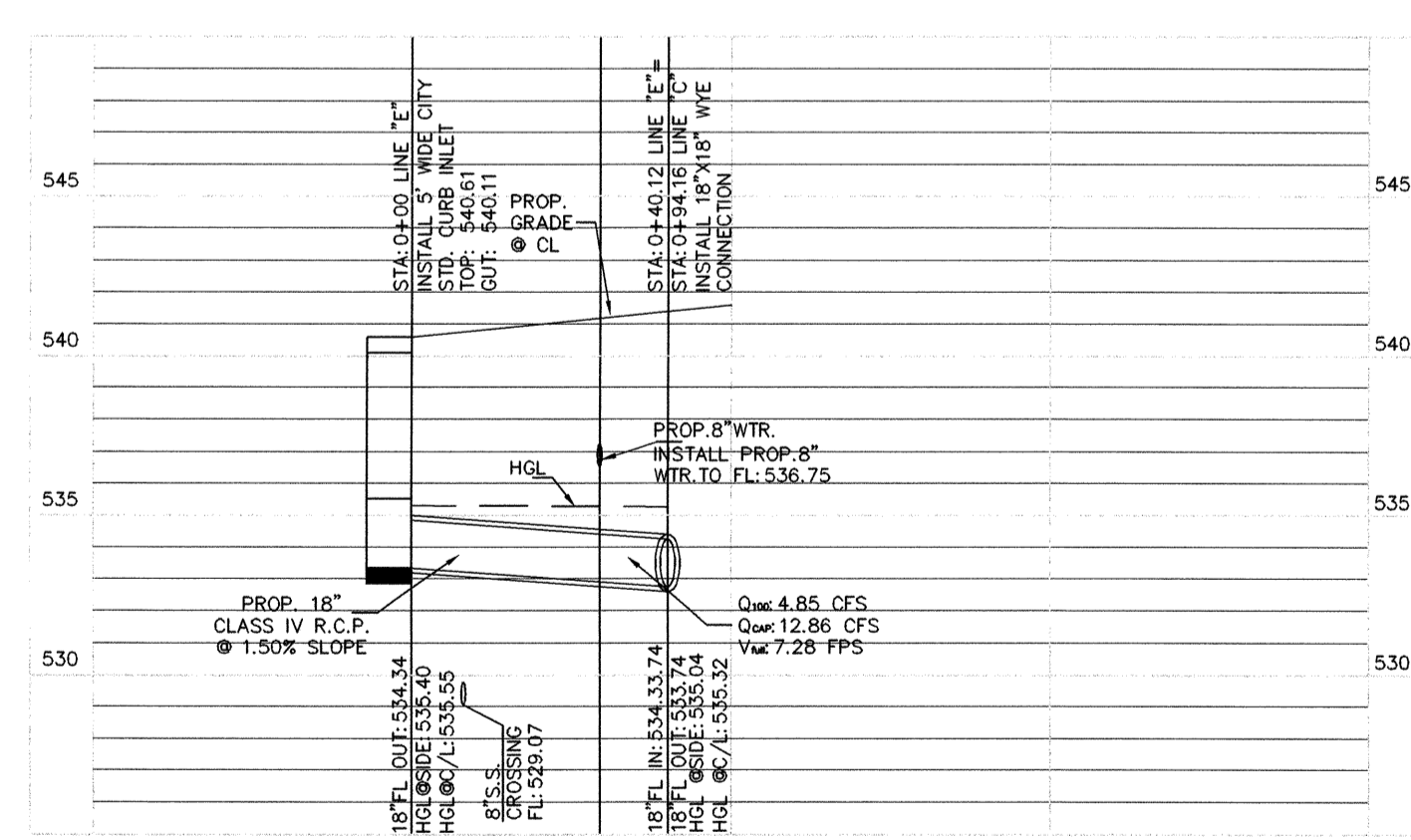

18" STORM SEWER PROFILE 'E'
(PRIVATE)

SCALE:
HOR. 1"=30'
VERT. 1"=6'

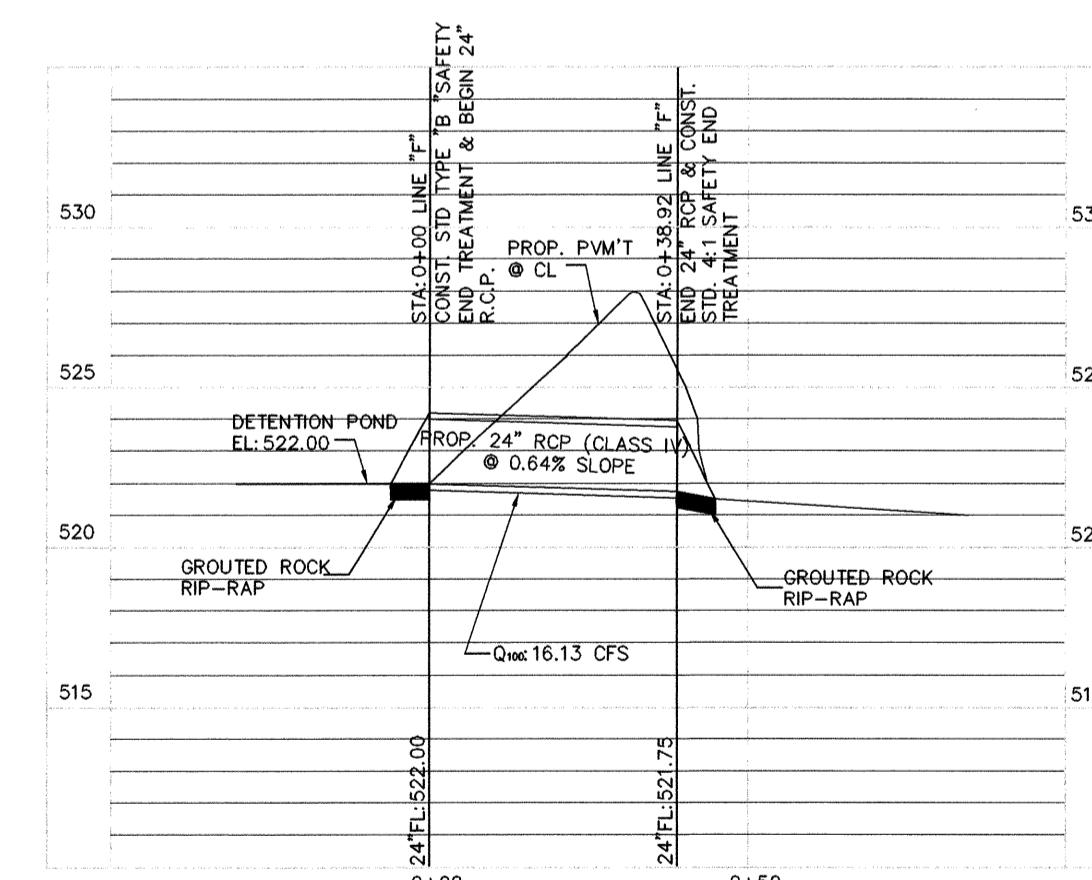

24" STORM SEWER CULVERT PROFILE 'F'
(PUBLIC)

SCALE:
HOR. 1"=30'
VERT. 1"=6'

NOTE: REFER SHEET 7.1 FOR THE CULVERT CALCULATION.

ALL RESPONSIBILITY FOR ADEQUACY OF DESIGN REMAINS WITH THE DESIGN ENGINEER. THE CITY OF ROCKWALL, IN REVIEWING AND RELEASING PLANS FOR CONSTRUCTION, ASSUMES NO RESPONSIBILITY FOR ADEQUACY OR ACCURACY OF DESIGN.

BENCH MARKS:
BM #1

AT THE NORTHWEST CORNER OF THE CONCRETE BRIDGE ON HIGHWAY 205, IN THE TOP OF THE CONCRETE GUARDRAIL BASE, 17' SOUTHWEST OFF THE HIGHWAY 205 CENTERLINE AND 3' SOUTHEAST OF THE NORTHWEST END OF THE GUARDRAIL BASE.
ELEVATION = 524.55

AS-BUILT

THE DIMENSION GROUP
FIRM REGISTRATION # F-8396
CIVIL ENGINEERING • LAND DEVELOPMENT • PLANNING • ARCHITECTURE • CONSTRUCTION MANAGEMENT
10755 SANDHILL ROAD, DALLAS, TEXAS 75238 TEL: 214-343-9400 FAX: 214-341-0000

NO.	AS-BUILTS	DATE
1		4/18/11

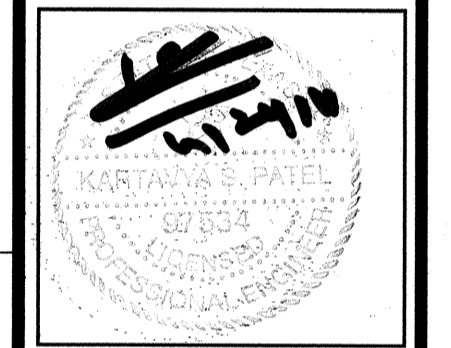

Racetrac
THESE PLANS ARE SUBJECT TO FEDERAL COPYRIGHT LAWS. ANY USE OF SAME WITHOUT THE EXPRESSED WRITTEN PERMISSION OF RACETRAC PETROLEUM, INC. IS PROHIBITED.
© 2001 RACETRAC PETROLEUM, INC.

Racetrac
RACETRAC PETROLEUM, INC.
300 TECHNOLOGY COURT
SMARNA, GEORGIA 30082
(770) 431-7600

DRAINAGE PROFILES	
RACETRAC SERVICE STATION	
SH 205 & SH 276	
ROCKWALL, TEXAS	
SCALE	DATE
1"=30'	5/18/10
DRAWN BY	DWG. NO.
CS	7.2
SHEET NO.	REV.
7.2	-