

# STATE HIGHWAY 276

(120' RIGHT-OF-WAY)



### GRADING GENERAL NOTES

- REFER TO GEOTECHNICAL ENGINEERING REPORT PREPARED BY CMJ ENGINEERING, INC. DATED MAY 2010, REPORT NO. 1485-10-01 FOR SITE WORK.
- TRENCH SAFETY: IF ANY TRENCH ON THIS JOB SITE, INCLUDING OPEN EXCAVATIONS WHOSE DIMENSIONS CAUSE THEM TO BE CONSIDERED TRENCHES BY O.S.H.A., REGARDLESS OF WHETHER FOR THE INSTALLATION OF UTILITIES, FOUNDATIONS OR ANY OTHER SITE ELEMENT, IS EQUAL TO OR GREATER THAN 5.00' DEPTH, THEN THE CONTRACTOR SHALL NOT PERFORM ANY TRENCHING ON THIS SITE UNTIL HE HAS FIRST OBTAINED DETAILED PLANS AND SPECIFICATIONS FOR TRENCH SAFETY SYSTEMS CONFORMING TO O.S.H.A. REQUIREMENTS. SUCH PLANS AND SPECIFICATIONS SHALL BE PREPARED BY A REGISTERED PROFESSIONAL ENGINEER EMPLOYED BY OR CONTRACTED BY THE CONTRACTOR AND SHALL BE CONSIDERED A PART OF THE CONTRACTOR'S MEANS AND METHOD'S OF CONSTRUCTION. IF THIS PROJECT IS OFFERED FOR BID, THE BIDS MUST CONTAIN A SEPARATE UNIT PRICE PAY ITEM FOR TRENCH SAFETY.
- ALL SURPLUS EXCAVATION AND WASTE MATERIAL SHALL BECOME THE PROPERTY OF THE CONTRACTOR AND IT SHALL BE HIS SOLE RESPONSIBILITY TO REMOVE SUCH SURPLUS EXCAVATION AND WASTE MATERIAL FROM THE SITE TO A PUBLIC DUMP SITE APPROVED FOR THE DISPOSAL OF SUCH MATERIALS. IF SURPLUS EXCAVATION IS REMOVED FROM THIS SITE TO ANOTHER PROPERTY, IT SHALL BE PLACED ON SUCH PROPERTY WITH THE WRITTEN CONSENT OF THE OWNER(S) OF SUCH PROPERTY. IF DUMPED IN THE CITY LIMITS THERE MUST BE A FILL PERMIT APPROVAL BY THE CITY. A COPY OF SUCH WRITTEN CONSENT SHALL BE PROVIDED TO THE OWNER. IF THE CONTRACTOR WISHES TO DISPOSE OF SURPLUS EXCAVATION ON-SITE, IT SHALL BE ONLY WITH THE PRIOR APPROVAL OF THE THE CITY, WITH A NEW GRADING PLAN, AND THE OWNERS PROJECT REPRESENTATIVE AND CARE SHOULD BE TAKEN TO AVOID BLOCKING NATURAL DRAINAGE AND INCREASING STEEP SLOPES. IF ANY OF THE HAULED EXCAVATION MATERIAL IS TAKEN TO ANOTHER LOCATION WITHIN THE CITY OF ROCKWALL LIMITS, THE OWNER OF THE PROPERTY IS REQUIRED TO OBTAIN A LOT GRADING PERMIT BEFORE MATERIAL IS DELIVERED.
- THE CONTRACTOR IS REQUIRED TO PROVIDE HIS OWN STAKING AND TO VERIFY PROJECT ELEVATIONS. "MATCH EXISTING" SHALL BE UNDERSTOOD TO APPLY TO BOTH VERTICAL ELEVATION AND HORIZONTAL ALIGNMENT.
- ANY EXISTING SITE IMPROVEMENTS OR UTILITIES REMOVED, DAMAGED OR UNDERCUT BY THE CONTRACTOR'S OPERATIONS SHALL BE REPAIRED OR REPLACED AS DIRECTED BY THE OWNER'S REPRESENTATIVE AND AS APPROVED BY THE OWNER OF SUCH UTILITY. ANY SUCH REPAIR OR REPLACEMENT SHALL BE AT THE CONTRACTOR'S SOLE EXPENSE.
- THE CONTRACTOR SHALL PREPARE ALL LANDSCAPE AREAS INCLUDING STREET RIGHT-OF-WAY AREAS TO AN ACCEPTABLE SUB-GRADE CONDITION IN ACCORDANCE WITH THE LANDSCAPE PLANS. (NOTE: ALL R.O.W. SHALL BE SODDED) IF THE CONTRACTOR IS NOT EMPLOYED TO PROVIDE AND INSTALL LANDSCAPING, HE SHALL PREPARE A FINISHED AND COMPACTED SUB-GRADE IN THE LANDSCAPING AREAS 4" BELOW NOMINAL FINISH GRADE AS SHOWN ON THE PLANS AND SHALL ADD 2" OF TOPSOIL TO BRING LANDSCAPING SUB-GRADE AS PROVIDED TO THE LANDSCAPING CONTRACTOR, TO 2" BELOW NOMINAL FINISH GRADE.
- THE CONTRACTOR SHALL STOCKPILE AN ADEQUATE QUANTITY OF TOPSOIL FOR USE BY THE LANDSCAPER TO BRING FINISH GRADE IN THE LANDSCAPED AREAS TO NOMINAL FINISH GRADE AS SHOWN ON THESE PLANS. WHERE SOD IS PLACED, ADJUST GRADES SO THAT TOP OF SOD MATCHES TOP OF CURB AND FLOW LINES OF DRAINAGE SWALES, UNLESS OTHERWISE SPECIFIED ON THESE PLANS.
- CEMENT STABILIZED SAND BEDDING REQUIRED FOR STORM DRAIN INLET STRUCTURES AND JUNCTION BOXES.
- ALL FILL TO BE COMPACTED TO A MIN. OF 95% STANDARD DENSITY.
- ALL FILL TO BE COMPACTED USING A SHEEP'S FOOT ROLLER.

### BENCH MARKS:

BM #1

AT THE NORTHWEST CORNER OF THE CONCRETE BRIDGE ON HIGHWAY 205, IN THE TOP OF THE CONCRETE GUARDRAIL BASE, 17' SOUTHWEST OFF THE HIGHWAY 205 CENTERLINE AND 3' SOUTHEAST OF THE NORTHWEST END OF THE GUARDRAIL BASE. ELEVATION = 524.55

### LEGEND

SPOT ELEVATION AT FINISHED GRADE	46.15
PROPOSED TOP OF CURB	46.65
PROPOSED TOP OF PAVING	46.15
OUTSIDE ELEVATION	O.E. 46.15
EXISTING CONTOURS	530
PROPOSED CONTOURS	530
HIGH POINT	H.P.

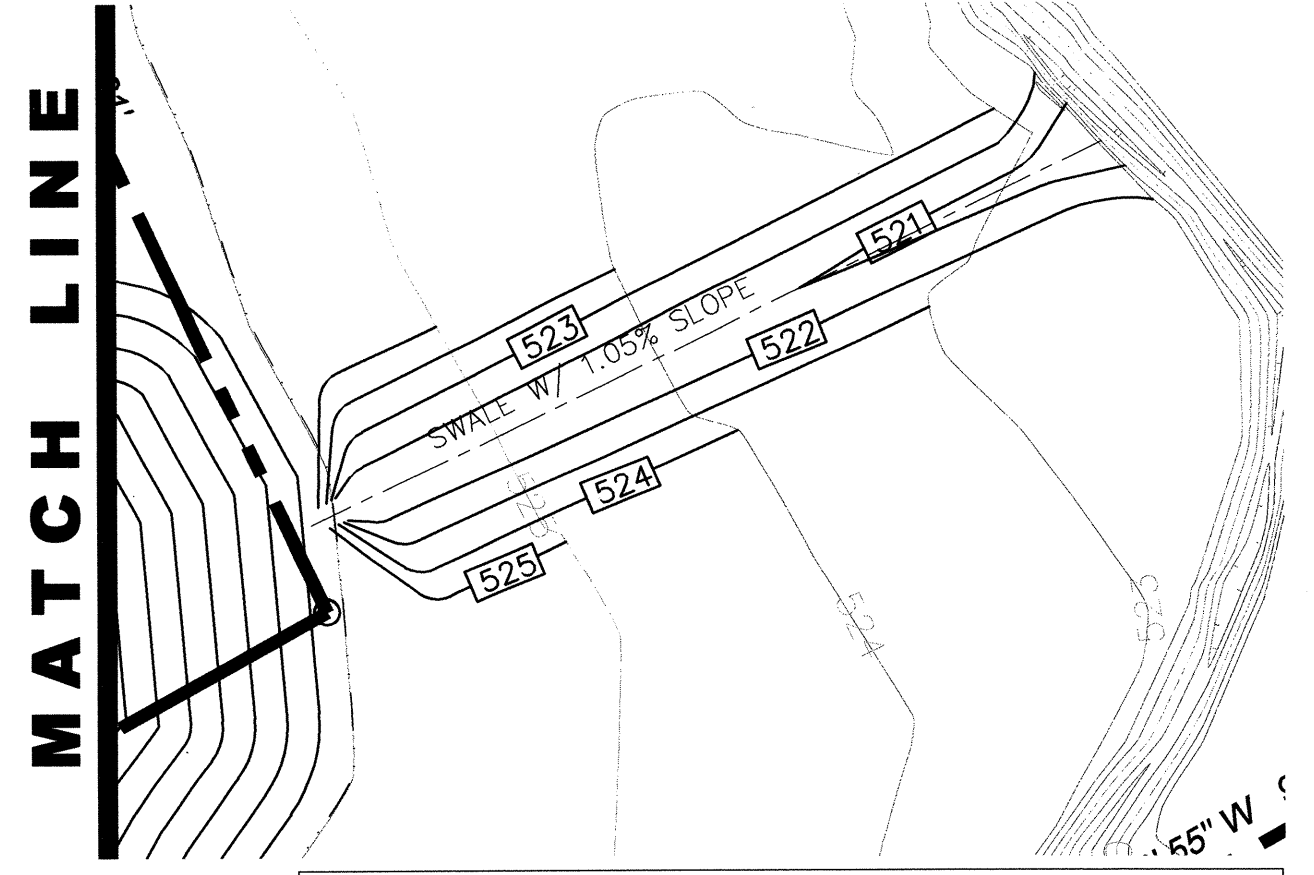

AS-BUILT

FIRM REGISTRATION # F-6396

CIVIL ENGINEERING • LAND DEVELOPMENT • PLANNING • ARCHITECTURE • CONSTRUCTION MANAGEMENT  
10755 SANDHILL ROAD, DALLAS, TEXAS 75238 TEL: 214-343-9400 FAX: 214-341-9000

ALL RESPONSIBILITY FOR ADEQUACY OF DESIGN REMAINS WITH THE DESIGN ENGINEER. THE CITY OF ROCKWALL, IN REVIEWING AND RELEASING PLANS FOR CONSTRUCTION, ASSUMES NO RESPONSIBILITY FOR ADEQUACY OR ACCURACY OF DESIGN.

DATE	4/18/11
BY	RP
REVISIONS	
NO.	1
AS-BUILTS	
<p><b>Racetrac</b> THESE PLANS ARE SUBJECT TO FEDERAL COPYRIGHT LAWS. ANY USE OF SAME WITHOUT THE EXPRESSED WRITTEN PERMISSION OF RACETRAC PETROLEUM, INC. IS PROHIBITED. © 2010 RACETRAC PETROLEUM, INC.</p>	
<p><b>Racetrac</b> RACETRAC PETROLEUM, INC. 300 TECHNOLOGY COURT SMYRNA, GEORGIA 30082 (770) 431-7600</p>	
GRADING PLAN	
RACETRAC SERVICE STATION	
SITE	S.H. 205 & S.H. 276 ROCKWALL, TEXAS
SCALE	1"=30'
DATE	5/18/2010
DWG. NO.	6
DRAWN BY	CS
<b>6</b>	-
SHEET NO.	REV.