

CIVIL SITE DEVELOPMENT PLANS

FOR

ROCKWALL RETAIL CENTER

ROCKWALL, TEXAS

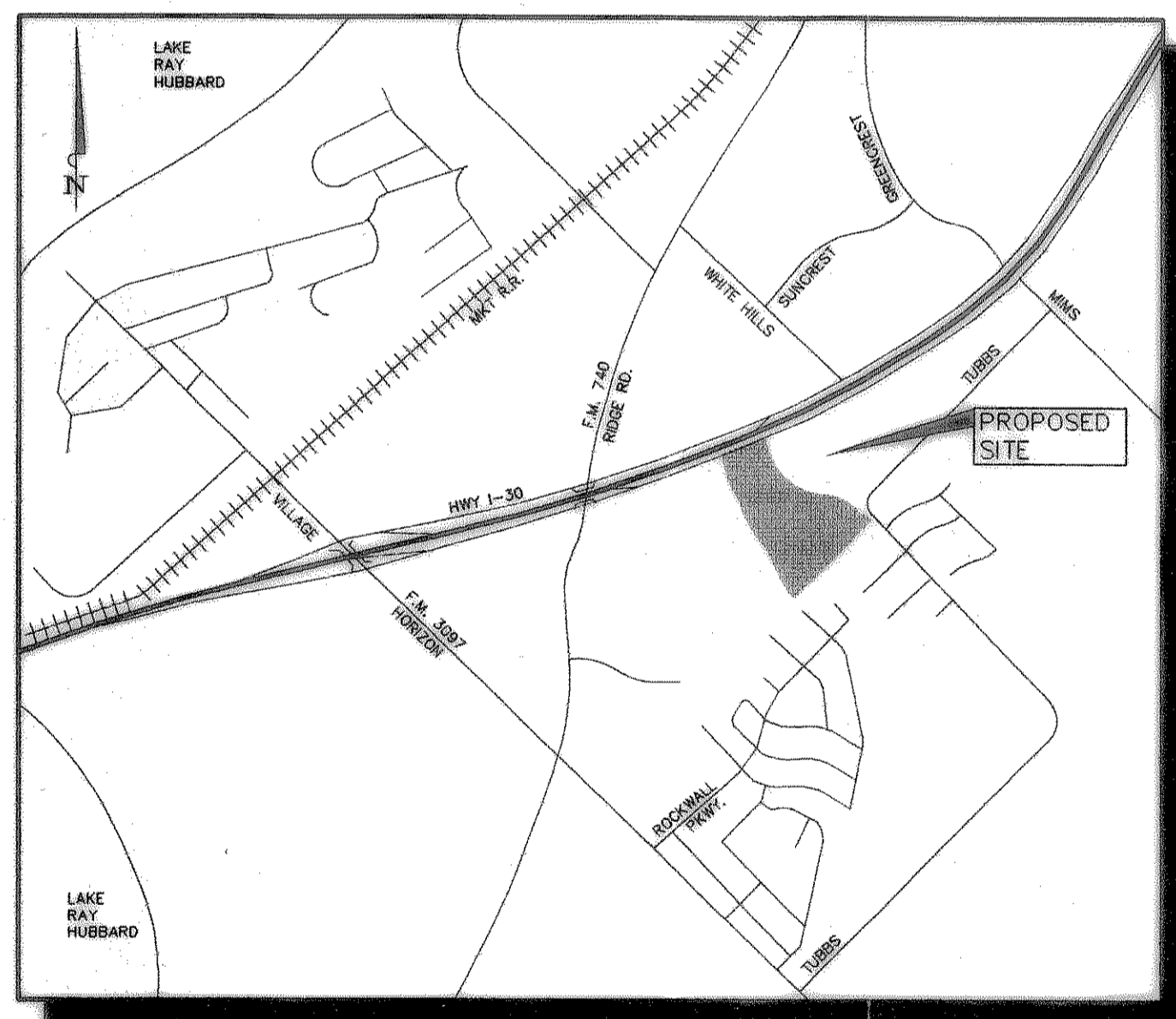

VICINITY MAP

INDEX OF SHEETS

SHEET NO.	DESCRIPTION	REVISION
C-1	COVER SHEET	
C-2	SITE PLAN	
C-3a	FINAL PLAT - SHEET 1	
C-3b	FINAL PLAT - SHEET 2	
C-3c	FINAL PLAT - SHEET 3	
C-4	PAVING AND DIMENSION CONTROL PLAN - NORTH	
C-5	PAVING AND DIMENSION CONTROL PLAN - SOUTH	
C-6	GRADING PLAN - NORTH	
C-7	GRADING PLAN - SOUTH	
C-8	DRAINAGE AREA MAP	
C-9	STORM DRAINAGE PLAN - NORTH	
C-10	STORM DRAINAGE PLAN - SOUTH	
C-11	STORM DRAINAGE PROFILES	
C-12	STORM DRAINAGE PROFILES	
C-13	WATER AND SANITARY SEWER PLAN - NORTH	
C-14	WATER AND SANITARY SEWER PLAN - SOUTH	
C-15	SANITARY SEWER PROFILES	
C-16	EROSION CONTROL PLAN AND DETAILS	
C-17	DETAILS	
C-18	DETAILS	
LS-1	LANDSCAPE PLAN	

DEVELOPER:

D&D FINANCIAL GROUP
 8150 N. CENTRAL EXPRESSWAY
 SUITE 795
 DALLAS, TEXAS 75206
 TEL. NO. 214-750-8850
 FAX. NO. 214-750-7011
 CONTACT: SCOTT DABNEY

PREPARED BY:



**Kimley-Horn
 and Associates, Inc.**

12700 Park Central Drive, Suite 1800
 Dallas, Texas 75251

Tel. No. (972) 770-1300
 Fax No. (972) 239-3820

- NTMWD NOTES
- NORTH TEXAS MUNICIPAL WATER DISTRICT (NTMWD) PIPELINE IS LOCATED ON SITE.
 - OPERATION OF HEAVY EARTHMOVING EQUIPMENT, COMPACTION EQUIPMENT OR HEAVY CONSTRUCTION EQUIPMENT, SUCH AS CONCRETE TRUCKS, SHALL BE RESTRICTED TO SPECIFIC CROSSING POINTS ACROSS NTMWD EASEMENTS, AS APPROVED BY THE NTMWD. THE CROSSINGS SHALL BE DESIGNATED AND VERIFIED TO PROVIDE A MINIMUM OF 5 FEET OF COVER.
 - TO ASSURE THAT THE EXISTING PIPELINE IS NOT DAMAGED BY PLACING OF SIGNIFICANT LOADS OVER THE NTMWD PIPELINE, NO MATERIALS SHALL BE STOCKPILED ON THE NTMWD EASEMENT WITHOUT AUTHORIZATION FROM THE NTMWD. IF THE CONTRACTOR DESIRES TO USE NTMWD'S EASEMENT FOR STOCKPILE OF MATERIALS, CONTACT NTMWD ENGINEERING AT (972) 442-5405 SO YOUR PLANS FOR USE OF NTMWD'S EASEMENT CAN BE REVIEWED.
 - IN AREAS WHERE THE COVER BETWEEN THE TOP OF THE NTMWD PIPELINE AND THE BOTTOM OF THE SUB-GRADE IS THREE (3) FEET OR LESS, IT IS REQUESTED THAT THE SUB-GRADE PREPARATION BE DELETED AND A THICKENED PAVEMENT SECTION BE USED TO LIMIT CONSTRUCTION ACTIVITIES OVER THE PIPELINE.
 - CROSSING OF THE NTMWD EASEMENT WITH OTHER UTILITIES, SUCH AS TV CABLE, PHONE, GAS AND ELECTRIC, SHALL BE COORDINATED WITH THE NTMWD TO AVOID DAMAGE TO THE NTMWD FACILITIES.
 - OUTDOOR LIGHTING, LANDSCAPING, SCREENING WALLS OR OTHER FACILITIES SHALL NOT BE INSTALLED IN NTMWD EASEMENTS WITHOUT WRITTEN APPROVAL OF THE NTMWD.
 - UNLESS OTHERWISE SHOWN OR REQUIRED, A MINIMUM OF ONE-FOOT CLEARANCE SHALL BE PROVIDED FOR ALL UTILITIES CROSSING THE NTMWD PIPELINES.
 - *THE CONTRACTOR SHALL CONTACT NTMWD ENGINEERING AT (972)442-5405 AT LEAST 48 HOURS PRIOR TO PERFORMING ANY WORK IN THE VICINITY OF THE NTMWD FACILITIES.*

"RECORD DRAWINGS"

NOTE: THE INTENT OF THE OWNER AND ENGINEER WAS TO CONSTRUCT THE IMPROVEMENTS ACCORDING TO THESE PLANS AS APPROVED BY THE CITY OF ROCKWALL. THE LINES AND GRADES WERE SET ON THE GROUND FOR CONSTRUCTION ACCORDING TO SAID PLANS. WE ARE NOT AWARE OF ANY CHANGES OR REVISIONS TO THESE PLANS DURING CONSTRUCTION EXCEPT AS NOTED ON THE PLANS.

