

CURVE	RADIUS	LENGTH	TANGENT	CHORD	BEARING	DELTA
C1	515.41'	400.31'	210.86'	390.32'	N18°47'45" E	44°30'02"
C2	400.00'	56.80'	28.45'	56.76'	N60°42'27" W	08°08'12"
C3	164.39'	30.41'	15.25'	30.37'	S59°28'32" E	10°36'02"
C4	44.00'	64.76'	39.85'	59.07'	S12°00'39" E	84°19'43"

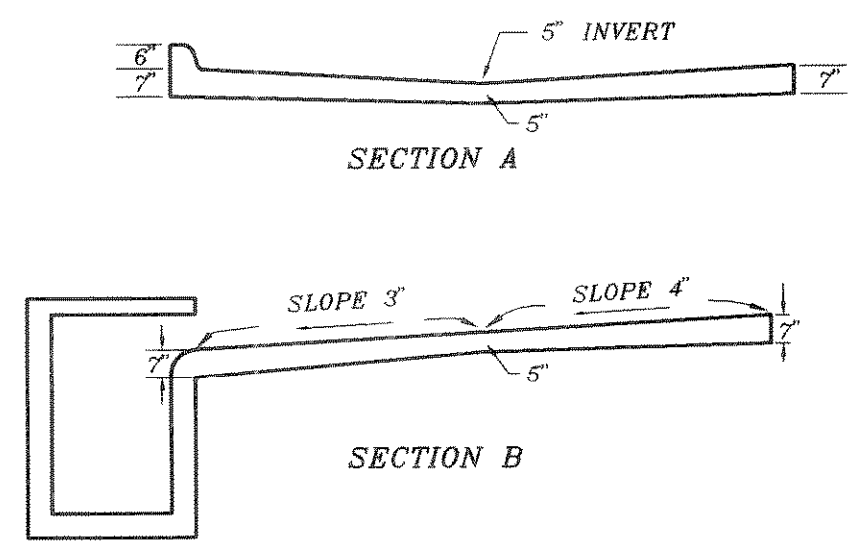

PAV. STA: 3+34.81
 C.L. 15' INLET
 T.C. 501.33
 THROAT 500.25
 F.L. 496.83

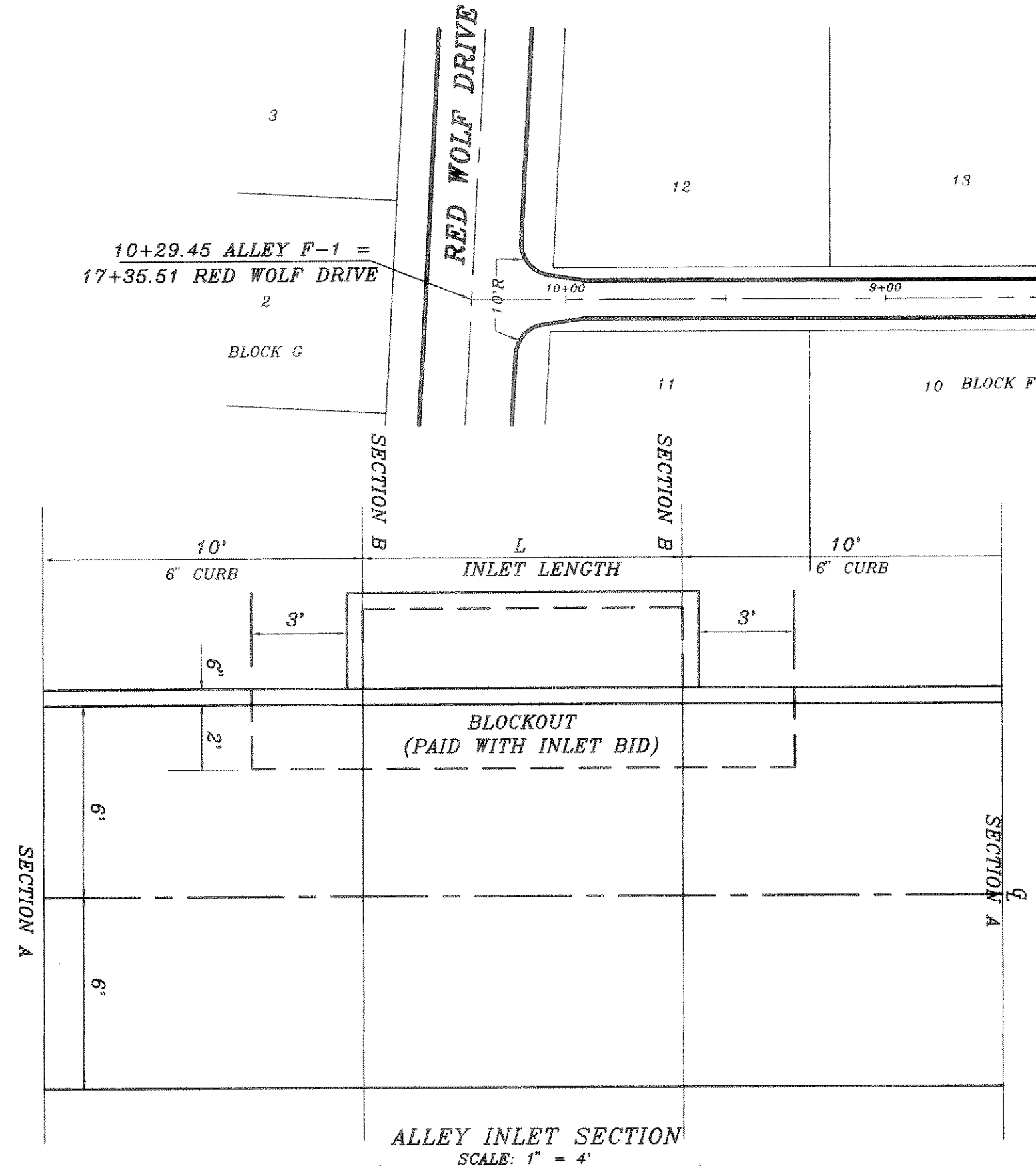
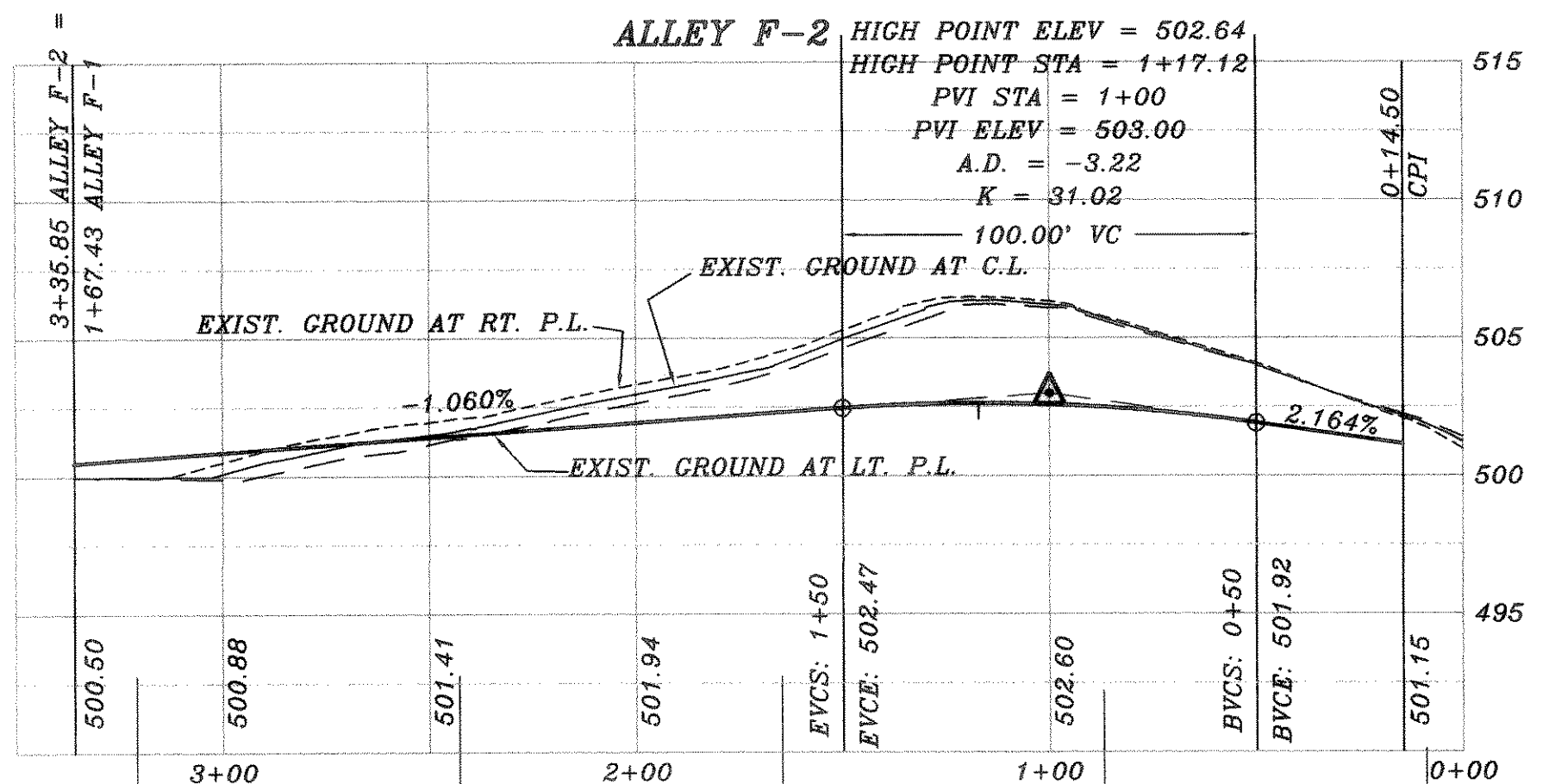
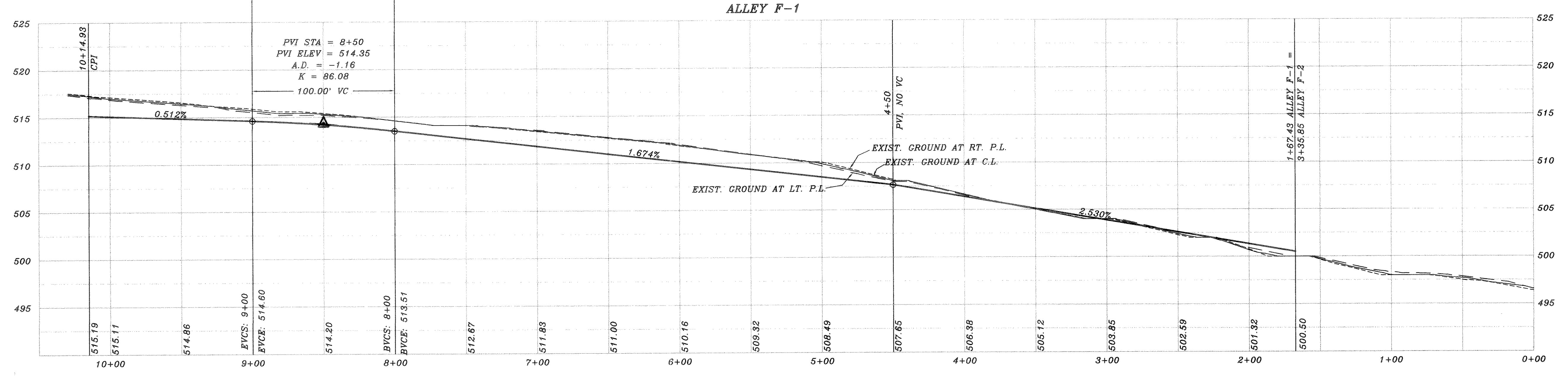

BENCH MARK
 SQUARE CUT IN CONCRETE AT BASE OF
 CONCRETE WALL AT S E CORNER OF
 SOUTH APPROACH TO BRIDGE OVER
 SQUABLE CREEK ON HWY. 205
 ELEV.: 472.41

BENCH MARK
 60D NAIL IN 36" PECAN TREE (TREE NO. 2302)
 PAV. STA. 8+30, 71' RT., MEMORIAL DRIVE
 ELEV.: 466.79

BENCH MARK
 60D NAIL IN 34" PECAN TREE (TREE NO. 2314)
 PAV. STA. 1+83, 138' RT., AUDOBON LANE
 ELEV.: 480.88

BENCH MARK
 60D NAIL IN 18" PECAN TREE (TREE NO. 2114)
 PAV. STA. 10+97, 63.5' RT., AUDOBON LANE
 ELEV.: 501.54

PHASE 2B

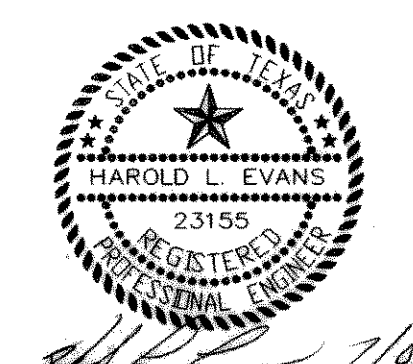

HAROLD L. EVANS CONSULTING ENGINEER P.O. BOX 28365 2331 CUS THOMASSON ROAD, SUITE 102 DALLAS, TEXAS 75228, (214) 328-8133	
REV. PER 4th REVIEW	7/12/01
REV. PER 2nd REVIEW	5/10/01
REVISION DESCRIPTION	DATE
0000_PHASE2B_00002P28	
SCALE 1" = 40' 1" = 6'	DESIGN H.L.E.
DRAWN	

PROPOSED PAVING
 ALLEY F-1 AND F-2
 QUAIL RUN VALLEY NO. 2
 CITY OF ROCKWALL

SHEET NO.	10
	24
JOB NO.	0020