

CURVE	RADIUS	LENGTH	TANGENT	CHORD	BEARING	DELTA
C1	20.00'	19.05'	10.31'	18.33'	S66°37'32" E	54°33'41"
C2	20.00'	19.05'	10.31'	18.33'	S58°48'48" W	54°33'41"
C3	39.50'	99.66'	123.63'	75.25'	S69°22'28" W	144°33'41"
C4	39.50'	99.66'	123.63'	75.25'	S76°11'12" E	144°33'41"

BENCH MARK  
SQUARE CUT IN CONCRETE AT BASE OF  
CONCRETE WALL AT S.W. CORNER OF  
SOUTH APPROACH TO BRIDGE OVER  
SQUABLE CREEK ON HWY. 205  
ELEV.: 472.41

BENCH MARK  
60D NAIL IN 34" PECAN TREE (TREE NO. 2314)  
PAV. STA. 1+83. 138' RT., AUDOBON LANE  
ELEV.: 460.88

BENCH MARK  
60D NAIL IN 36" PECAN TREE (TREE NO. 2302)  
PAV. STA. 8+30. 71' RT., MEMORIAL DRIVE  
ELEV.: 466.79

BENCH MARK  
60D NAIL IN 18" PECAN TREE (TREE NO. 2114)  
PAV. STA. 10+97. 63.5' RT., AUDOBON LANE  
ELEV.: 501.54

COVEY TRAIL

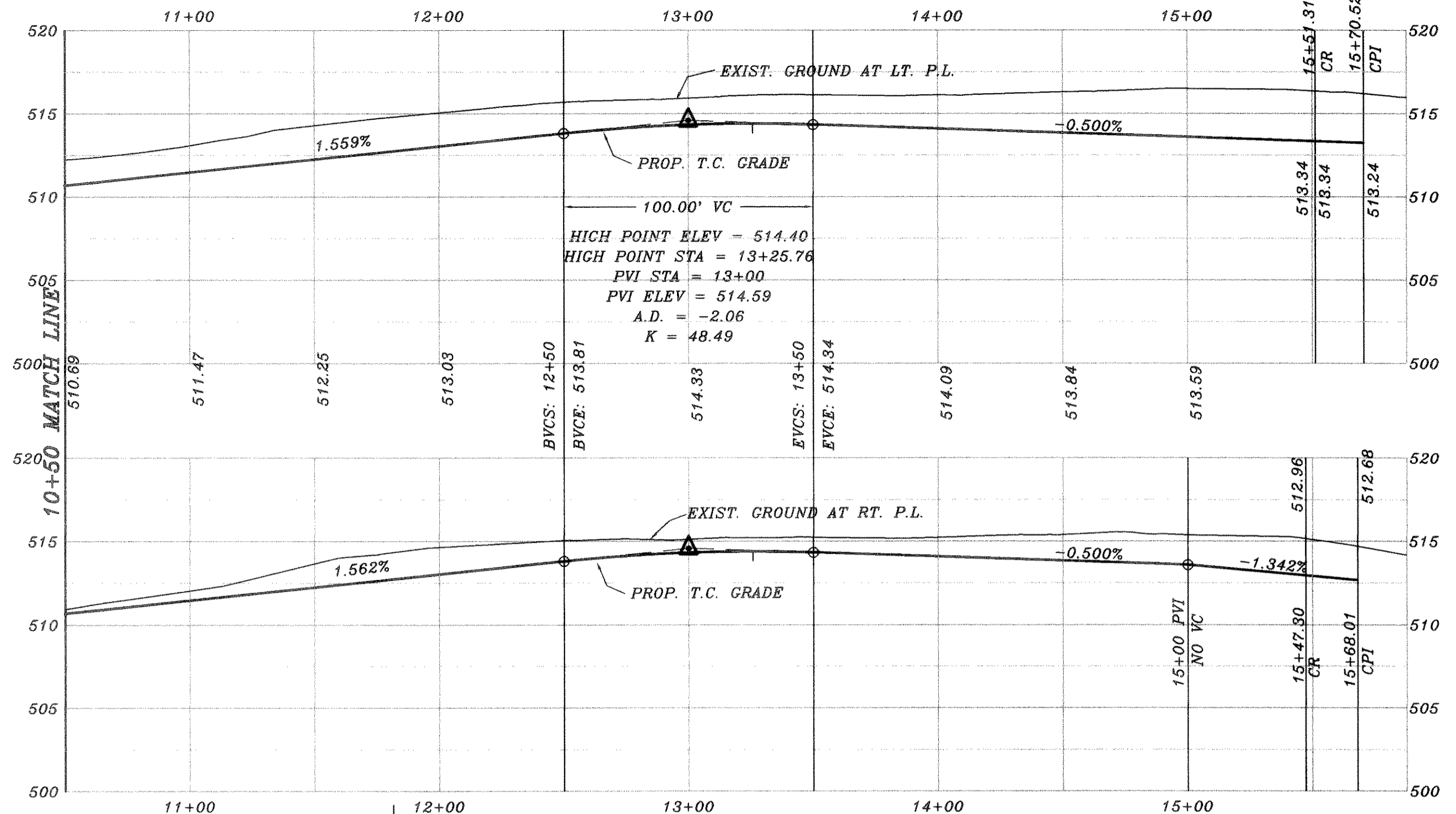

SAVANAH CT.

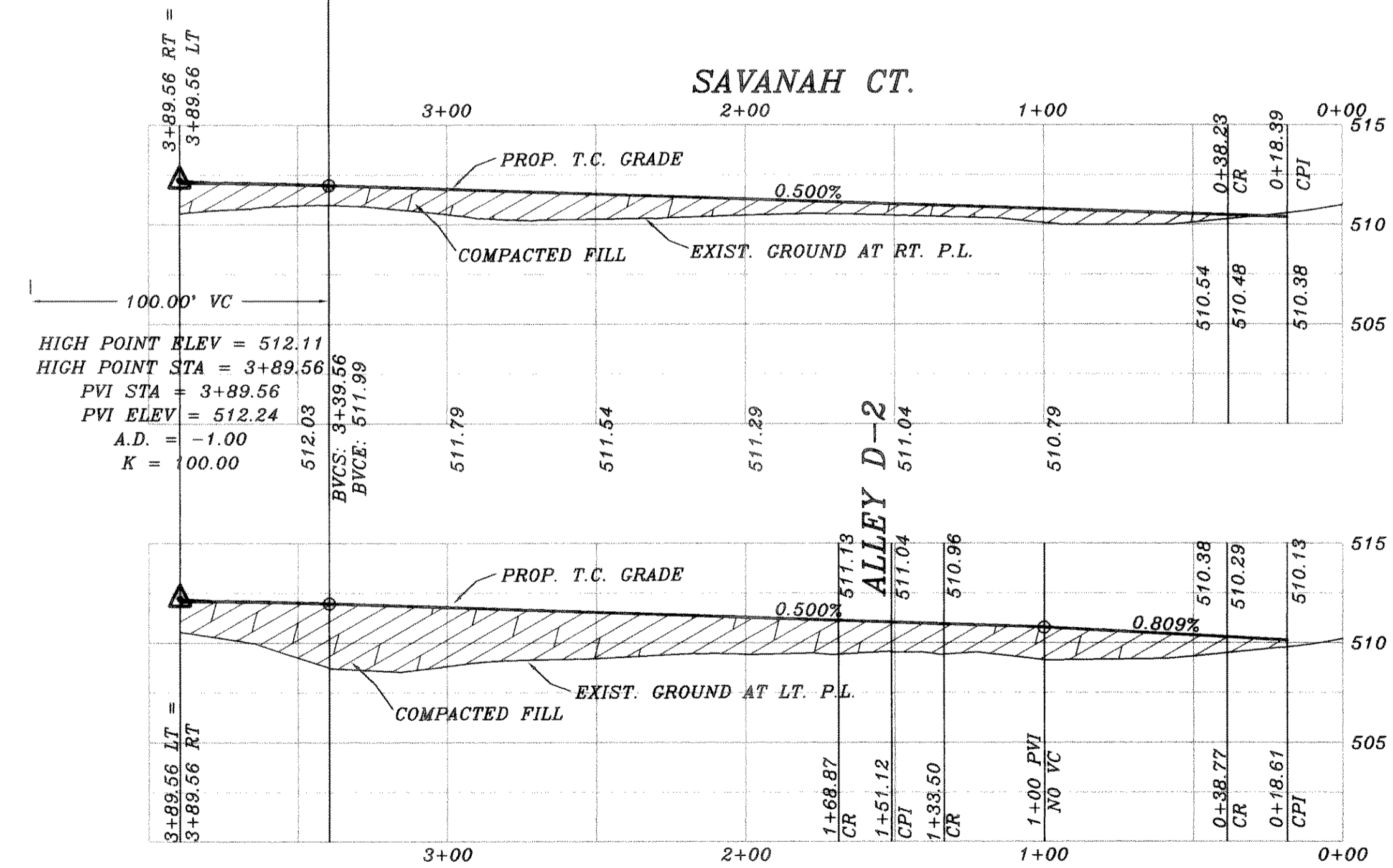

ASBUILT

Winkelmann & Associates, Inc. hereby states that this plan, to the best of our knowledge is "As Built." Modifications from the originally approved construction documents have been made as per information provided by the contractor. Winkelmann & Associates, Inc. does not certify as to the correctness or quality of construction as no field inspection was performed.

HAROLD L. EVANS  
CONSULTING ENGINEER  
P.O. BOX 28355  
23155  
REGISTERED PROFESSIONAL ENGINEER

9-27-08  
DATE  
Ph 2A



REVISION DESCRIPTION	DATE	SCALE	DESIGN	DRAWN
0020_PHASE2_0020P25		1" = 40' 1" = 6"	H.L.E.	

HAROLD L. EVANS  
CONSULTING ENGINEER  
P.O. BOX 28355  
2331 CUS THOMASSON ROAD, SUITE 102  
DALLAS, TEXAS 75228, (214) 328-8133

PROPOSED PAVING  
COVEY TRAIL AND SAVANAH CT.  
QUAIL RUN VALLEY NO. 2  
CITY OF ROCKWALL

SHEET NO.  
6  
24  
JOB NO.  
0020