

CURVE	RADIUS	LENGTH	TANGENT	CHORD	BEARING	DELTA
C1	100.00'	26.93'	13.55'	26.85'	S01°44'19" W	152°53'
C2	100.00'	75.61'	39.71'	73.82'	S31°06'53" W	43°19'15"
C3	100.00'	129.11'	75.32'	120.33'	N15°42'21" E	73°58'19"
C4	100.00'	36.28'	18.34'	36.08'	S10°48'17" E	20°47'03"
C5	100.00'	77.57'	40.68'	75.36'	N20°39'29" E	44°18'18"
C6	100.00'	39.56'	20.04'	39.31'	S09°51'23" W	22°40'07"
C7	100.00'	20.75'	10.41'	20.71'	N15°14'50" E	11°53'13"

NOTE: SEE OUTFALL WORKS DETAILS SHEET 17

42"
Q = 112.80
S = 0.10351
PARTIAL FLOW
Vp = 10.43
Qc = 323
d = 17.2'

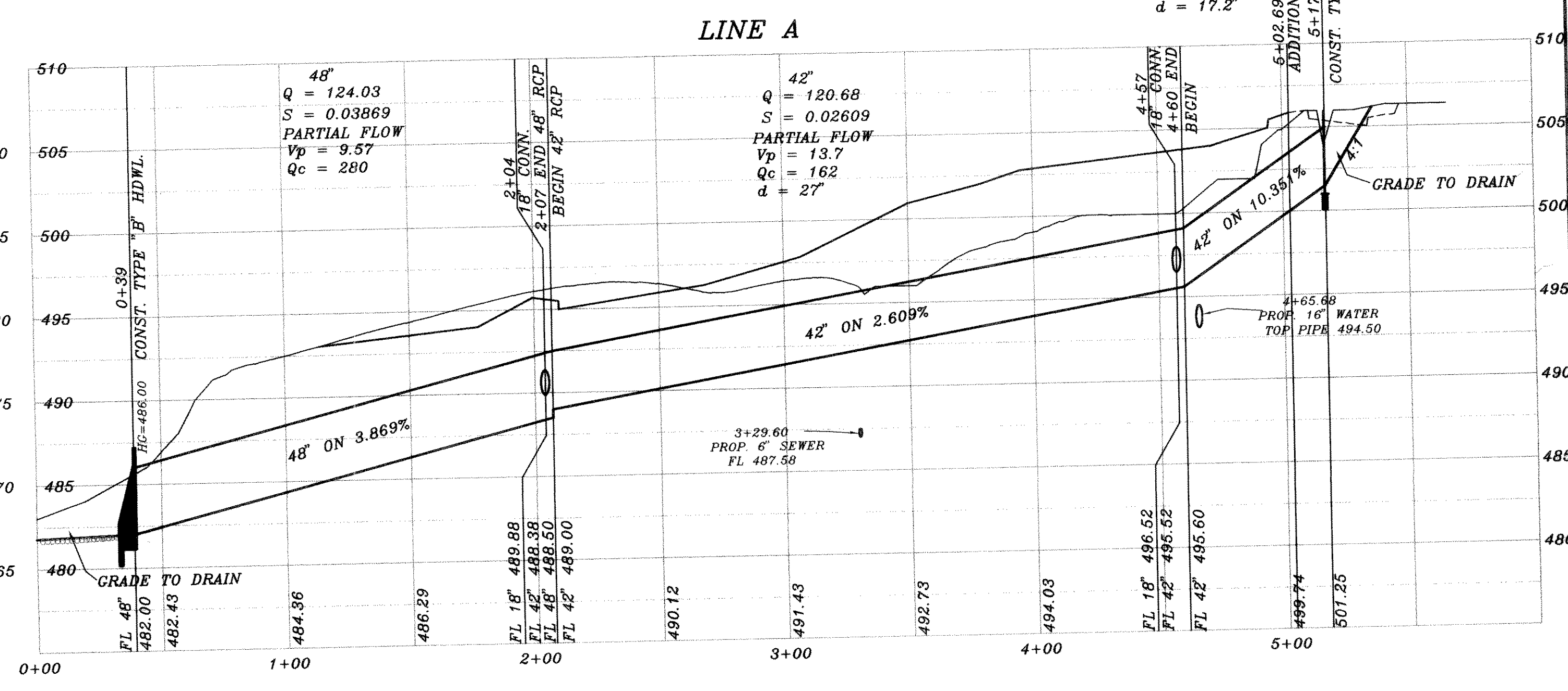
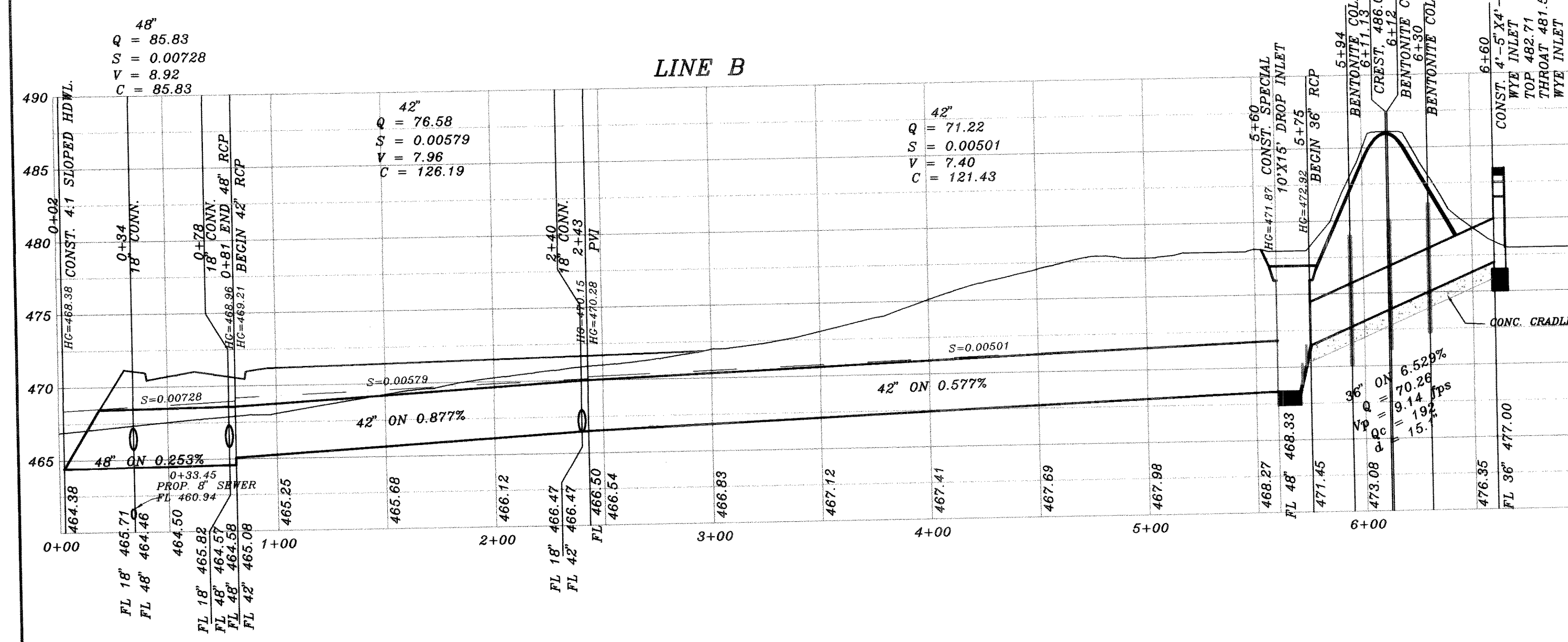

BENCH MARK
SQUARE CUT IN CONCRETE AT BASE OF
CONCRETE WALL AT S.W. CORNER OF
SOUTH APPROACH TO BRIDGE OVER
SQUABBLE CREEK ON HWY. 205
ELEV.: 472.41

BENCH MARK
60D NAIL IN 34' PECAN TREE (TREE NO. 2314)
PAV. STA. 1+83.138' RT. AUDOBON LANE
ELEV.: 480.88

BENCH MARK
60D NAIL IN 36' PECAN TREE (TREE NO. 2302)
PAV. STA. 8+39.71' RT. MEMORIAL DRIVE
ELEV.: 468.79

BENCH MARK
60D NAIL IN 18' PECAN TREE (TREE NO. 2114)
PAV. STA. 10+97.635' RT. AUDOBON LANE
ELEV.: 501.54



Winkelman & Associates, Inc. hereby states that this plan, to the best of our knowledge is "As Built." Modifications from the originally approved construction documents have been made as per information provided by the contractor, Winkelman & Associates, Inc. does not purport as to the correctness or quality of construction as no field inspection was performed.

J.E. Winkelman
WINKELMAN & ASSOCIATES, INC.
DATE: 4-10-02

HAROLD L. EVANS CONSULTING ENGINEER 2331 CUS THOMASSON ROAD, SUITE 102 DALLAS, TEXAS 75228. (214) 328-8133		PROPOSED DRAINAGE LINE A AND LINE B QUAIL RUN VALLEY NO. 1 CITY OF ROCKWALL	SHEET NO. 14 / 21
REVISION DESCRIPTION 0620STM1	DATE 11/6/00		SCALE 1" = 40' 1" = 6'