

CURVE	RADIUS	DELTA	LENGTH	CHORD	BEARING
C1	38.00'	91°28'18"	67.47'	51.86'	N48°33'47"W
C2	100.00'	67°14'53"	91.12'	66.06'	S81°24'38"W
C3	1585.00'	1°09'38"	39.72'	39.72'	S34°31'54"W

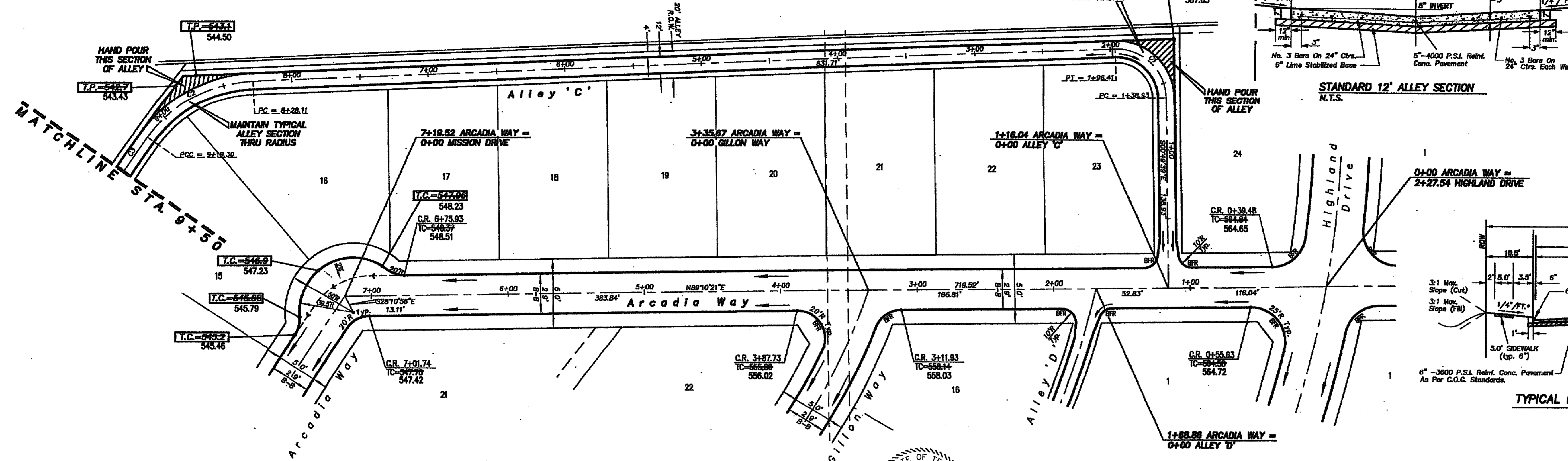
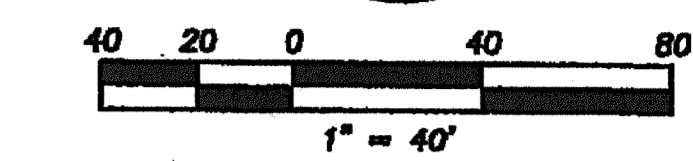
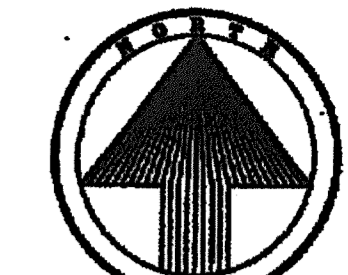

RECORD DRAWINGS

NOTE: THESE PLANS HAVE BEEN REVISED TO CONFORM WITH CONSTRUCTION RECORDS PROVIDED TO SPIARS ENGINEERING, INC. BY CONTRACTOR AND CITY STAFF AFTER AS-BUILTS WERE ORIGINALLY SUBMITTED TO THE CITY OF ROCKWALL BY OTHERS. MODIFICATIONS TO PAVING, PAD AND UTILITY ELEVATIONS, AS REFLECTED ON THESE PLANS, WERE VERIFIED BY FIELD SURVEY PERFORMED IN DECEMBER, 2008.

CAUTION EXISTING UTILITIES !!!
EXISTING UTILITIES AND UNDERGROUND FACILITIES INDICATED ON THESE PLANS HAVE BEEN LOCATED FROM REFERENCE INFORMATION. IT SHALL BE THE RESPONSIBILITY OF THE CONTRACTOR TO VERIFY BOTH HORIZONTAL AND VERTICAL LOCATION OF ALL EXISTING UTILITIES AND UNDERGROUND FACILITIES PRIOR TO CONSTRUCTION. TO TAKE THE NECESSARY PRECAUTIONS IN ORDER TO PROTECT ALL FACILITIES ENCOUNTERED, THE CONTRACTOR SHALL PRESERVE AND PROTECT ALL EXISTING UTILITIES FROM DAMAGE DURING CONSTRUCTION.

BENCHMARK: #1
BRASS CAP IN CL. OF MEDIAN NORTH ON LAKESHORE DRIVE NORTH OF THE INTERSECTION OF NORTH ALAMO AND LAKESHORE DRIVE
ELEV. 524.78

BENCHMARK: #2
BRASS CAP IN CL. OF MEDIAN ON LAKESHORE DRIVE BETWEEN TO STREETS, STONEBROOK AND AMESBURY BEING NORTH OF HAVEN HILL
ELEV. 518.83



ARCADIA WAY

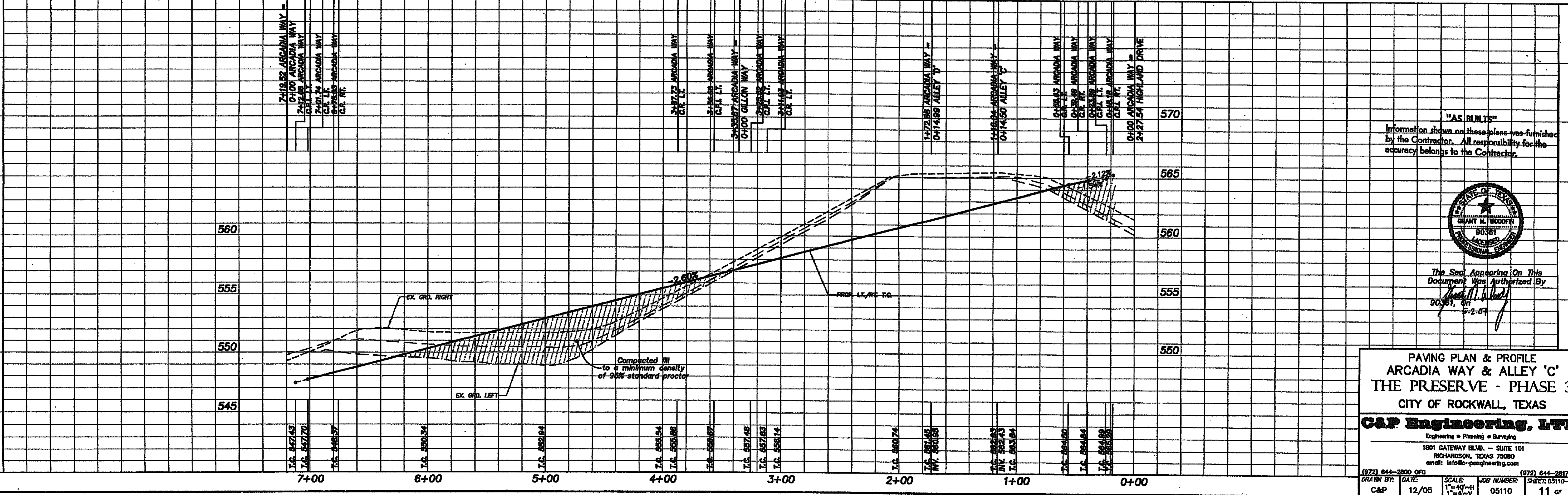

"AS BUILTS"
Information shown on these plans was furnished by the Contractor. All responsibility for the accuracy belongs to the Contractor.

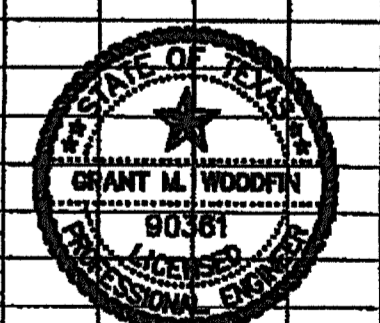

The Seal Appearing On This Document Was Authorized By
Grant M. Woodruff
90361, PE
2-2-07

PAVING PLAN & PROFILE
ARCADIA WAY & ALLEY 'C'
THE PRESERVE - PHASE 3
CITY OF ROCKWALL, TEXAS

C&P Engineering, LTD.
Engineering • Planning • Surveying
1801 GATEWAY BLVD. - SUITE 101
RICHARDSON, TEXAS 75080
email: info@c-pengineering.com

DRAIN BY: C&P DATE: 12/05 SCALE: 1"=40'-H, 1"=4'-V JOB NUMBER: 05110 SHEET: 05110-PavG 11 of 11