

PROP. PAVEMENT DETAIL
N.T.S.

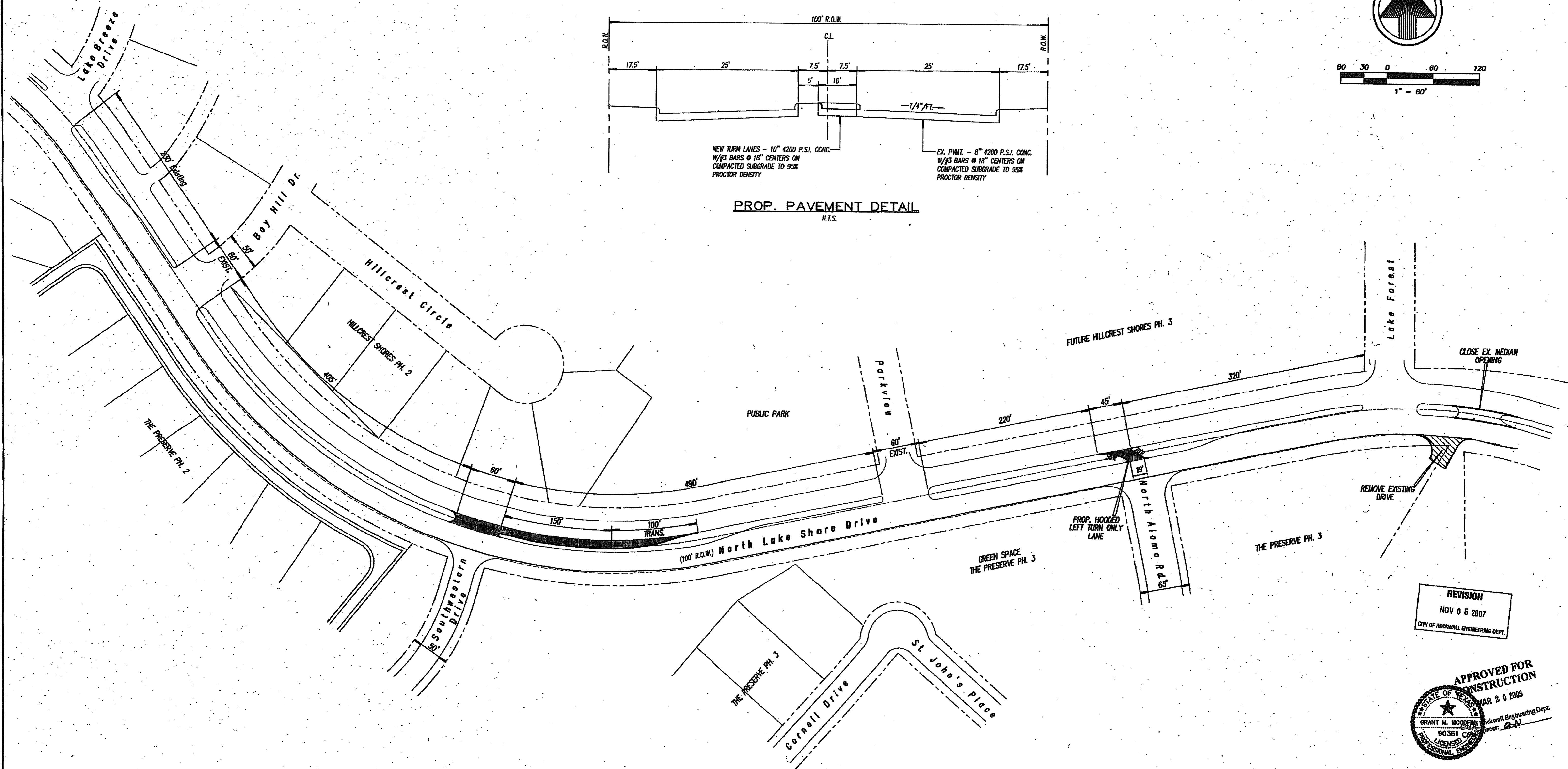

REVISION
NOV 05 2007
CITY OF ROCKWALL ENGINEERING DEPT.

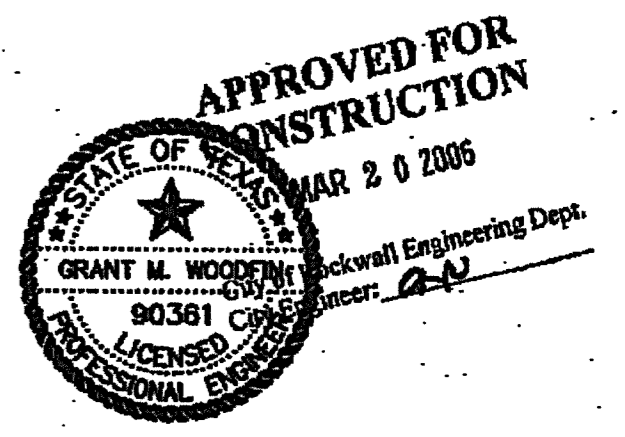

The Seal Appearing On This Document Was Authorized By
Grant M. Woodruff
90361, CE 11.2.07

TURN LANES - NORTH LAKESHORE BLVD.
THE PRESERVE - PHASE 2 & 3
CITY OF ROCKWALL, TEXAS

C&P Engineering, LTD.
Engineering • Planning • Surveying
1801 GATEWAY BLVD. - SUITE 101
RICHARDSON, TEXAS 75080
email: info@c-pengineering.com

(972) 644-2800 OFC (972) 644-2817 FAX

DRAWN BY: C&P	DATE: 11/07	SCALE:	JOB NUMBER: 05110	SHEET: OF
------------------	----------------	--------	----------------------	--------------