

NOTE:  
12" WATER LINE IN HIGHLAND DR. TO FACILITATE EX. 16" WATER  
AND REMAIN IN SERVICE UNTIL NEW 16" MAIN IS CONNECTED  
AT BOTH ENDS OF PROJECT.

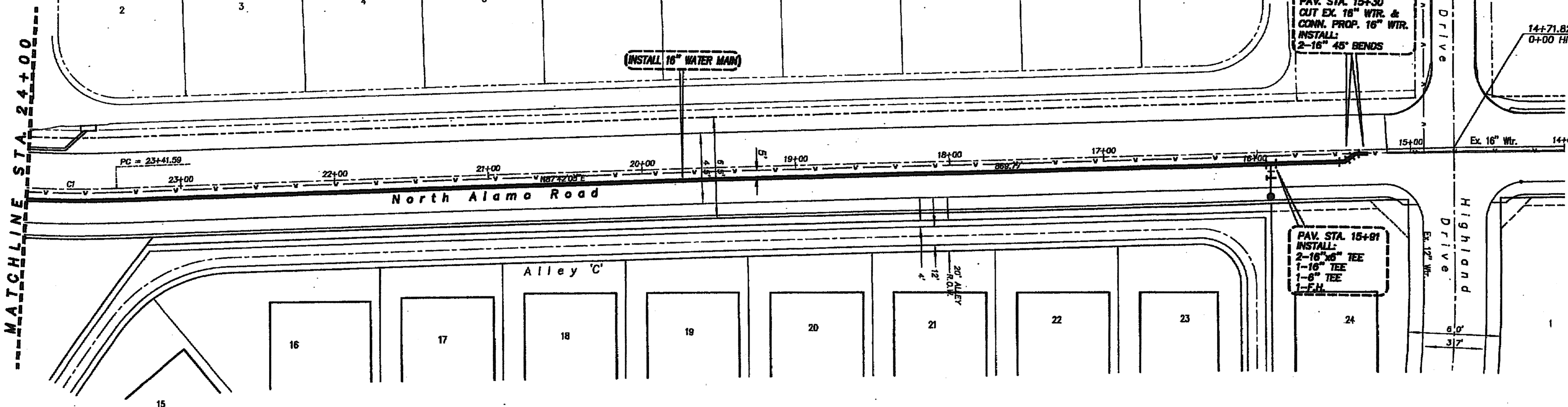
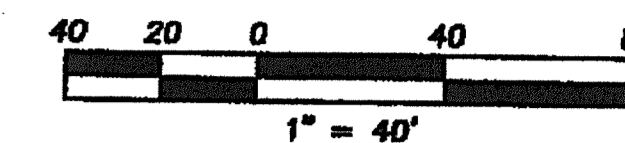
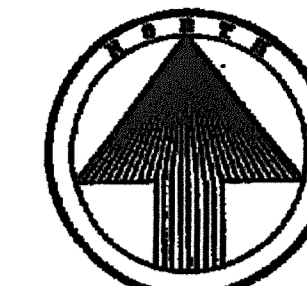

CURVE DATA					
CURVE	RADIUS	DELTA	LENGTH	CHORD	BEARING
C1	688.90'	59.21°	68.41'	68.38'	S89°17'45"E

NOTE:  
CONTRACTOR SHALL CONNECT ANY & ALL SERVICES AND  
FIRE HYDRANT LEADS TO PROP. 16" WATER MAIN IF  
THOSE SERVICES WERE CONNECTED TO THE EXISTING 16" WATER.

PROP. 16" WATER MAIN

**CAUTION EXISTING UTILITIES !!!**  
EXISTING UTILITIES AND UNDERGROUND FACILITIES INDICATED ON THESE  
PLANS HAVE BEEN LOCATED FROM REFERENCE INFORMATION. IT  
SHALL BE THE RESPONSIBILITY OF THE CONTRACTOR TO VERIFY BOTH  
HORIZONTALLY AND VERTICALLY THE LOCATION OF ALL EXISTING UTILITIES  
AND UNDERGROUND FACILITIES PRIOR TO CONSTRUCTION. TO TAKE THE  
NECESSARY PRECAUTIONS IN ORDER TO PROTECT ALL FACILITIES  
ENCOUNTERED. THE CONTRACTOR SHALL PRESERVE AND PROTECT ALL  
EXISTING UTILITIES FROM DAMAGE DURING CONSTRUCTION.

BENCH MARK: #1  
BRASS CAP IN CL. OF MEDIAN NORTH ON LAKESHORE  
DRIVE NORTH OF THE INTERSECTION OF NORTH ALAMO  
AND LAKESHORE DRIVE.  
ELEV. 524.78

BENCH MARK: #2  
BRASS CAP IN CL. OF MEDIAN ON LAKESHORE DRIVE  
BETWEEN TO STREETS, STONEBROOK AND AMESBURY  
BEING NORTH OF HAVEN HILL.  
ELEV. 518.83

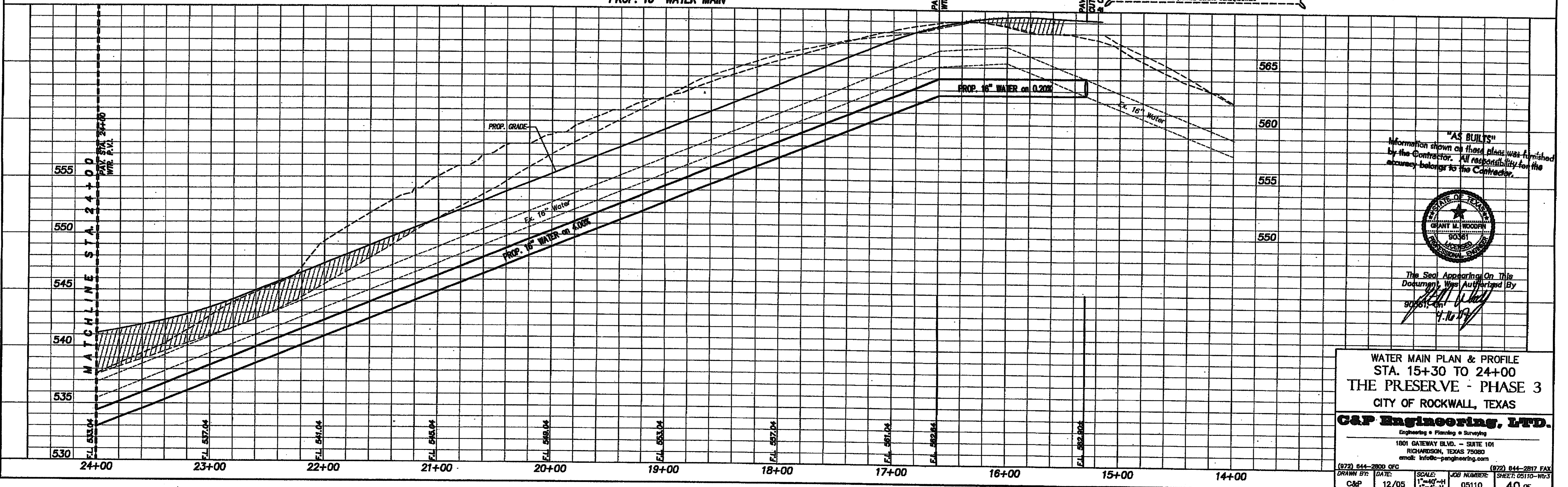

"AS BUILTS"  
Information shown on these plans was furnished  
by the Contractor. All responsibility for the  
accuracy belongs to the Contractor.

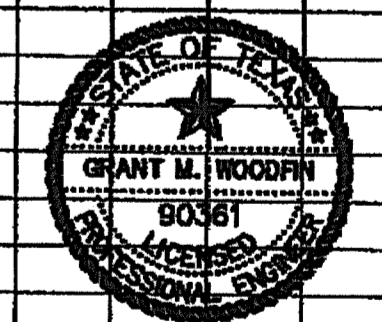

The Seal Appearing On This  
Document Was Authorized By  
*Grant W. Woodfin*  
12/16/05

WATER MAIN PLAN & PROFILE  
STA. 15+30 TO 24+00  
THE PRESERVE - PHASE 3  
CITY OF ROCKWALL, TEXAS

**C&P Engineering, LTD.**  
Engineering • Planning • Surveying  
1801 GATEWAY BLVD. - SUITE 101  
RICHARDSON, TEXAS 75080  
email: info@c-pengineering.com

(972) 844-2800 OFC (972) 844-2817 FAX  
DRAWN BY: C&P DATE: 12/05 SCALE: 1"=40'-H  
JOB NUMBER: 05110 SHEET: 05110-WR-3  
40 OF