

NOTE:
 FIRE HYDRANTS AND VALVE LOCATIONS MAY
 BE EXAGGERATED FOR GRAPHICS PURPOSES.
 INSTALLATION SHALL BE ACCORDING TO ALL
 CITY STANDARDS.
 INSTALL: 2" BLOW OFF IN METER BOX

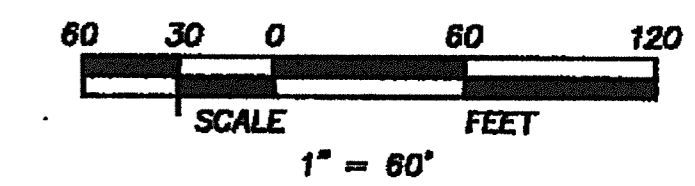

LEGEND

- SANITARY LINE
- WATER LINE
- ⊕ FIRE HYDRANT
- SANITARY MANHOLE
- ⊙ WATER METER

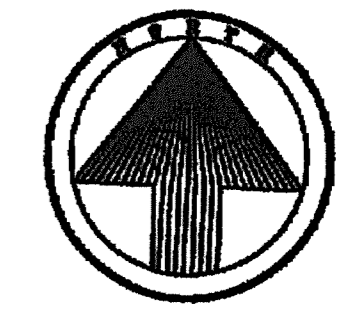
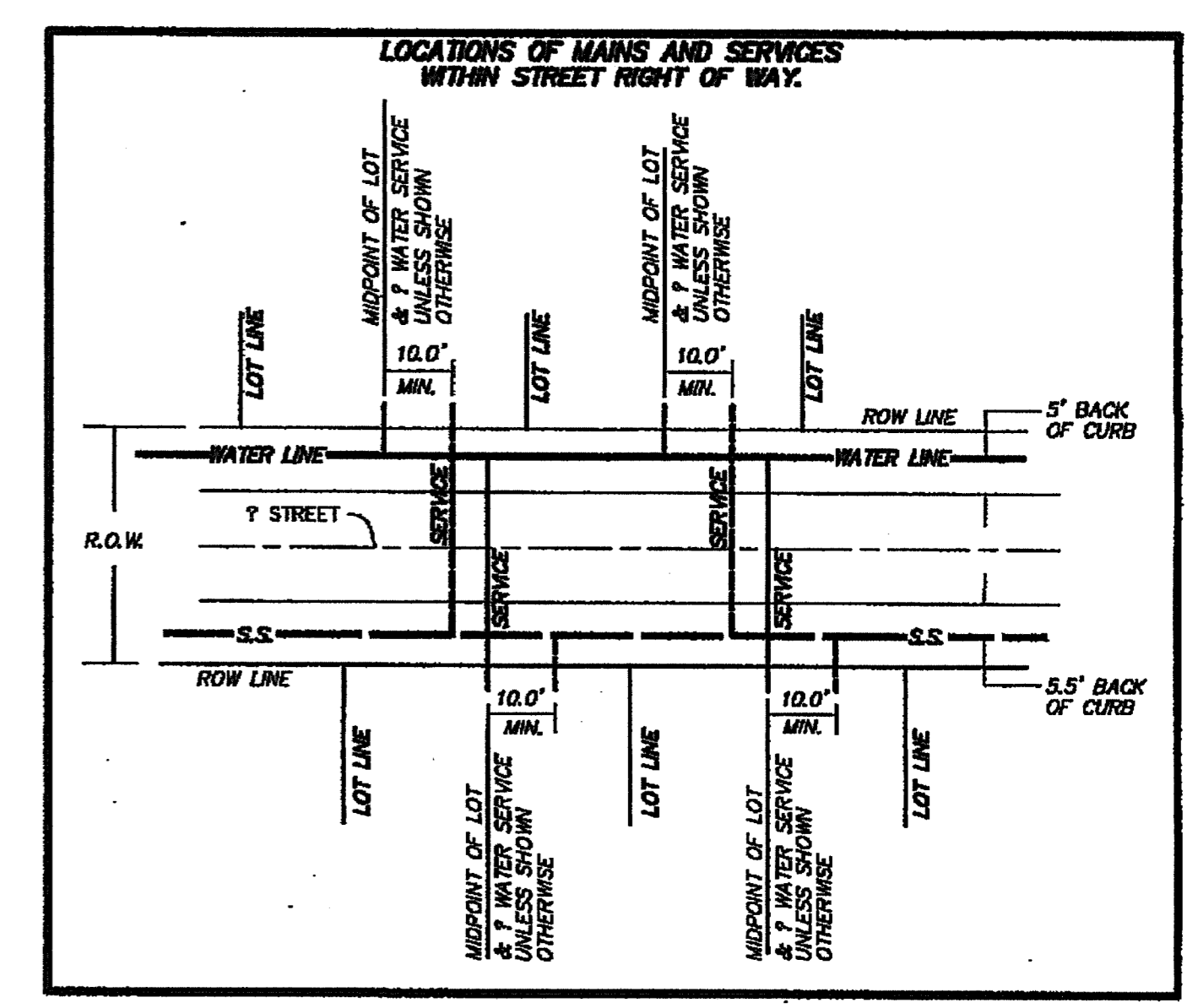
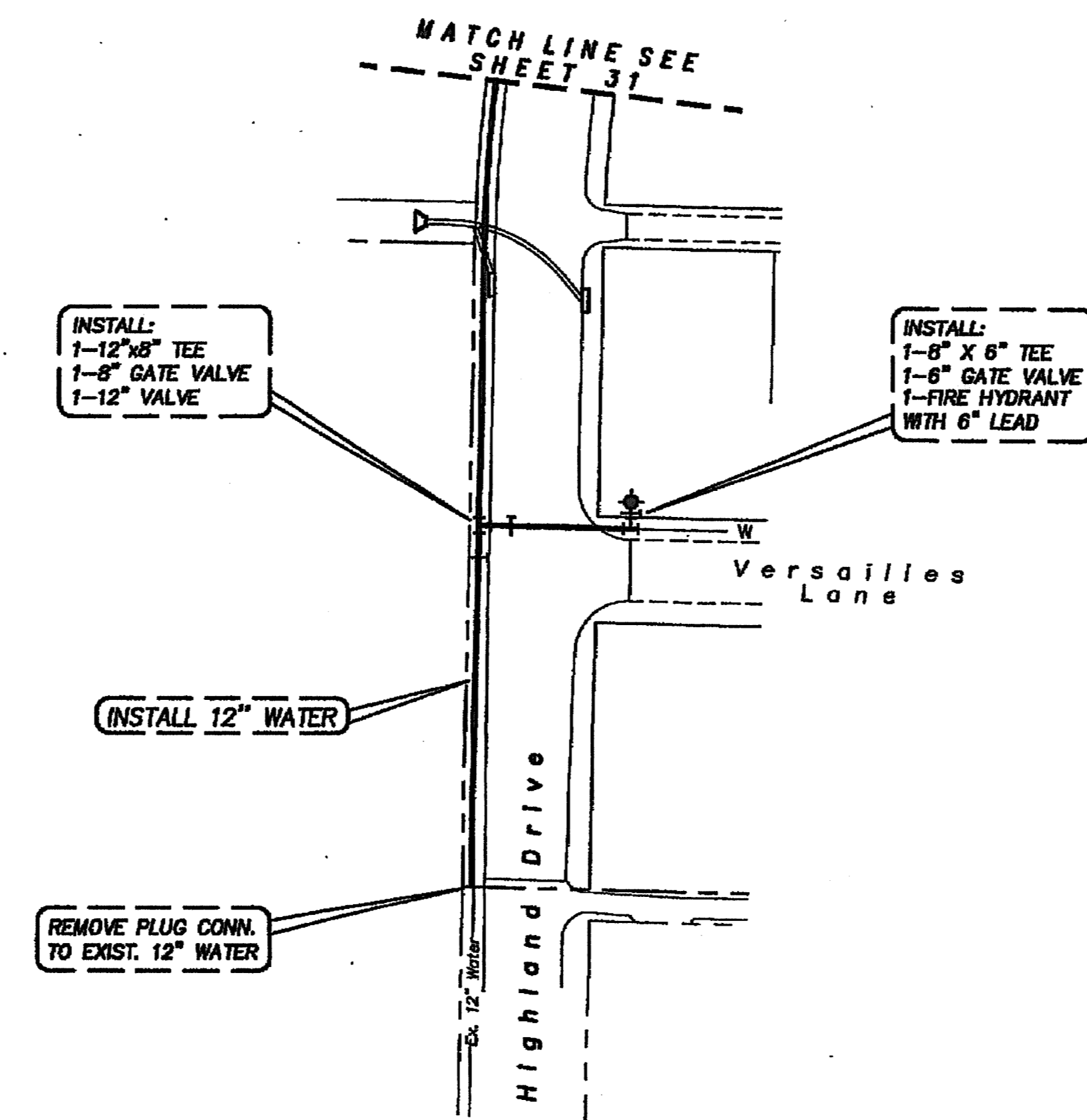

LOCATIONS OF MAINS AND SERVICES
 N.T.S.

BENCH MARK: #1
 BRASS CAP IN CL. OF MEDIAN NORTH ON LAKESHORE
 DRIVE NORTH OF THE INTERSECTION OF NORTH ALAMO
 AND LAKESHORE DRIVE.
 ELEV. 524.78

BENCH MARK: #2
 BRASS CAP IN CL. OF MEDIAN ON LAKESHORE DRIVE
 BETWEEN TO STREETS, STONEBROOK AND AMESBURY
 BEING NORTH OF HAVEN HILL.
 ELEV. 518.83

WATER & SANITARY SEWER GENERAL NOTES

1. Unless otherwise noted all materials and construction shall conform to the applicable specifications and standards of the City of Rockwall and The North Central Texas Council of Governments - "Standard Specifications for Public Works Construction," 3rd. edition.
2. All sanitary sewer and water main construction within public right-of-way or easement shall conform to the requirements of the Texas Natural Resources Conservation Commission (T.N.R.C.C.) guidelines for construction of public water and sewer systems. Contractor shall maintain a copy of the design documents at the jobsite at all times.
3. Contractor shall maintain existing sanitary sewer and water service at all times during construction.
4. The locations, elevations and dimensions of existing utilities shown on the plans were obtained from available city and utility company records and plans and are considered APPROXIMATE. It shall be the contractor's responsibility to verify all locations, elevations and dimensions of adjacent and/or conflicting utilities sufficiently in advance of construction in order that adjustments can be made to provide adequate clearances. The contractor shall preserve and protect public utilities at all times during construction. Any damage to utilities resulting from contractor's operations, shall be restored at his expense. The engineer shall be notified when proposed sanitary sewer or water line grades conflict with existing utility grades. At least forty-eight (48) hours prior to beginning construction in the vicinity of existing utilities, the contractor shall notify utility companies to locate all underground utilities.
5. All dimensions shown are to centerline of pipe unless noted otherwise.
6. All water mains shall be CLASS 200, DR-14 PVC pipe.
7. All sanitary sewer lines shall be SDR-35 PVC pipe (0-10' deep) & SDR-26 PVC pipe (over 10' deep).
8. The contractor shall provide a trench safety plan prior to beginning his work.
9. All sanitary sewer lines and water mains shall have a minimum cover to the top of pipe equal to 42" and 48" respectively, unless shown otherwise.
10. All fittings shall be mechanical and shall be polywrapped.
11. Pipe embedment and thrust blocking shall be per "N.C.T.C.O.G. Standard Details."
12. Green EMS locator pads shall be installed at every sanitary sewer manhole, service & cleanout. Blue EMS locator pads shall be installed at every waterline change in direction, service, fire hydrant and valve.
13. All proposed water lines shall be pressure tested, flushed and sterilized and meet all federal and state testing requirements.
14. All fire hydrants shall be a type approved by the City of Rockwall and shall be installed and color-coded in accordance with all the City of Rockwall requirements.
15. Pull proposed water and sanitary sewer lines as necessary to clear inlet boxes. Do not exceed the manufacturer's maximum deflection. (use 250' min. radius)
16. Where a sanitary sewer service line ties into a manhole, the service shall be raised above the flowline of the main by one foot (1') to allow for maintenance related issues.

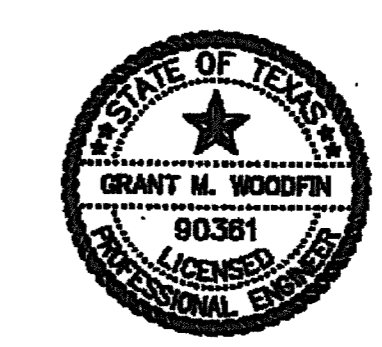

The Seal Appearing On This Document Was Authorized By
 5.2.07

"AS BUILTS"
 Information shown on these plans was furnished by the Contractor. All responsibility for the accuracy belongs to the Contractor.

WATER & SANITARY SEWER PLAN
THE PRESERVE - PHASE 3
CITY OF ROCKWALL, TEXAS

C&P Engineering, LTD.
 Engineering • Planning • Surveying

1801 GATEWAY BLVD. - SUITE 101
 RICHARDSON, TEXAS 75080
 email: info@c-pengineering.com

(972) 844-2800 OFC (972) 844-2817 FAX
 DRAWN BY: C&P DATE: 12/05 SCALE: 1"=60'-H JOB NUMBER: 05110 SHEET: 0510-WSS2
 31A OF