

DEVELOPMENT PLANS FOR THE PRESERVE - PHASE 3 CITY OF ROCKWALL, ROCKWALL COUNTY, TEXAS

THE PRESERVE - PHASE 3

INDEX of SHEETS

Sheet No.	Title
1	Cover Sheet
2, 3, 4	Final Plat (Winklemann)
5	Paving Details
6-20	Paving Plan & Profile
21-22	Lot Grading Plan
23	Drainage Area Map
23A	Storm Sewer Calculations
24-29	Storm Sewer Plan & Profile
30-31A	Water & Sanitary Sewer Plan
32-37	Sanitary Sewer Profiles
38-40	Water Line Plan & Profiles
41	Erosion Control Plan / S.W.P.P.P.
42	Erosion Control Details
S1.1	Retaining Wall Details
Winklemann & Associates, Inc. Plans:	
Lift Station:	
32	Lift Station Paving & Dim. Control Plan
33	Lift Station Grading Plan
34	Lift Station Pump Specs.
34A	Lift Station Panel & Float Specs.
35, 35A, 35B	Lift Station Details
36	Force Main Plan
Off-site Phase One Plans:	
1	Phase One Drainage Area Map
2	Phase One Drainage Calculations
35	Phase One Water Plan
36	Phase One Sanitary Sewer Plan
37,39,40	Phase One Sanitary Sewer Profiles
North Alamo Connection to SH 205	
15	Alamo Drive Plan (Connection to SH 205)
15-A	Alamo Drive Traffic Plan
34A	Alamo Drive Drainage Plan
34B	Drainage Details

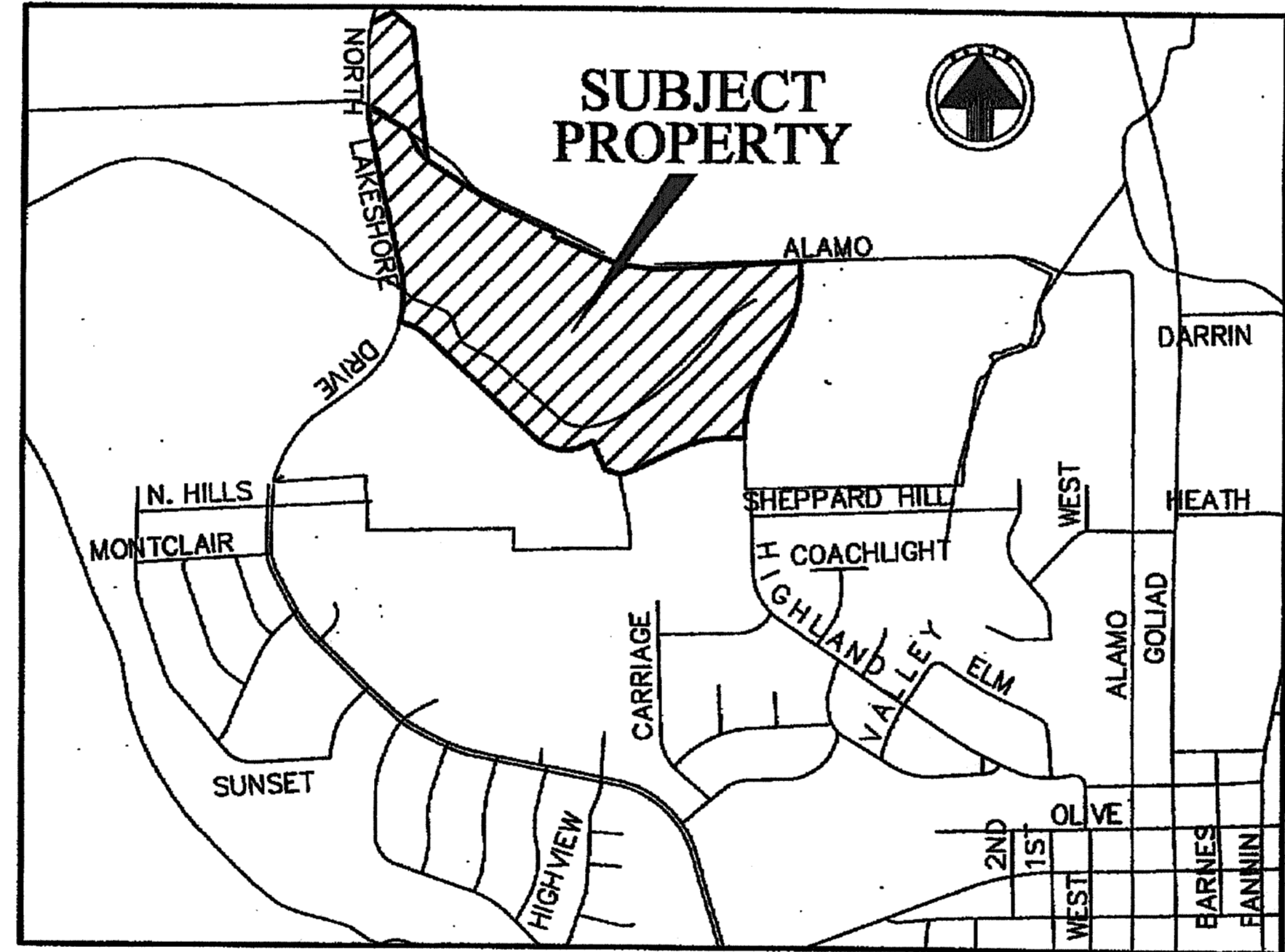

LOCATION MAP
(-N. T. S.)

"AS BUILT"
Information shown on these plans was furnished by the Contractor. All responsibility for the accuracy belongs to the Contractor.

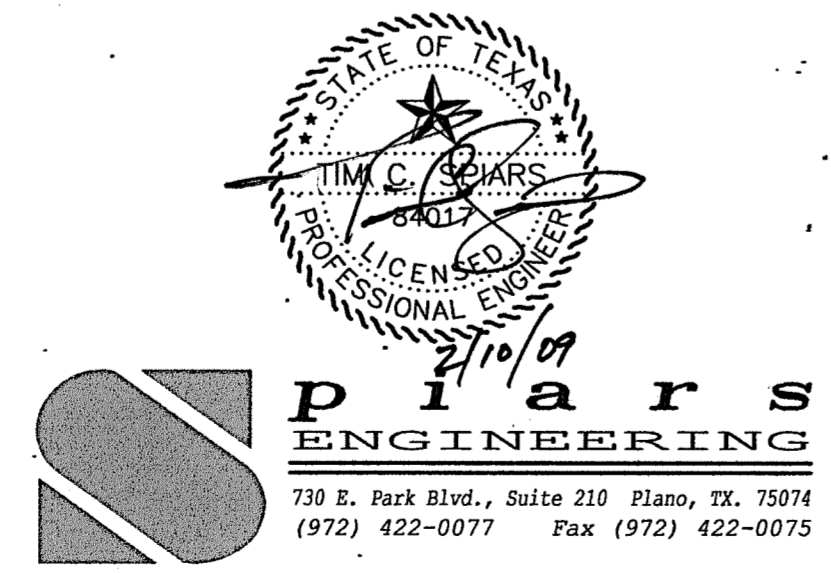

RECORD DRAWINGS

NOTE: THESE PLANS HAVE BEEN REVISED TO CONFORM WITH CONSTRUCTION RECORDS PROVIDED TO SPIARS ENGINEERING, INC. BY CONTRACTOR AND CITY STAFF AFTER AS-BUILTS WERE ORIGINALLY SUBMITTED TO THE CITY OF ROCKWALL BY OTHERS. MODIFICATIONS TO PAVING, PAD AND UTILITY ELEVATIONS, AS REFLECTED ON THESE PLANS, WERE VERIFIED BY FIELD SURVEY PERFORMED IN DECEMBER, 2008.

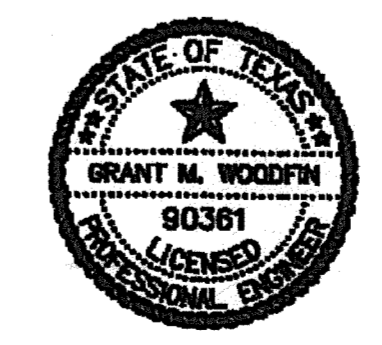

The Seal Appearing On This Document Was Authorized By
Grant M. Woodfin
90361, On 4.18.07

Applicant ~ Developer
SHADDOCK DEVELOPERS
2400 Dallas Parkway
Suite 560
Plano, Texas 75093
(972) 985-5505

February 2007

Engineer ~ Surveyor:
C & P Engineering, LTD.
1801 Gateway, Suite 101
Richardson, Texas 75080
(972) 644-2800