

**DRAINAGE GENERAL NOTES**

1. Unless otherwise noted all materials and construction shall conform to the applicable specifications and standards of the City of Rockwall and the North Central Texas Council of Governments - "Standard Specifications for Public Works Construction," 3rd. edition.
2. All reinforcement shall be grade 60.
3. Jetting of embedment and backfill will not be allowed as a method of compaction.
4. Minimum compaction adjacent to and above storm sewers and drainage structures will be 95% with moisture 1% to 3% wet of optimum in all rights-of-way. Compaction in other areas will be 95%.
5. Lifts will not exceed 6" and results will be obtained by Ramex, hand-tamping or as approved in writing by the City.
6. Contractor will be responsible for field verifying the location of all existing utilities prior to his operations.
7. All bends and connections other than those at junction boxes shall be prefabricated by the factory.
8. All storm sewer pipes shall be ASTM C-76 RCP with tongue and groove connections (Class III or greater).

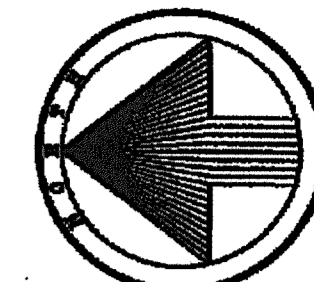

40 20 0 40 80  
1" = 40'

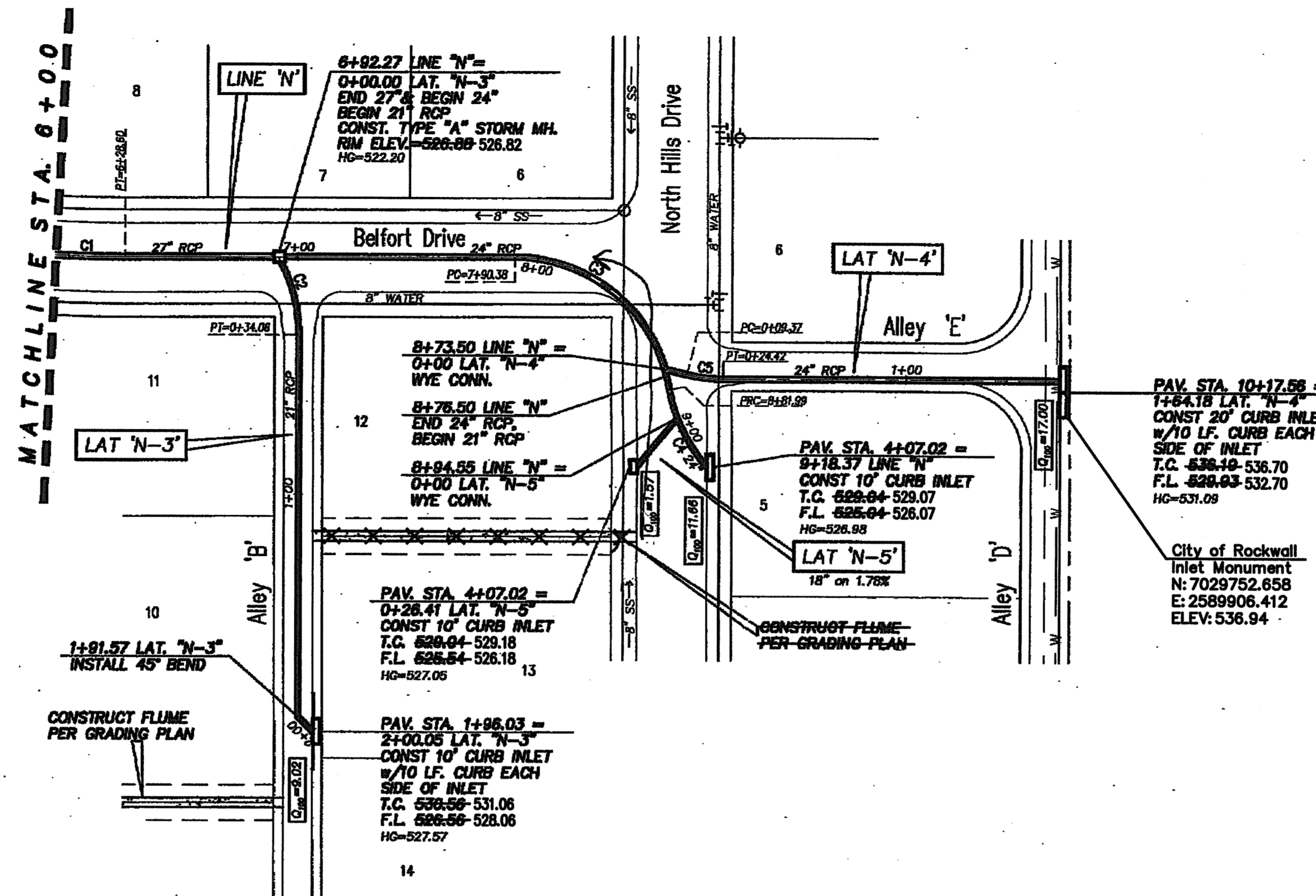

CURVE DATA					
CURVE	RADIUS	DELTA	LENGTH	CHORD	BEARING
C1	570.00'	252°28'	28.60'	28.60'	S01°20'37"W
C2	65.00'	300°12'	34.06'	33.67'	N74°55'06"E
C3	65.00'	80°45'14"	31.61'	34.22'	N40°16'59"E
C4	65.00'	37°04'12"	36.39'	35.91'	S84°37'31"W
C5	65.00'	131°14'46"	15.05'	15.01'	S09°32'38"W

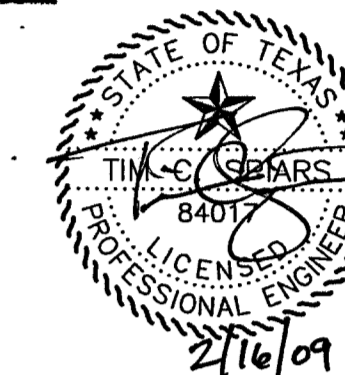

**RECORD DRAWINGS**

NOTE:  
THESE PLANS HAVE BEEN REVISED TO CONFORM WITH CONSTRUCTION RECORDS PROVIDED TO SPARS ENGINEERING, INC. BY CONTRACTOR AND CITY STAFF AFTER AS-BUILTS WERE ORIGINALLY SUBMITTED TO THE CITY OF ROCKWALL BY OTHERS. MODIFICATIONS TO PAVING, PAD, AND UTILITY ELEVATIONS, AS REFLECTED ON THESE PLANS, WERE VERIFIED BY FIELD SURVEY PERFORMED IN DECEMBER, 2008.

**BENCH MARK: #1**  
BRASS CAP IN CL. OF MEDIAN NORTH ON LAKESHORE DRIVE NORTH OF THE INTERSECTION OF NORTH ALAMO AND LAKESHORE DRIVE.

ELEV. 524.78

**BENCH MARK: #2**  
BRASS CAP IN CL. OF MEDIAN NORTH ON LAKESHORE DRIVE BETWEEN TO STREETS, STONEBROOK AND AMESBURY BEING NORTH OF HAVEN HILL

ELEV. 518.83

LINE "N"

LATERAL "N-3"

LATERAL "N-4"

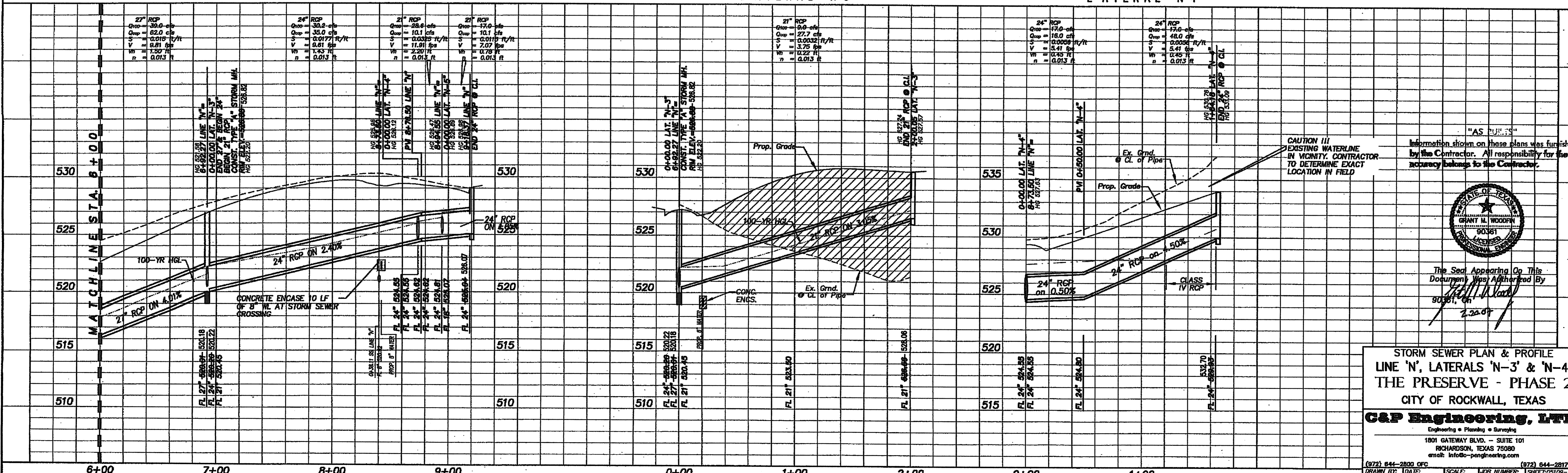

STORM SEWER PLAN & PROFILE  
LINE "N", LATERALS "N-3" & "N-4"  
THE PRESERVE - PHASE 2  
CITY OF ROCKWALL, TEXAS

**C&P Engineering, LTD.**  
Engineering • Planning • Surveying

1801 GATEWAY BLVD. - SUITE 101  
RICHARDSON, TEXAS 75080  
email: info@c-pengineering.com

(972) 644-2800 OFF (972) 644-2817 FAX  
DRAWN BY: DATE: SCALE: JOB NUMBER: SHEET: 05108-Sms3  
C&P 2/06 1"=40'-H 05109 20 of