

CURVE DATA					
CURVE	RADIUS	DELTA	LENGTH	CHORD	BEARING
C1	250.00'	44°10'48"	182.77'	188.03'	S21°59'48"W
C2	80.00'	44°10'48"	69.40'	67.89'	S21°59'48"W
C3	36.00'	89°22'51"	58.47'	50.86'	N44°20'48"E

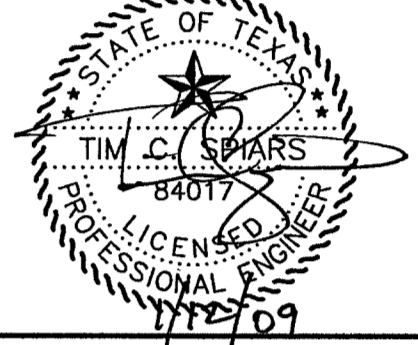

RECORD DRAWINGS

NOTE: THESE PLANS HAVE BEEN REVISED TO CONFORM WITH CONSTRUCTION RECORDS PROVIDED TO SPIARS ENGINEERING, INC. BY CONTRACTOR AND CITY STAFF AFTER AS-BUILTS WERE ORIGINALLY SUBMITTED TO THE CITY OF ROCKWALL BY OTHERS. MODIFICATIONS TO PAVING, PAD AND UTILITY ELEVATIONS, AS REFLECTED ON THESE PLANS, WERE VERIFIED BY FIELD SURVEY PERFORMED IN DECEMBER, 2008.

BENCHMARK: #1
BRASS CAP IN CL. OF MEDIAN NORTH ON LAKESHORE DRIVE NORTH OF THE INTERSECTION OF NORTH ALAMO AND LAKESHORE DRIVE.
ELEV. 524.78

BENCHMARK: #2
BRASS CAP IN CL. OF MEDIAN ON LAKESHORE DRIVE BETWEEN TO STREETS, STONEBROOK AND AMESBURY BEING NORTH OF HAVEN HILL.
ELEV. 518.83

McFARLIN PLACE

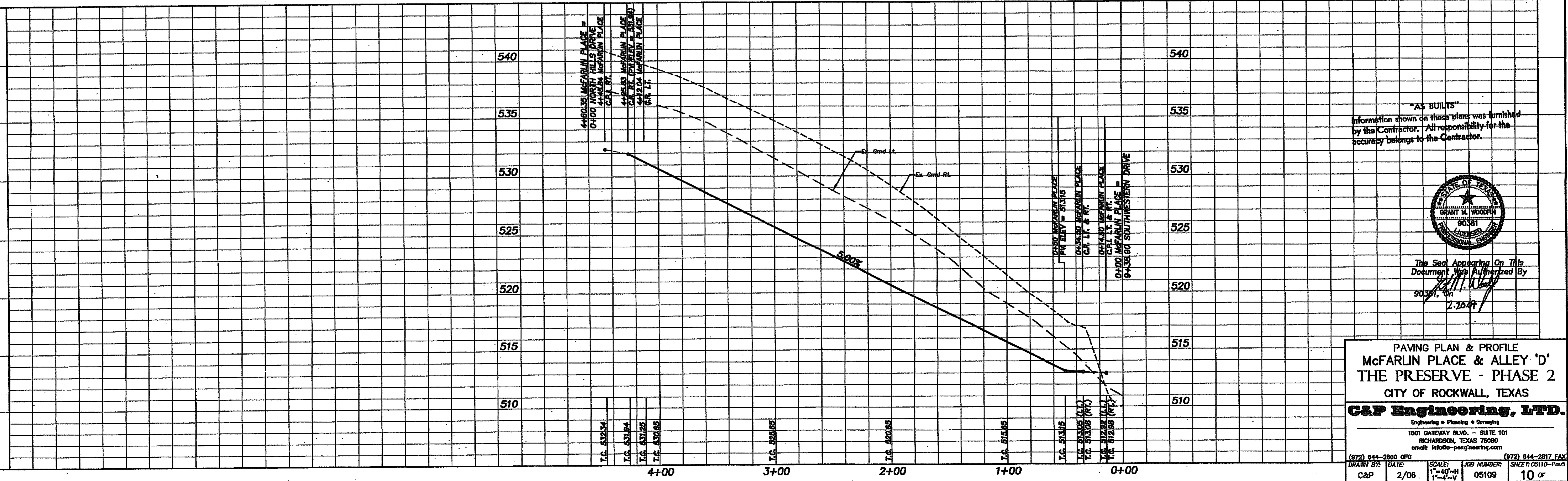

"AS BUILTS"
Information shown on these plans was furnished by the Contractor. All responsibility for the accuracy belongs to the Contractor.

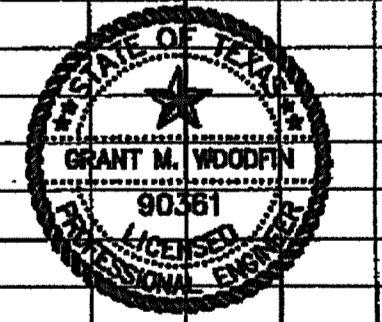

The Seal Appearing On This Document Was Authorized By
Grant M. Woodfin
2.20.09

PAVING PLAN & PROFILE

McFARLIN PLACE & ALLEY 'D'

THE PRESERVE - PHASE 2

CITY OF ROCKWALL, TEXAS

C&P Engineering, LTD.
Engineering • Planning • Surveying
1801 GATEWAY BLVD. - SUITE 101
RICHARDSON, TEXAS 75080
email: info@c-and-p-engineering.com

DRAWN BY: C&P		DATE: 2/06	SCALE: 1"=40'-H 1"=40'-V	JOB NUMBER: 05109	SHEET: 05110-Pos5	10 OF 10
---------------	--	------------	-----------------------------	-------------------	-------------------	----------