

1 DECIDUOUS TREE  
3/4" = 1'-0"

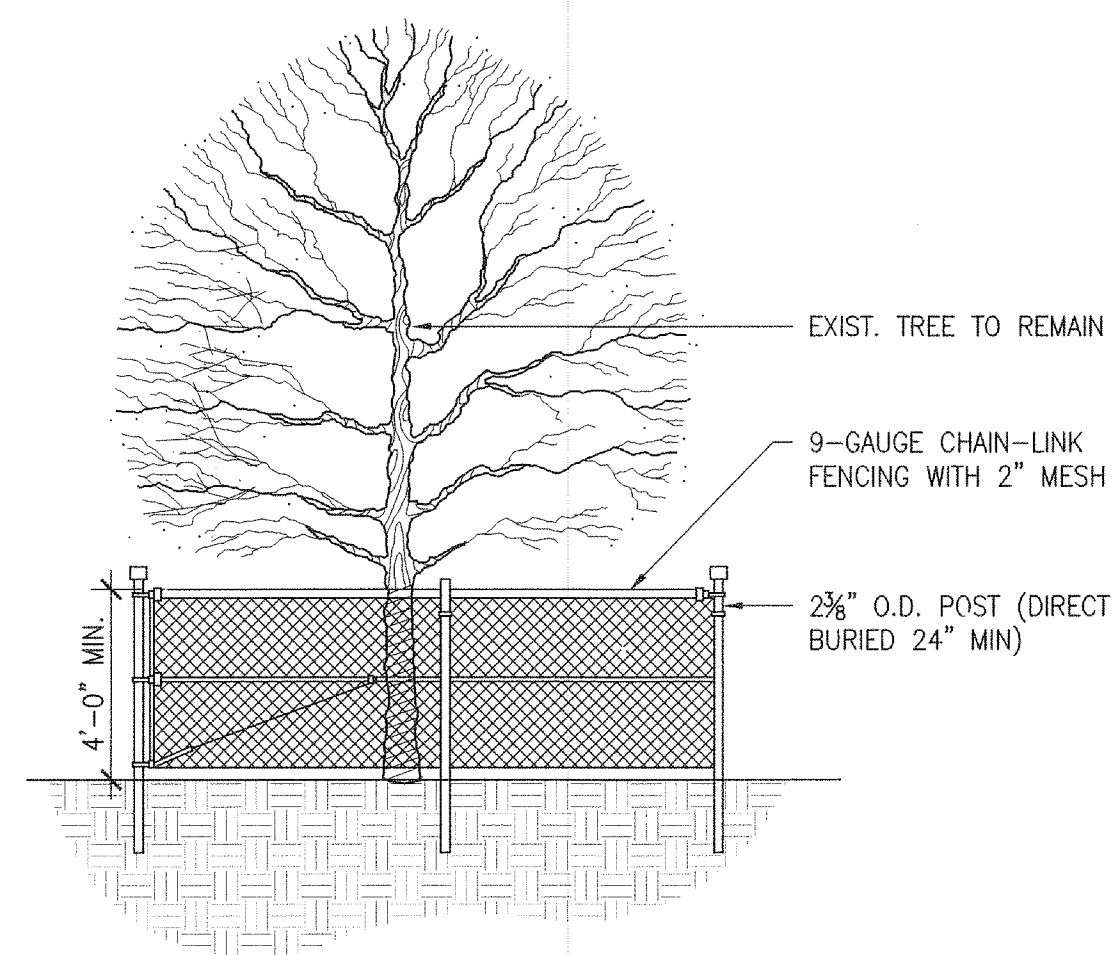

2 NON-MOVABLE TREE PROTECT FENCING  
N.T.S.

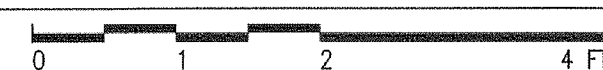
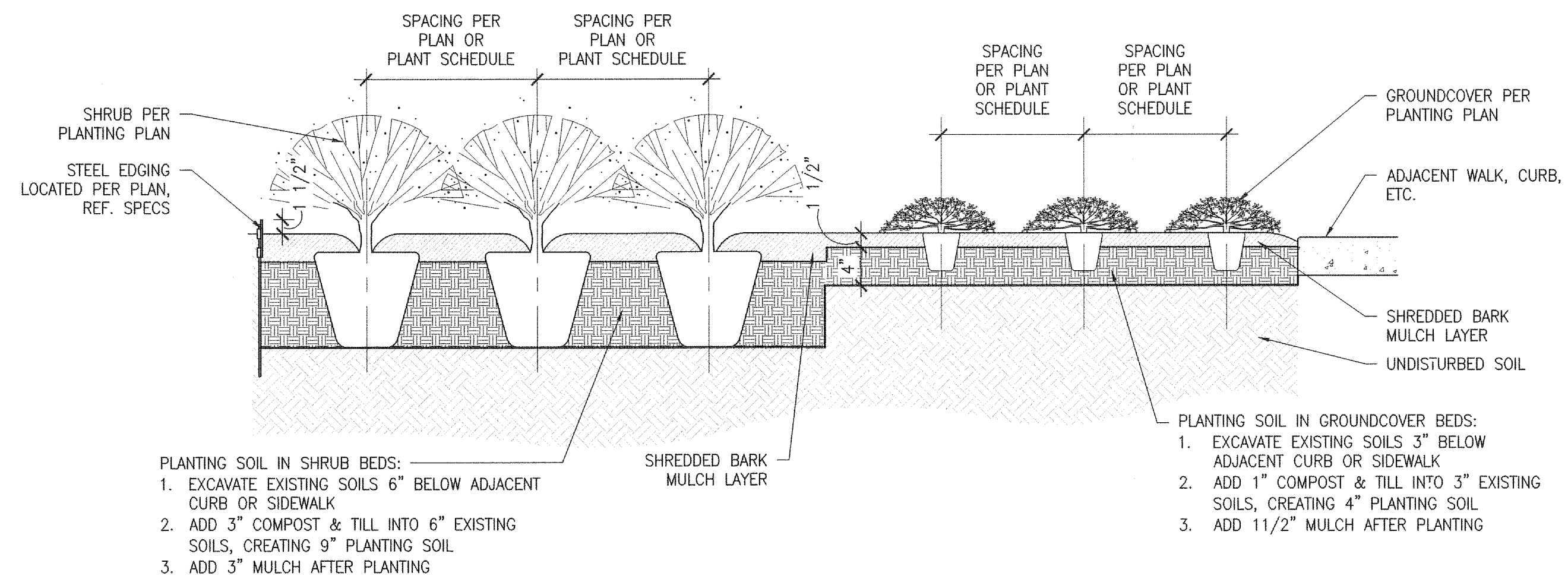

3 SHRUB AND GROUNDCOVER  
1" = 1'-0"



JOHNNES  
 03/26/2014  
 W. (016715) 1567-13.397.DWG\LANDSCAPE\_CSD\_2012\1567-13.397-LD.DWG



**RECORD DRAWING**

THE SIGNED AND SEALED CONSTRUCTION DOCUMENT HAS BEEN REVISED TO REFLECT CONSTRUCTION RECORDS MAINTAINED AND PROVIDED BY THE CONTRACTOR FOR THIS PROJECT. THE INFORMATION SHOWN ON THIS RECORD DRAWING, WHICH WAS PROVIDED BY THE CONTRACTOR, OR OTHERS NOT ASSOCIATED WITH THE DESIGN ENGINEER, CANNOT BE VERIFIED FOR ACCURACY OR COMPLETENESS. PACHECO KOCH SHALL ASSUME NO LIABILITY FOR ANY CHANGES MADE DURING CONSTRUCTION THAT WERE NOT SPECIFICALLY APPROVED BY THE ENGINEER PRIOR TO CONSTRUCTION. THE SEALED CONSTRUCTION DRAWINGS ARE ON FILE AT THE OFFICES OF PACHECO KOCH.

ATTESTED BY:  
 SIGNATURE: *Wade C. Peterson*  
 ENGINEER OF RECORD: WADE C. PETERSON  
 CONTRACTOR: ROGERS-O'BRIEN CONSTRUCTION CO., LTD  
 DATE REVISED: 03/26/2014

NO.	DATE	REVISION

8350 N. CENTRAL EXPWY. SUITE 1000  
 DALLAS, TX 75206 972.235.3031  
 DALLAS • FORT WORTH • HOUSTON TX REG. ENGINEERING FIRM T-469  
 TX REG. SURVEYING FIRM LS-100080-00

**LANDSCAPE DETAILS**  
**THR PRESBYTERIAN HOSPITAL OF ROCKWALL**  
**PARKING LOT EXPANSION**  
**3150 HORIZON ROAD**  
**CITY OF ROCKWALL, ROCKWALL COUNTY, TEXAS**

DESIGN	DRAWN	DATE	SCALE	NOTES	FILE	NO.
WCP	CM	JAN 2013	1" = 20'			<b>L2.1</b>

THR PRESBYTERIAN - PARKING LOT EXPANSION